

NEW MEXICO OIL CONSERVATION COMMISSION
WELL LOCATION AND ACREAGE DEDICATION PLAT

Form C-102
Supersedes C-128
Effective 1-1-65

All distances must be from the outer boundaries of the Section.

Owner TENNECO OIL COMPANY			Lease FLORENCE		Well No. 124
Well Letter C	Section 27	Township 29N	Range 9W	County San Juan	
Actual Footage Location of Well: 635 feet from the North line and 2020 feet from the West line					
Ground Level Elev. 5608	Producing Formation Dakota/Mesa Verde	Pool Basin Dakota/Blanco Mesa Verde	Dedicated Acreage: 320/320 Acres		

1. Outline the acreage dedicated to the subject well by colored pencil or hatchure marks on the plat below.
2. If more than one lease is dedicated to the well, outline each and identify the ownership thereof (both as to working interest and royalty).
3. If more than one lease of different ownership is dedicated to the well, have the interests of all owners been consolidated by communitization, unitization, force-pooling, etc?

☐ Yes ☐ No If answer is "yes," type of consolidation _____

If answer is "no," list the owners and tract descriptions which have actually been consolidated. (Use reverse side of this form if necessary.) _____

No allowable will be assigned to the well until all interests have been consolidated (by communitization, unitization, forced-pooling, or otherwise) or until a non-standard unit, eliminating such interests, has been approved by the Commission.

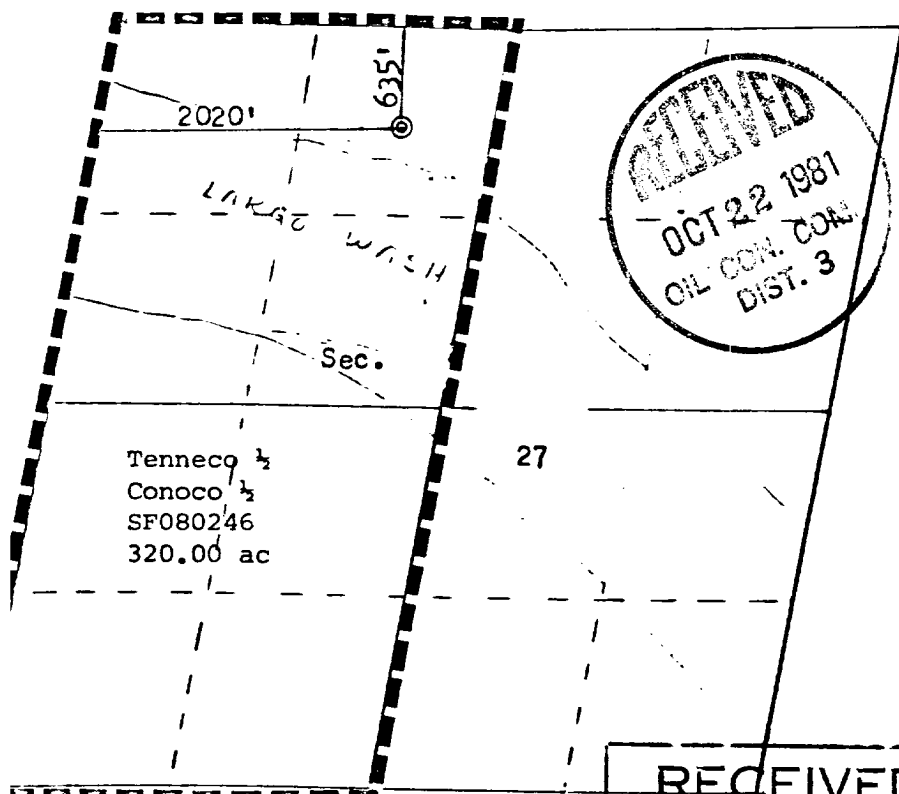

Scale: 1"=1320'

CERTIFICATION

I hereby certify that the information contained herein is true and complete to the best of my knowledge and belief.

Name
M. L. Freeman

Position
Staff Production Analyst

Company
Tenneco Oil Company

Date
August 19, 1980

I hereby certify that the well location shown on this plat was plotted from field notes of actual surveys made by me or under my supervision, and that the same is true and correct to the best of my knowledge and belief.

Date Surveyed
June 10, 1980

Registered Professional Engineer and Land Surveyor

Fred E. Kerr
Certificate No. **B. KERR**

3950