

NO. OF COPIES RECEIVED	3
DISTRIBUTION	
SANTA FE	/
FILE	/
U.S.G.S.	
LAND OFFICE	
OPERATOR	/

NEW MEXICO OIL CONSERVATION COMMISSION

Form C-103
Supersedes Old
C-102 and C-103
Effective 1-1-65

5a. Indicate Type of Lease	
State <input type="checkbox"/>	Fee <input checked="" type="checkbox"/>
5. State Oil & Gas Lease No.	

SUNDRY NOTICES AND REPORTS ON WELLS <small>(DO NOT USE THIS FORM FOR PROPOSALS TO DRILL OR TO DEEPEN OR PLUG BACK TO A DIFFERENT RESERVOIR. USE "APPLICATION FOR PERMIT -" (FORM C-101) FOR SUCH PROPOSALS.)</small>		
1. <input type="checkbox"/> OIL WELL <input checked="" type="checkbox"/> GAS WELL <input type="checkbox"/> OTHER-		7. Unit Agreement Name
2. Name of Operator AMOCO PRODUCTION COMPANY		8. Farm or Lease Name COOPER GAS COM
3. Address of Operator 501 AIRPORT DRIVE, FARMINGTON, NEW MEXICO 87401		9. Well No. 1E
4. Location of Well UNIT LETTER J , 1650 FEET FROM THE SOUTH LINE AND 1480 FEET FROM THE EAST LINE, SECTION 15 TOWNSHIP 29N RANGE 11W NMPM.		10. Field and Pool, or Wildcat BASIN DAKOTA/ BLOOMFIELD CHACRA
15. Elevation (Show whether DF, RT, GR, etc.) 5513' GL		12. County SAN JUAN

16. Check Appropriate Box To Indicate Nature of Notice, Report or Other Data	
NOTICE OF INTENTION TO:	SUBSEQUENT REPORT OF:
PERFORM REMEDIAL WORK <input type="checkbox"/>	REMEDIAL WORK <input type="checkbox"/>
TEMPORARILY ABANDON <input type="checkbox"/>	COMMENCE DRILLING OPNS. <input type="checkbox"/>
PULL OR ALTER CASING <input type="checkbox"/>	CASING TEST AND CEMENT JOBS <input type="checkbox"/>
OTHER <input type="checkbox"/>	OTHER <input type="checkbox"/>
PLUG AND ABANDON <input type="checkbox"/>	ALTERING CASING <input type="checkbox"/>
CHANGE PLANS <input checked="" type="checkbox"/>	PLUG AND ABANDONMENT <input type="checkbox"/>

17. Describe Proposed or Completed Operations (Clearly state all pertinent details, and give pertinent dates, including estimated date of starting any proposed work) SEE RULE 1103.

Amoco Production Company plans to change its surface casing design to 8-5/8", 32# set at 300' and cemented to surface with 300sx. The production string will be 5-1/2", 15.5# set at 6536' and cemented to surface with 1400sx. The well will now be a dual basin dakota-chacra completion. Attached is a revised survey plat.



18. I hereby certify that the information above is true and complete to the best of my knowledge and belief.

Original Signed By **B. E. FACKRELL** TITLE **DISTRICT ENGINEER** DATE **FEBRUARY 27, 1980**

APPROVED BY **Original Signed by FRANK T. CHAVEZ** TITLE **SUPERVISOR DISTRICT # 3** DATE **FEB 28 1980**

CONDITIONS OF APPROVAL, IF ANY:

All distances must be from the outer boundaries of the Section.

Operator AMOCO PRODUCTION COMPANY		Lease COOPER GAS COM		Well No. 1-E
Unit Letter J	Section 15	Township 29N	Range 11W	County San Juan

Actual Footage Location of Well:				
1650	feet from the	South	line and	1480
				feet from the East
Ground Level Elev. 5513	Producing Formation Dakota / Chacra		Pool Basin Dakota/Bloomfield Chacra	Dedicated Acreage: 320/160 Acres

1. Outline the acreage dedicated to the subject well by colored pencil or hachure marks on the plat below.
2. If more than one lease is dedicated to the well, outline each and identify the ownership thereof (both as to working interest and royalty).
3. If more than one lease of different ownership is dedicated to the well, have the interests of all owners been consolidated by communitization, unitization, force-pooling, etc?

☒ Yes ☐ No If answer is "yes," type of consolidation Communitization

If answer is "no," list the owners and tract descriptions which have actually been consolidated. (Use reverse side of this form if necessary.)

No allowable will be assigned to the well until all interests have been consolidated (by communitization, unitization, forced-pooling, or otherwise) or until a non-standard unit, eliminating such interests, has been approved by the Commission.

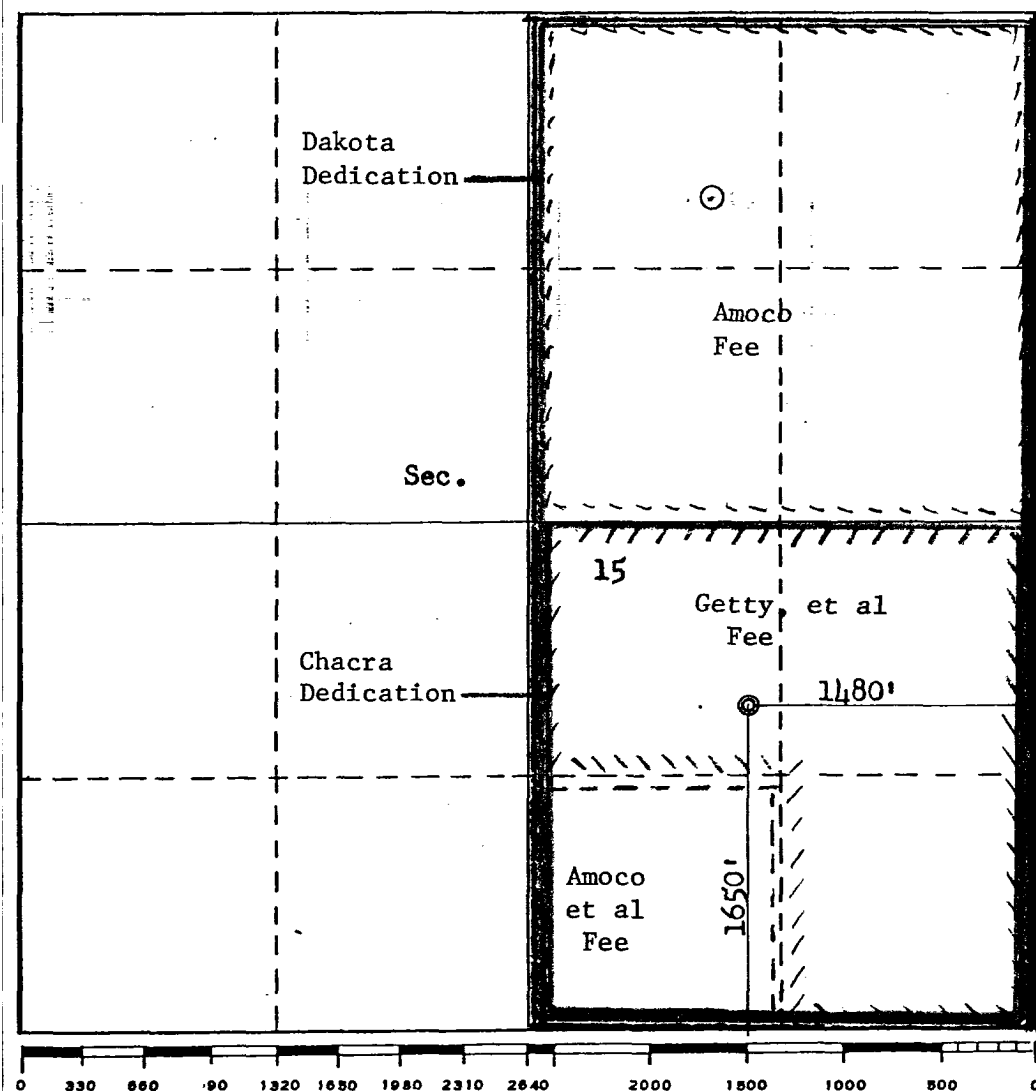

CERTIFICATION

I hereby certify that the information contained herein is true and complete to the best of my knowledge and belief.

B. E. Fackrell

Name
B. E. FACKRELL
Position
DISTRICT ENGINEER
Company
AMOCO PRODUCTION COMPANY

Date
FEBRUARY 27, 1980

I hereby certify that the well location shown on this plat was plotted from field notes of actual surveys made by me or under my supervision, and that the same is true and correct to the best of my knowledge and belief.

Date Surveyed
December 13, 1979
Registered Professional Engineer and/or Land Surveyor
Fred B. Kerr, Jr.
Certificate No.
3950