

NO. OF COPIES RECEIVED	3
DISTRIBUTION	
SANTA FE	1
FILE	1
U.S.G.S.	
LAND OFFICE	
OPERATOR	1

# NEW MEXICO OIL CONSERVATION COMMISSION

Form C-103  
Supersedes Old  
C-102 and C-103  
Effective 1-1-65

5a. Indicate Type of Lease
State <input type="checkbox"/> Fee <input checked="" type="checkbox"/>
5. State Oil & Gas Lease No.

## SUNDRY NOTICES AND REPORTS ON WELLS

(DO NOT USE THIS FORM FOR PROPOSALS TO DRILL OR TO DEEPEN OR PLUG BACK TO A DIFFERENT RESERVOIR. USE "APPLICATION FOR PERMIT -" (FORM C-101) FOR SUCH PROPOSALS.)

1. OIL WELL <input type="checkbox"/> GAS WELL <input checked="" type="checkbox"/> OTHER-	7. Unit Agreement Name
2. Name of Operator AMOCO PRODUCTION COMPANY	8. Farm or Lease Name Cooper Gas Com
3. Address of Operator 501 Airport Drive, Farmington, New Mexico 87401	9. Well No. IE
4. Location of Well UNIT LETTER J 1620 FEET FROM THE South LINE AND 1450 FEET FROM THE East LINE, SECTION 15 TOWNSHIP 29N RANGE 11W NMPM.	10. Field and Pool, or Wildcat Basin Dakota/ Bloomfield Chacra
15. Elevation (Show whether DF, RT, GR, etc.) 5510' ground level	12. County San Juan

## Check Appropriate Box To Indicate Nature of Notice, Report or Other Data

### NOTICE OF INTENTION TO:

PERFORM REMEDIAL WORK <input type="checkbox"/>	PLUG AND ABANDON <input type="checkbox"/>
TEMPORARILY ABANDON <input type="checkbox"/>	CHANGE PLANS <input type="checkbox"/>
PULL OR ALTER CASING <input type="checkbox"/>	OTHER <input checked="" type="checkbox"/> Change location

### SUBSEQUENT REPORT OF:

REMEDIAL WORK <input type="checkbox"/>	ALTERING CASING, <input type="checkbox"/>
COMMENCE DRILLING OPNS. <input type="checkbox"/>	PLUG AND ABANDONMENT <input type="checkbox"/>
CASING TEST AND CEMENT JOBS <input type="checkbox"/>	
OTHER <input type="checkbox"/>	

17. Describe Proposed or Completed Operations (Clearly state all pertinent details, and give pertinent dates, including estimated date of starting any proposed work) SEE RULE 1103.

Amoco Production Company has relocated the above well from 1650' FSL and 1480' FEL, Section 15, T29N, R11W, to a new location of 1620' FSL and 1450' FEL, Section 15, T29N, R11W. A revised survey plat is attached.



18. I hereby certify that the information above is true and complete to the best of my knowledge and belief.

Original Signed By  
B. E. FACHRELL

SIGNED \_\_\_\_\_ TITLE District Engineer DATE March 19, 1980

Original Signed by FRANK T. CHAVEZ

SUPERVISOR DISTRICT #3

APPROVED BY \_\_\_\_\_ TITLE \_\_\_\_\_ DATE MAR 20 1980

CONDITIONS OF APPROVAL, IF ANY:

All distances must be from the outer boundaries of the Section

Operator <b>AMOCO PRODUCTION COMPANY</b>			Lease <b>COOPER GAS COM</b>		Well No. <b>1-E</b>
Unit Letter <b>J</b>	Section <b>15</b>	Township <b>29N</b>	Range <b>11W</b>	County <b>San Juan</b>	

Actual Footage Location of Well: <b>1620</b> feet from the <b>South</b> line and <b>1450</b> feet from the <b>East</b> line					
Ground Level Elev. <b>5510</b>	Producing Formation <b>Dakota/Chacra</b>		Pool <b>Basin Dakota/Bloomfield Chacra</b>	Dedicated Acreage: <b>E 320/160</b> Acres	

1. Outline the acreage dedicated to the subject well by colored pencil or hachure marks on the plat below.
2. If more than one lease is dedicated to the well, outline each and identify the ownership thereof (both as to working interest and royalty).
3. If more than one lease of different ownership is dedicated to the well, have the interests of all owners been consolidated by communitization, unitization, force-pooling, etc?

☒ Yes ☐ No If answer is "yes," type of consolidation COMMUNITIZATION

If answer is "no," list the owners and tract descriptions which have actually been consolidated. (Use reverse side of this form if necessary.)

No allowable will be assigned to the well until all interests have been consolidated (by communitization, unitization, forced-pooling, or otherwise) or until a non-standard unit, eliminating such interests, has been approved by the Commission.

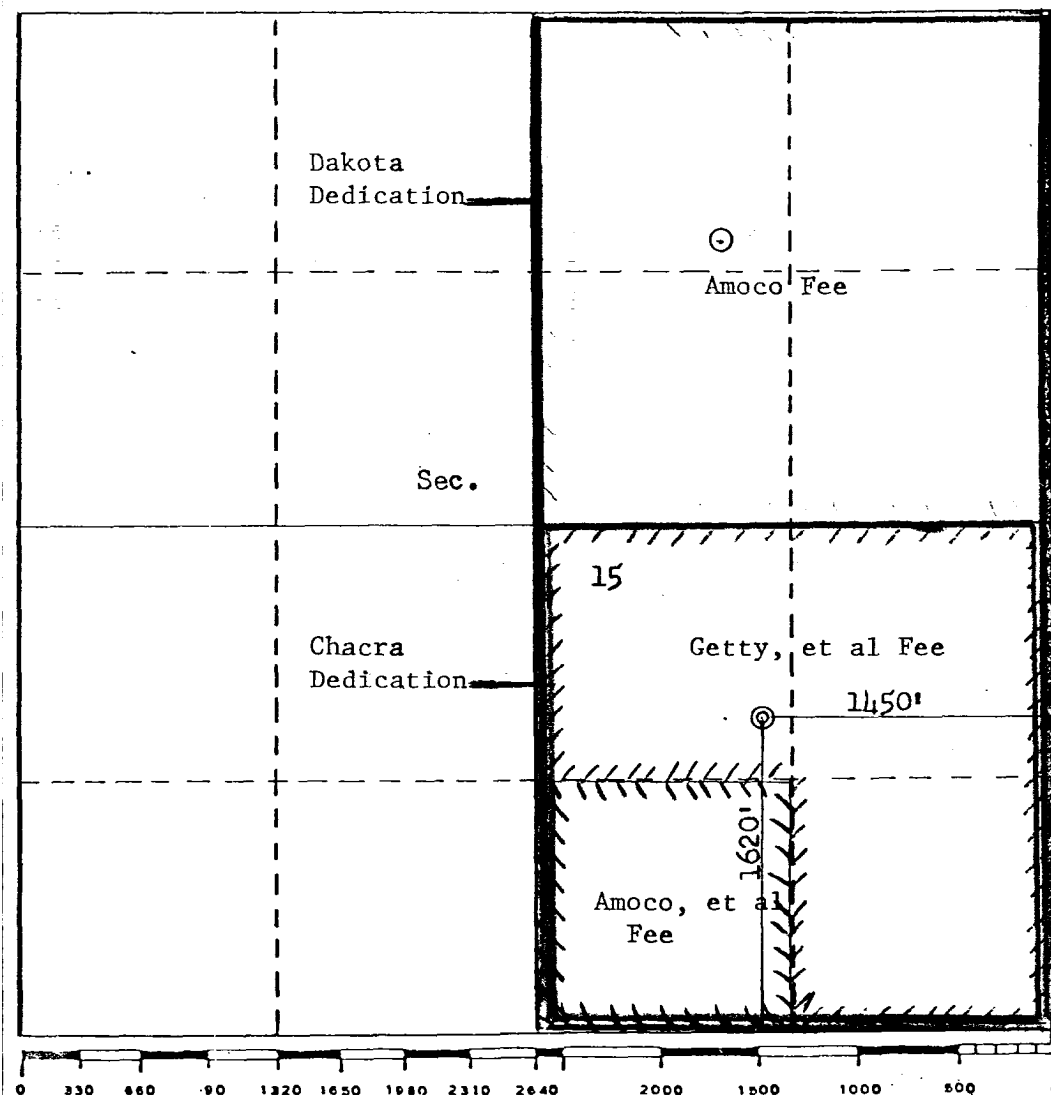

## CERTIFICATION

I hereby certify that the information contained herein is true and complete to the best of my knowledge and belief.

*B.E. Fackrell*

Name  
**B.E. FACKRELL**  
Position  
**DISTRICT ENGINEER**  
Company  
**AMOCO PRODUCTION COMPANY**  
Date  
**MARCH 14, 1980**

RECEIVED  
MAR 20 1980  
OIL CON. COM.  
DIST. 3  
I hereby certify that the well location on this plat was plotted from field notes or other surveys made by me or my supervisor, and that the same is true and correct to the best of my knowledge and belief.

Date Surveyed  
**March 13, 1980**  
Registered Professional Engineer  
and/or Land Surveyor  
*Fred B. Kerr Jr.*  
Certificate  
**3950**