

30-045-24248

NO. OF COPIES RECEIVED	5
DISTRIBUTION	
SANTA FE	1
FILE	1
U.S.G.S.	2
LAND OFFICE	
OPERATOR	1

NEW MEXICO OIL CONSERVATION COMMISSION

Form C-101
Revised 1-1-65

5A. Indicate Type of Lease	
STATE <input type="checkbox"/>	FEE <input checked="" type="checkbox"/>
5. State Oil & Gas Lease No.	
NM-215	

APPLICATION FOR PERMIT TO DRILL, DEEPEN, OR PLUG BACK

1a. Type of Work		7. Unit Agreement Name	
DRILL <input checked="" type="checkbox"/> DEEPEN <input type="checkbox"/> PLUG BACK <input type="checkbox"/>		Gallegos Canyon Unit	
b. Type of Well		8. Farm or Lease Name	
OIL WELL <input type="checkbox"/> GAS WELL <input checked="" type="checkbox"/> OTHER <input type="checkbox"/>		Gallegos Canyon Unit	
2. Name of Operator		9. Well No.	
ENERGY RESERVES GROUP, INC.		307	
3. Address of Operator		10. Field and Pool, or Wildcat	
P.O. BOX 3280 CASPER, WYOMING 82602		West Kutz Pictured Cliffs	
4. Location of Well		Undesignated Mesa Verde	
UNIT LETTER <u>L</u> LOCATED <u>1455</u> FEET FROM THE <u>South</u> LINE			
AND <u>510</u> FEET FROM THE <u>West</u> LINE OF SEC. <u>30</u> TWP. <u>29 N</u> RGE. <u>12 W</u> NMPM			
		12. County	
		San Juan	
		159-28	
		19. Proposed Depth	
		4000'	
		19A. Formation	
		Pictured Cliffs	
		Mesa Verde	
		20. Rotary or C.T.	
		Rotary	
21. Elevations (Show whether DE, RT, etc.)		21B. Drilling Contractor	
5360' G.L.		Unknown	
21A. Kind & Status Plug. Bond		22. Approx. Date Work will start	
Blanket 3881464		As soon as approval is received.	

23.

PROPOSED CASING AND CEMENT PROGRAM

SIZE OF HOLE	SIZE OF CASING	WEIGHT PER FOOT	SETTING DEPTH	SACKS OF CEMENT	EST. TOP
13-3/4"	9-5/8"	36#	250'	250	Surface
8-3/4"	7"	20# & 23#	4000'	200	Cmt. from TD to top of Mesa Verde in 1st stage. Fro base of P.C. to top of Fruitland in 2nd stage.

Energy Reserves Group, Inc. proposes to drill the above referenced well with rotary tools from the surface to TD. This well will be a dual completion. The Mesa Verde at 2995' and below will be used for water disposal. The Pictured Cliffs at 1230' will be used for production. No cores or DST's are planned. Copies of all logs run will be furnished upon completion of the well. A 10" series 900 dual ram hydraulic preventor will be used.

APPROVAL VALID
FOR 90 DAYS UNLESS
DRILLING COMMENCED,

EXPIRES 6-18-80

IN ABOVE SPACE DESCRIBE PROPOSED PROGRAM: IF PROPOSAL IS TO DEEPEN OR PLUG BACK, GIVE DATA ON PRESENT PRODUCTION ZONE AND PROPOSED NEW PRODUCTION ZONE. GIVE CLOWOUT PREVENTER PROGRAM, IF ANY.

I hereby certify that the information above is true and complete to the best of my knowledge and belief.

Signed Curtis J. MacIntyre Title Production Engineer Date 3/5/80

(This space for State Use)

APPROVED BY Frank J. Chang TITLE SUPERVISOR DISTRICT # 3 DATE MAR 20 1980

CONDITIONS OF APPROVAL, IF ANY:

Held C-104 for NSL

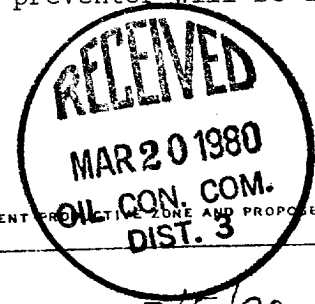

OIL CONSERVATION DIVISION

P. O. BOX 2088

Form C-107
Revised 10-1-78

STATE OF NEW MEXICO

SANTA FE, NEW MEXICO 87501

ENERGY AND MINERALS DEPARTMENT

All distances must be from the outer boundaries of the Section

Operator ENERGY RESERVES GROUP		Lease GALLEGOS CANYON UNIT		Well No. 307
Unit Letter L	Section 30	Township 29N	Range 12W	County San Juan
Actual Footage Location of Well: 1455 feet from the South line and 510 feet from the West line				
Ground Level Elev. 5360	Producing Formation Pictured Cliffs(Gas) Mesa		Pool Verde(Disposal)	Dedicated Acreage: 159.28 160 Acres

- Outline the acreage dedicated to the subject well by colored pencil or hachure marks on the plat below.
- If more than one lease is dedicated to the well, outline each and identify the ownership thereof (both as to working interest and royalty).
- If more than one lease of different ownership is dedicated to the well, have the interests of all owners been consolidated by communitization, unitization, force-pooling, etc?

☐ Yes ☐ No If answer is "yes," type of consolidation _____

If answer is "no," list the owners and tract descriptions which have actually been consolidated. (Use reverse side of this form if necessary.) _____

No allowable will be assigned to the well until all interests have been consolidated (by communitization, unitization, forced-pooling, or otherwise) or until a non-standard unit, eliminating such interests, has been approved by the Commission.

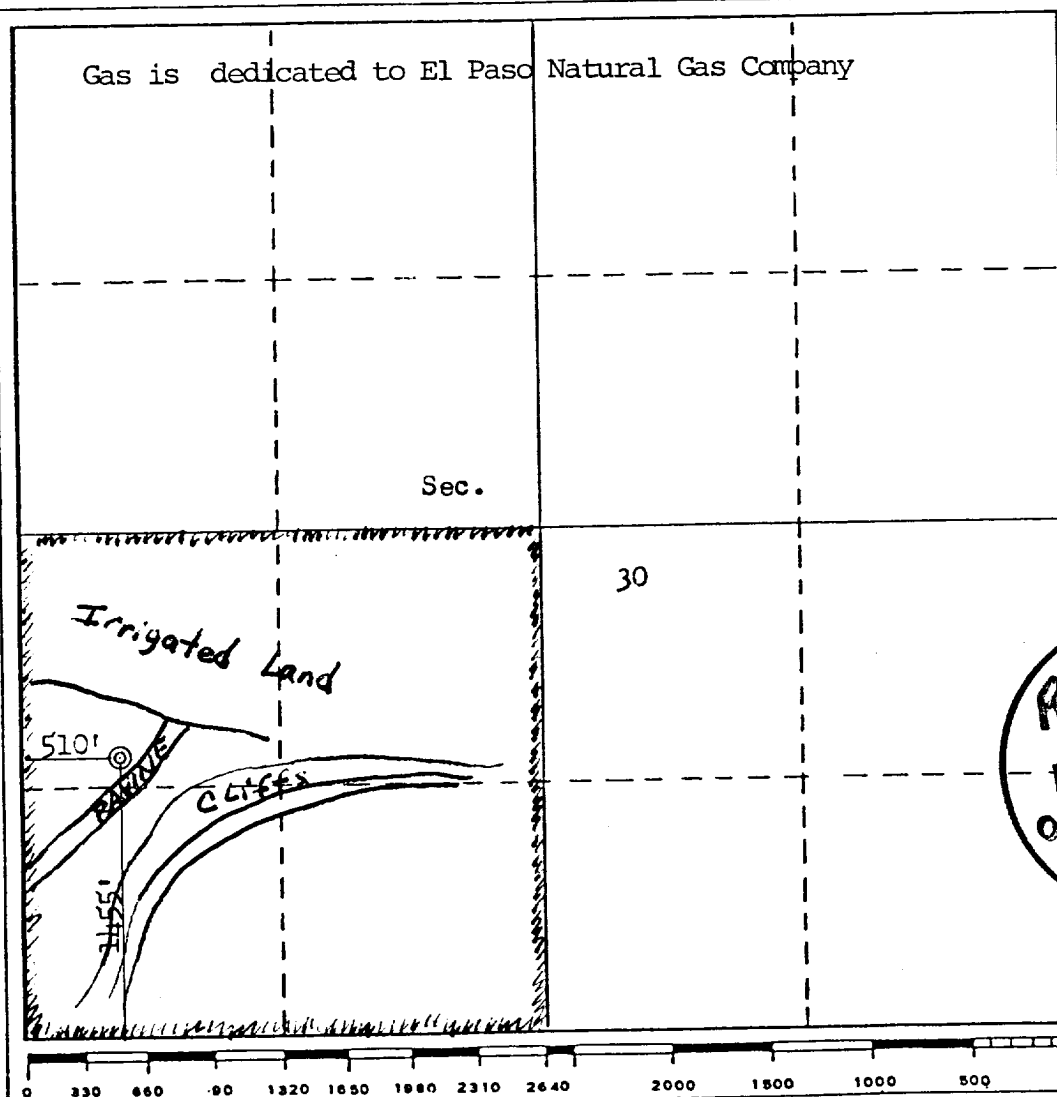

CERTIFICATION

I hereby certify that the information contained herein is true and complete to the best of my knowledge and belief.

Curt Mac Intyre
Name
Production Engineer
Position
Energy Reserves Group
Company
March 11, 1980
Date

I hereby certify that the well location shown on this plat was plotted from field notes and actual surveys made by me or under my supervision, and that the same are true and correct to the best of my knowledge and belief.

RECEIVED
MAR 20 1980
OIL CON. COM.

Fred B. Kerr
REGISTERED PROFESSIONAL ENGINEER
and/or LAND SURVEYOR
Certificate No. *3950*