



**NEW MEXICO ENERGY, MINERALS
& NATURAL RESOURCES DEPARTMENT**

**AZTEC DISTRICT OFFICE
1000 RIO BRAZOS ROAD
AZTEC, NEW MEXICO 87410
(505) 334-6176 Fax (505) 334-6170**

**GARY E. JOHNSON
GOVERNOR**

**JENNIFER A. SALISBURY
CABINET SECRETARY**

Certified: P-471-215-171

November 21, 1996

Pam Staley
Amoco Prod Co
PO Box 800
Denver Co 80201

RE: Gallegos Canyon Unit #307, L-30-29N-12W, 30-045-24248

Dear Pam:

The above-mentioned well was approved for injection into the Mesaverde and production through the casing from the Fruitland allowing us to monitor the tubing casing annulus for any packer or tubing leak. The Fruitland has been shut in and this has created significant noncompliance with OCD Rules and Regulations by not being able to monitor mechanical integrity.

You are hereby directed to return the Fruitland to production or squeeze the Fruitland perforations and run a mechanical integrity test before December 4, 1996. If I can be of any assistance in this matter feel free to call me at 505-334-6178. Notify the OCD in Aztec so we may provide a witness.

Sincerely,

Johnny Robinson
Deputy Oil & Gas Inspector

JR/sh

cc: well file
UIC file
David Catanach, UIC Director, Santa Fe

FIELD PIT SITE ASSESSMENT FORM

GENERAL

Meter: 93-455 Location: Gallegos Canyon Unit 307
Operator #: 0641 Operator Name: BP Petroleum P/L District: Angel Peak
Coordinates: Letter: L Section 30 Township: 29 Range: 12
Or Latitude _____ Longitude _____
Pit Type: Dehydrator _____ Location Drip: X Line Drip: _____ Other: _____
Site Assessment Date: 10/4/94 Area: 01 Run: 61

SITE ASSESSMENT

NMOCD Zone:

(From NMOCD
Maps)

Inside
Outside

Land Type:

BLM ☐ (1)

State ☐ (2)

Fee ☒ (3)

DEPUTY OIL & GAS INSPECTOR

SEP 10 1996

Depth to Groundwater

Less Than 50 Feet (20 points)

50 Ft to 99 Ft (10 points)

Greater Than 100 Ft (0 points)

☒ (1)

☐ (2)

☐ (3)

Wellhead Protection Area :

Is it less than 1000 ft from wells, springs, or other sources of fresh water extraction? , or ; Is it less than 200 ft from a private domestic water source? ☐ (1) YES (20 points) ☒ (2) NO (0 points)

Horizontal Distance to Surface Water Body

Less Than 200 Ft (20 points)

200 Ft to 1000 Ft (10 points)

Greater Than 1000 Ft (0 points)

☒ (1)

☐ (2)

☐ (3)

Name of Surface Water Body Stewart Canyon

(Surface Water Body : Perennial Rivers, Major Wash, Streams, Creeks, Irrigation Canals, Ditches, Lakes, Ponds)

Distance to Nearest Ephemeral Stream ☐ (1) < 100' (Navajo Pits Only)
☐ (2) > 100'

RECEIVED
APR - 4 1996

OIL CON. DIV.
DIST. 3

TOTAL HAZARD RANKING SCORE: 40 POINTS

REMARKS

Remarks : Redline Book: Inside, Vulnerable Zone Topo: Inside
Three pits, location drip pit is dry. Will close one pit.

DIG & HAUL

ORIGINAL PIT LOCATION

Original Pit : a) Degrees from North 128° Footage from Wellhead 83'
b) Length : 27' Width : 26' Depth : 3'

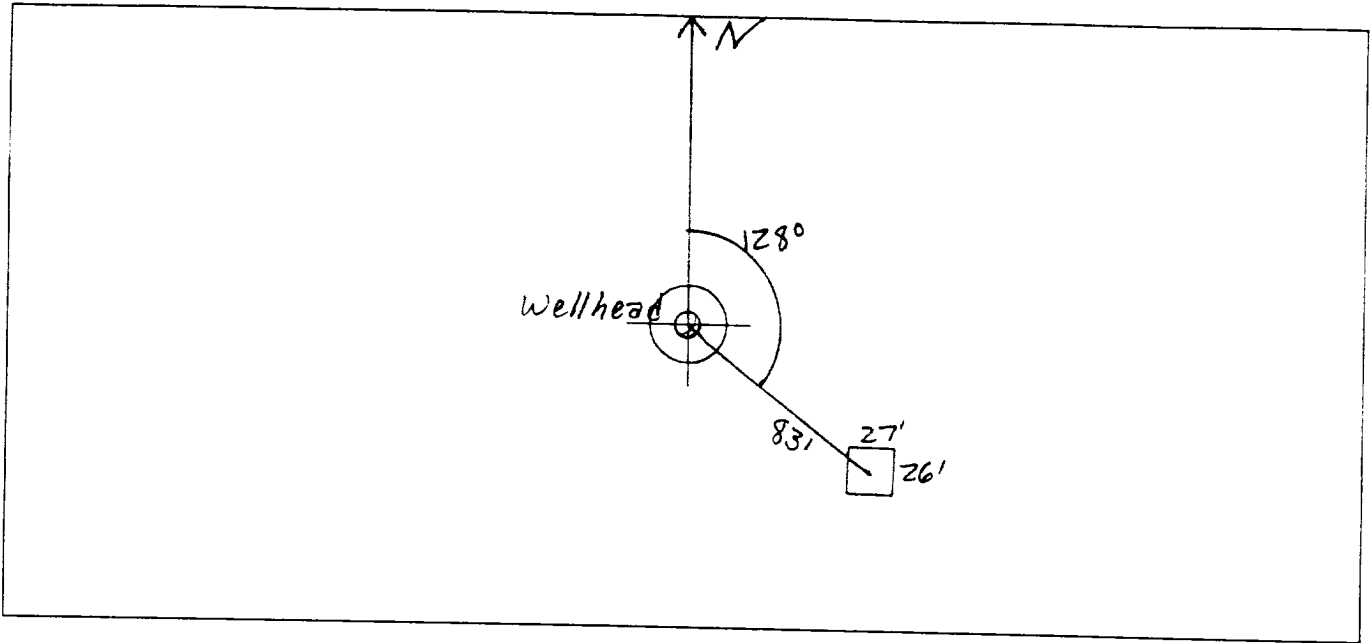

Remarks :

Pictures at 1113.

Dump Truck

Well is temporarily disconnected.

Completed By:

Sarah Kelly

Signature

10/4/94

Date

FIELD PIT REMEDIATION/CLOSURE FORM

GENERAL	<p>Meter: <u>93-455</u> Location: <u>Gallegos Canyon unit 307</u></p> <p>Coordinates: Letter: <u>L</u> Section <u>30</u> Township: <u>29</u> Range: <u>12</u></p> <p>Or Latitude _____ Longitude _____</p> <p>Date Started : <u>10-28-94</u> Run: <u>01</u> <u>61</u></p>
FIELD OBSERVATIONS	<p>Sample Number(s): <u>mk 308</u></p> <p>Sample Depth: <u>6'</u> Feet</p> <p>Final PID Reading <u>0</u> PID Reading Depth <u>6'</u> Feet</p> <p>Yes No</p> <p>Groundwater Encountered <input type="checkbox"/> <input checked="" type="checkbox"/> Approximate Depth _____ Feet</p>
CLOSURE	<p>Remediation Method :</p> <p>Excavation <input checked="" type="checkbox"/> Approx. Cubic Yards <u>50</u> <u>40</u></p> <p>Onsite Bioremediation <input type="checkbox"/></p> <p>Backfill Pit Without Excavation <input type="checkbox"/></p> <p>Soil Disposition:</p> <p>Envirotech <input checked="" type="checkbox"/> Tierra <input type="checkbox"/></p> <p>Other Facility <input type="checkbox"/> Name: _____</p> <p>Pit Closure Date: <u>10-28-94</u> Pit Closed By: <u>REI</u></p>
REMARKS	<p>Remarks : <u>Pit Had 2" of water on top soil was</u> <u>gray Dug Down 5 1/2 feet Turned brown TOOK sample</u> <u>at 6 feet Hole Had cleaned up</u></p>
	<p>Signature of Specialist: <u>Morgan Hillion</u></p>

Natural Gas Company

FIELD SERVICES LABORATORY

ANALYTICAL REPORT

PIT CLOSURE PROJECT - Soil Samples Inside the GWV Zone

SAMPLE IDENTIFICATION

	Field ID	Lab ID
SAMPLE NUMBER:	MW 308	946467
MTR CODE SITE NAME:	93455	N/A
SAMPLE DATE TIME (Hrs):	10-28-94	1315
SAMPLED BY:	N/A	
DATE OF TPH EXT. ANAL.:	11-3-94	11-3-94
DATE OF BTEX EXT. ANAL.:	11-8-94	11-10-94
TYPE DESCRIPTION:	VG	BROWN SANDY CLAY

REMARKS:

RESULTS

PARAMETER	RESULT	UNITS	QUALIFIERS			
			DF	Q	M(g)	V(ml)
BENZENE	20.025	MG/KG	1			
TOLUENE	20.025	MG/KG	1			
ETHYL BENZENE	20.025	MG/KG	1			
TOTAL XYLENES	20.025	MG/KG	1			
TOTAL BTEX	20.10	MG/KG				
TPH (418.1)	22.4	MG/KG			237	28
HEADSPACE PID	0	PPM				
PERCENT SOLIDS	86.4	%				

-- TPH is by EPA Method 418.1 and BTEX is by EPA Method 8020 --

The Surrogate Recovery was at 93 % for this sample All QA/QC was acceptable.
 Narrative: All Results attached.

DF = Dilution Factor Used

Approved By:

Date:

11/24/94



2709-D Pan American Freeway, NE Albuquerque, NM 87106
Phone (505) 344-3777 FAX (505) 344-4413

November 15, 1994

El Paso Natural Gas Co.
P.O. Box 4990
Farmington, NM 87499

Project Name/Number: PIT CLOSURE 24324

Attention: John Lambdin

On 11/04/94, Analytical Technologies, Inc., (ADHS License No. AZ0015), received a request to analyze **non-aqueous** samples. The samples were analyzed with EPA methodology or equivalent methods. The results of these analyses and the quality control data, which follow each set of analyses, are enclosed.

If you have any questions or comments, please do not hesitate to contact us at (505) 344-3777.

Letitia Krakowski, Ph.D.
Project Manager

H. Mitchell Rubenstein, Ph.D.
Laboratory Manager

MR:jt

Enclosure



GAS CHROMATOGRAPHY RESULTS

TEST : BTEX (EPA 8020)
 CLIENT : EL PASO NATURAL GAS CO. ATI I.D.: 411319
 PROJECT # : 24324
 PROJECT NAME : PIT CLOSURE

SAMPLE ID. #	CLIENT I.D.	MATRIX	DATE SAMPLED	DATE EXTRACTED	DATE ANALYZED	DIL. FACTOR
01	946465	NON-AQ	10/28/94	11/08/94	11/10/94	1
02	946466	NON-AQ	10/28/94	11/08/94	11/11/94	1
03	946467	NON-AQ	10/28/94	11/08/94	11/10/94	1

PARAMETER	UNITS	01	02	03
BENZENE	MG/KG	<0.025	<0.025	<0.025
TOLUENE	MG/KG	<0.025	<0.025	<0.025
ETHYLBENZENE	MG/KG	<0.025	<0.025	<0.025
TOTAL XYLENES	MG/KG	<0.025	<0.025	<0.025

SURROGATE:

BROMOFLUOROBENZENE (%)	87	92	93
------------------------	----	----	----