



STATE OF NEW MEXICO
ENERGY AND MINERALS DEPARTMENT
OIL CONSERVATION DIVISION

3-1-80
3-7-80
✓

BRUCE KING
GOVERNOR
LARRY KEHOE
SECRETARY

March 3, 1980

POST OFFICE BOX 2088
STATE LAND OFFICE BUILDING
SANTA FE, NEW MEXICO 87501
(505) 827-2434

Tenneco Oil Company
720 South Colorado Blvd.
Denver, Colorado 80222

Administrative Order NSL-1155

Gentlemen:

Reference is made to your application for approval of a non-standard location for your Callow Well No. 8-E to be located 1900 feet from the North line and 1950 feet from the East line of Section 27, Township 29 North, Range 13 West, NMPM, Basin Dakota Pool, San Juan County, New Mexico.

By authority granted me under the provisions of Rule 3 of Order No. R-1670-V, the above-described unorthodox location is hereby approved.

Sincerely,

JOE D. RAMEY,
Director

JDR/RLS/dr

cc: Oil Conservation Division - Aztec
Oil & Gas Engineering Committee - Hobbs
U. S. Geological Survey - Farmington



OIL CONSERVATION COMMISSION
Albuquerque DISTRICT

OIL CONSERVATION COMMISSION
BOX 2088
SANTA FE, NEW MEXICO

DATE February 12, 1980

RE: Proposed MC _____
Proposed DHC _____
Proposed NSL ✓ _____
Proposed SWD _____
Proposed WFX _____
Proposed PMX _____

Gentlemen:

I have examined the application dated February 5, 1980
for the Senior Oil Co. Callow #9E G-27-29N-13W
Operator Lease and Well No. Unit, S-T-R

and my recommendations are as follows:

Approve

Yours very truly,

Frank S. Dargatzis

Tenneco Oil
A Tenneco Company

Penthouse
720 South Colorado Blvd.
Denver, Colorado 80222
(303) 758-7130



CERTIFIED MAIL
Return Receipt Requested

February 5, 1980

New Mexico Oil Conservation Division
P.O. Box 2088
Santa Fe, New Mexico 87501

Attention: Mr. Joe D. Ramey

New Mexico Oil Conservation Division
1000 Rio Brazos Road
Aztec, New Mexico 87401

Attention: Mr. F. T. Chavez

Re: Application for Unorthodox Location
Tenneco Callow #8-E
Proposed Dakota Infill Well
San Juan County, New Mexico

Gentlemen:

Attached in duplicate (to each office) are a well location plat C-102 with a sketch of the surrounding topography and an ownership plat for the above captioned Dakota infill gas well.

The Callow #8-E proposed site is 1900' FNL, 1950' FEL, Section 27, T29N-R13W, San Juan County, New Mexico. This places the well only 690' from the boundary line of the proration unit. This was the only feasible site due to the topographical conditions as sketched on the C-102.

A copy of this application is being submitted to all offset operators by certified mail with a request that they furnish your Santa Fe office with a waiver of objection.

Pursuant to authority of Rule 104-F, we respectfully request your approval of an exemption to the standard well location requirements.

Very truly yours,

TENNECO OIL COMPANY

Orig.

J. M. LACEY

J. M. Lacey

Division Production Manager

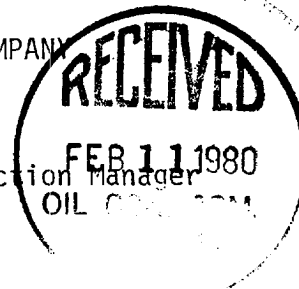

HGC/el

Enclosures

W A I V E R

_____ hereby waives objection to Tenneco Oil Company's application for unorthodox location for their Callow #8-E as proposed above.

By: _____

Date: _____

All distances must be from the outer boundaries of the Section

Operator TENNECO OIL COMPANY			Lease CALLOW		Well No. 8-E
Unit Letter G	Section 27	Township 29N	Range 13W	County San Juan	
Actual Footage Location of Wells: 1900 feet from the North line and 1950 feet from the East line					
Ground Level Elev. 5358	Producing Formation Dakota		Pool Basin Dakota		Dedicated Acreage: Acres

1. Outline the acreage dedicated to the subject well by colored pencil or hachure marks on the plat below.
2. If more than one lease is dedicated to the well, outline each and identify the ownership thereof (both as to working interest and royalty).
3. If more than one lease of different ownership is dedicated to the well, have the interests of all owners been consolidated by communitization, unitization, force-pooling, etc?

☐ Yes ☐ No If answer is "yes," type of consolidation _____

If answer is "no," list the owners and tract descriptions which have actually been consolidated. (Use reverse side of this form if necessary.) _____

No allowable will be assigned to the well until all interests have been consolidated (by communitization, unitization, forced-pooling, or otherwise) or until a non-standard unit, eliminating such interests, has been approved by the Commission.

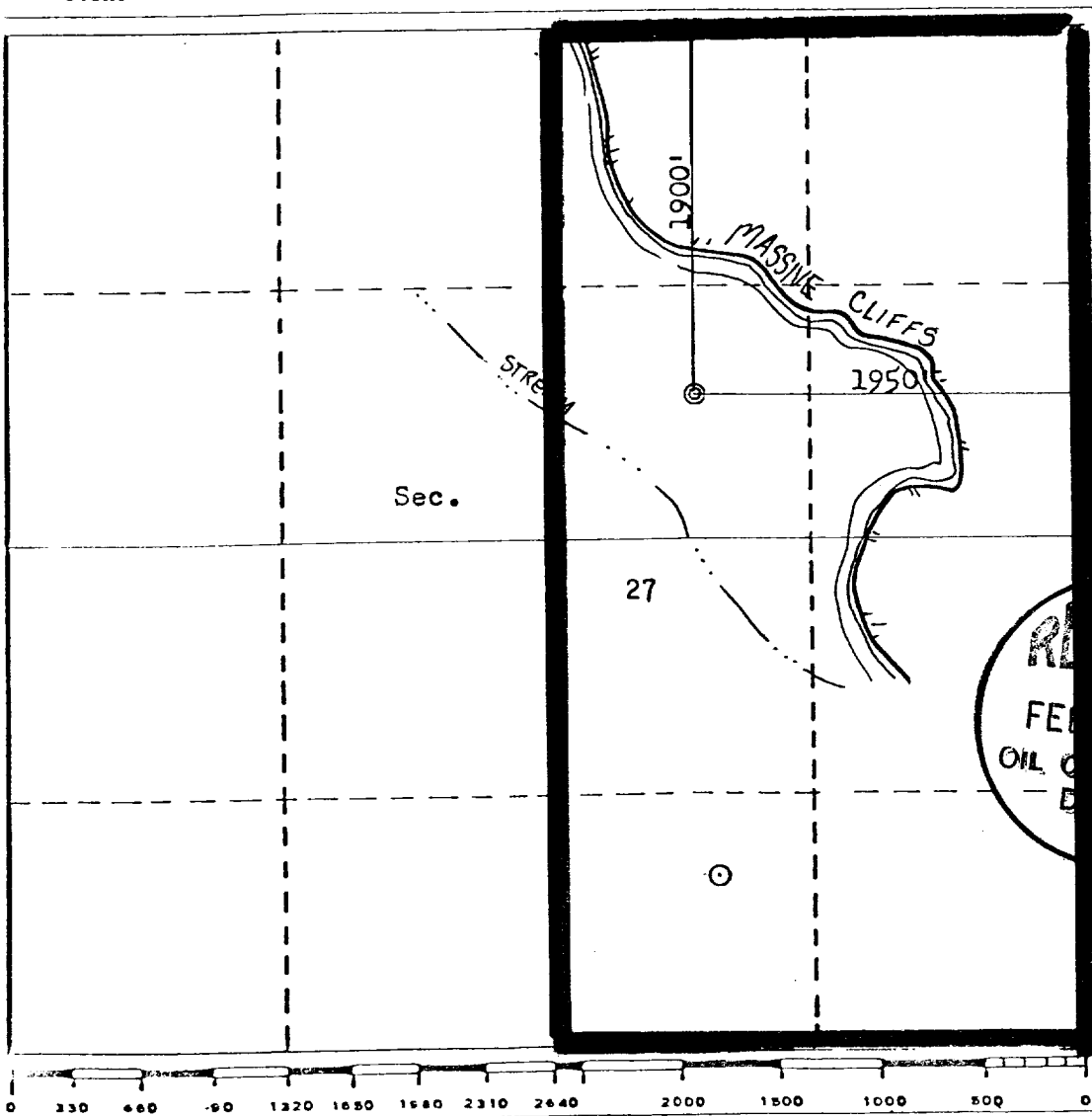

CERTIFICATION

I hereby certify that the information contained herein is true and complete to the best of my knowledge and belief.

Name _____

Position _____

Company _____

Date _____

I hereby certify that the well location shown on this plat was plotted from field notes of actual surveys made by me or under my supervision, and that the same are true and correct to the best of my knowledge and belief.

Date Surveyed _____

January 21, 1980

Registered Professional Engineer
and/or Land Surveyor

Fred B. Kerr, Jr.
Fred B. Kerr, Jr.

Certification No. B. KERR, JR.

3950

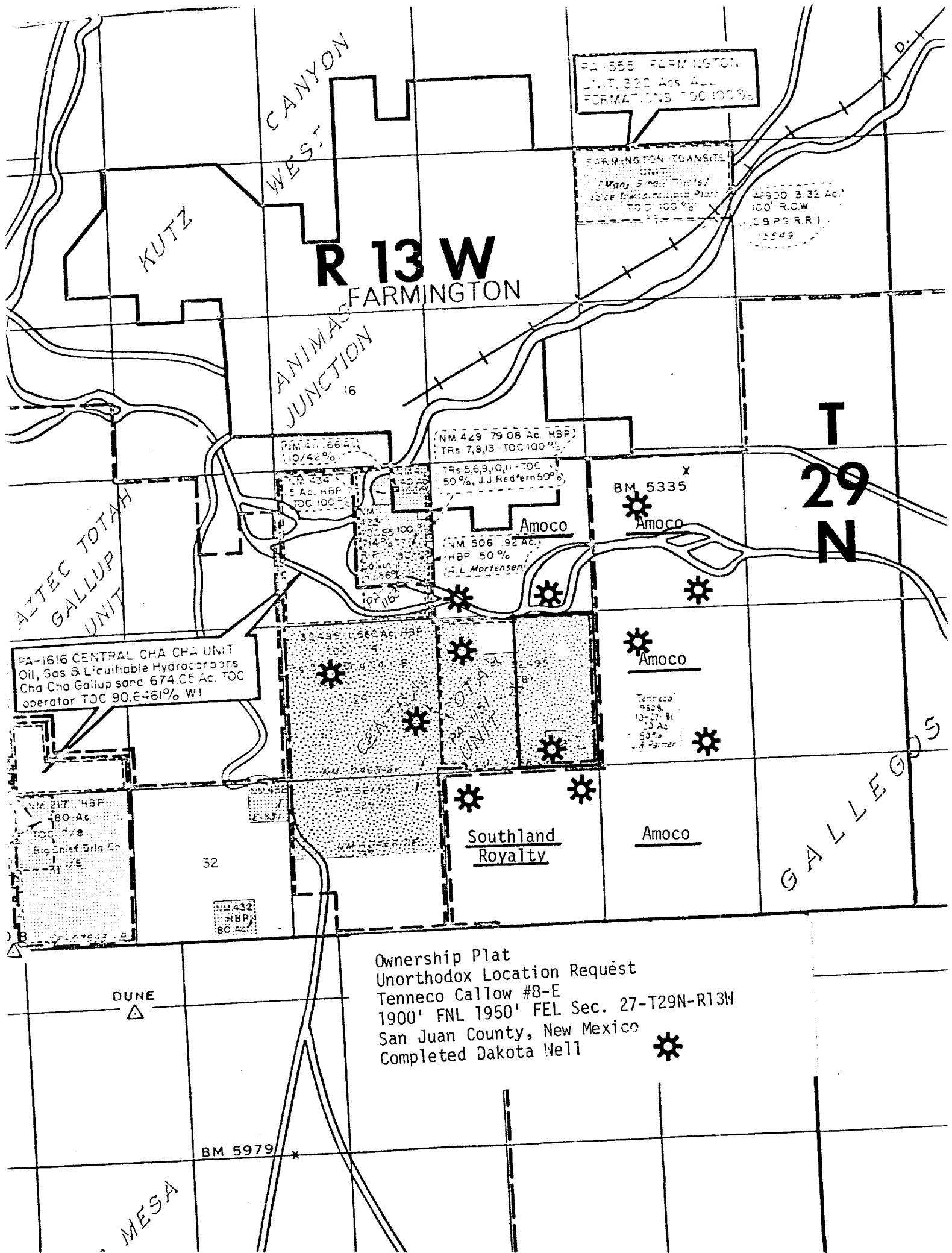

PA-555 FARMINGTON UNIT, 320 Acs. ALL FORMATIONS TOC 100%

FARMINGTON TOWNSHIP UNIT
(Many Small Tracts)
1500 Acres to Land Plat
TOC 100%

42900 3 32 Ac.
100' R.O.W.
(C&P R.R.)
19549

R 13 W
FARMINGTON

T 29 N

AZTEC TOTAH
GALLUP UNIT

PA-1616 CENTRAL CHA CHA UNIT
Oil, Gas & Liquefiable Hydrocarbons
Cha Cha Gallup sand 674.05 Ac. TOC
operator TOC 90.6461% W1

PA-217 HBP
80 Ac.
TOC 7/8
Big Chief Drig. Co.
31 1/5

32

PA-432
HBP
80 Ac.

NM 429 79 08 Ac HBP
TRs 7,8,13 - TOC 100%

TRs 5,6,9,11 - TOC
50%, J.J. Redfern 50%

Amoco

NM 506 92 Ac.
HBP 50%
L. Mortensen

BM 5335

Amoco

Amoco

Tenneco
9308
10-27-81
10 Ac
50%
J. Palmer

Southland
Royalty

Amoco

GALLUP

Ownership Plat
Unorthodox Location Request
Tenneco Callow #8-E
1900' FNL 1950' FEL Sec. 27-T29N-R13W
San Juan County, New Mexico
Completed Dakota Well

DUNE

BM 5979

MESA

MAILING LIST
APPLICATION FOR UNORTHODOX LOCATION
TENNECO - CALLOW #8-E
SAN JUAN COUNTY, NEW MEXICO

Amoco Production Company
501 Airport Road
Farmington, New Mexico 87401

Attention: J. L. Krupka

Southland Royalty Company
410 17th Street, Suite 1000
Denver, Colorado 80202

Attention: J. Zent

New Mexico Oil Conservation Division
P.O. Box 2088
Santa Fe, New Mexico 87501

Attention: J. D. Ramey

New Mexico Oil Conservation Division
1000 Rio Brazos Road
Aztec, New Mexico 87401

Attention: F. T. Chavez

OIL CONSERVATION COMMISSION
Albuquerque DISTRICT

OIL CONSERVATION COMMISSION
BOX 2088
SANTA FE, NEW MEXICO

DATE February 12, 1980

RE: Proposed MC _____
Proposed DHC _____
Proposed NSL ✓ _____
Proposed SWD _____
Proposed WFX _____
Proposed PMX _____

Gentlemen:

I have examined the application dated February 5, 1980
for the Seneca Oil Co. Callow #8E G-27-29N-13W
Operator Lease and Well No. Unit, S-T-R

and my recommendations are as follows:

Approve

Yours very truly,

Frank S. Chavez

Tenneco Oil

A Tenneco Company

Penthouse
720 South Colorado Blvd.
Denver, Colorado 80222
(303) 758-7130



CERTIFIED MAIL

Return Receipt Requested

February 5, 1980

New Mexico Oil Conservation Division
P.O. Box 2088
Santa Fe, New Mexico 87501

Attention: Mr. Joe D. Ramey

New Mexico Oil Conservation Division
1000 Rio Brazos Road
Aztec, New Mexico 87401

Attention: Mr. F. T. Chavez

Re: Application for Unorthodox Location
Tenneco Callow #8-E
Proposed Dakota Infill Well
San Juan County, New Mexico

Gentlemen:

Attached in duplicate (to each office) are a well location plat C-102 with a sketch of the surrounding topography and an ownership plat for the above captioned Dakota infill gas well.

The Callow #8-E proposed site is 1900' FNL, 1950' FEL, Section 27, T29N-R13W, San Juan County, New Mexico. This places the well only 690' from the boundary line of the proration unit. This was the only feasible site due to the topographical conditions as sketched on the C-102.

A copy of this application is being submitted to all offset operators by certified mail with a request that they furnish your Santa Fe office with a waiver of objection.

Pursuant to authority of Rule 104-F, we respectfully request your approval of an exemption to the standard well location requirements.

Very truly yours,

TENNECO OIL COMPANY

By

J. M. LACEY
J. M. Lacey

Division Product or Manager



HGC/el

Enclosures

W A I V E R

_____ hereby waives objection to Tenneco Oil Company's application for unorthodox location for their Callow #8-E as proposed above.

By: _____

Date: _____

All distances must be from the outer boundaries of the Section

Operator TENNECO OIL COMPANY			Lease CALLOW		Well No. 8-E
Unit Letter G	Section 27	Township 29N	Range 13W	County San Juan	
Actual Footage Location of Well:					
1900 feet from the North line and		1950 feet from the East line			
Ground Level Elev. 5358	Producing Formation Dakota	Pool Basin Dakota	Dedicated Acreage: Acres		

1. Outline the acreage dedicated to the subject well by colored pencil or hatchure marks on the plat below.
2. If more than one lease is dedicated to the well, outline each and identify the ownership thereof (both as to working interest and royalty).
3. If more than one lease of different ownership is dedicated to the well, have the interests of all owners been consolidated by communitization, unitization, force-pooling, etc?

☐ Yes ☐ No If answer is "yes," type of consolidation _____

If answer is "no," list the owners and tract descriptions which have actually been consolidated. (Use reverse side of this form if necessary.) _____

No allowable will be assigned to the well until all interests have been consolidated (by communitization, unitization, forced-pooling, or otherwise) or until a non-standard unit, eliminating such interests, has been approved by the Commission.

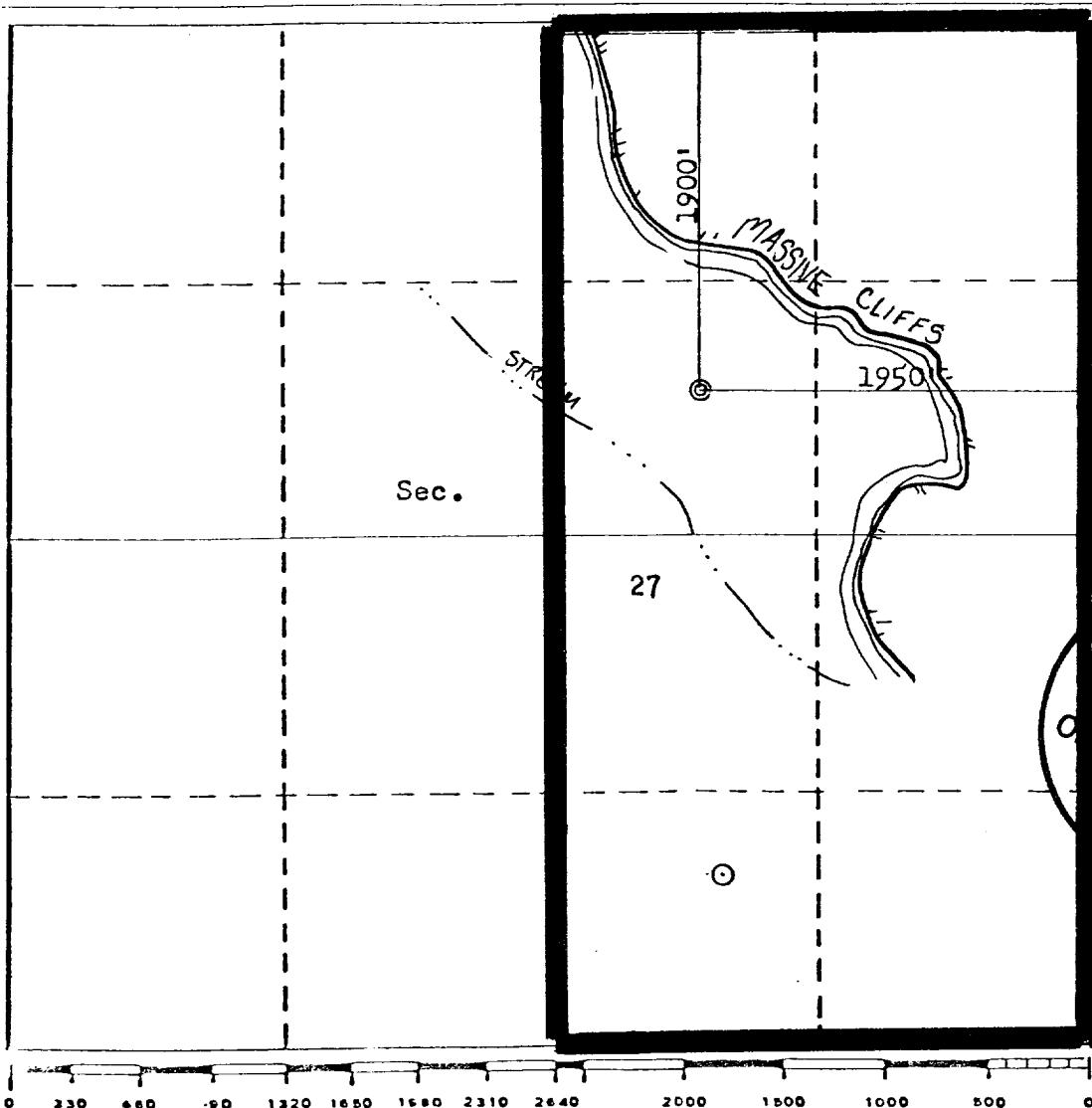

CERTIFICATION

I hereby certify that the information contained herein is true and complete to the best of my knowledge and belief.

Name _____

Position _____

Company _____

Date _____

I hereby certify that the well location shown on this plat was plotted from field notes and surveys made by me or under my supervision, and that the same is true and correct to the best of my knowledge and belief.

Date Surveyed _____

January 21, 1980
Registered Professional Engineer
and/or Land Surveyor
for N.M.

Fred B. Kerr, Jr.
Fred B. Kerr, Jr.
Certified by Fred B. Kerr, Jr.
3950

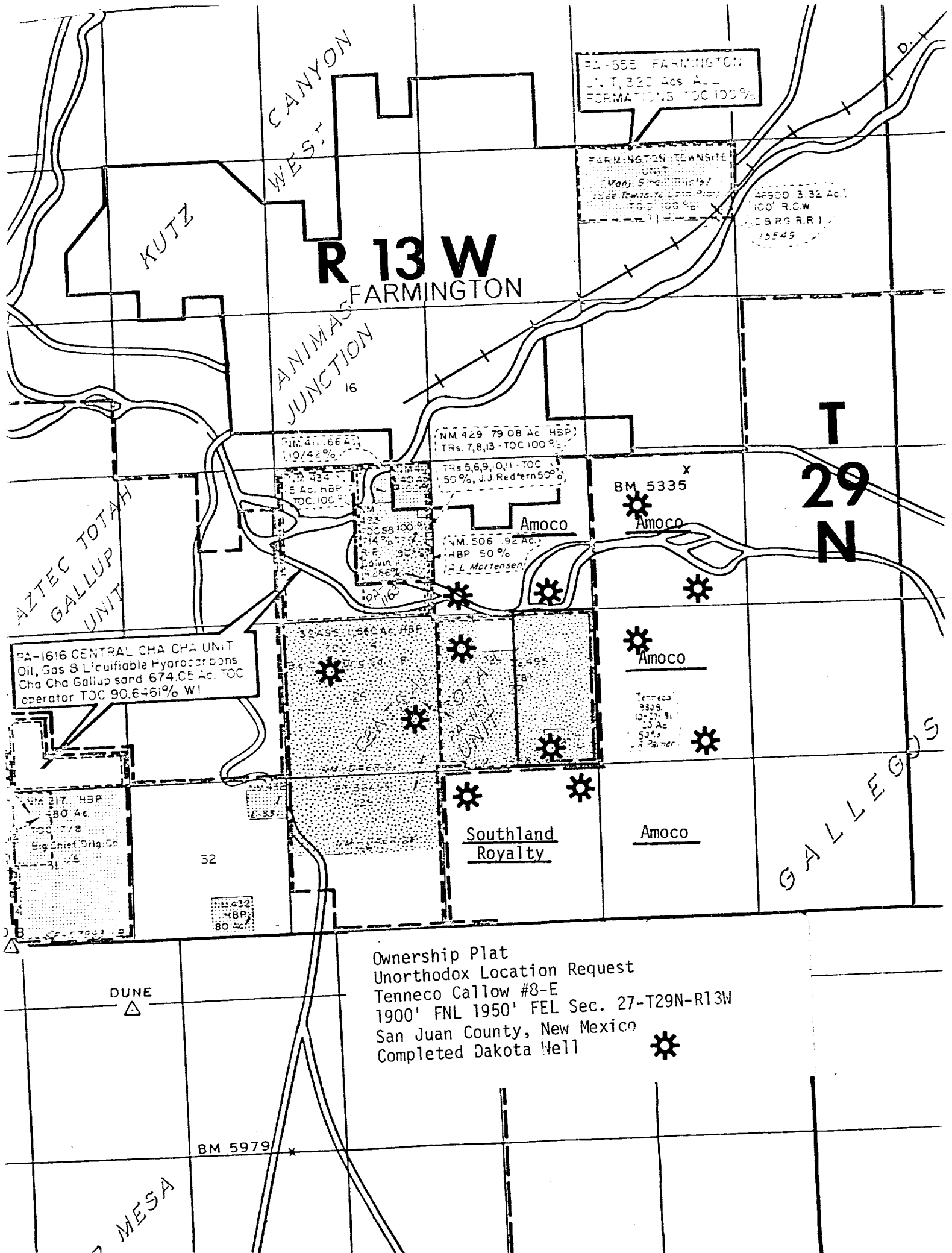

KUTZ CANYON WEST

R 13 W FARMINGTON

ANIMAS JUNCTION

T 29 N

AZTEC TOTAL GALLUP UNIT

PA-1616 CENTRAL CHA CHA UNIT
Oil, Gas & Liquefiable Hydrocarbons
Cha Cha Gallup sand 674.05 Ac. TOC
operator TOC 90.6461% WI

PA-555 FARMINGTON UNIT, 320 Ac. All FORMATIONS TOC 100%

FARMINGTON TOWNSHIP UNIT
Many Small Units!
1000 Townships Land Plat
TOC 100%

AP 900 3.32 Ac.
100' R.O.W.
C.B. & R.R.
19549

NM 429 79.08 Ac. HBP
TRs. 7,8,13 - TOC 100%

TRs 5,6,9,10,11 - TOC 50%, J.J. Redfern 50%

Amoco

NM 506 92 Ac.
HBP 50%
L. Mortensen

BM 5335

Amoco

Tenneco
9305
10-27-81
100 Ac
50%
A. Palmer

Southland Royalty

Amoco

GALLUP

Ownership Plat
Unorthodox Location Request
Tenneco Callow #8-E
1900' FNL 1950' FEL Sec. 27-T29N-R13W
San Juan County, New Mexico
Completed Dakota Well

DUNE

BM 5979

MESA

MAILING LIST
APPLICATION FOR UNORTHODOX LOCATION
TENNECO - CALLOW #8-E
SAN JUAN COUNTY, NEW MEXICO

Amoco Production Company
501 Airport Road
Farmington, New Mexico 87401

Attention: J. L. Krupka

Southland Royalty Company
410 17th Street, Suite 1000
Denver, Colorado 80202

Attention: J. Zent

New Mexico Oil Conservation Division
P.O. Box 2088
Santa Fe, New Mexico 87501

Attention: J. D. Ramey

New Mexico Oil Conservation Division
1000 Rio Brazos Road
Aztec, New Mexico 87401

Attention: F. T. Chavez