

NO. OF COPIES RECEIVED	5
DISTRIBUTION	
SANTA FE	1
FILE	1
U.S.G.S.	2
LAND OFFICE	
OPERATOR	1

NEW MEXICO OIL CONSERVATION COMMISSION

Form C-101
Revised 1-1-65

5A. Indicate Type of Lease
STATE ☐ FEE ☒

5. State Oil & Gas Lease No.

APPLICATION FOR PERMIT TO DRILL, DEEPEN, OR PLUG BACK

1a. Type of Work DRILL <input checked="" type="checkbox"/> DEEPEN <input type="checkbox"/> PLUG BACK <input type="checkbox"/>		7. Unit Agreement Name Garrett-Fed. Com.
b. Type of Well OIL WELL <input type="checkbox"/> GAS WELL <input checked="" type="checkbox"/> OTHER <input type="checkbox"/> SINGLE ZONE <input type="checkbox"/> MULTIPLE ZONE <input checked="" type="checkbox"/>		8. Form or Lease Name
2. Name of Operator Getty Oil Company		9. Well No. 1-E
3. Address of Operator Box 3360, Casper, Wyoming 82602		10. Field and Pool, or Wilson Basin Dakota & Mesaverde
4. Location of Well UNIT LETTER B LOCATED 1170 FEET FROM THE North LINE AND 1470 FEET FROM THE East LINE OF SEC. 12 TWP. 29N RGE. 11W		12. County San Juan
19. Proposed Depth 6875'		19A. Formation Dakota-Mesaverde
20. Rotary or C.T. Rotary		21. Elevation (Show whether D.P., R.T., etc.) '5828' GR
21A. Kind & Status Plug. Bond Blanket		21B. Drilling Contractor Not Known
22. Approx. Date Work will start 5-15-80		

PROPOSED CASING AND CEMENT PROGRAM

SIZE OF HOLE	SIZE OF CASING	WEIGHT PER FOOT	SETTING DEPTH	SACKS OF CEMENT	EST. TOP
14 3/4"	10 3/4"	40.5	600'	315	Surface
9 7/8"	7 5/8"	26.4	3600'	820	Surface
6 3/4"	5 1/2"	15.5	6875'	370	3600'

We propose to drill to 3600' with mud and set 7 5/8" casing. Air will be used to drill from 3600' to 6875' TD. If tests indicate commercial production in both the Mesaverde and Dakota we propose to dual complete the well.

APPROVAL VALID
FOR 90 DAYS UNLESS
DRILLING COMMENCED,

EXPIRES 7-30-80



IN ABOVE SPACE DESCRIBE PROPOSED PROGRAM; IF PROPOSAL IS TO DEEPEN OR PLUG BACK, GIVE DATA ON PRESENT PRODUCTIVE ZONE AND PROPOSED NEW PRODUCTION ZONE, GIVE BLOWOUT PREVENTER PROGRAM, IF ANY.

I hereby certify that the information above is true and complete to the best of my knowledge and belief.

Signed [Signature] Title Area Superintendent Date 4-28-80

(This space for State Use)

APPROVED BY [Signature] TITLE SUPERVISOR DISTRICT # 3 DATE MAY 1 1980

CONDITIONS OF APPROVAL, IF ANY:

30 Prie required

OIL CONSERVATION DIVISION

STATE OF NEW MEXICO
ENERGY AND MINERALS DEPARTMENTP. O. BOX 2088
SANTA FE, NEW MEXICO 87501Form C-102
Revised 10-1-78

All distances must be from the outer boundaries of the Section

Operator GETTY OIL COMPANY			Lease GARRETT-FEDERAL COM		Well No. 1-E
Unit Letter B	Section 12	Township 29N	Range 11W	County San Juan	
Actual Footage Location of Well:					
1170 feet from the North line and		1170 feet from the East line			
Ground Level Elev. 5828	Producing Formation Dakota-Mesaverde	Pool Basin Dakota-Mesaverde exf	Dedicated Acreage: 320/320 Acres		

1. Outline the acreage dedicated to the subject well by colored pencil or hatchure marks on the plat below.
2. If more than one lease is dedicated to the well, outline each and identify the ownership thereof (both as to working interest and royalty).
3. If more than one lease of different ownership is dedicated to the well, have the interests of all owners been consolidated by communitization, unitization, force-pooling, etc?

☐ Yes ☐ No If answer is "yes," type of consolidation _____

If answer is "no," list the owners and tract descriptions which have actually been consolidated. (Use reverse side of this form if necessary.) _____

No allowable will be assigned to the well until all interests have been consolidated (by communitization, unitization, forced-pooling, or otherwise) or until a non-standard unit, eliminating such interests, has been approved by the Commission.

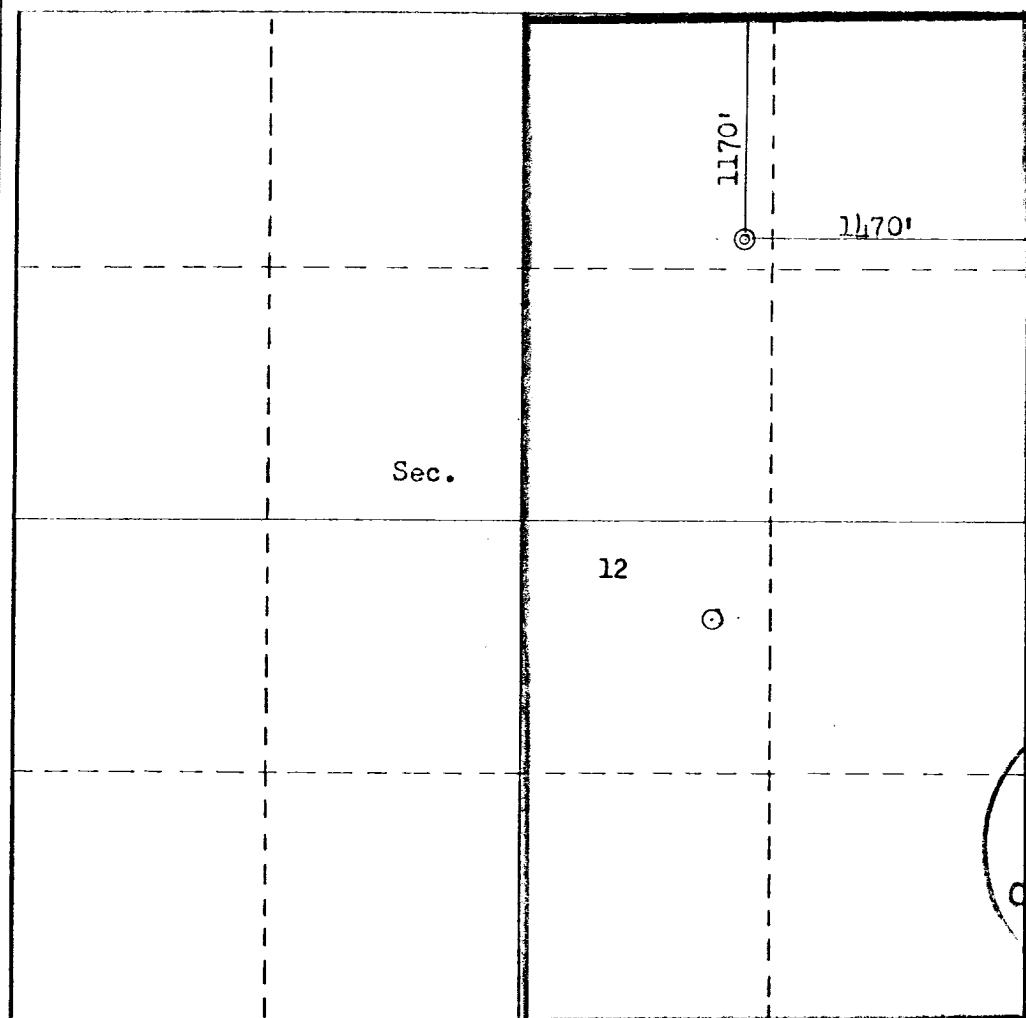

CERTIFICATION

I hereby certify that the information contained herein is true and complete to the best of my knowledge and belief.

H. E. Aab

Name

H. E. Aab

Position

Area Superintendent

Company

Getty Oil Company

Date

4-28-80

I hereby certify that the well location shown on this plat was plotted from field notes of actual surveys made by me or under my supervision, and that the same is true and correct to the best of my knowledge and belief.

