

Operator GETTY OIL COMPANY		Lease MARTIN-FEDERAL COM.		Well No. 1E	
Unit Letter J	Section 13	Township 29N	Range 11W	County San Juan	
Actual Footage Location of Well: 1450 feet from the South line and 2460 feet from the East line					
Ground Level Elev. 5601	Producing Formation Mesaverde Dakota		Pool Blanco Mesaverde basin dakota	Dedicated Acreage: 168 Acres	

1. Outline the acreage dedicated to the subject well by colored pencil or hachure marks on the plat below.
2. If more than one lease is dedicated to the well, outline each and identify the ownership thereof (both as to working interest and royalty).
3. If more than one lease of different ownership is dedicated to the well, have the interests of all owners been consolidated by communitization, unitization, force-pooling, etc?

☐ Yes ☐ No If answer is "yes," type of consolidation _____

If answer is "no," list the owners and tract descriptions which have actually been consolidated. (Use reverse side of this form if necessary.) _____

No allowable will be assigned to the well until all interests have been consolidated (by communitization, unitization, forced-pooling, or otherwise) or until a non-standard unit, eliminating such interests, has been approved by the Commission.

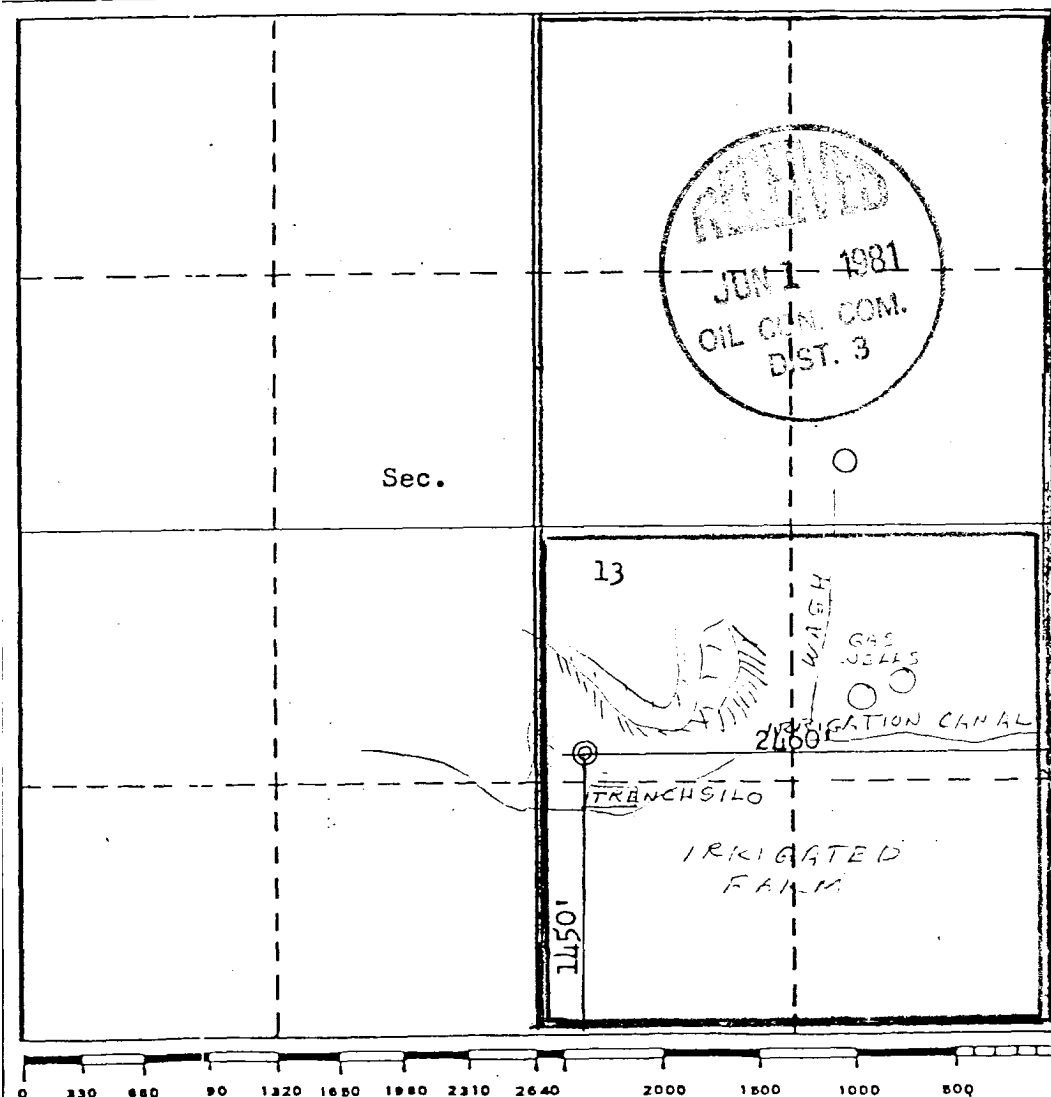

CERTIFICATION

I hereby certify that the information contained herein is true and complete to the best of my knowledge and belief.

C. E. Mowry
C. E. Mowry

Name

Area Engineer

Position

Getty Oil Company

Company

June 9, 1980

Date

I hereby certify that the well location shown on this plat was plotted from field notes of actual surveys made by me or under my supervision, and that the same is true and correct to the best of my knowledge and belief.

Date Surveyed

May 30 1980

Registered Professional Engineer
and/or Land Surveyor*Fred B. Kiersey*
Fred B. Kiersey

Certificate No.

3950