

NEW MEXICO OIL CONSERVATION COMMISSION  
 WELL LOCATION AND ACREAGE DEDICATION PLAT

Form C-102  
 Supersedes C-128  
 Effective 1-1-65

All distances must be from the outer boundaries of the Section.

Operator Pioneer Production Corporation		Lease Hartman		Well No. 1E
Unit Letter F	Section 31	Township 29 North	Range 11 West	County San Juan
Actual Footage Location of Well: 1850 feet from the North line and 1850 feet from the West line				
Ground Level Elev. 5396	Producing Formation	Pool	Dedicated Acreage: Acres	

1. Outline the acreage dedicated to the subject well by colored pencil or hachure marks on the plat below.
2. If more than one lease is dedicated to the well, outline each and identify the ownership thereof (both as to working interest and royalty).
3. If more than one lease of different ownership is dedicated to the well, have the interests of all owners been consolidated by communitization, unitization, force-pooling, etc?

Yes  No If answer is "yes," type of consolidation \_\_\_\_\_

If answer is "no," list the owners and tract descriptions which have actually been consolidated. (Use reverse side of this form if necessary.) \_\_\_\_\_

No allowable will be assigned to the well until all interests have been consolidated (by communitization, unitization, forced-pooling, or otherwise) or until a non-standard unit, eliminating such interests, has been approved by the Commission.

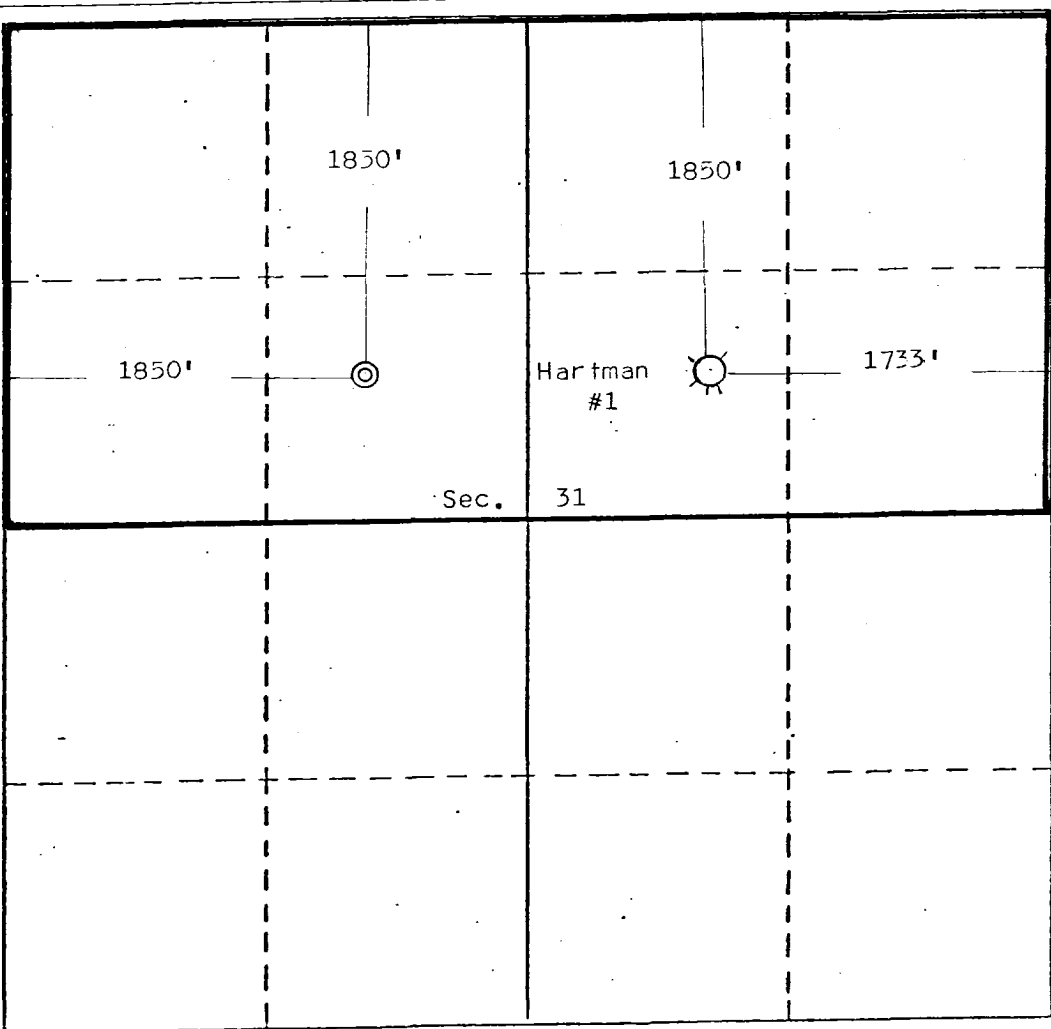

CERTIFICATION

I hereby certify that the information contained herein is true and complete to the best of my knowledge and belief.

*Thomas A. Dagan*

Name: Thomas A. Dagan  
 Position: Agent  
 Company: Pioneer Production Corp.  
 Date: 6-27-80

I hereby certify that the well location shown on this plat was obtained from field notes of actual surveys made by me or under my supervision and that the same is true and correct to the best of my knowledge and belief.

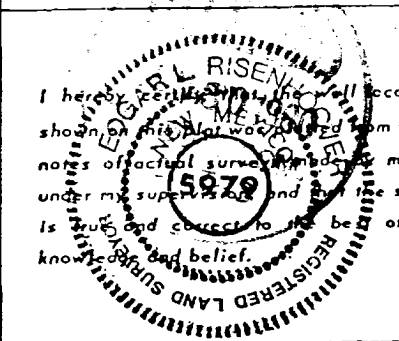

Date Surveyed: May 8, 1980  
 Registered Professional Engineer and/or Land Surveyor  
*Edgar L. Risenhoover*  
 Certificate No. 5979  
 Edgar L. Risenhoover, L.S.

