

NEW MEXICO OIL CONSERVATION LOCATION AND ACREAGE DEDICATION PLAT

Effective 1-1-63

All distances must be from the outer boundaries of the section.

Operator Pioneer Production Corporation			Lease Hartman		Well No. 1E
Unit Letter F	Section 31	Township 29 North	Range 11 West	County San Juan	

Actual Footage Location of Well:

1850	feet from the	North	line and	1850	feet from the	West	line
Ground Level Elev. 5396	Producing Formation Chacra		Pool Undesignated Chacra		Dedicated Acreage: 160		Acres

1. Outline the acreage dedicated to the subject well by colored pencil or hatchure marks on the plat below.
2. If more than one lease is dedicated to the well, outline each and identify the ownership thereof (both as to working interest and royalty).
3. If more than one lease of different ownership is dedicated to the well, have the interests of all owners been consolidated by communitization, unitization, force-pooling, etc?

☐ Yes ☐ No If answer is "yes," type of consolidation _____

If answer is "no," list the owners and tract descriptions which have actually been consolidated. (Use reverse side of this form if necessary.) _____

No allowable will be assigned to the well until all interests have been consolidated (by communitization, unitization, forced-pooling, or otherwise) or until a non-standard unit, eliminating such interests, has been approved by the Commission.

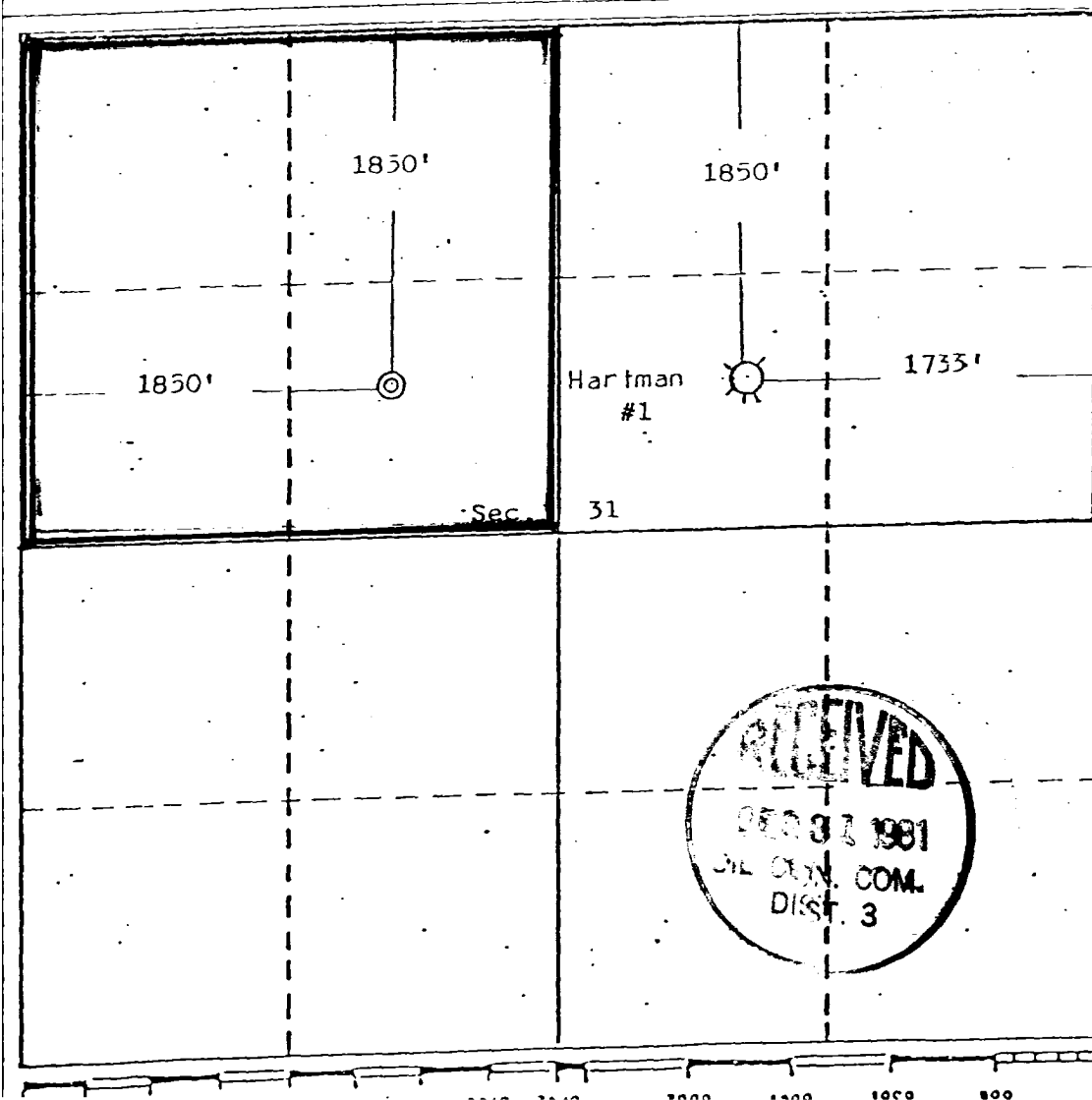

CERTIFICATION

I hereby certify that the information contained herein is true and complete to the best of my knowledge and belief.

Name
Thomas A. Dugan

Position
Agent

Company
Pioneer Production Corp.

Date
11-9-81

I hereby certify that the well location shown on this plat was obtained from field notes of actual surveys made by me or under my supervision, and that the same is true and correct to the best of my knowledge and belief.

Date Surveyed
May 8, 1980

Registered Professional Engineer and/or Land Surveyor

Edgar L. Risenhoover
Certificate No. **5979**
Edgar L. Risenhoover, L.S.