



STATE OF NEW MEXICO  
ENERGY AND MINERALS DEPARTMENT  
OIL CONSERVATION DIVISION

August 19, 1980

BRUCE KING  
GOVERNOR

LARRY KEHOE  
SECRETARY

POST OFFICE BOX 2088  
STATE LAND OFFICE BUILDING  
SANTA FE, NEW MEXICO 87501  
(505) 827-2434

Tenneco Oil  
720 South Colorado Blvd.  
Denver, Colorado 80222

Attention: Mr. J. M. Lacey

Administrative Order NSL-1246

Gentlemen:

*Payne A #1E*

Reference is made to your application for approval of a non-standard location for your ~~Elvin J. Payne Gas Unit Well~~ No. A 1-E to be located 530 feet from the South line and 2080 feet from the West line of Section 19, Township 29 North, Range 10 West, NMPM, a Dakota-Mesaverde-Chacra well, San Juan County, New Mexico.

By authority granted me under the provisions of Rule 3 of Order No. R-1670, the above-described unorthodox location is hereby approved.

Sincerely,

JOE D. RAMEY,  
Director

JDR/RLS/dr

cc: Oil Conservation Division - Aztec  
Oil & Gas Engineering Committee - Hobbs



OIL CONSERVATION COMMISSION  
DISTRICT

OIL CONSERVATION COMMISSION  
BOX 2088  
SANTA FE, NEW MEXICO

DATE 8-7-80

RE: Proposed MC \_\_\_\_\_  
Proposed DHC \_\_\_\_\_  
Proposed NSL X \_\_\_\_\_  
Proposed SWD \_\_\_\_\_  
Proposed WFX \_\_\_\_\_  
Proposed PMX \_\_\_\_\_

Gentlemen:

I have examined the application dated July 30, 1980  
for the Tenneco Oil Co. Payne A #1E  
Operator ~~Belvin E. Payne Gas Unit A1E~~ N A-29-10  
Lease and Well No. Unit, S-T-R

and my recommendations are as follows:

Approve

Yours very truly,

Richard H. Linn

# Tenneco Oil

A Tenneco Company

Penthouse  
720 South Colorado Blvd.  
Denver, Colorado 80222  
(303) 758-7130



## CERTIFIED MAIL

Return Receipt Requested

July 25, 1980

New Mexico Oil Conservation Division  
P.O. Box 2088  
Santa Fe, New Mexico 87501

Attention: Joe D. Ramey

New Mexico Oil Conservation Division  
1000 Rio Brazos Road  
Aztec, New Mexico 87401

Attention: F. T. Chavez

RE: Application for Unorthodox Location  
Tenneco Elvin J. Payne Gas Unit A1E  
Proposed Dakota/Mesaverde/Chacra Well  
San Juan County, New Mexico

Gentlemen:

Attached in duplicate (to each office) are a well location plat C-102 with a sketch of the surrounding topography and an ownership plat for the above-captioned Dakota/Mesaverde/Chacra gas well.

The Elvin J. Payne Gas Unit A1E proposed site is 530' FSL, 2080' FWL, Section 19, T29N-R10W, San Juan County, New Mexico. This places the well only 530' from the boundary lines of the quarter section. This was the only feasible site due to topographical conditions as sketched on the C-102.

A copy of this application is being submitted to all offset operators by certified mail with a request that they furnish your Santa Fe office with a waiver of objection.

Pursuant to authority of Rule 104-F, we respectfully request your approval of an exemption to the standard well location requirements.

Very truly yours,

TENNECO OIL COMPANY

  
J. M. Lacey  
Division Production Manager

EMJ:efl

Enclosures



### W A I V E R

\_\_\_\_\_ hereby waives objection to Tenneco Oil Company's application for unorthodox location for their Elvin J. Payne Gas Unit A1E as proposed above.

By: \_\_\_\_\_

Date: \_\_\_\_\_

All distances must be from the outer boundaries of the Section

|   |  |                        |   |                           |  |
|---|--|------------------------|---|---------------------------|--|
| Lessor<br><b>TENNECO OIL COMPANY</b>  |  |                        | Lease<br><b>ELVIN J. PAYNE GAS UNIT "A"</b>   |                           | Well No.<br><b>1-E</b>                         |
| Section Letter<br><b>N</b>  | Section<br><b>19</b>                                   | Township<br><b>29N</b> | Range<br><b>10W</b>                           | County<br><b>San Juan</b> |  |
| Actual Footage Location of Well:<br><b>530</b> feet from the <b>South</b> line and <b>2080</b> feet from the <b>West</b> line |  |                        |   |                           |  |
| Land Level Elev.<br><b>5476</b>   | Producing Formation<br><b>Dakota/Mesa Verde/Chacra</b> |                        | Pool<br><b>Dakota/Undesignated/Bloomfield</b> |                           | Dedicated Acreage:<br><b>320/160/160</b> Acres |

1. Outline the acreage dedicated to the subject well by colored pencil or hatchure marks on the plat below.
2. If more than one lease is dedicated to the well, outline each and identify the ownership thereof (both as to working interest and royalty).
3. If more than one lease of different ownership is dedicated to the well, have the interests of all owners been consolidated by communitization, unitization, force-pooling, etc?

☒ Yes ☐ No If answer is "yes," type of consolidation Communitization in progress

If answer is "no," list the owners and tract descriptions which have actually been consolidated. (Use reverse side of this form if necessary.) \_\_\_\_\_

No allowable will be assigned to the well until all interests have been consolidated (by communitization, unitization, forced-pooling, or otherwise) or until a non-standard unit, eliminating such interests, has been approved by the Commission.

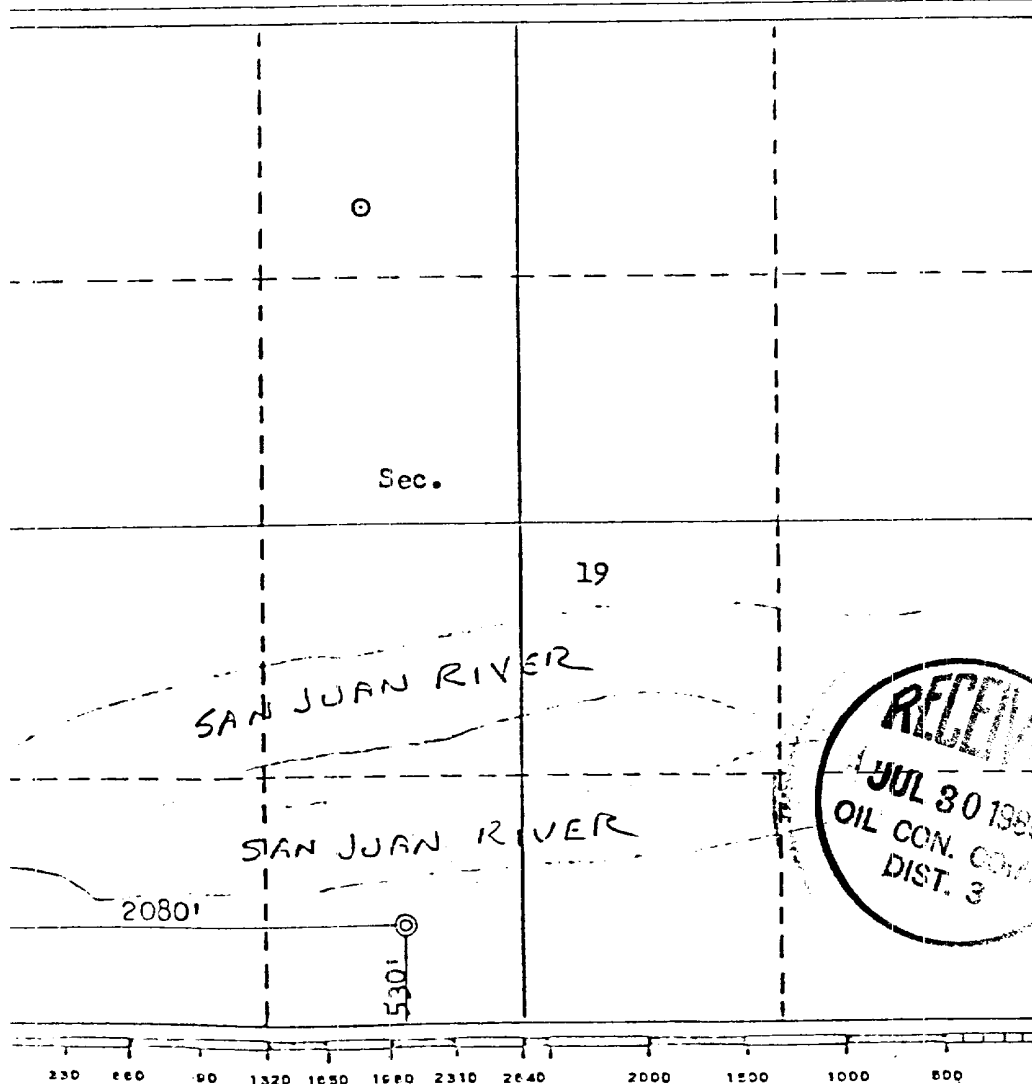
|  |  |
|--|--|
|  | <b>CERTIFICATION</b><br><br>I hereby certify that the information contained herein is true and complete to the best of my knowledge and belief.<br><br><i>M. L. Freeman</i><br>Name<br><b>M. L. Freeman</b><br>Position<br><b>Staff Production Analyst</b><br>Company<br><b>Tenneco Oil Company</b><br>Date<br><b>July 2, 1980</b>   |
|  | <br><br>I hereby certify that the well location shown on this plat was plotted from field notes of actual surveys made by me or under my supervision, and that the same is true and correct to the best of my knowledge and belief.<br><br>Date Surveyed<br><b>September 7, 1979</b><br>Registered Professional Engineer and/or Land Surveyor<br><i>Fred B. Kerr</i><br>Certified<br><b>3950</b> |

# CHACRA

# ROW

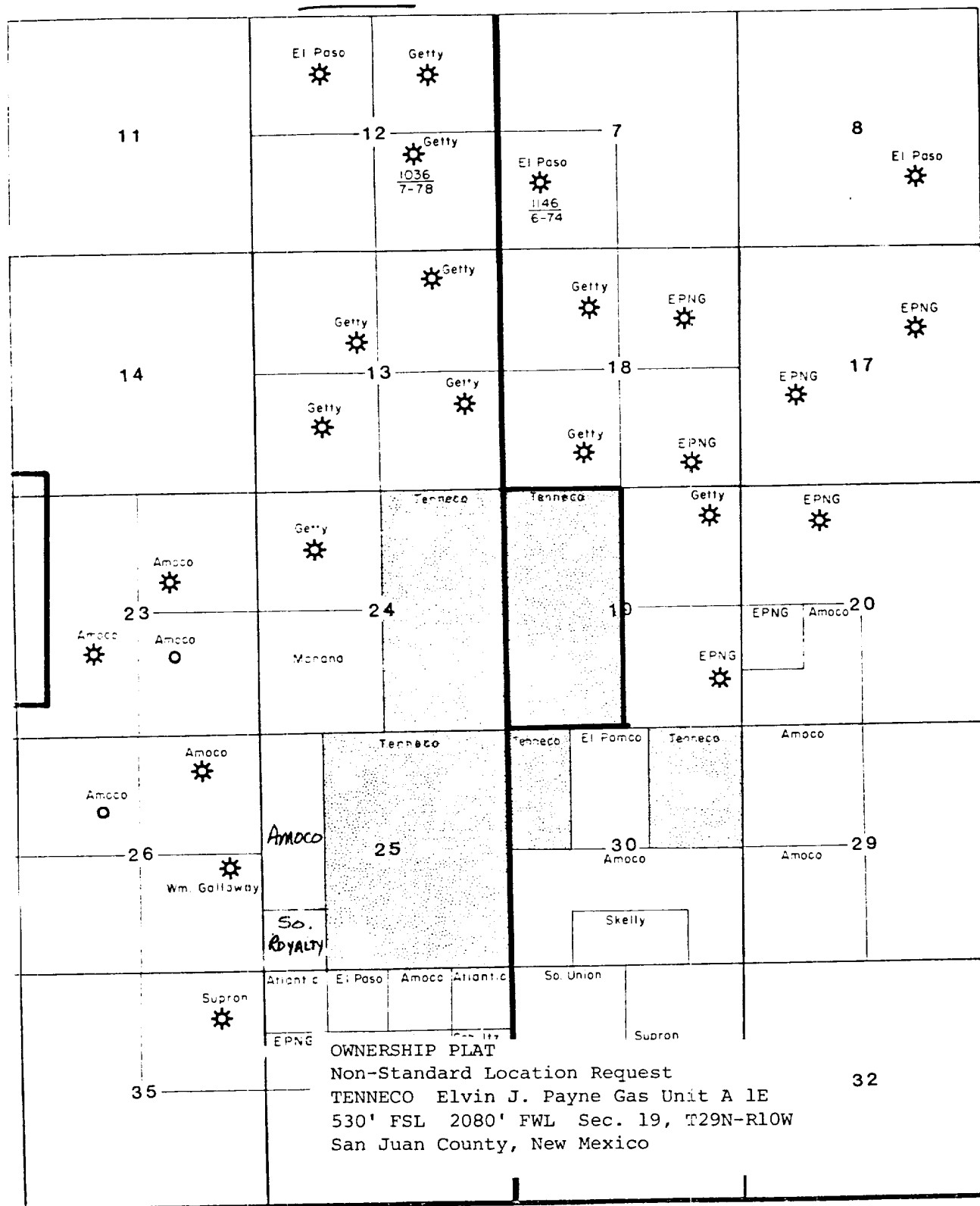

T  
29  
N

R 11 W'

R 10 W

# MESAUERDE

R 1 1 W

R 1 0 W

T  
29

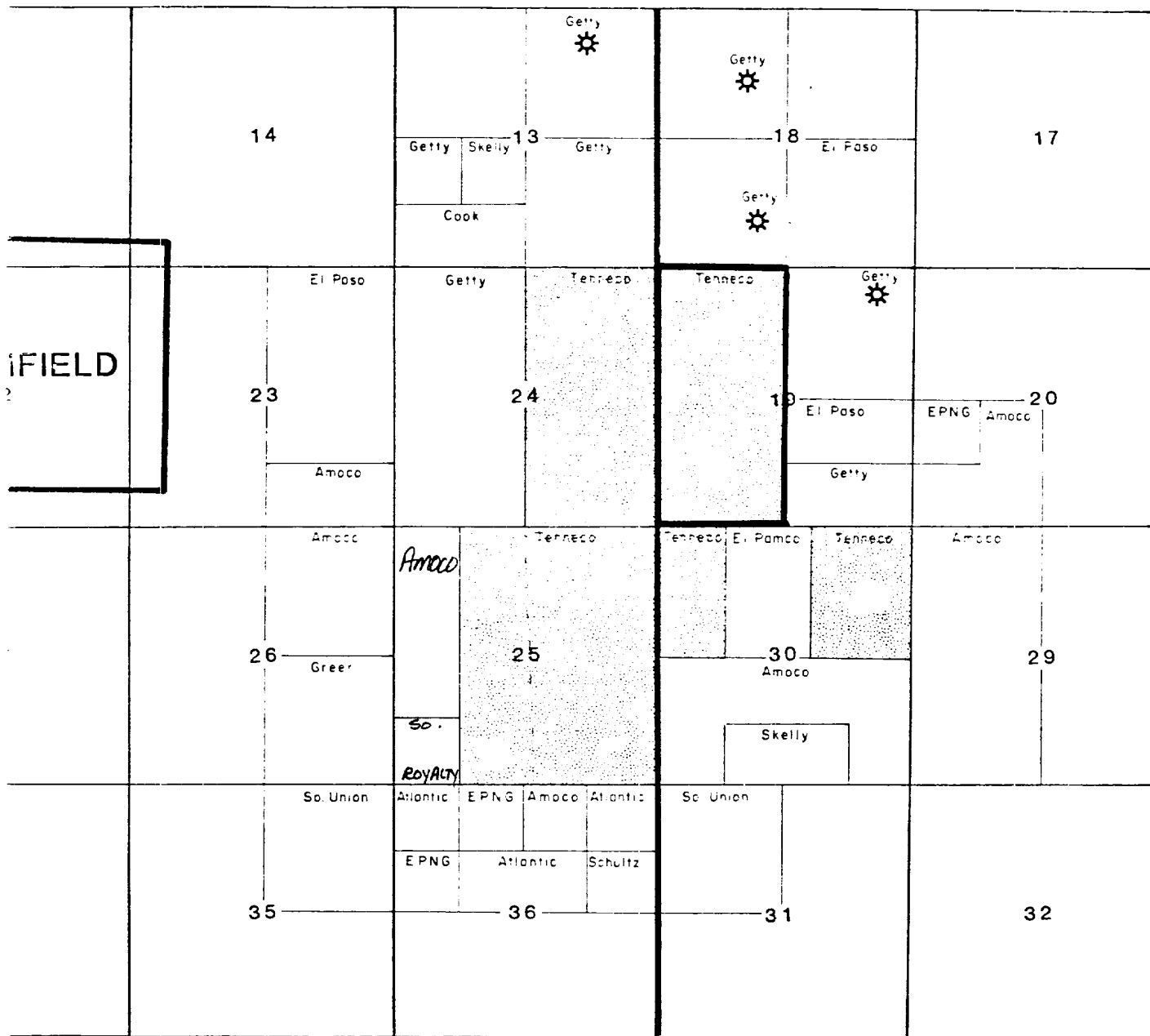

R 1 1 W

R 1 0 W

OWNERSHIP PLAT  
Non-Standard Location Request  
TENNECO Elvin J. Payne Gas Unit A 1E  
530' FSL 2080' FWL Sec. 19, T29N-R10W  
San Juan County, New Mexico



MAILING LIST  
APPLICATION FOR UNORTHODOX LOCATION  
TENNECO ELVIN J. PAYNE GAS UNIT A1E  
SAN JUAN COUNTY, NEW MEXICO

New Mexico Oil Conservation Division  
P.O. Box 2088  
Santa Fe, New Mexico 87501

Attention: Joe D. Ramey

New Mexico Oil Conservation Division  
1000 Rio Brazos Road  
Aztec, New Mexico 87401

Attention: F. T. Chavez

El Paso Natural Gas Company  
P.O. Box 1492  
El Paso, Texas 79978

Attention: R. H. Nordhausen

Getty Oil Company  
3 Park Central, Suite 700  
1515 Arapahoe  
Denver, Colorado 80202

Attention: R. B. Elkington

El Pamco  
P.O. Box 14738  
5900 Tramway Blvd. N.E.  
Albuquerque, New Mexico 87111



# Tenneco Oil

A Tenneco Company

Penthouse  
720 South Colorado Blvd.  
Denver, Colorado 80222  
(303) 758-7130



CERTIFIED MAIL

Return Receipt Requested

July 25, 1980

New Mexico Oil Conservation Division  
P.O. Box 2088  
Santa Fe, New Mexico 87501

Attention: Joe D. Ramey

New Mexico Oil Conservation Division  
1000 Rio Brazos Road  
Aztec, New Mexico 87401

Attention: F. T. Chavez

RE: Application for Unorthodox Location  
Tenneco Elvin J. Payne Gas Unit A1E  
Proposed Dakota/Mesaverde/Chacra Well  
San Juan County, New Mexico



Gentlemen:

Attached in duplicate (to each office) are a well location plat C-102 with a sketch of the surrounding topography and an ownership plat for the above-captioned Dakota/Mesaverde/Chacra gas well.

The Elvin J. Payne Gas Unit A1E proposed site is 530' FSL, 2080' FWL, Section 19, T29N-R10W, San Juan County, New Mexico. This places the well only 530' from the boundary lines of the quarter section. This was the only feasible site due to topographical conditions as sketched on the C-102.

A copy of this application is being submitted to all offset operators by certified mail with a request that they furnish your Santa Fe office with a waiver of objection.

Pursuant to authority of Rule 104-F, we respectfully request your approval of an exemption to the standard well location requirements.

Very truly yours,

TENNECO OIL COMPANY

*J. M. Lacey*  
J. M. Lacey  
Division Production Manager

EMJ:efl

Enclosures

## W A I V E R

*El Paso Natural Gas Co*  
El Paso Natural Gas Co

hereby waives objection to Tenneco Oil Company's application for unorthodox location for their Elvin J. Payne Gas Unit A1E as proposed above.

By:

Date:

*John A. Ahlman*  
8-4-80