

UNITED STATES  
DEPARTMENT OF THE INTERIOR  
GEOLOGICAL SURVEY

## APPLICATION FOR PERMIT TO DRILL, DEEPEN, OR PLUG BACK

## 1a. TYPE OF WORK

DRILL ☒DEEPEN ☐PLUG BACK ☐

## b. TYPE OF WELL

OIL  
WELL ☐GAS  
WELL ☒

OTHER

SINGLE  
ZONE ☒MULTIPLE  
ZONE ☐

## 2. NAME OF OPERATOR

SUPRON ENERGY CORPORATION

## 3. ADDRESS OF OPERATOR

P.O. Box 808, Farmingotn, New Mexico 87401

## 4. LOCATION OF WELL (Report location clearly and in accordance with any State requirements.\*)

At surface  
1120 ft./South line and 875 ft./West line

At proposed prod. zone

Same as above.

## 14. DISTANCE IN MILES AND DIRECTION FROM NEAREST TOWN OR POST OFFICE\*

1 mile south of Bloomfield, New Mexico

## 15. DISTANCE FROM PROPOSED\*

LOCATION TO NEAREST  
PROPERTY OR LEASE LINE, FT.  
(Also to nearest drlg. unit line, if any) 875 ft.

## 16. NO. OF ACRES IN LEASE

1183.91

18. DISTANCE FROM PROPOSED LOCATION\*  
TO NEAREST WELL, DRILLING, COMPLETED,  
OR APPLIED FOR, ON THIS LEASE, FT.

340 ft.

## 19. PROPOSED DEPTH

2880 ft.

17. NO. OF ACRES ASSIGNED  
TO THIS WELL

160.00 SW 1/4

## 20. ROTARY OR CABLE TOOLS

Rotary

## 21. ELEVATIONS (Show whether DF, RT, GR, etc.)

5528 GR.

## 22. APPROX. DATE WORK WILL START\*

August 20, 1980

## 23.

## PROPOSED CASING AND CEMENTING PROGRAM

SIZE OF HOLE	SIZE OF CASING	WEIGHT PER FOOT	SETTING DEPTH	QUANTITY OF CEMENT
9-7/8"	7-5/8"	26.40	200 ft.	100 sx circulated
6-3/4"	2-7/8"	6.50	2880 ft.	350 sx

This action is subject to administrative  
appeal pursuant to 30 CFR 290.

We propose to drill this well through the Chacra zone to a T.D. of + 2900 ft. using mud as a circulating medium. 7-5/8" casing will be set at + 200 ft. and will be landed and cemented back to surface. 2-7/8", 6.50# tbg. will be run and cemented as a production casing string. The casing will be tested, perforated and the Chacra zone fractured. The well will be cleaned up, tested and the wellhead nipped down. The well will be tested and connected to a gathering line.

This well will be drilled on acreage dedicated to a gas transporter.

RECEIVED

JUL 25 1980

U. S. GEOLOGICAL SURVEY  
FARMINGTON, N. M.

IN ABOVE SPACE DESCRIBE PROPOSED PROGRAM: If proposal is to deepen or plug back, give data on present productive zone and proposed new productive zone. If proposal is to drill or deepen directionally, give pertinent data on subsurface locations and measured and true vertical depths. Give blowout preventer program, if any.

## 24.

SIGNED

Rudy B. Motto

TITLE

Area Superintendent

DATE July 29, 1980

(This space for Federal or State office use)

PERMIT NO.

APPROVAL DATE

APPROVED BY

TITLE

DATE

CONDITIONS OF APPROVAL, IF ANY:

NMOCC

All distances must be from the outer boundaries of the Section.

Operator <b>SUPRON ENERGY CORPORATION</b>			Lease <b>GARLAND</b>		Well No. <b>3</b>
Unit Letter <b>M</b>	Section <b>27</b>	Township <b>29 NORTH</b>	Range <b>11 WEST</b>	County <b>SAN JUAN</b>	
Actual Postage Location of Well: <b>1120</b> feet from the <b>SOUTH</b> line and <b>875</b> feet from the <b>WEST</b> line					
Ground Level Elev. <b>5528</b>	Producing Formation <b>Chacra</b>	Pool <b>Bloomfield Chacra Extension</b>		Dedicated Acreage <b>SW 1/4 160.00</b> Acres	

1. Outline the acreage dedicated to the subject well by colored pencil or hatchure marks on the plat below.
2. If more than one lease is dedicated to the well, outline each and identify the ownership thereof (both as to working interest and royalty).
3. If more than one lease of different ownership is dedicated to the well, have the interests of all owners been consolidated by communitization, unitization, force-pooling, etc?  
☐ Yes ☐ No If answer is "yes," type of consolidation \_\_\_\_\_  
 If answer is "no," list the owners and tract descriptions which have actually been consolidated. (Use reverse side of this form if necessary.) \_\_\_\_\_  
 No allowable will be assigned to the well until all interests have been consolidated (by communitization, unitization, forced-pooling, or otherwise) or until a non-standard unit, eliminating such interests, has been approved by the Division.

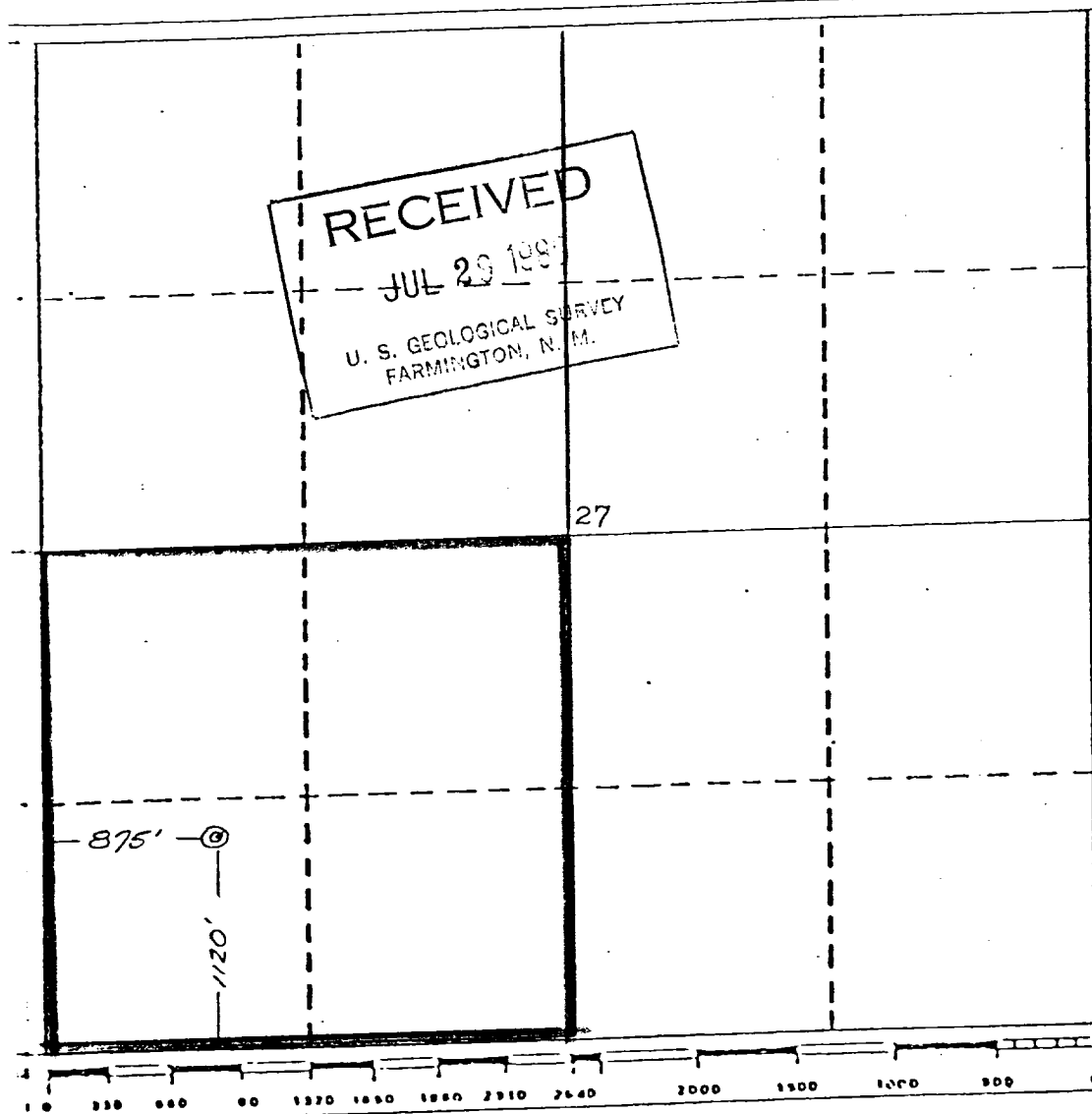

**CERTIFICATION**

I hereby certify that the information contained herein is true and complete to the best of my knowledge and belief.

*Rudy D. Motto*  
Name  
**Rudy D. Motto**  
Position  
**Area Superintendent**  
Company  
**SUPRON ENERGY CORPORATION**  
Date  
**July 23, 1980**

I hereby certify that the well location shown on this plat **NO** plotted from field notes or actual survey made by me or under my supervision, and that the same is true and correct to the best of my knowledge and belief.

**STATE OF NEW MEXICO**  
**REGISTERED PROFESSIONAL ENGINEER & LAND SURVEYOR**  
**JAMES P. LEASE**

Date Surveyed  
**June 20, 1980**  
Registered Professional Engineer and/or Land Surveyor  
*James P. Lease*  
**James P. Lease**  
Certificate No.  
**1463**

SUPRON ENERGY CORPORATION  
GARLAND No. 3  
1120 ft./South line and 895 ft./West  
Sec. 27, T-29N, R-11W, NMPM  
San Juan County, New Mexico

1. The Geologic name of the surface formation is "Wasatch".
2. The estimated tops of important Geologic markers are:

A. Top of the Ojo Alamo	439 ft.
B. Top of the Fruitland	1422 ft.
C. Top of the Pictured Cliffs	1676 ft.
D. Top of the Chacra	2680 ft.
3. The estimated depth at which anticipated water, oil or other mineral bearing formations are expected to be encountered are:

A. Top of the Ojo Alamo	439 ft.	Water
B. Top of the Fruitland	1422 ft.	Water
C. Top of the Pictured Cliffs	1676 ft.	Gas
D. Top of the Chacra	2680 ft.	Gas
4. The casing program is shown on form 9-331C and all casing is new.
5. The lessee's pressure control equipment schematics are attached along with minimum specifications, testing procedures and frequencies.
6. The type, estimated volumes and characteristics of the circulating medium are as follows:

A. 0 to 200 ft.	Natural Mud
B. 200 to 2880 ft.	Permaloid non dispersed mud containing approx. 67 sx of Permaloid and 10 sx of C.M.C.
7. The auxiliary equipment will be floats at the bit and a sub on the floor with a full opening valve to be stabbed into the drill pipe when the kelly is not in the string.
8. This well is in area which is heavily developed; therefore we will not have a testing or coring program. The logging program is as follows:

A. E.S. Induction
B. Gamma Ray Density
C. Gamma Ray Correlation
D. Cement Bond or Temperature
9. We do not expect to find any abnormal pressures, temperatures or hydrogen sulfide problems in this heavily developed area.
10. The anticipated starting date for this well is August 20, 1980.

United States Department of the Interior  
Geological Survey  
P.O. Box 959  
Farmington, New Mexico 87401

Attention: Mr. Mr. James Sims  
District Oil and Gas Supervisor

Dear Sir:

Supron Energy Corporation proposes to drill the Garland No. 3 well located 1120 feet from the South line and 875 feet from the West line of Section 27, Township 29 North, Range 11 West, N.M.P.M., San Juan County, New Mexico.

The following attachments are included with this application:

1. Map of existing roads.
2. No access road is needed.
3. Location of existing wells.
4. Lateral roads to well location.
5. Location of surface equipment if required.
6. Drilling and completion water will be obtained from the San Juan River.
7. Waste will be disposed of by being placed in the reserve pit and buried upon completion of the well.
8. There will be no camp at or near the well site.
9. There will be no air strip.
10. A plat is attached showing the location of the rig, mud tanks, reserve pit, burn pit and ect.
11. A letter of certification is attached. The operator representative, for compliance purposes, is Rudy D. Motto, Area Superintendent, P.O. Box 808, Farmington, New Mexico 87401. Phone (505) 325-3587.
12. After the well is completed the location will be cleaned up and bladed. The reserve pit will be allowed to dry then it will be filled and restored to its natural state.
13. The soil is sandy loam with the principal vegetation being Indian ricegrass, greasewood, snakeweed and brome.



# LOCATION AND EQUIPMENT LAYOUT

SUPRON ENERGY CORPORATION

GARLAND NO. 3

1120 Ft./South; 875 Ft./West line  
Sec. 27, T-29N, R-11W, N.M.P.M.,  
San Juan County, New Mexico

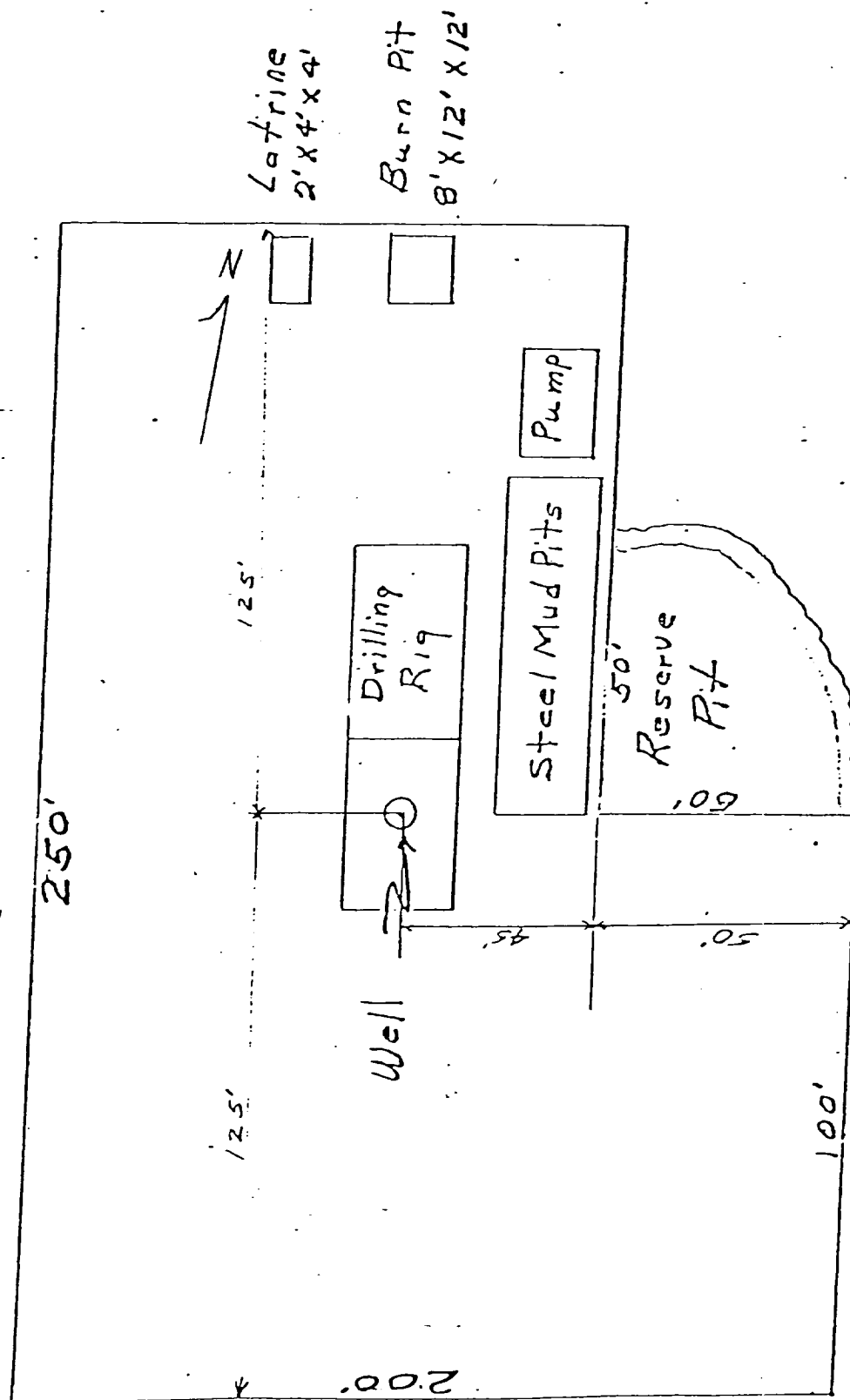

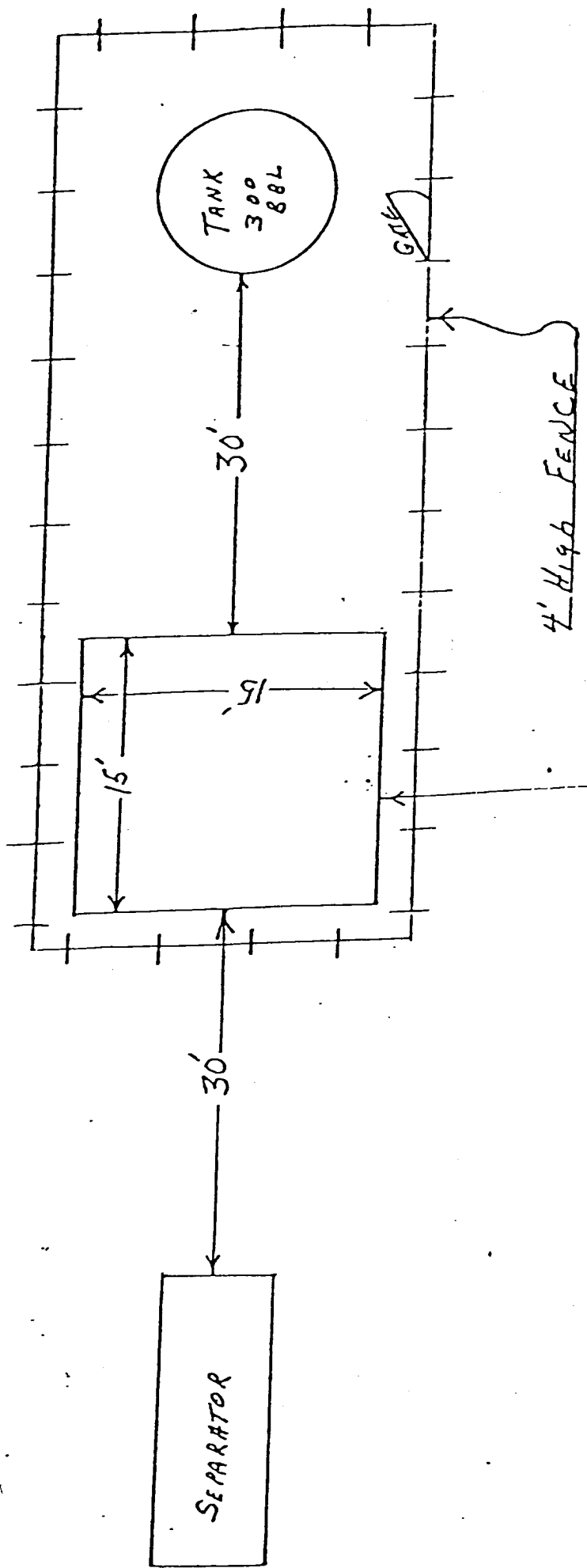

Blowout Preventer will be tested daily and prior to drilling out with the results to be logged on the drillers report.

The B.O.P. and all valve and fittings are rated at 3000 psi working pressure, and hydraulically operated

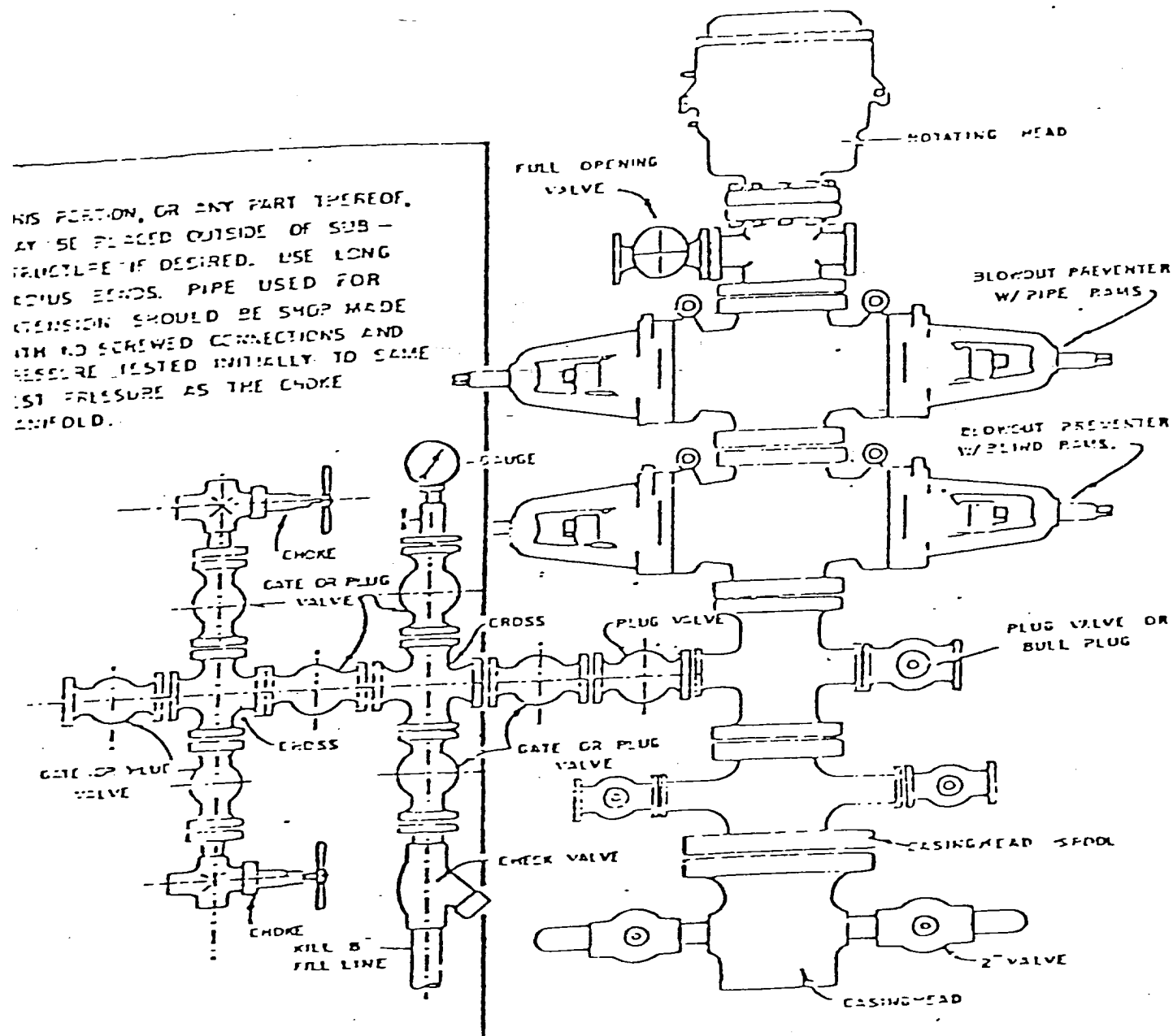

BLOWOUT PREVENTER HOOKUP



SUPRON ENERGY CORPORATION  
Post Office Box 808  
FARMINGTON, New MEXICO 87401

I hereby certify that I, or persons under my direct supervision, have inspected the proposed drillsite and access route; that I am familiar with the conditions which presently exist; that the statements made in this plan are, to the best of my knowledge, true and correct; and, that the work associated with the operations proposed herein will be performed by SUPRON ENERGY CORPORATION and its contractors subcontractors in conformity with this plan and the terms and conditions under which it is approved.

SUPRON ENERGY CORPORATION



Rudy D. Motto  
Area Superintendent  
Phone: 325-3587