

SANTA FE		
FILE		
U.S.G.S.		
LAND OFFICE		
OPERATOR		

Revised 1-1-65

5A. Indicate Type of Lease	
STATE <input type="checkbox"/>	FEE <input checked="" type="checkbox"/>

5. State Oil & Gas Lease No.

APPLICATION FOR PERMIT TO DRILL, DEEPEN, OR PLUG BACK

1a. Type of Work		7. Unit Agreement Name	
b. Type of Well OIL WELL <input type="checkbox"/> GAS WELL <input checked="" type="checkbox"/> OTHER <input type="checkbox"/> DRILL <input checked="" type="checkbox"/> DEEPEN <input type="checkbox"/> PLUG BACK <input type="checkbox"/>		8. Farm or Lease Name Ransom	
2. Name of Operator Manana Gas, Inc.		9. Well No. 1M	
3. Address of Operator Box 145, Farmington, NM 87401 (505) 325-3066		10. Field and Pool or Well Unit Aztec Fruitland and Aztec Pictured Cliffs	
4. Location of Well UNIT LETTER <u>O</u> LOCATED <u>1240</u> FEET FROM THE <u>South</u> LINE AND <u>2435</u> FEET FROM THE <u>East</u> LINE OF SEC. <u>13</u> TWP. <u>29N</u> RGE. <u>11W</u> NMPM		11. Section and Range <u>1300 + 160</u>	
12. County San Juan		13. Formation Pictured Cliffs	
14. Proposed Depth 2000'		15. Rotary or C.T. Rotary	
21. Elevations (Show whether DF, RT, etc.) 2435 <u>JS-81</u>		22. Approx. Date Work will start November 7, 1980	
21A. Kind & Status Plug. Bond Blanket		21B. Drilling Contractor Lee Wilson	

PROPOSED CASING AND CEMENT PROGRAM

SIZE OF HOLE	SIZE OF CASING	WEIGHT PER FOOT	SETTING DEPTH	SACKS OF CEMENT	EST. TOP
7	5 1/2	15.5	100	100	Surface
4 3/4	2 7/8	6.5	1970	200	Surface

This well will be logged and if productive, new casing will be run, cemented, and perforated. The formation will be fracture treated.

Bag type, 3000 psi BOP equipment will be used after the surface casing is set and until the well is completed.

The gas is dedicated.

APPROVAL VALID
FOR 90 DAYS UNLESS
DRILLING COMMENCED,

EXPIRES 2-3-81

IN ABOVE SPACE DESCRIBE PROPOSED PROGRAM: IF PROPOSAL IS TO DEEPEN OR PLUG BACK, GIVE DATA ON PRESENT PRODUCTIVE ZONE AND PROPOSED NEW PRODUCTIVE ZONE. GIVE BLOWOUT PREVENTER PROGRAM, IF ANY.

I hereby certify that the information above is true and complete to the best of my knowledge and belief.

Signed Al R. Kendrick Title Vice President Date 11/3/80

(This space for State Use)

APPROVED BY 3rd J. Day TITLE SUPERVISOR DISTRICT # 3 DATE NOV 5 1980

CONDITIONS OF APPROVAL, IF ANY:

Hold
C-104 flow
NSC

All distances must be from the outer boundaries of the Section.

Operator MANANA GAS, INCORPORATED			Lease RANSOM			Well No. 1M		
Unit Letter 0	Section 13	Township 29N	Range 11W	County San Juan				
Actual Footage Location of Wells: 1240 feet from the South line and 2435 feet from the East line								
Ground Level Elev. 5581		Producing Formation Fruitland Pictured Cliffs		Pool Aztec Aztec		Dedicated Acreage 160 / 160 Acres		

1. Outline the acreage dedicated to the subject well by colored pencil or hatchure marks on the plat below.
2. If more than one lease is dedicated to the well, outline each and identify the ownership thereof (both as to working interest and royalty).
3. If more than one lease of different ownership is dedicated to the well, have the interests of all owners been consolidated by communitization, unitization, force-pooling, etc?

☐ Yes ☐ No If answer is "yes," type of consolidation _____

If answer is "no," list the owners and tract descriptions which have actually been consolidated. (Use reverse side of this form if necessary.) _____

No allowable will be assigned to the well until all interests have been consolidated (by communitization, unitization, forced-pooling, or otherwise) or until a non-standard unit, eliminating such interests, has been approved by the Commission.

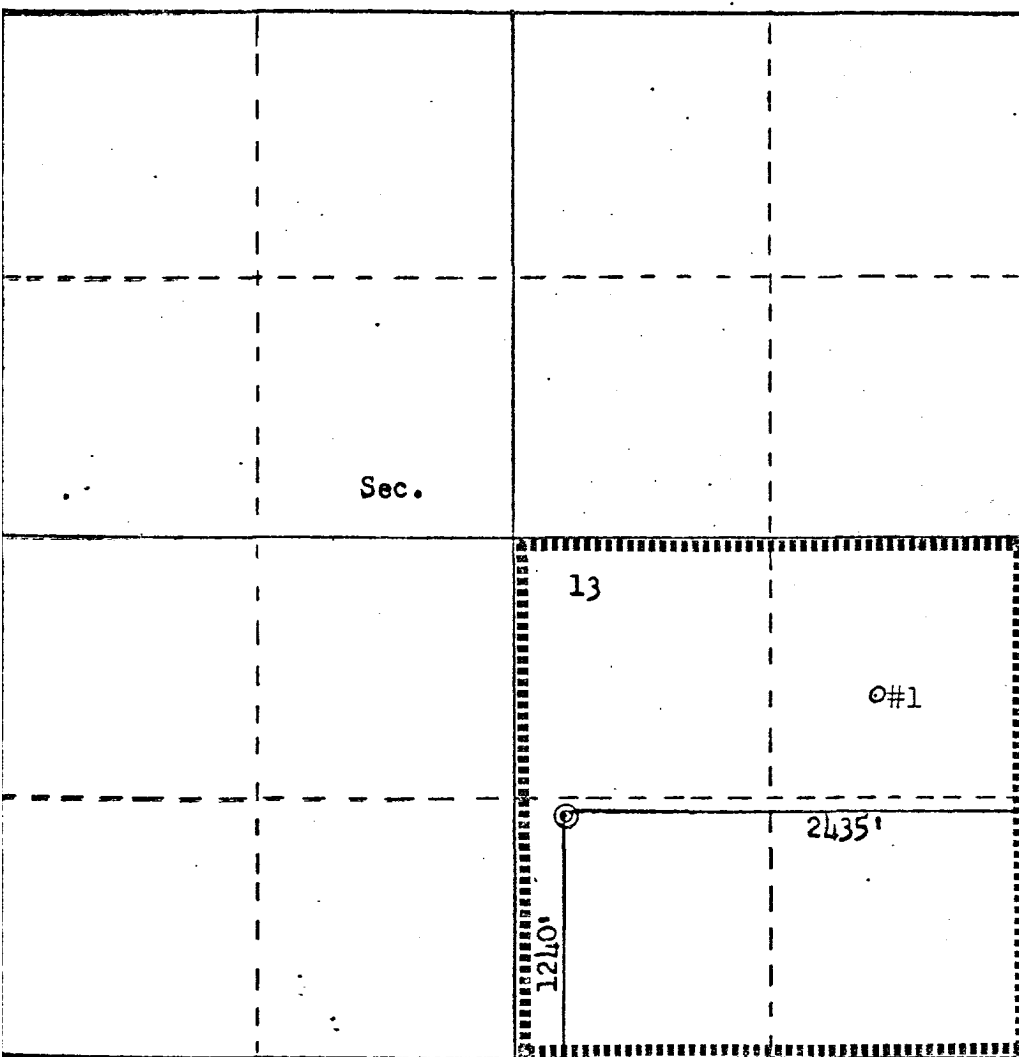

Scale: 1"=1000'

CERTIFICATION

I hereby certify that the information contained herein is true and complete to the best of my knowledge and belief.

Name
Art Kendrick
Position
Vice President
Company
Manana Gas, Inc.
Date
10/22/80

I hereby certify that the well location shown on this plat was plotted from field notes of actual surveys made by me or under my supervision, and that the same is true and correct to the best of my knowledge and belief.

Date Surveyed
October 22, 1980
Registered Professional Engineer and Land Surveyor
Fred B. Kerr Jr.
Fred B. Kerr Jr.
Certificate No. FERR, JR.
3950