

All distances must be from the outer boundaries of the Section.

Operator S & I OIL COMPANY			Lease Bob-Blanche		Well No. No. 1
Unit Letter L	Section 12	Township 29N	Range 15W	County San Juan	
Actual Footage Location of Well:					
1830		feet from the South	line and 660	feet from the West	line
Ground Level Elev. 5176	Producing Formation Gallup		Pool Cha Cha Gallup	Dedicated Acreage: 80	

1. Outline the acreage dedicated to the subject well by colored pencil or hachure marks on the plat below.
2. If more than one lease is dedicated to the well, outline each and identify the ownership thereof (both as to working interest and royalty).
3. If more than one lease of different ownership is dedicated to the well, have the interests of all owners been consolidated by communitization, unitization, force-pooling, etc?

☒ Yes ☐ No If answer is "yes," type of consolidation Farmout Agreement, Exhibit "A"
Pooled Unit Agreement Exhibit "B"

If answer is "no," list the owners and tract descriptions which have actually been consolidated. (Use reverse side of this form if necessary.) See Attached Exhibit A and B

No allowable will be assigned to the well until all interests have been consolidated (by communitization, unitization, forced-pooling, or otherwise) or until a non-standard unit, eliminating such interests, has been approved by the Division

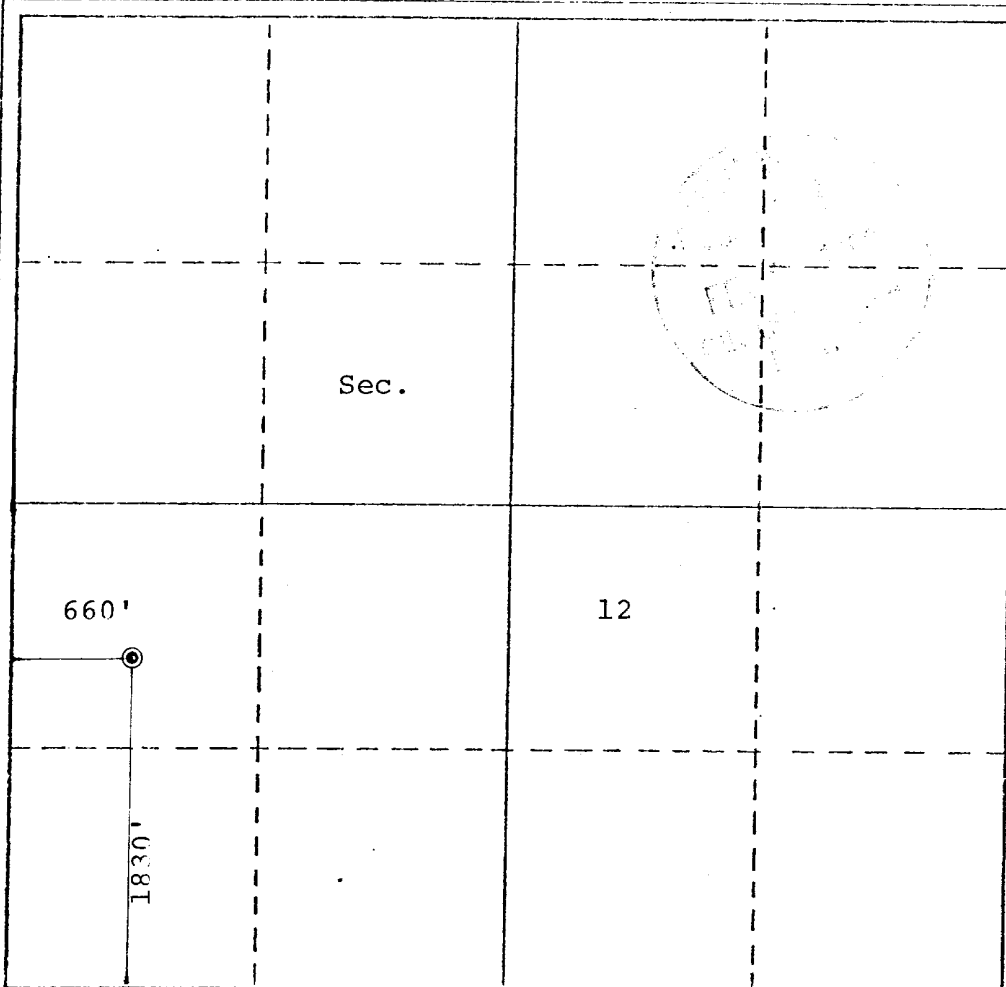

CERTIFICATION

I hereby certify that the information contained herein is true and complete to the best of my knowledge and belief.

FOR: **S & I OIL COMPANY**

Damon L. Weems
Position

Attorney

Company

Weems, Birdsall & Assoc.

Date

2/1/82

I hereby certify that the well location shown on this plat was plotted from field notes of actual surveys made by me or under my supervision, and that the same is true and correct to the best of my knowledge and belief.

Date Survey

10-1-80
Registered Professional Engineer
and/or Land Surveyor

Certificate No.

3950

0 500 660 90 1320 1680 1940 2300 2660 2000 1500 1000 500 0

DISTRIBUTION	
CONTACT	
FILE	
U.S.G.S.	
LAND OFFICE	
TRANSPORTER	OIL GAS
OPERATOR	
PRODUCTION OFFICE	

NEW MEXICO OIL CONSERVATION COMMISSION
REQUEST FOR ALLOWABLE
1981
AUTHORIZATION TO TRANSPORT OIL AND NATURAL GAS

Form C-104
Supersedes Old C-104 and C-1
Effective 1-1-85

B.R.

Operator S & I OIL COMPANY	
Address 413 W. Main Street Farmington, New Mexico 87401	
Reason(s) for filing (check proper box)	
New Well <input checked="" type="checkbox"/>	Change in Transporter of:
Recompletion <input type="checkbox"/>	Oil <input type="checkbox"/> Dry Gas <input type="checkbox"/>
Change in Ownership <input type="checkbox"/>	Casinghead Gas <input type="checkbox"/> Condensate <input type="checkbox"/>
Other (Please explain)	

If change of ownership give name and address of previous owner _____

II. DESCRIPTION OF WELL AND LEASE

Lease Name Bob Blanche	Well No. 1	Pool Name, Including Formation Cha Cha Gallup	Kind of Lease State, Federal or Fee	Fee	Lease No.
Location					
Unit Letter L	1830'	Feet From The South Line and 660	Feet From The West		
Line of Section 12	Township 29N	Range 15W	NMPM,	San Juan	County

III. DESIGNATION OF TRANSPORTER OF OIL AND NATURAL GAS

Name of Authorized Transporter of Oil <input checked="" type="checkbox"/> or Condensate <input type="checkbox"/> Giant Refining Company	Address (Give address to which approved copy of this form is to be sent) P.O. Box 256 Farmington, N.M. 87401					
Name of Authorized Transporter of Casinghead Gas <input type="checkbox"/> or Dry Gas <input type="checkbox"/> El Paso Natural Gas Company	Address (Give address to which approved copy of this form is to be sent) P.O. Box 990 Farmington, N.M. 87401					
If well produces oil or liquids, give location of tanks.	Unit L	Sec. 12	Twp. 29N	Rge. 15W	Is gas actually connected? <input type="checkbox"/>	When

If this production is commingled with that from any other lease or pool, give commingling order number: _____

IV. COMPLETION DATA

Designate Type of Completion - (X)	Oil Well <input checked="" type="checkbox"/>	Gas Well	New Well <input checked="" type="checkbox"/>	Workover	Deepen	Plug Back	Same Res'v.	Diff. Res'v.
Date Spudded 12/31/80	Date Compl. Ready to Prod. 2/5/81		Total Depth 4670'		P.B.T.D. 4612'			
Elevations (DF, RKB, RT, GR, etc.) 5176'GL	Name of Producing Formation Gallup		Top Oil/Gas Pay 4556'		Tubing Depth 4466'			
Perforations 4423'-4427'; 4430'-4432'; 4437'-4442'; 4449'-4453'; 4466'-4475'; 4489'-4494'; 4505'-4507'; 4513'-4516'; 4518'-4519'; 4521'-4524'; 4551'-4556'					Depth Casing Shoe 4463'			
TUBING, CASING, AND CEMENTING RECORD								
HOLE SIZE	CASING & TUBING SIZE		DEPTH SET		SACKS CEMENT			
12-1/4"	8-5/8"		289'		275 sacks			
7-7/8"	4-1/2"		4645'		925 sacks			
	2-3/8"		4465'					

V. TEST DATA AND REQUEST FOR ALLOWABLE OIL WELL

(Test must be after recovery of total volume of load oil and must be equal to or exceed top allowable for this depth or be for full 24 hours)

Date First New Oil Run To Tanks 2/10/81	Date of Test 3/26/81	Producing Method (Flow, pump, gas lift, etc.) Flowing	
Length of Test 24 hrs.	Tubing Pressure 50 psig	Casing Pressure 475 psig	Choke Size 3/4"
Actual Prod. During Test	Oil-Bbls. 52	Water-Bbls. 2	Gas-MCF 203

GAS WELL

Actual Prod. Test-MCF/D	Length of Test	Condensate/MMCF	Gravity of Condensate
Testing Method (pilot, back pr.)	Tubing Pressure (shut-in)	Casing Pressure (shut-in)	Choke Size

VI. CERTIFICATE OF COMPLIANCE

I hereby certify that the rules and regulations of the Oil Conservation Commission have been complied with and that the information given above is true and complete to the best of my knowledge and belief.

FOR: S & I OIL COMPANY

ORIGINAL SIGNED BY
EWELL N. WALSH

Ewell N. Walsh, PE (Signature) President
Walsh Engineering & Prod. Corp.

4/24/81

(Date)

OIL CONSERVATION COMMISSION

AUG 25 1981

APPROVED _____, 19____
BY **Original Signed by FRANK T. CHAVEZ**

TITLE **SUPERVISOR DISTRICT # 3**

This form is to be filed in compliance with RULE 1104.

If this is a request for allowable for a newly drilled or deepened well, this form must be accompanied by a tabulation of the deviation tests taken on the well in accordance with RULE 111.

All sections of this form must be filled out completely for allowable on new and recompleted wells.

Fill out only Sections I, II, III, and VI for changes of owner, well name or number, or transporter, or other such change of condition.

Separate Forms C-104 must be filed for each pool in multiply completed wells.