



STATE OF NEW MEXICO  
ENERGY AND MINERALS DEPARTMENT  
OIL CONSERVATION DIVISION

December 29, 1980

BRUCE KING  
GOVERNOR

LARRY KEHOE  
SECRETARY

POST OFFICE BOX 2088  
STATE LAND OFFICE BUILDING  
SANTA FE, NEW MEXICO 87501  
(505) 827-2434

Dugan Production Corporation  
P. O. Box 208  
Farmington, New Mexico 87401

Attention: Mr. Jerome P. McHugh, Jr.

Administrative Order NSL-1296

Gentlemen:

Reference is made to your application on behalf of Pioneer Production Corporation for a non-standard location for their Farmington 8 Well No. 1E located 655 feet from the South line and 1725 feet from the East line of Section 15, Township 29 North, Range 13 West, NMPM, Basin Dakota Pool, San Juan County, New Mexico.

By authority granted me under the provisions of Rule 3 of Order No. R-1670, the above-described unorthodox location is hereby approved.

Sincerely,

JOE D. RAMEY,  
Director

JDR/RLS/dr

cc: Oil Conservation Division - Aztec  
Oil & Gas Engineering Committee - Hobbs  
U. S. Geological Survey - Farmington

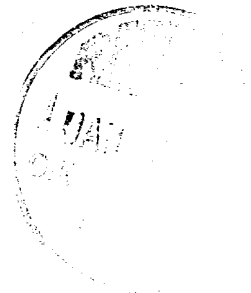

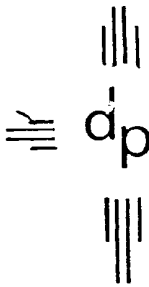

# dugan production corp.

December 3, 1980

Frank Chavez  
New Mexico Oil Conservation Division  
1000 Rio Brazos Rd.  
Aztec, NM 87410

James F. Sims  
U. S. Geological Survey  
P. O. Box 959  
Farmington, NM 87401

Re: Application for Administrative Approval of  
Unorthodox Location for Pioneer Production Corporation's  
Farmington B #1E Well located SW/4 SE/4 Sec 15 T29N R13W,  
San Juan County, NM

Dear Sir:

Enclosed are copies of the instruments filed with the New Mexico  
Oil Conservation Division regarding the Application for Administrative  
Approval of the Unorthodox Location for the above-referenced well.

Sincerely,

Jerome P. McHugh, Jr.  
Agent for Applicant

fp

Enclosures

*Recommend approval*  
*S.E.*



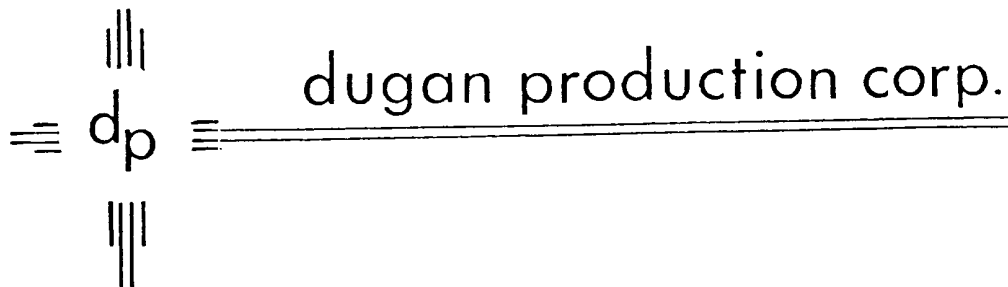

December 3, 1980

Joe D. Ramey  
Division Director  
New Mexico Oil Conservation Division  
P. O. Box 2088  
Santa Fe, NM 87501

Re: Application for Administrative Approval of  
Unorthodox Location for Pioneer Production Corporation's  
Farmington B #1E Well located SW/4 SE/4 Sec 15 T29N R13W,  
San Juan County, NM

Dear Mr. Ramey:

Enclosed please find three copies of the Application for Administrative Approval of the Unorthodox Location for the above-referenced well, which application includes a plat showing the ownership of all leases offsetting this spacing unit for which the unorthodox location is sought, and all wells completed thereon, and a plat showing the existent topographical conditions of the well location. Also enclosed are copies of the dedicated acreage plat.

Copies of this application are being submitted to all offsetting operators by certified mail with a request that they furnish your office with a waiver of objection.

Please advise if you need further information.

Sincerely,

  
Jerome P. McHugh Jr.  
Agent for Applicant

fp

Enclosures

Joe D. Ramey  
December 3, 1980  
Page 2

Pioneer Production Corp.  
Farmington B #1E

xc: Frank Chavez  
New Mexico Oil Conservation Division  
1000 Rio Brazos Road  
Aztec, NM 87410

James Sims  
U.S. Geological Survey  
P O Box 959  
Farmington, NM 87401

Amoco Production Company  
501 Airport Drive  
Farmington, NM 87401

APPLICATION FOR ADMINISTRATIVE APPROVAL  
OF UNORTHODOX LOCATION

Applicant: Pioneer Production Corp.  
P O Box 208  
Farmington, NM 87041

Name of Well: Farmington B #1E

Land Dedicated to the Well: T29N, R13W, NMPM  
Section 15 SE/4  
San Juan County, NM

Proposed Unorthodox Location: T29N, R13W, NMPM  
Sec 15 655' FSL - 1725' FEL  
Unit Letter O  
San Juan County, NM

Reason for Unorthodox Location: Located within light industrial zone  
in Farmington, NM city limits. No  
standard location available because  
of man-made structures in the area.  
See Exhibit "D" attached hereto and  
incorporated herein (Zoning plat)

Offsetting Leases and Operators  
and Well Completions: See Exhibit "A" attached hereto and  
incorporated herein by reference.

Existent Topographical Conditions: See Exhibit "B" attached hereto and  
incorporated herein by reference.

New Mexico Oil Conservation Division Rule 104F  
Rule Authorizing Application:

See Exhibit "C" (Surveyor's Plat) attached hereto and incorporated herein.

BY: 

Thomas A. Dugan, Agent

Waiver:

\_\_\_\_\_ hereby acknowledges receipt of the  
Application for Administrative Approval of Unorthodox Location filed by  
Pioneer Production Corp. \_\_\_\_\_ herein and hereby waives objection to  
Pioneer Production Corp. \_\_\_\_\_ Application for Administrative  
Approval of Unorthodox Location for their Farmington B #1E  
Well as proposed herein.

BY: \_\_\_\_\_

DATE: \_\_\_\_\_

EXHIBIT "A"

PIONEER PRODUCTION CORP.  
Farmington B #1E

1. Amoco Production Co.  
501 Airport Drive  
Farmington, NM 87401

T29N R13W Sec 22 E/2, W/2  
T29N R13W Sec 23 N/2

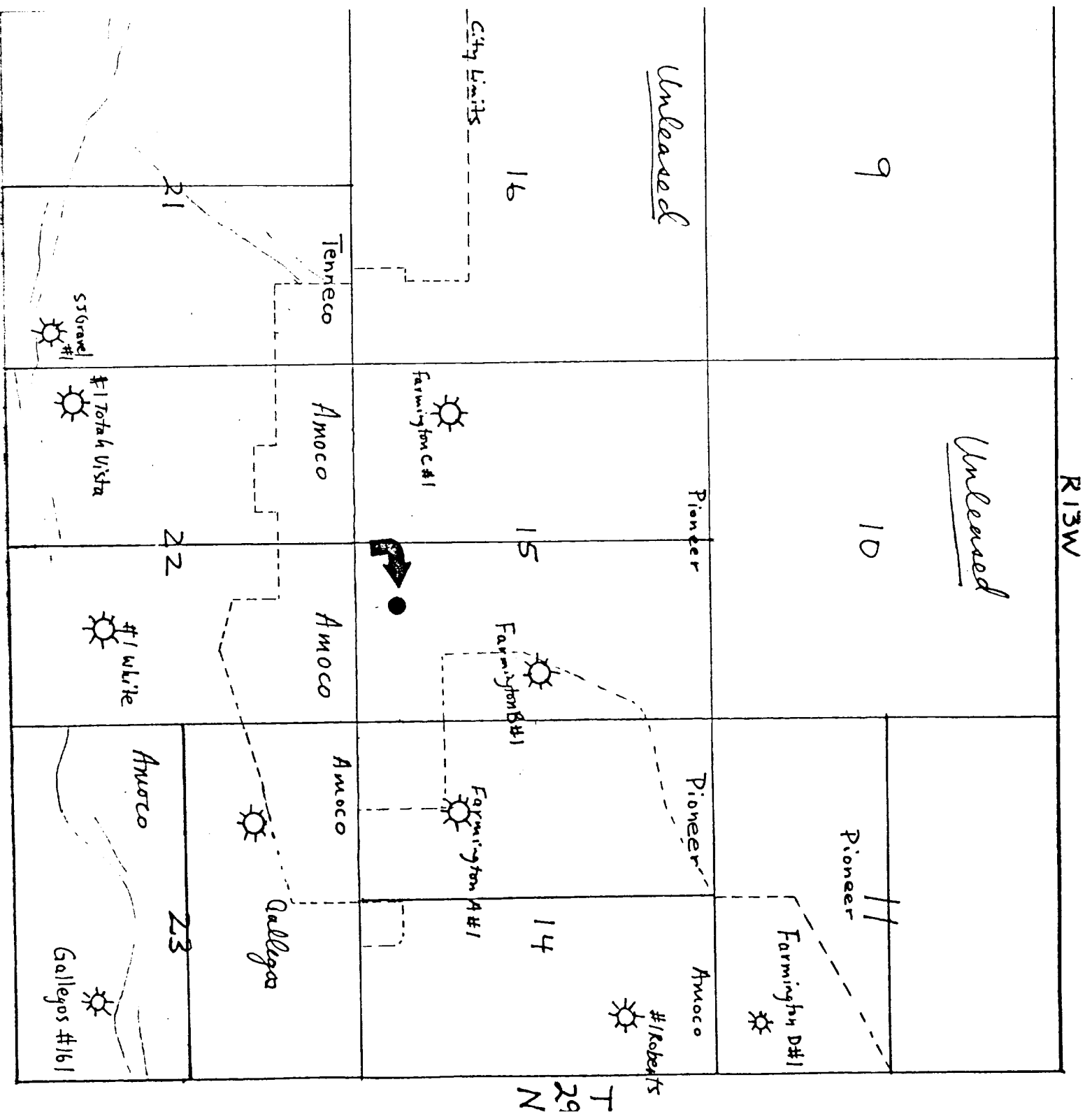
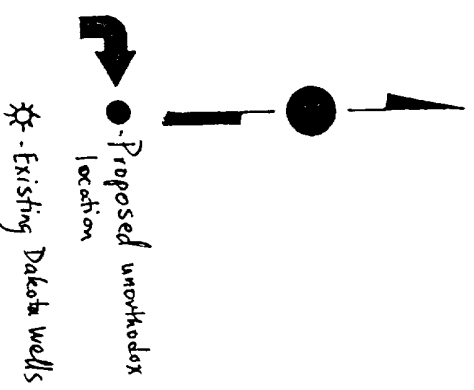

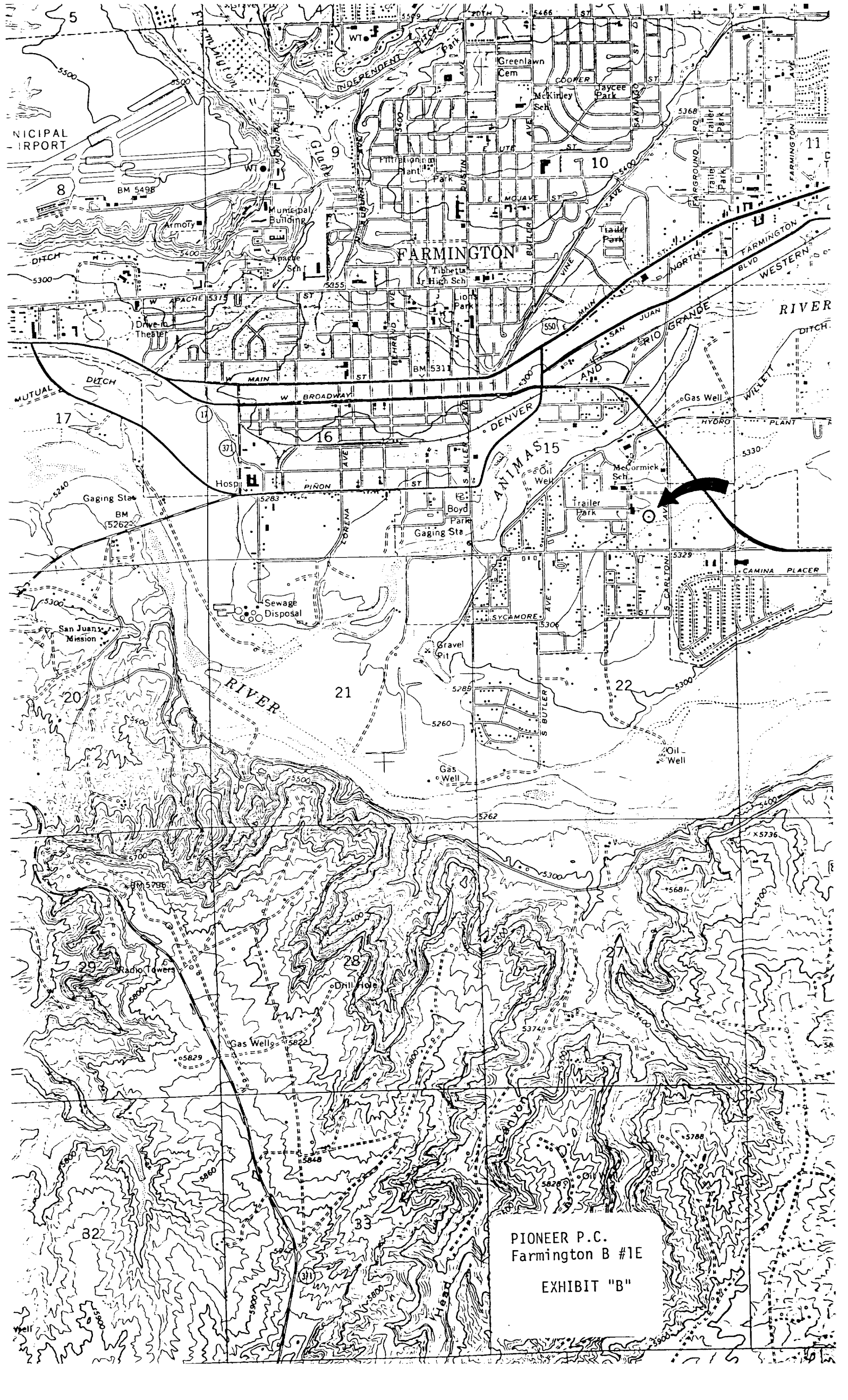

PIONEER P.C.  
Farmington B #1E  
EXHIBIT "B"

Form C-102  
Supersedes C-128  
Effective 1-1-65

Operator Pioneer Production Corp.		Lease Farmington B		Well No. #1E
Unit Letter 0	Section 15	Township 29 North	Range 13 West	County San Juan
Actual Footage Location of Well: 655 feet from the South line and 1725 feet from the East line				
Ground Level Elev. 5321'	Producing Formation Dakota	Pool	Dedicated Acreage: 160 Acres	

- No allowable will be assigned to the well until all interests have been consolidated (by communitization, unitization, forced-pooling, or otherwise) or until a non-standard unit, eliminating such interests, has been approved by the Commission.

Certificate No.  
2373

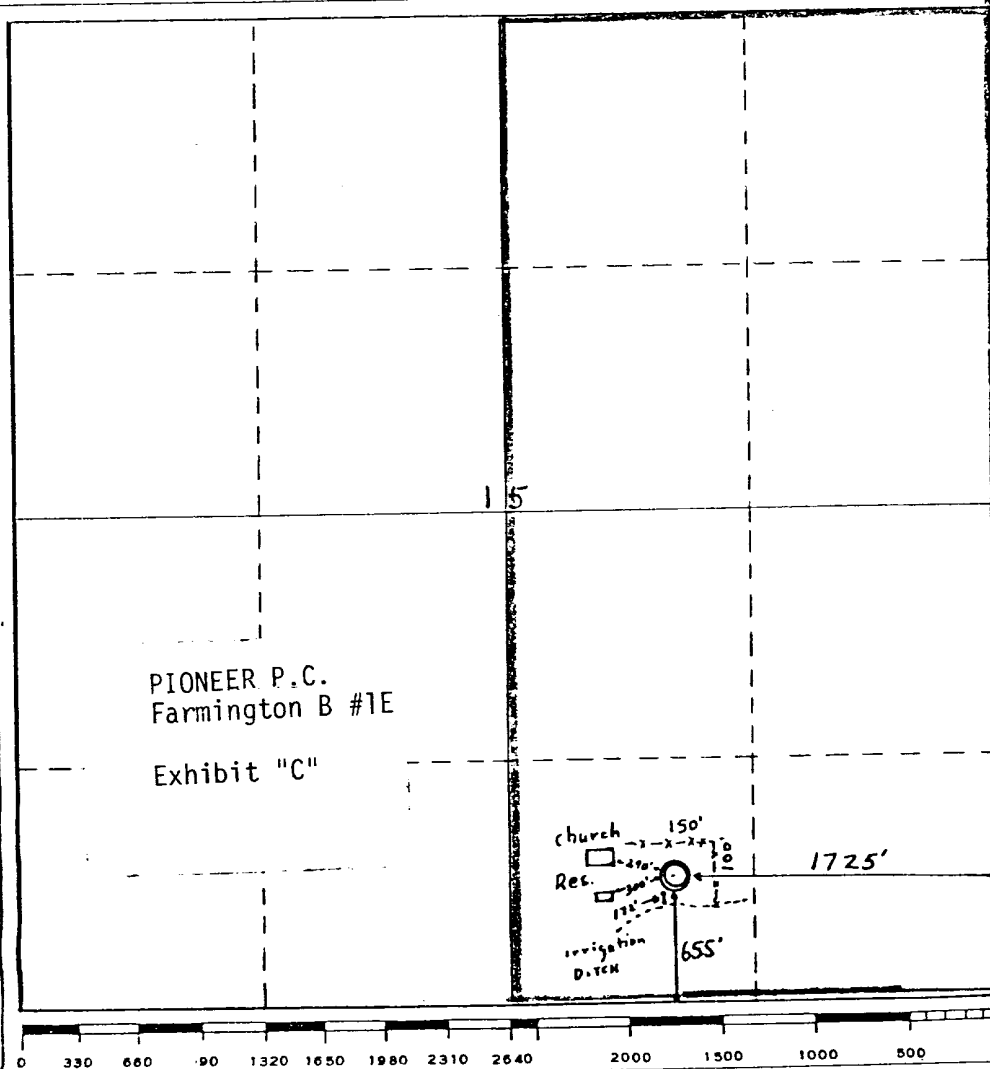

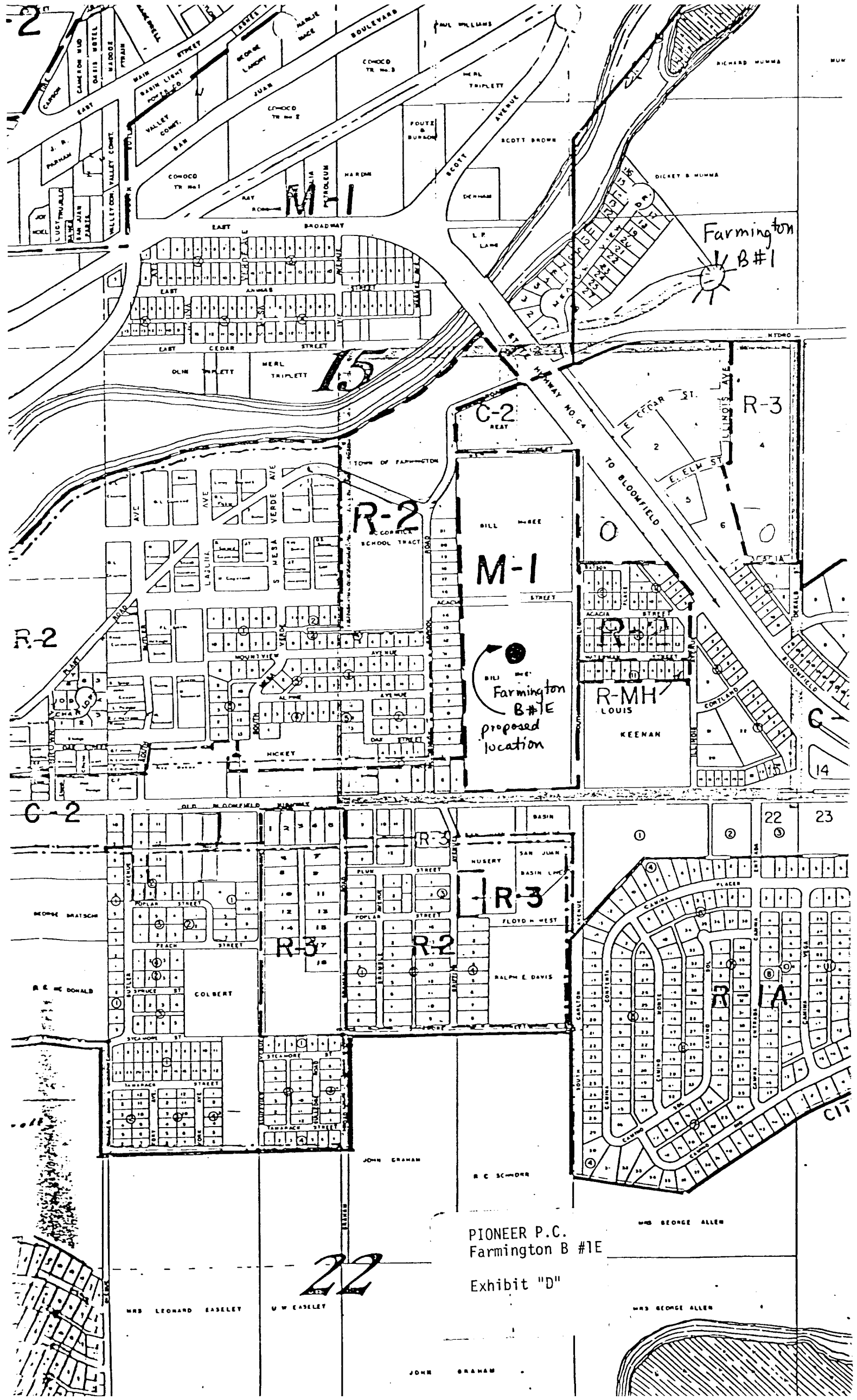

PIONEER P.C.  
Farmington B #1E

Exhibit "D"



STATE OF NEW MEXICO  
**ENERGY AND MINERALS DEPARTMENT**  
OIL CONSERVATION DIVISION

September 18, 1980

BRUCE KING  
GOVERNOR

LARRY KEHOE  
SECRETARY

POST OFFICE BOX 2088  
STATE LAND OFFICE BUILDING  
SANTA FE, NEW MEXICO 87501  
(505) 827-2434



Dugan Production Corp.  
P. O. Box 208  
Farmington, New Mexico 87401

Attention: Mr. Sherman E. Dugan

Administrative Order NSL-1260

Gentlemen:

Reference is made to your application on behalf of Pioneer Production Company for approval of a non-standard location for their Farmington B Well No. 1E to be located 655 feet from the South line and 1025 feet from the East line of Section 15, Township 29 North, Range 13 West, NMPM, Basin-Dakota Pool, San Juan County, New Mexico.

By authority granted me under the provisions of Rule 3 of Order No. R-1670, the above-described unorthodox location is hereby approved.

Sincerely,

JOE D. RAMEY,  
Director

JDR/RLS/dr

cc: Oil Conservation Division - Aztec  
Oil & Gas Engineering Committee - Hobbs  
U. S. Geological Survey - Farmington

OIL CONSERVATION COMMISSION  
DISTRICT

OIL CONSERVATION COMMISSION  
BOX 2088  
SANTA FE, NEW MEXICO

DATE 9-8-80

RE: Proposed MC \_\_\_\_\_  
Proposed DHC \_\_\_\_\_  
Proposed NSL X \_\_\_\_\_  
Proposed SWD \_\_\_\_\_  
Proposed WFX \_\_\_\_\_  
Proposed PMX \_\_\_\_\_

Gentlemen:

I have examined the application dated August 28, 1980  
for the Pioneer Production Farmington B #1E 0 - 15-29N-13W  
Operator Lease and Well No. Unit, S-T-R

and my recommendations are as follows:

Approve  
\_\_\_\_\_  
\_\_\_\_\_  
\_\_\_\_\_  
\_\_\_\_\_  
\_\_\_\_\_

Yours very truly,

Richard H. Linneman

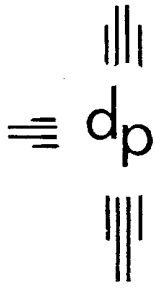

# dugan production corp.

---

August 27, 1980

Re: Application for Administrative Approval of  
Non-Standard Location for Pioneer Production's  
Farmington B #1E Well in San Juan County, NM

Enclosed are copies of the instruments filed with the New Mexico Oil  
Conservation Division regarding the Application for Administrative  
Approval of the Unorthodox Location for the Farmington B #1E Well  
located in San Juan County, New Mexico.

Sincerely,

DUGAN PRODUCTION CORPORATION

Sherman E. Dugan  
Agent for Applicant

SED/de

Enclosures

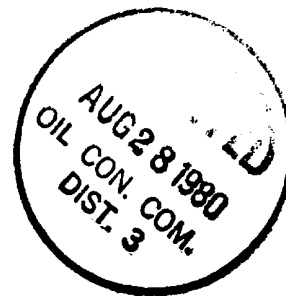

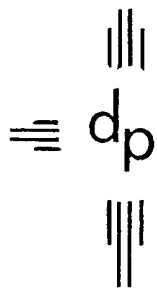

# dugan production corp.

---

August 27, 1980

Re: Application for Administrative Approval of  
Unorthodox Location for Pioneer Production's  
Farmington B #1E Well in San Juan County, NM

Enclosed are copies of the instruments filed with the New Mexico Oil Conservation Division regarding Application for Administrative Approval of the Unorthodox Location for the Farmington B #1E Well located in the SW/4 SE/4 Sec 15 T29N R13W, San Juan County, New Mexico.

In addition, we are enclosing three copies of the Application with a Waiver of Objection. If you do not have any objection to this unorthodox location, please sign all three copies of this Waiver. Please send one executed copy to Joe D. Ramey, Division Director, New Mexico Oil Conservation Division, P. O. Box 2088, Santa Fe, New Mexico 87501 and return one to our office. The remaining copy is for your records.

Thank you in advance for your assistance and cooperation in this matter.

Sincerely,

DUGAN PRODUCTION CORPORATION

Sherman E. Dugan  
Agent for Applicant

SED/de

Enclosures



**NEW MEXICO OIL CONSERVATION COMMISSION**  
**WELL LOCATION AND ACREAGE DEDICATION PLAT**

Form C-102  
 Supersedes C-128  
 Effective 1-1-65

All distances must be from the outer boundaries of the Section.

Operator <b>Pioneer Production</b>			Lease <b>Farmington B</b>		Well No. <b>1-E</b>
Unit Letter <b>0</b>	Section <b>15</b>	Township <b>29 North</b>	Range <b>13 West</b>	County <b>San Juan</b>	
Actual Footage Location of Well: <b>655</b> feet from the <b>South</b> line and <b>1625</b> feet from the <b>East</b> line					
Ground Level Elev. <b>5321</b>	Producing Formation	Pool	Dedicated Acreage:  Acre.		

1. Outline the acreage dedicated to the subject well by colored pencil or hachure marks on the plat below.
2. If more than one lease is dedicated to the well, outline each and identify the ownership thereof (both as to working interest and royalty).
3. If more than one lease of different ownership is dedicated to the well, have the interests of all owners been consolidated by communitization, unitization, force-pooling, etc?

☐ Yes    ☐ No    If answer is "yes," type of consolidation \_\_\_\_\_

If answer is "no," list the owners and tract descriptions which have actually been consolidated. (Use reverse side of this form if necessary.) \_\_\_\_\_

No allowable will be assigned to the well until all interests have been consolidated (by communitization, unitization, forced-pooling, or otherwise) or until a non-standard unit, eliminating such interests, has been approved by the Commission.

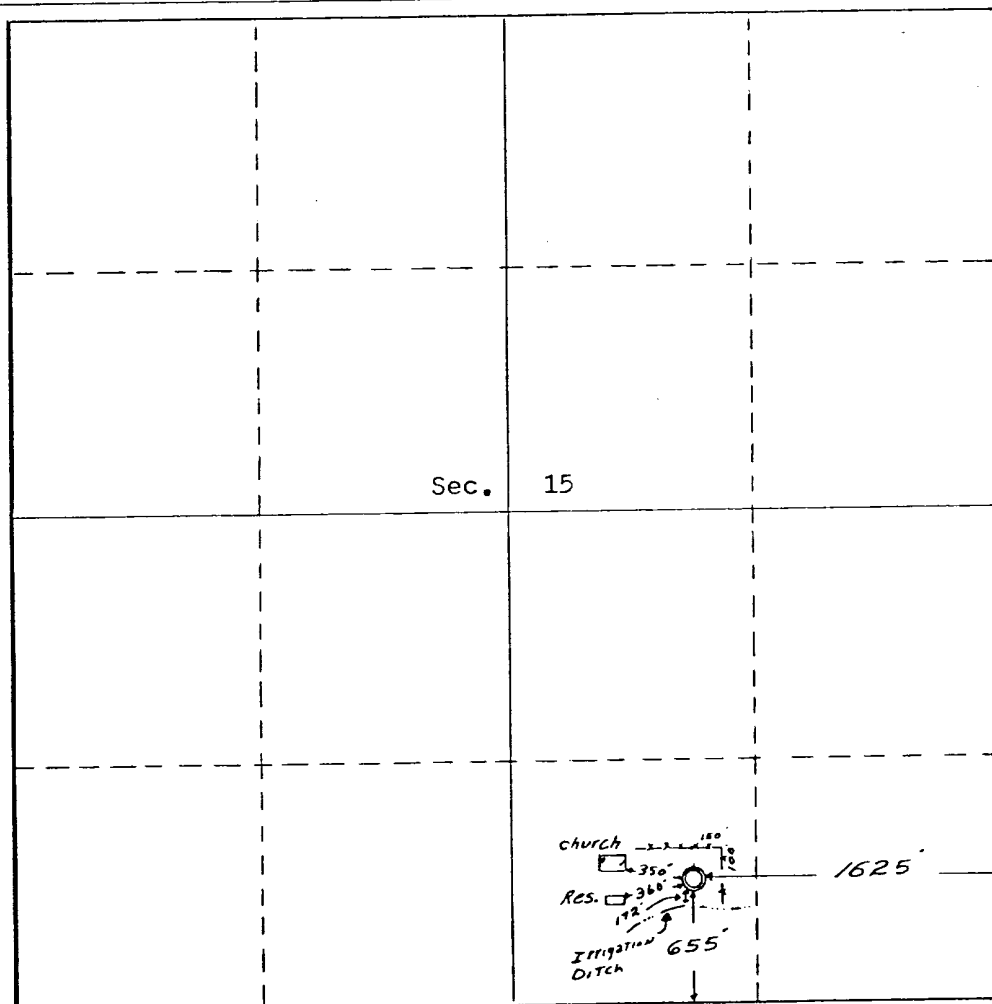

**CERTIFICATION**

I hereby certify that the information contained herein is true and complete to the best of my knowledge and belief.

Name \_\_\_\_\_

Position \_\_\_\_\_

Company \_\_\_\_\_

Date \_\_\_\_\_

I hereby certify that the well location shown on this plat was located from field notes of actual survey made by me or under my supervision, and that the same is true and correct to the best of my knowledge and belief.

Date Surveyed

**June 26, 1980**

Registered Professional Engineer and/or Land Surveyor

*Edgar L. Risenhoover*

Certificate No. **5979**

**Edgar L. Risenhoover, L.S.**

0 330 660 990 1320 1650 1980 2310 2640 2970 3300 3630 3960 4290 4620 4950 5280 5610 5940 6270 6600

Unleased Acreage  
Township 29 North, Range 13 West  
Section 10  
San Juan County, New Mexico

R13W

Tenneco  
Township 29 North, Range 13 West NMPM  
Section 11  
San Juan County, New Mexico

San Juan County, New Mexico

Pioneer  
Township 29 North, Range 13 West NMPM  
Section 14, W/2  
San Juan County, New Mexico

San Juan County, New Mexico

Pioneer

Township 29 North, Range 13 West NMPM  
Section: 15  
San Juan County, New Mexico

San Juan County, New Mexico

Unleased Acreage  
Township 29 North, Range 13 West NMPM  
Section 16  
San Juan County, New Mexico

San Juan County, New Mexico

Tenneco  
Township 29 North, Range 13 West NMPM  
Section 21  
San Juan County, New Mexico

San Juan County, New Mexico

Amoco  
Township 29 North, Range 13 West NMPM  
Section 22  
San Juan County, New Mexico

San Juan County, New Mexico

Amoco  
Township 29 North, Range 13 West NMPM  
Section 23  
San Juan County, New Mexico

San Juan County, New Mexico

Unleased	Unleased	Tenneco	
9	10	11	
Unleased	Pioneer	Pioneer	
16	15	14	
Tenneco	Amoco	Amoco	
21	22	23	
Amoco			
Township 29 North, Range 13 West NMPM			
Section 22			
San Juan County, New Mexico			
Township 29 North, Range 13 West NMPM			
Section 23			
San Juan County, New Mexico			

T29N

APPLICATION FOR ADMINISTRATIVE APPROVAL  
OF UNOROTHODOX LOCATION

Pioneer Production Corp.  
Box 208  
San Juan County, New Mexico

EXHIBIT "A"

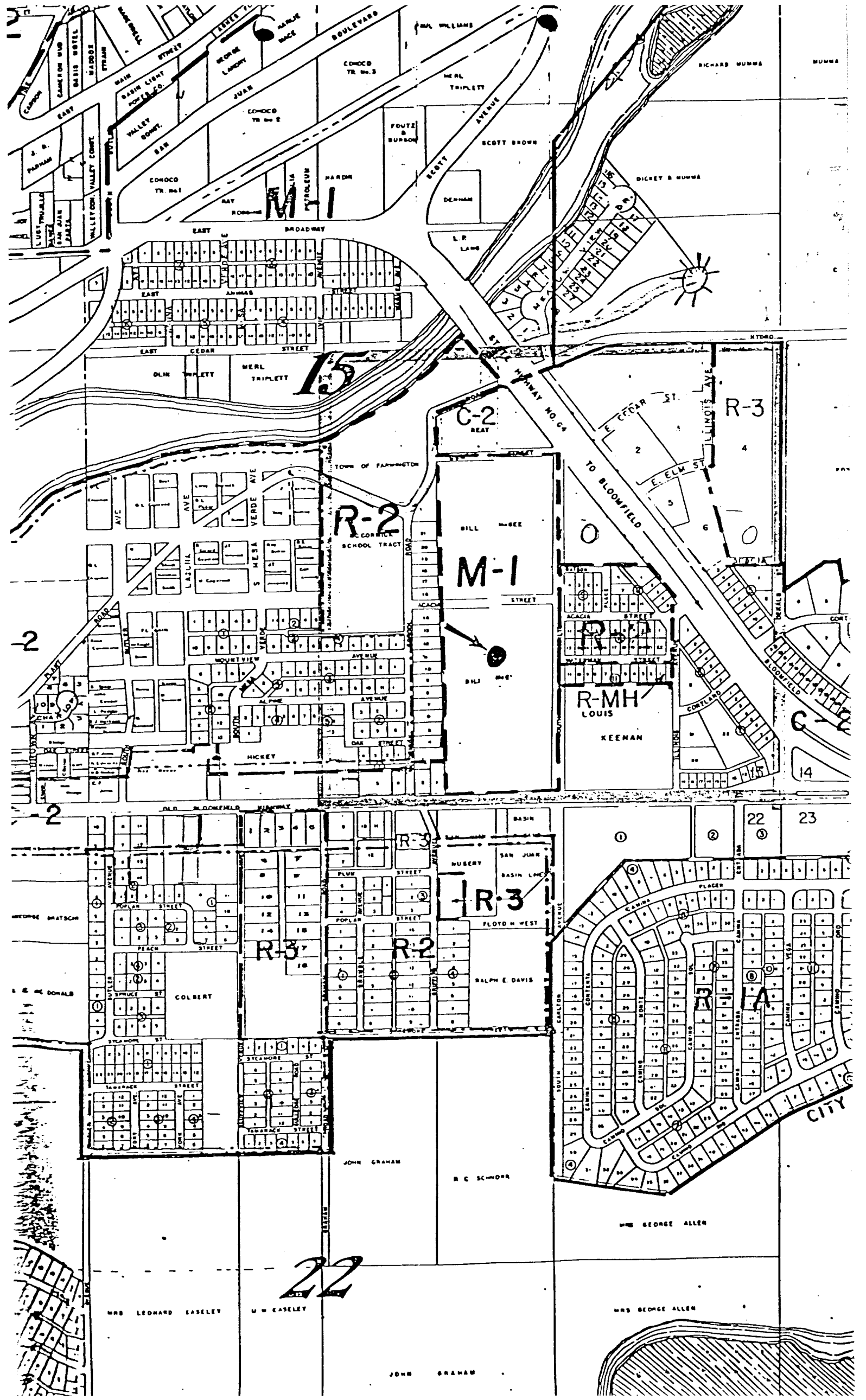

15

R-2

M-1

R-3

R-MH

R-3

R-3

R-2

R-3

1A

22

CITY