

WELL LOCATION AND ACREAGE DEDICATION PLAT

Form No. 1-6-81
Effective 1-1-81

All distances must be from the outer boundaries of the Section.

Operator Tenneco Oil Company			Lease Hamner		Well No. 3E
Unit Letter M	Section 29	Township 29N	Range 9W	County San Juan	

Actual Footage Location of Well:
970 feet from the **South** line and **870** feet from the **West** line

Ground Level Elev. 5761	Producing Formation Dakota/Chacra	Pool Dakota/Chacra	Dedicated Acreage: 160 Acres
-----------------------------------	---	------------------------------	--

1. Outline the acreage dedicated to the subject well by colored pencil or hatchure marks on the plat below.
2. If more than one lease is dedicated to the well, outline each and identify the ownership thereof (both as to working interest and royalty).
3. If more than one lease of different ownership is dedicated to the well, have the interests of all owners been consolidated by communitization, unitization, force-pooling, etc?

☐ Yes ☐ No If answer is "yes," type of consolidation _____

If answer is "no," list the owners and tract descriptions which have actually been consolidated. (Use reverse side of this form if necessary.) _____

No allowable will be assigned to the well until all interests have been consolidated (by communitization, unitization, forced-pooling, or otherwise) or until a non-standard unit, eliminating such interests, has been approved by the Commission.

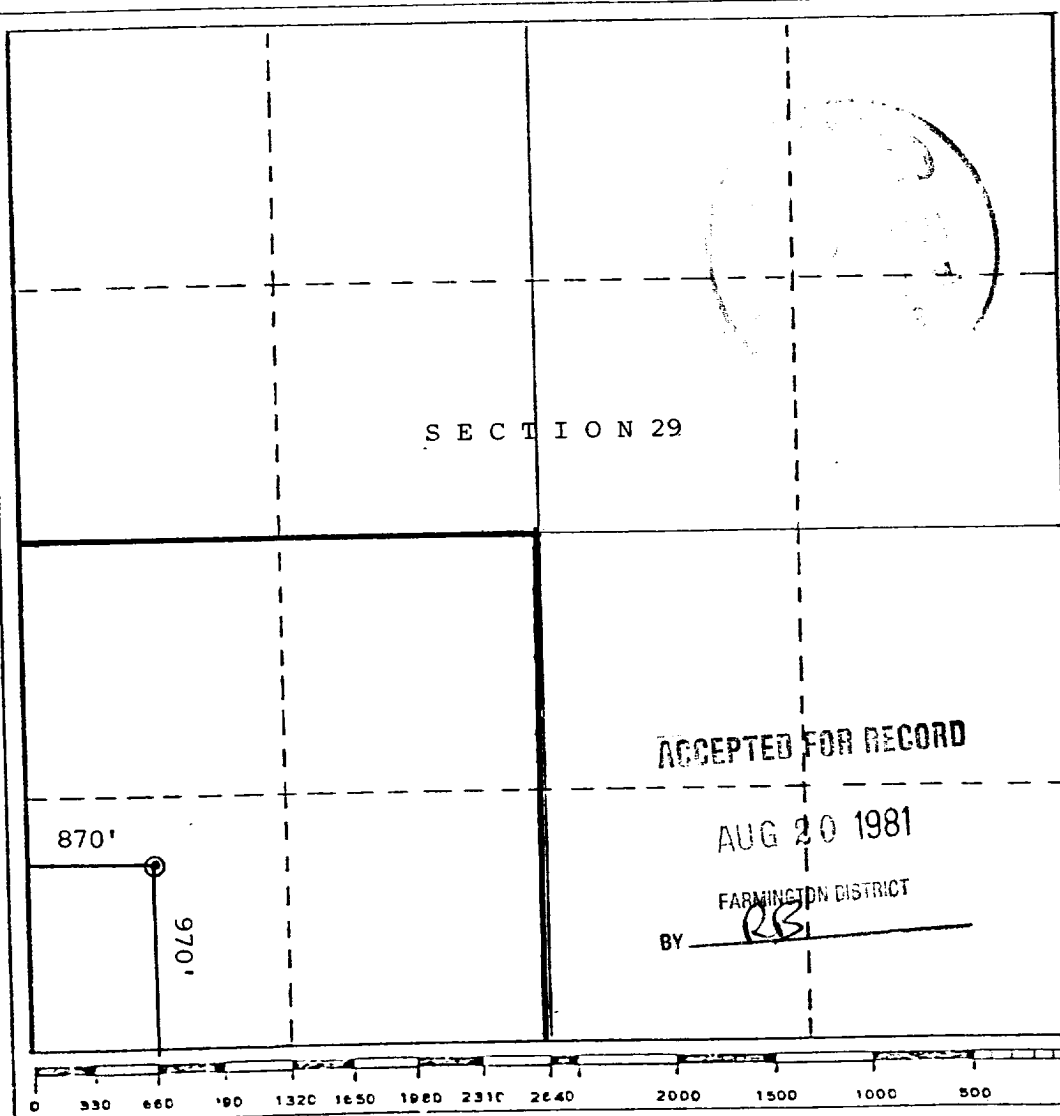

CERTIFICATION

I hereby certify that the information contained herein is true and complete to the best of my knowledge and belief.

[Signature]

Name
Production Analyst
Position
Tenneco Oil Company
Company
8/3/81
Date

I hereby certify that the well location shown on this plat was plotted from field notes of actual surveys made by me or under my supervision, and that the same is true and correct to the best of my knowledge and belief.

Date Surveyed
Registered Professional Engineer and/or Land Surveyor
Certificate No.

ACCEPTED FOR RECORD

AUG 20 1981

FARMINGTON DISTRICT

BY RS

NMOCG