

NO. OF COPIES RECEIVED		
DISTRIBUTION		
SANTA FE		
FILE		
U.S.G.S.		
LAND OFFICE		
OPERATOR		

# NEW MEXICO OIL CONSERVATION COMMISSION

30-045-24818  
Form C-101  
Revised 1-1-65

5A. Indicate Type of Lease	
STATE <input type="checkbox"/>	FEE <input checked="" type="checkbox"/>
5. State Oil & Gas Lease No.	

## APPLICATION FOR PERMIT TO DRILL, DEEPEN, OR PLUG BACK

1a. Type of Work		7. Unit Agreement Name	
b. Type of Well OIL WELL <input type="checkbox"/> GAS WELL <input checked="" type="checkbox"/> OTHER <input type="checkbox"/>		8. Farm or Lease Name Farmington A	
2. Name of Operator El Paso Natural Gas Company		9. Well No. 1E	
3. Address of Operator PO Box 289, Farmington, NM 87401		10. Field and Pool, or Wildcat Basin Dakota	
4. Location of Well UNIT LETTER O LOCATED 590 FEET FROM THE South LINE AND 2400 FEET FROM THE East LINE OF SEC. 1 TWP. 29N RGE. 13W NMPM		12. County San Juan	
19. Proposed Depth 6238'		19A. Formation Dakota	
20. Rotary or C.T. rotary			
21. Elevations (Show whether DF, RT, etc.) 5366' GL		21A. Kind & Status Plug. Bond statewide	
21B. Drilling Contractor		22. Approx. Date Work will start	

### PROPOSED CASING AND CEMENT PROGRAM

SIZE OF HOLE	SIZE OF CASING	WEIGHT PER FOOT	SETTING DEPTH	SACKS OF CEMENT	EST. TOP
13 3/4"	9 5/8"	32.3#	200'	190	circ. surface
6 1/4"	4 1/2"	10.5#	6238'	1095	3 stage - circ. surface

This well will be drilled vertically to 1600', where it will be directionally drilled to within 175' of a point 990' from South line and 1650' from the West line of Section. This proposal was approved under Order #R-6460'.

Selectively perforate and sandwater fracture the Dakota formation. A 3000 psi WP and 6000 psi test double gate preventer equipped with blind and pipe rams will be used for blow out prevention on this well.

This gas is dedicated.

The S/2 of Section 1 is dedicated to this well.

APPROVAL VALID  
FOR 90 DAYS UNLESS  
DRILLING COMMENCED  
EXPIRES 7-26-81

IN ABOVE SPACE DESCRIBE PROPOSED PROGRAM: IF PROPOSAL IS TO DEEPEN OR PLUG BACK, GIVE DATA ON PRESENT PRODUCTIVE ZONE AND PROPOSED NEW PRODUCTIVE ZONE. GIVE BLOWOUT PREVENTER PROGRAM, IF ANY.

I hereby certify that the information above is true and complete to the best of my knowledge and belief.

Signed A. G. Busico Title Drilling Clerk Date January 23, 1981

(This space for State Use)

APPROVED BY Frank J. Davey TITLE SUPERVISOR DISTRICT #3 DATE JAN 26 1981

CONDITIONS OF APPROVAL, IF ANY:

N MEXICO OIL CONSERVATION COMMISS  
WELL LOCATION AND ACREAGE DEDICATION PLAT

Form C-102  
Supersedes C-128  
Effective 1-1-65

All distances must be from the outer boundaries of the Section.

Operator <b>EL PASO NATURAL GAS COMPANY</b>		Lease <b>FARMINGTON A (FEE)</b>		Well No. <b>1E</b>
Unit Letter <b>0</b>	Section <b>1</b>	Township <b>29-N</b>	Range <b>13-W</b>	County <b>SAN JUAN</b>
Actual Footage Location of Well: <b>590</b> feet from the <b>SOUTH</b> line and <b>2400</b> feet from the <b>EAST</b> line				
Ground Level Elev. <b>5366</b>	Producing Formation <b>DAKOTA</b>	Pool <b>BASIN DAKOTA</b>	Dedicated Acreage: <b>320.00</b> Acres	

1. Outline the acreage dedicated to the subject well by colored pencil or hachure marks on the plat below.
2. If more than one lease is dedicated to the well, outline each and identify the ownership thereof (both as to working interest and royalty).
3. If more than one lease of different ownership is dedicated to the well, have the interests of all owners been consolidated by communitization, unitization, force-pooling, etc?

☐ Yes ☐ No If answer is "yes," type of consolidation \_\_\_\_\_

If answer is "no," list the owners and tract descriptions which have actually been consolidated. (Use reverse side of this form if necessary.) \_\_\_\_\_

No allowable will be assigned to the well until all interests have been consolidated (by communitization, unitization, forced-pooling, or otherwise) or until a non-standard unit, eliminating such interests, has been approved by the Commission.

NOTE: THIS PLAT IS REISSUED TO SHOW GROUND ELEVATION ABOVE BOTTOM OF HOLE LOCATION. 6-11-80

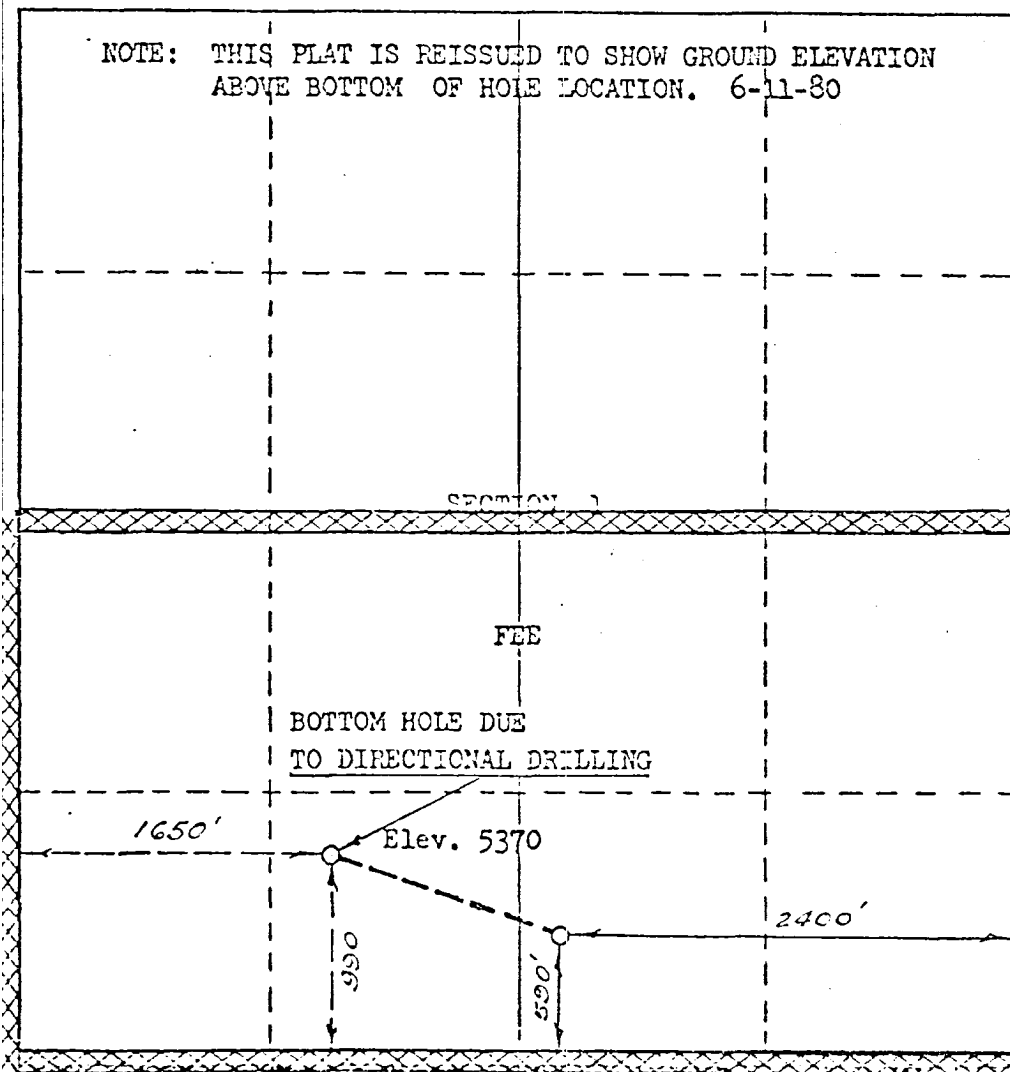

CERTIFICATION

I hereby certify that the information contained herein is true and complete to the best of my knowledge and belief.

*A. P. Davis*

Name

**El Paso Natural Gas Co.**

Position

**Drilling Clerk**

Company

**January 23, 1981**

Date

I hereby certify that the well location shown on this plat was plotted from field notes of actual surveys made by me or under my supervision, and that the same is true and correct to the best of my knowledge and belief.

Date Surveyed

**FEBRUARY 7, 1980**

Registered Professional Engineer and/or Land Surveyor

*David G. Wilson*

Certificate No. **1760**