

File

El Paso EXPLORATION
COMPANY

P. O. BOX 289
FARMINGTON, NEW MEXICO 87401
PHONE: 505-325-2841

July 25, 1980

Mr. Joe Ramey
New Mexico Oil Conservation Division
Post Office Box 2088
Santa Fe, New Mexico 87501

Dear Mr. Ramey:

This is a request for administrative approval to drill a deviated non-standard surface gas well location to a standard subsurface total depth in the Basin Dakota pool.

It is intended to locate the El Paso Natural Gas Company's Farmington A #1E surface location at 590' from the South line and 2400' from the East line, and projected subsurface location will be approximately 1650' from the West line and 990' from the South line of Section 1, T-29-N, R-~~10~~-W, San Juan County, New Mexico.

0 - 1 - 29 - 13

The proposed surface gas well location is in El Paso Natural Gas Company's warehouse yard which is readily accessible and away from private business located near the subsurface location.

All operators of proration units offsetting the proposed non-standard gas well location have been notified of this application by certified mail.

Plats showing the proposed gas well location, ownership plat, and a city map are enclosed.

Yours truly,

Don Read

D. R. Read
Project Drilling Engineer

DRR:pb



EL PASO NATURAL GAS COMPANY

Well Name Farmington A #1 E

Basin Dakota

Footage----- 590' FSL, 2400' FEL

APPLICATION FOR NON-STANDARD LOCATION

County San Juan

State New Mexico

Section 1

Township

29-N

Range 13-W

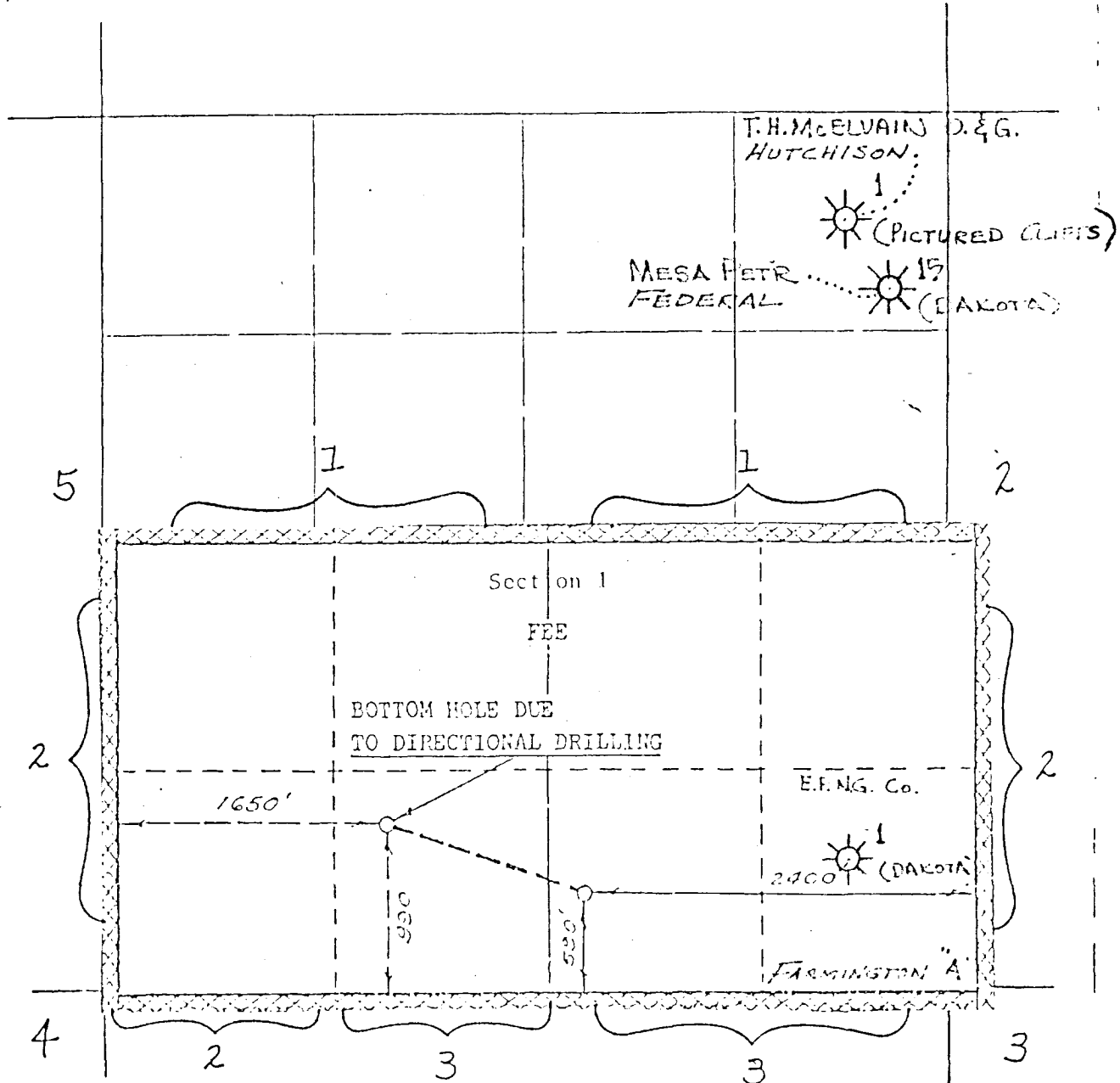

REMARKS:

- (1) Mesa Petroleum Company
- (2) Pioneer Production Company
- (3) Amoco Production Company
- (4) Tenneco Oil Company
- (5) Sun Oil Company

(ld)

N MEXICO OIL CONSERVATION COMMISSION
WELL LOCATION AND ACREAGE DEDICATION PLAT

Form C-102
Supersedes C-128
Effective 1-1-65

All distances must be from the outer boundaries of the Section.

Operator EL PASO NATURAL GAS COMPANY		Lease FARMINGTON A (FEE)		Well No. 1E
Unit Letter 0	Section 1	Township 29-N	Range 13-W	County SAN JUAN
Actual Footage Location of Well: <div style="display: flex; justify-content: space-between;"> 590 feet from the SOUTH line and 2400 feet from the EAST line </div>				
Ground Level Elev. 5366	Producing Formation DAKOTA	Pool BASIN DAKOTA	Dedicated Acreage: 320.00 Acres	

1. Outline the acreage dedicated to the subject well by colored pencil or hatchure marks on the plat below.
2. If more than one lease is dedicated to the well, outline each and identify the ownership thereof (both as to working interest and royalty).
3. If more than one lease of different ownership is dedicated to the well, have the interests of all owners been consolidated by communitization, unitization, force-pooling, etc?

☐ Yes ☐ No If answer is "yes," type of consolidation _____

If answer is "no," list the owners and tract descriptions which have actually been consolidated. (Use reverse side of this form if necessary.) _____

No allowable will be assigned to the well until all interests have been consolidated (by communitization, unitization, forced-pooling, or otherwise) or until a non-standard unit, eliminating such interests, has been approved by the Commission.

NOTE: THIS PLAT IS REISSUED TO SHOW GROUND ELEVATION ABOVE BOTTOM OF HOLE LOCATION. 6-11-80

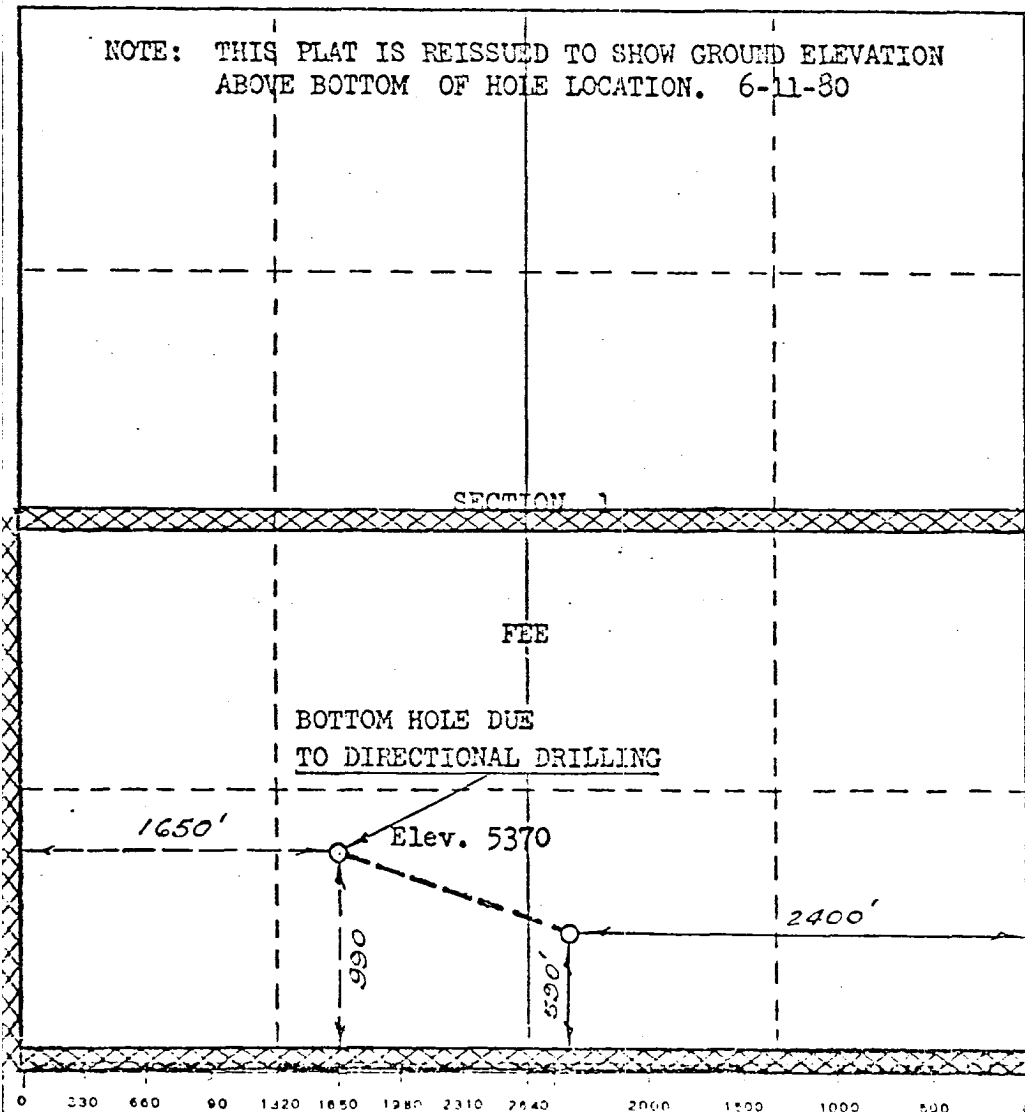

CERTIFICATION

I hereby certify that the information contained herein is true and complete to the best of my knowledge and belief.

Name _____

Position _____

Company _____

Date _____

I hereby certify that the well location shown on this plat was plotted from field notes of actual surveys made by me or under my supervision, and that the same is true and correct to the best of my knowledge and belief.

Date Surveyed

FEBRUARY 7, 1980

Registered Professional Engineer and/or Land Surveyor

[Signature]

Certificate No. **1760**

