

NO. OF COPIES RECEIVED	
DISTRIBUTION	
SANTA FE	
FILE	
U.S.G.S.	
LAND OFFICE	
OPERATOR	

NEW MEXICO OIL CONSERVATION COMMISSION

Form C-101
Revised 1-4-65

5A. Indicate Type of Lease
STATE <input checked="" type="checkbox"/> FEE <input type="checkbox"/>
5. State Oil & Gas Lease No.
E-1451-2

APPLICATION FOR PERMIT TO DRILL, DEEPEN, OR PLUG BACK

1a. Type of Work		7. Unit Agreement Name	
b. Type of Well OIL WELL <input type="checkbox"/> GAS WELL <input checked="" type="checkbox"/> OTHER <input type="checkbox"/>		8. Farm or Lease Name State Com C	
2. Name of Operator Tenneco Oil Company		9. Well No. #6	
3. Address of Operator P.O. Box 3249, Englewood, Colorado 80155		10. Field and Pool, or Wildcat Pictured Cliffs/Chacra	
4. Location of Well UNIT LETTER K LOCATED 1660 FEET FROM THE South LINE AND 1750 FEET FROM THE West LINE OF SEC. 32 TWP. 29N RGE. 9W NMPM		12. County San Juan	
19. Proposed Depth ±3375'		19A. Formation P.C./Chacra	
20. Rotary or C.T. Rotary		21. Elevations (Show whether DF, RT, etc.) GR 5863'	
21A. Kind & Status Plug. Bond blanket		21B. Drilling Contractor Four Corners	
22. Approx. Date Work will start March 1981			

23.

PROPOSED CASING AND CEMENT PROGRAM

SIZE OF HOLE	SIZE OF CASING	WEIGHT PER FOOT	SETTING DEPTH	SACKS OF CEMENT	EST. TOP
12 1/4"	8 5/8" new	24#	±250'	Circulate to surface	
7 7/8"	5 1/2" new	15.5#	±3375'	Circulate to surface	

See attached.

The gas is dedicated.

APPROVAL VALID
FOR 90 DAYS UNLESS
DRILLING COMMENCED,

EXPIRES 8-11-81



IN ABOVE SPACE DESCRIBE PROPOSED PROGRAM; IF PROPOSAL IS TO DEEPEN OR PLUG BACK, GIVE DATA ON PRESENT PRODUCTIVE ZONE AND PROPOSED NEW PRODUCTIVE ZONE, GIVE BLOWOUT PREVENTER PROGRAM, IF ANY.

I hereby certify that the information above is true and complete to the best of my knowledge and belief.

Signed A. C. Mishler Title Sr. Production Analyst Date February 2, 1981

(This space for State Use)

APPROVED BY Frank J. Chry TITLE SUPERVISOR DISTRICT 3 DATE FEB 11 1981

CONDITIONS OF APPROVAL, IF ANY:

OIL CONSERVATION DIVISION

P. O. BOX 2088

SANTA FE, NEW MEXICO 87501

Form C-107
Revised 10-1-78

STATE OF NEW MEXICO

ENERGY AND MINERALS DEPARTMENT

All distances must be from the outer boundaries of the Section.

Operator TENNECO OIL COMPANY		Lease STATE "C" COM		Well No. 6
Unit Letter K	Section 32	Township 29N	Range 9W	County San Juan
Actual Footage Location of Well: 1660 feet from the South line and 1750 feet from the West line				
Ground Level Elev. 5863	Producing Formation PICTURED CLIFFS/CHACRA	Pool PICTURED CLIFFS/CHACRA	Dedicated Acreage: 160 Acres	

1. Outline the acreage dedicated to the subject well by colored pencil or hachure marks on the plat below.
2. If more than one lease is dedicated to the well, outline each and identify the ownership thereof (both as to working interest and royalty).
3. If more than one lease of different ownership is dedicated to the well, have the interests of all owners been consolidated by communitization, unitization, force-pooling, etc?

☒ Yes ☐ No If answer is "yes," type of consolidation COMMUNITIZATION

If answer is "no," list the owners and tract descriptions which have actually been consolidated. (Use reverse side of this form if necessary.) _____

No allowable will be assigned to the well until all interests have been consolidated (by communitization, unitization, forced-pooling, or otherwise) or until a non-standard unit, eliminating such interests, has been approved by the Commission.

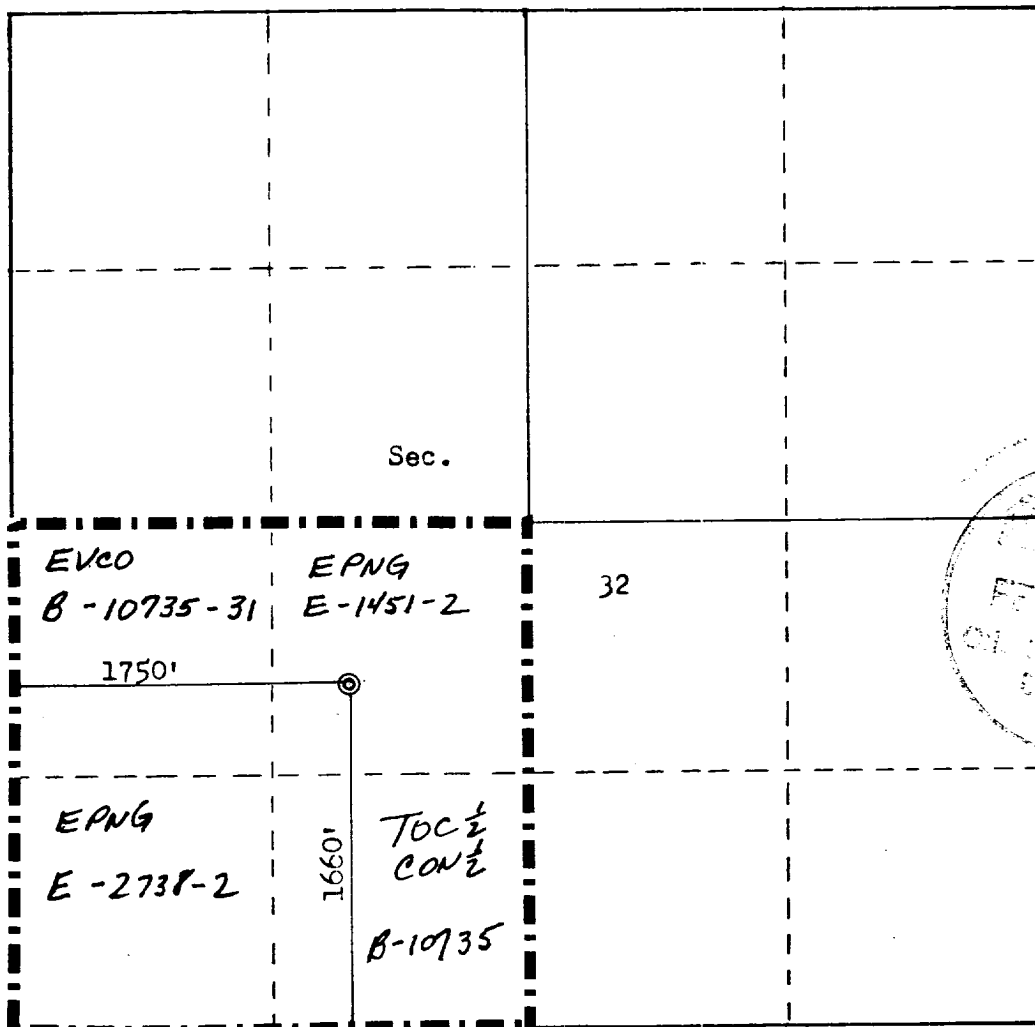

CERTIFICATION

I hereby certify that the information contained herein is true and complete to the best of my knowledge and belief.

Name

R. A. Mishler

Position

Sr. Production Analyst

Company

Tenneco Oil Company

Date

February 2, 1981

I hereby certify that the well location shown on this plat was plotted from field notes of actual surveys made by me or under my supervision, and that the same is true and correct to the best of my knowledge and belief.

Date Surveyed

December 20, 1980

Registered Professional Engineer and Land Surveyor

Fred B. Kerr, Jr.

Certificate No. 3950

