

NO. OF COPIES RECEIVED	
DISTRIBUTION	
SANTA FE	
FILE	
U.S.G.S.	
LAND OFFICE	
OPERATOR	

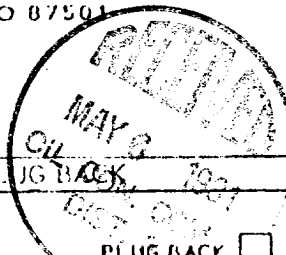

5A. Indicate Type of Lease
STATE ☐ FEE ☒
5. State Oil & Gas Lease No.

APPLICATION FOR PERMIT TO DRILL, DEEPEN, OR PLUG BACK

1a. Type of Work
b. Type of Well
OIL WELL ☒ GAS WELL ☐ OTHER ☐
DRILL ☒ DEEPEN ☐ PLUG BACK ☐
SINGLE ZONE ☐ MULTIPLE ZONE ☐

2. Name of Operator
Caribou Four Corners, Inc.

3. Address of Operator
2906 First Ave North Billings, Montana 59101

4. Location of Well
UNIT LETTER 0 LOCATED 510 FEET FROM THE South LINE
AND 1920 FEET FROM THE East LINE OF SEC. 11 TWP. 29N RGE. 15W NEARBY

7. Unit Agreement Name
8. Form or Lease Name

Kirtland

9. Well No.
#8

10. Field and Pool, or Wildcat
Cha-Cha Gallup

11. County
San Juan

12. Proposed Depth
4700

13A. Formation
Gallup

14. Elevation (Show whether DT, RI, etc.)
5126 Grd

21A. Kind & Status Plug. Bond
State Wide

21B. Drilling Contractor
Kenai, Maness

22. Approx. Date Work will start
May 15, 1981

15. Rotary or C.T.
CT to surface
Rotary to TD

23. PROPOSED CASING AND CEMENT PROGRAM

SIZE OF HOLE	SIZE OF CASING	WEIGHT PER FOOT	SETTING DEPTH	SACKS OF CEMENT	EST. TOP
12 1/2	8 5/8	23#	330'	275 sx	circ
7 7/8	4 1/2	9.5#	4700'	1000 sx	circ

- I. Drill to 330 ft with cable tool and set 8 jts 8 5/8" 23# casing with 275 sx cement. Cement should circulate.
- II. Move in rotary and drill to approx 4700'.
- III. Mud logger will be on well during rotary drilling.
- IV. Log with Schlumberger Laterlog-SFL and FDC-CNL.
- V. Run casing to TD and cement in two stages.
- VI. Set DV tool at approximately 3300', cement bottom stage 300 sx and cement top stage with 700 sx cement.

APPROVAL VALID
FOR 60 DAYS UNLESS
DRILLING COMMENCED.

EXPIRES 11-6-81

IN ABOVE SPACE DESCRIBE PROPOSED PROGRAM IF PROPOSAL IS TO DEEPEN OR PLUG BACK, GIVE DATA ON PRESENT PRODUCTIVE ZONE AND PROPOSED NEW PRODUCTIVE ZONE. GIVE BLOWOUT PREVENTER PROGRAM, IF ANY.

I hereby certify that the information above is true and complete to the best of my knowledge and belief.

Signed Dennis G. Fournier Title Geologist Date May 4, 1981

(This space for State Use)

APPROVED BY Frank J. Long TITLE SUPERVISOR DISTRICT # 3 DATE MAY 6 1981

CONDITIONS OF APPROVAL, IF ANY:

All distances must be from the outer boundaries of the Section.

Operator CARIBOU-FOUR CORNERS, INC.			Lease KIRTLAND		Well No. 8
Unit Letter 0	Section 11	Township 29N	Range 15W	County San Juan	
Actual Footage Location of Well: 510 feet from the South line and 1920 feet from the East line					
Ground Level Elev. 5126	Producing Formation Gallup		Pool Cha-Cha Gallup		Dedicated Acreage: 80 Acres

1. Outline the acreage dedicated to the subject well by colored pencil or hatchure marks on the plat below.
2. If more than one lease is dedicated to the well, outline each and identify the ownership thereof (both as to working interest and royalty).
3. If more than one lease of different ownership is dedicated to the well, have the interests of all owners been consolidated by communitization, unitization, force-pooling, etc?

☒ Yes ☐ No If answer is "yes," type of consolidation Force pooling row before the state.
Case #7231

If answer is "no," list the owners and tract descriptions which have actually been consolidated. (Use reverse side of this form if necessary.) _____

No allowable will be assigned to the well until all interests have been consolidated (by communitization, unitization, forced-pooling, or otherwise) or until a non-standard unit, eliminating such interests, has been approved by the Commission.

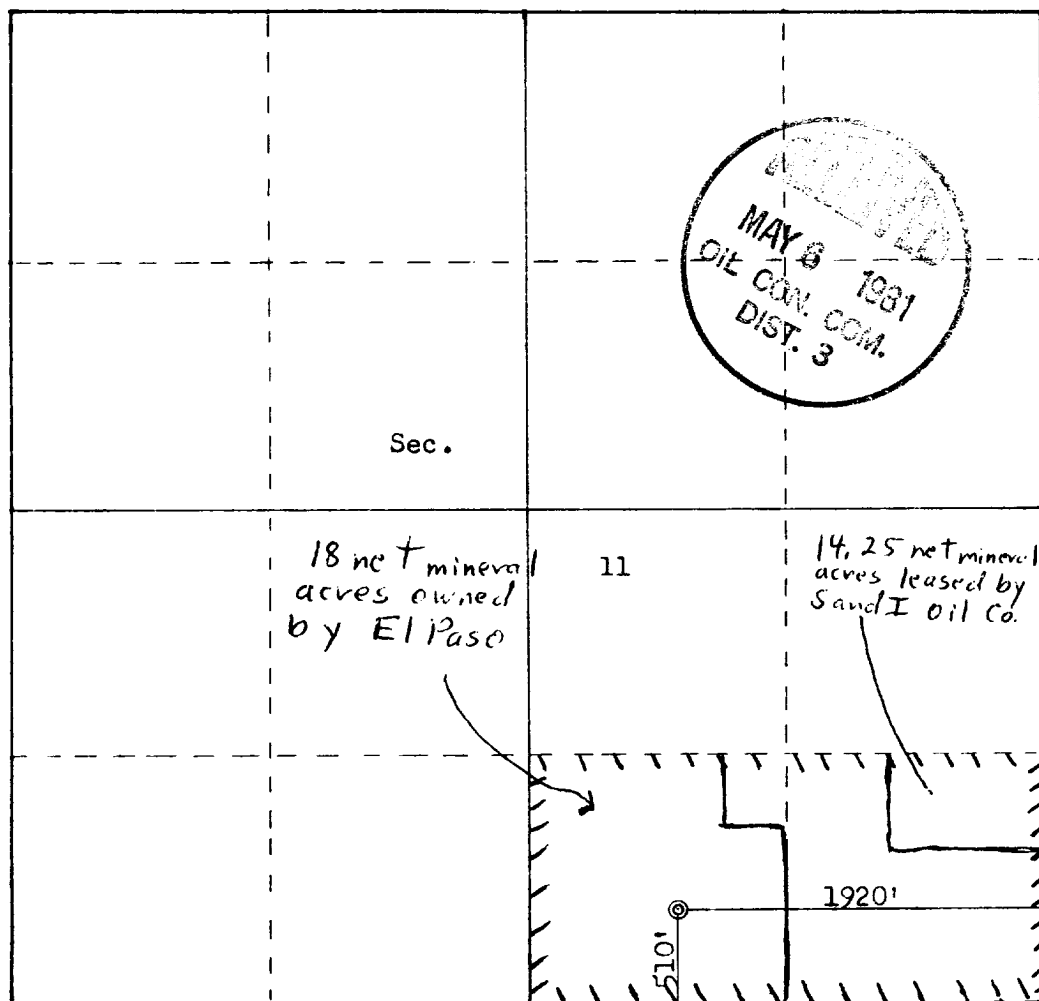

Scale: 1"=1000'

CERTIFICATION

I hereby certify that the information contained herein is true and complete to the best of my knowledge and belief.

George G. Forest
Name

Geologist

Position

Caribou Four Corners, Inc.

Company

May 4, 1981

Date

I hereby certify that the well location shown on this plat was plotted from field notes of actual surveys made by me or under my supervision, and that the same is true and correct to the best of my knowledge and belief.

Date Surveyed

January 16, 1981

Registered Professional Engineer and Land Surveyor

Fred B. Kerr Jr.
Fred B. Kerr Jr.

Certificate No.

3950