

OIL CONSERVATION DIVISION

STATE OF NEW MEXICO
OIL AND MINERALS DEPARTMENT

P. O. BOX 2083

SANTA FE, NEW MEXICO 87501

Form C-107
Revised 10-1-70

All distances must be from the outer boundaries of the Section.

Operator ARCO OIL & GAS			Lease STATE "B"		Well No. 1E
Unit Letter E	Section 16	Township 29N	Range 10W	County San Juan	
Actual Footage Location of Well:					
1800 feet from the North line and		1180 feet from the West line			
Ground Level Elev: 5748	Producing Formation Dakota	Pool Basin Dakota	Dedicated Acreage: 320 Acres		

1. Outline the acreage dedicated to the subject well by colored pencil or hatchure marks on the plat below.
2. If more than one lease is dedicated to the well, outline each and identify the ownership thereof (both as to working interest and royalty).
3. If more than one lease of different ownership is dedicated to the well, have the interests of all owners been consolidated by communitization, unitization, force-pooling, etc?

☒ Yes ☐ No If answer is "yes," type of consolidation Communitization

If answer is "no," list the owners and tract descriptions which have actually been consolidated. (Use reverse side of this form if necessary.) _____

No allowable will be assigned to the well until all interests have been consolidated (by communitization, unitization, forced-pooling, or otherwise) or until a non-standard unit, eliminating such interests, has been approved by the Commission.

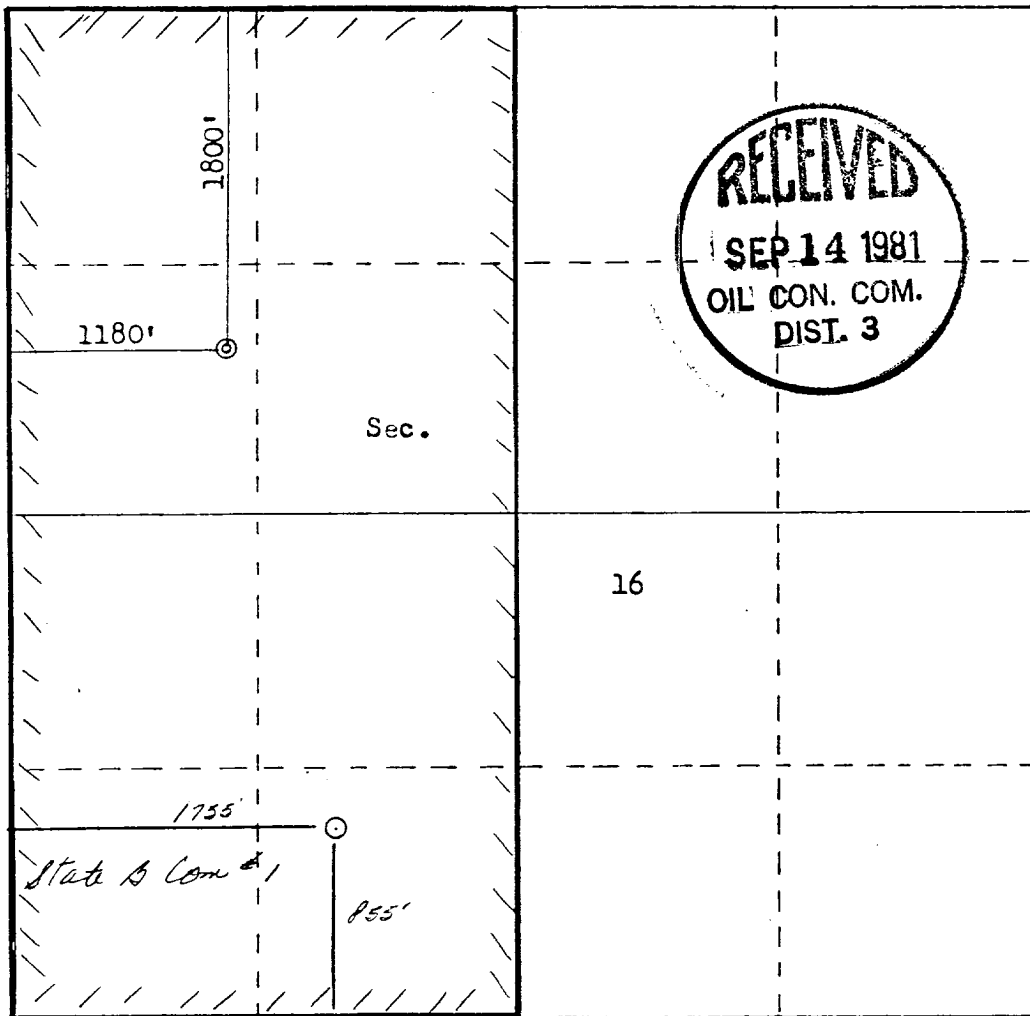

Scale: 1"=1000'

CERTIFICATION

I hereby certify that the information contained herein is true and complete to the best of my knowledge and belief.

Name W.A. Walther, Jr.
 Position District Manager of Production
 Company ARCO Oil & Gas Co, Div of Atlantic Richfield Company
 Date September 11, 1981

I hereby certify that the well location shown on this plat was plotted from field notes of actual surveys made by me or under my supervision, and that the same is true and correct to the best of my knowledge and belief.

Date Surveyed August 28, 1981
 Registered Professional Engineer and Land Surveyor
Fred B. Kerr, Jr.
 Certificate No. 3950 JR.