

NO. OF COPIES RECEIVED	
DISTRIBUTION	
SANTA FE	
FILE	
U.S.G.S.	
LAND OFFICE	
OPERATOR	

NEW MEXICO OIL CONSERVATION COMMISSION

30-045-25223

Form C-101
Revised 1-1-65

5A. Indicate Type of Lease	
STATE <input type="checkbox"/>	FEE <input checked="" type="checkbox"/>

5. State Oil & Gas Lease No.

APPLICATION FOR PERMIT TO DRILL, DEEPEN, OR PLUG BACK

1a. Type of Work		7. Unit Agreement Name	
b. Type of Well		Canyon Unit Com "F"	
DRILL <input checked="" type="checkbox"/>	DEEPEN <input type="checkbox"/>	8. Farm or Lease Name	
SINGLE ZONE <input type="checkbox"/>	MULTIPLE ZONE <input type="checkbox"/>	9. Well No.	
c. Name of Operator		162E	
Amoco Production Company		10. Field and Pool, or Wildcat	
d. Address of Operator		Basin Dakota	
501 Airport Drive, Farmington, NM 87401		11. Location of Well	
UNIT LETTER B LOCATED 1180 FEET FROM THE North LINE		12. County	
AND 1590 FEET FROM THE East LINE OF SEC. 36 TWP. 29N RGE. 12W NMPM		San Juan	
13. Proposed Depth		13A. Formation	
6108'		Dakota	
13B. Drilling Contractor		23. Rotary or C.T.	
Unknown		Rotary	
21A. Kind & Status Plug. Bond		22. Approx. Date Work will start	
Statewide		As soon as permitted	
21B. Drilling Contractor			
5362' G.L.			

PROPOSED CASING AND CEMENT PROGRAM

SIZE OF HOLE	SIZE OF CASING	WEIGHT PER FOOT	SETTING DEPTH	SACKS OF CEMENT	EST. TOP
12 1/4"	8 5/8"	24.0 #	300'	315 sx	Surface
7 7/8"	4 1/2"	11.6 #	6108'	1100 sx	Surface

Amoco proposes to drill the above well to further develop the Basin Dakota reservoir. The well will be drilled to the surface casing point using native mud. The well will then be drilled to TD with a low solids nondispersed mud system. Completion design will be based on open hole logs. Copy of all logs will be filed upon completion. Amoco's standard blowout prevention will be employed; see attached drawing for blowout preventer design.

Upon completion the well location will be cleaned and the reserve pit filled and leveled.

Gas produced from this well is not dedicated to a gas sales contract.

APPROVAL VALID
FOR ~~60 DAYS~~ UNLESS
DRILLING COMMENCED,

EXPIRES 4-15-82



IN ABOVE SPACE DESCRIBE PROPOSED PROGRAM: IF PROPOSAL IS TO DEEPEN OR PLUG BACK, GIVE DATA ON PRESENT PRODUCTIVE ZONE AND PROPOSED NEW PRODUCTIVE ZONE. GIVE BLOWOUT PREVENTER PROGRAM, IF ANY.

I hereby certify that the information above is true and complete to the best of my knowledge and belief.

Signed Wayne L. Pittman Title District Engineer Date 10-13-81

(This space for State Use)

APPROVED BY Frank J. Chazy TITLE SUPERVISOR DISTRICT # 3 DATE OCT 15 1981

CONDITIONS OF APPROVAL, IF ANY:

All distances must be from the outer boundaries of the Section.

Operator AMOCO PRODUCTION COMPANY		Lease GALLEGOS CANYON UNIT COM "F"		Well No. 162E
Well Letter B	Section 36	Township 29N	Range 12W	County San Juan
Actual Footage Location of Well: 1180 feet from the North line and 1590 feet from the East line				
Ground Level Elev: 5362	Producing Formation Dakota	Pool Basin Dakota	Dedicated Acreage 320 Acres	

1. Outline the acreage dedicated to the subject well by colored pencil or hatchure marks on the plat below.
2. If more than one lease is dedicated to the well, outline each and identify the ownership thereof (both as to working interest and royalty).
3. If more than one lease of different ownership is dedicated to the well, have the interests of all owners been consolidated by communitization, unitization, force-pooling, etc?

☒ Yes ☐ No If answer is "yes," type of consolidation Communitization

If answer is "no," list the owners and tract descriptions which have actually been consolidated. (Use reverse side of this form if necessary.)

No allowable will be assigned to the well until all interests have been consolidated (by communitization, unitization, forced-pooling, or otherwise) or until a non-standard unit, eliminating such interests, has been approved by the Commission.

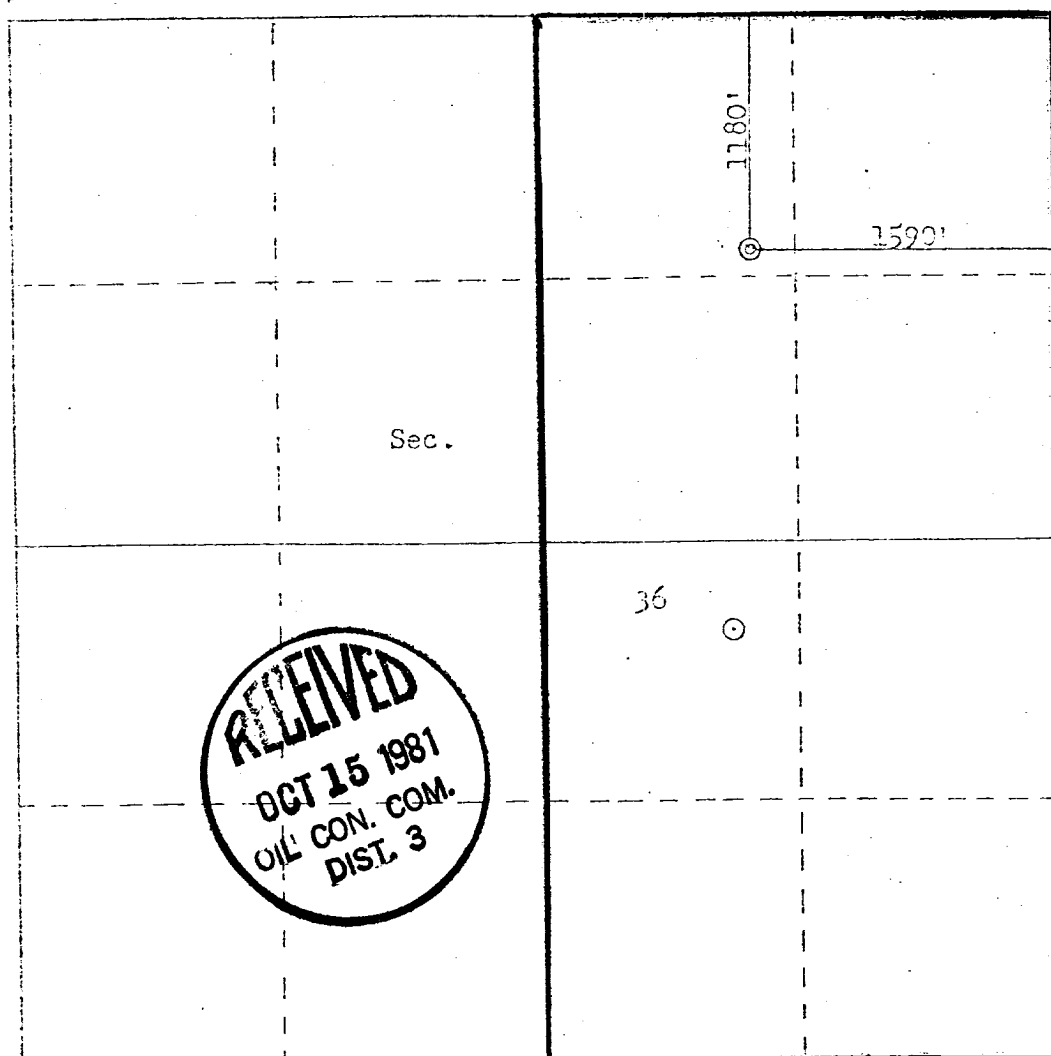

CERTIFICATION

I hereby certify that the information contained herein is true and complete to the best of my knowledge and belief.

W. L. Peterson
Name

W. L. PETERSON

Position
DISTRICT ENGINEER

Company
AMOCO PRODUCTION COMPANY

Date
2-12-81

I hereby certify that the well location shown on this plat was plotted from field notes of actual surveys made by me or under my supervision, and that the same is true and correct to the best of my knowledge and belief.

Date Surveyed
December 15, 1980

Registered Professional Engineer
and Land Surveyor
Fred E. Kerr Jr.
Fred E. Kerr Jr.

Certification No.
3950
F. E. KERR, JR.

Scale: 1"=1000'

1. Blowout Preventers and Master Valve to be fluid operated, and all fittings must be in good condition.
2. Equipment through which bit must pass shall be as large as the inside diameter of the casing that is being drilled through.
3. Nipple above Blowout Preventer shall be same size or larger than BOP being drilled through.
4. All fittings to be flanged.
5. Omsco or comparable safety valve must be available on rig floor at all times with proper connection or sub. The I.D. of safety valve should be as great as I.D. of tool joints of drill pipe, or at least as great as I.D. of drill collars.

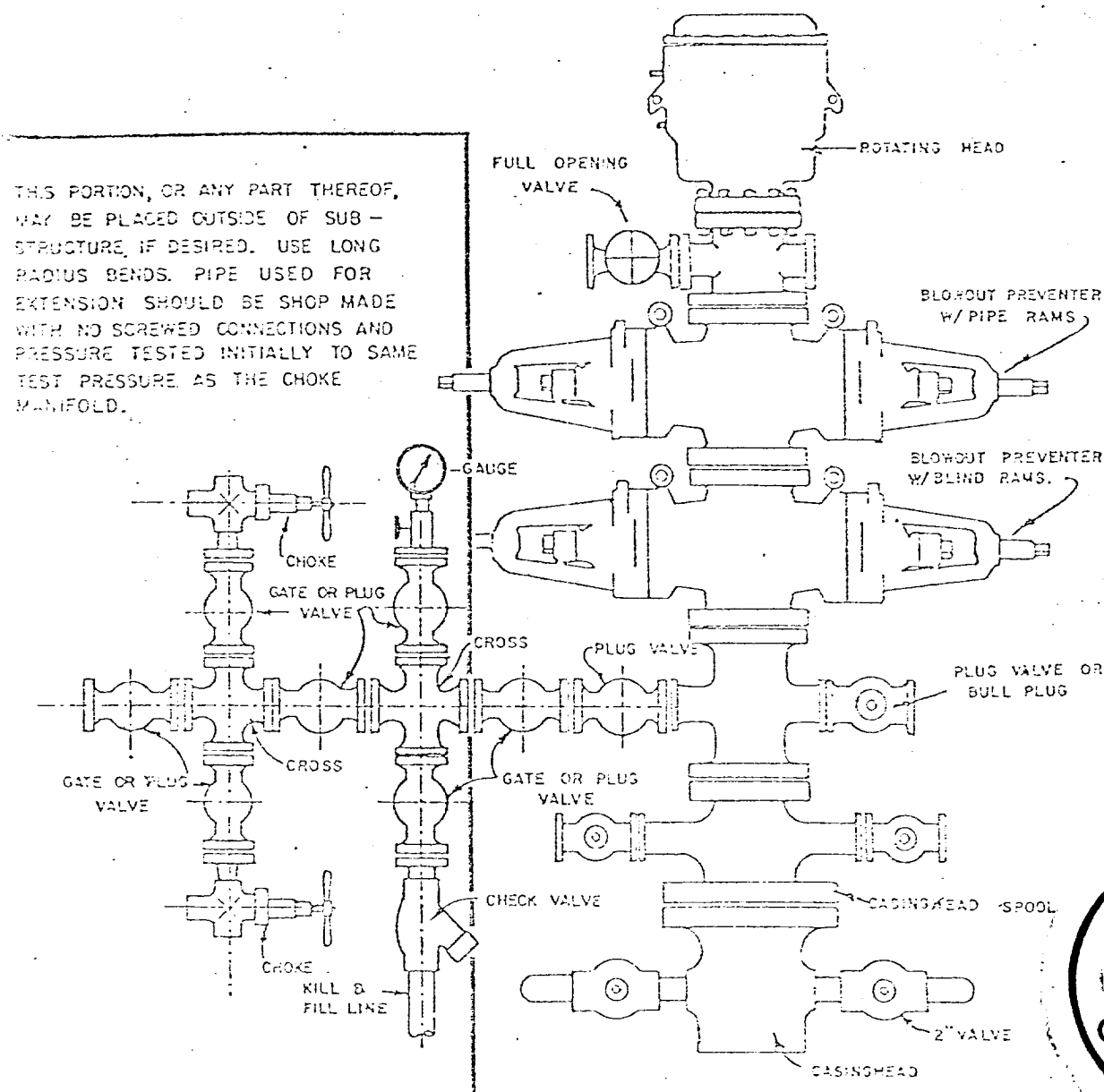

BLOWOUT PREVENTER HOOKUP

API Series # 900



EXHIBIT D-4

OCTOBER 16, 1959

Operation of BOP by closing both pipe and blind rams will be tested each trip or, on long bit runs, pipe rams will be closed once each 24 hours.