



STATE OF NEW MEXICO  
ENERGY AND MINERALS DEPARTMENT  
OIL CONSERVATION DIVISION

8-25-81  
10-9-81  
11-12-81

BRUCE KING  
GOVERNOR  
LARRY KEHOE  
SECRETARY

April 14, 1981

POST OFFICE BOX 2088  
STATE LAND OFFICE BUILDING  
SANTA FE, NEW MEXICO 87501  
(505) 827-2434

Amoco Production Company  
Petroleum Center Building  
501 Airport Drive  
Farmington, New Mexico 87401

Attention: Mr. R. W. Schroeder

Administrative Order NSL-1342

Gentlemen:

Reference is made to your application for approval of a non-standard location for your Martinez Gas Com "G" No. 1E located 585 feet from the North line and 1220 feet from the West line of Section 24, Township 29 North, Range 10 West, NMPM, Basin Dakota Field, San Juan County, New Mexico.

By authority granted me under the provisions of Rule 3 of Order No. R-1670, the above-described unorthodox location is hereby approved.

Sincerely,

JOE D. RAMEY,  
Director

JDR/RLS/dr

cc: Oil Conservation Division - Aztec  
Oil & Gas Engineering Committee - Hobbs





STATE OF NEW MEXICO  
ENERGY AND MINERALS DEPARTMENT

OIL CONSERVATION DIVISION  
AZTEC DISTRICT OFFICE

1000 RIO BRAZOS ROAD  
AZTEC, NEW MEXICO 87410  
(505) 834-6178

OIL CONSERVATION DIVISION  
BOX 2088  
SANTA FE, NEW MEXICO 87501

DATE 4-17-81

RE: Proposed MC \_\_\_\_\_  
Proposed DHC \_\_\_\_\_  
Proposed NSL x \_\_\_\_\_  
Proposed SWD \_\_\_\_\_  
Proposed WFX \_\_\_\_\_  
Proposed PMX \_\_\_\_\_

Gentlemen:

I have examined the application dated 3-26-81  
for the Agnew Martinez Sun Con Co #1E D-24-29N-10W  
Operator Lease and Well No. Unit, S-T-R

and my recommendations are as follows:

Agnew  
\_\_\_\_\_  
\_\_\_\_\_  
\_\_\_\_\_  
\_\_\_\_\_

Yours truly,

Frank J. Dwyer



**Amoco Production Company**

Petroleum Center Building  
501 Airport Drive  
Farmington, New Mexico 87401  
505-325-8841

R. W. Schroeder  
District Superintendent

March 23, 1981

Mr. Joe D. Ramey  
New Mexico Oil Conservation Division  
P. O. Box 2088  
Santa Fe, NM 87501

File: RWS-230-400.1

Dear Mr. Ramey:

Application for Unorthodox Location  
Martinez Gas Com "G" No. 1E  
Basin Dakota Field  
San Juan County, New Mexico

Amoco Production Company hereby requests approval of our Martinez Gas Com "G" No. 1E at a location 585' FNL and 1220' FWL Section 24, T29N, R10W.

The attached Form C-102 illustrates the topographic problems encountered in selecting a suitable well site. The selected location is only 100' from the NW/4 NW/4 line, and 585' from the North line of Section 24.

A copy of this application is being sent to the offset operators, El Paso Natural Gas and Southland Royalty, with the request they furnish you a waiver of objection and return one copy of the same to me.

Yours very truly,

*[Signature]*  
R. W. Schroeder

MDD/pbr  
Attachments

cc: Frank Chavez  
New Mexico Oil Conservation Division  
1000 Rio Brazos Road  
Aztec, NM 87410

Southland Royalty  
410 17th St. No. 1000  
Denver, CO 80202

El Paso Natural Gas Company  
P. O. Box 990  
Farmington, NM 87401  
Attn: Regional Land Manager

G. J. Ross - Denver

G. D. Ryan - Denver



\_\_\_\_\_ hereby waives objection to Amoco's application for an unorthodox location as proposed above.

By: \_\_\_\_\_

Date: \_\_\_\_\_

# Memo

From

Frank J. Chavez

To

Deputy Oil & Gas Inspector

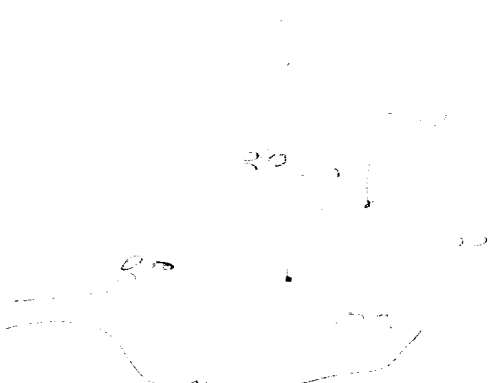

1063  
890  
173  
-----  
563

*[Faint handwritten signature]*

All distances must be from the outer boundaries of the Section.

WF

Operator <b>AMOCO PRODUCTION COMPANY</b>			Lease <b>MARTINEZ GAS COM. #1</b>		Well No. <b>1E</b>
Unit Letter <b>D</b>	Section <b>24</b>	Township <b>29N</b>	Range <b>10W</b>	County <b>San Juan</b>	
Actual Footage Location of Well: <b>585</b> feet from the <b>North</b> line and <b>1220</b> feet from the <b>West</b> line					
Ground Level Elev: <b>5759</b>	Producing Formation <b>Dakota</b>		Pool <b>Basin Dakota</b>		Dedicated Acreage: <b>320</b> Acres

1. Outline the acreage dedicated to the subject well by colored pencil or hatchure marks on the plat below.
2. If more than one lease is dedicated to the well, outline each and identify the ownership thereof (both as to working interest and royalty).
3. If more than one lease of different ownership is dedicated to the well, have the interests of all owners been consolidated by communitization, unitization, force-pooling, etc?

☒ Yes ☐ No If answer is "yes," type of consolidation Communitization

If answer is "no," list the owners and tract descriptions which have actually been consolidated. (Use reverse side of this form if necessary.)

No allowable will be assigned to the well until all interests have been consolidated (by communitization, unitization, forced-pooling, or otherwise) or until a non-standard unit, eliminating such interests, has been approved by the Commission.

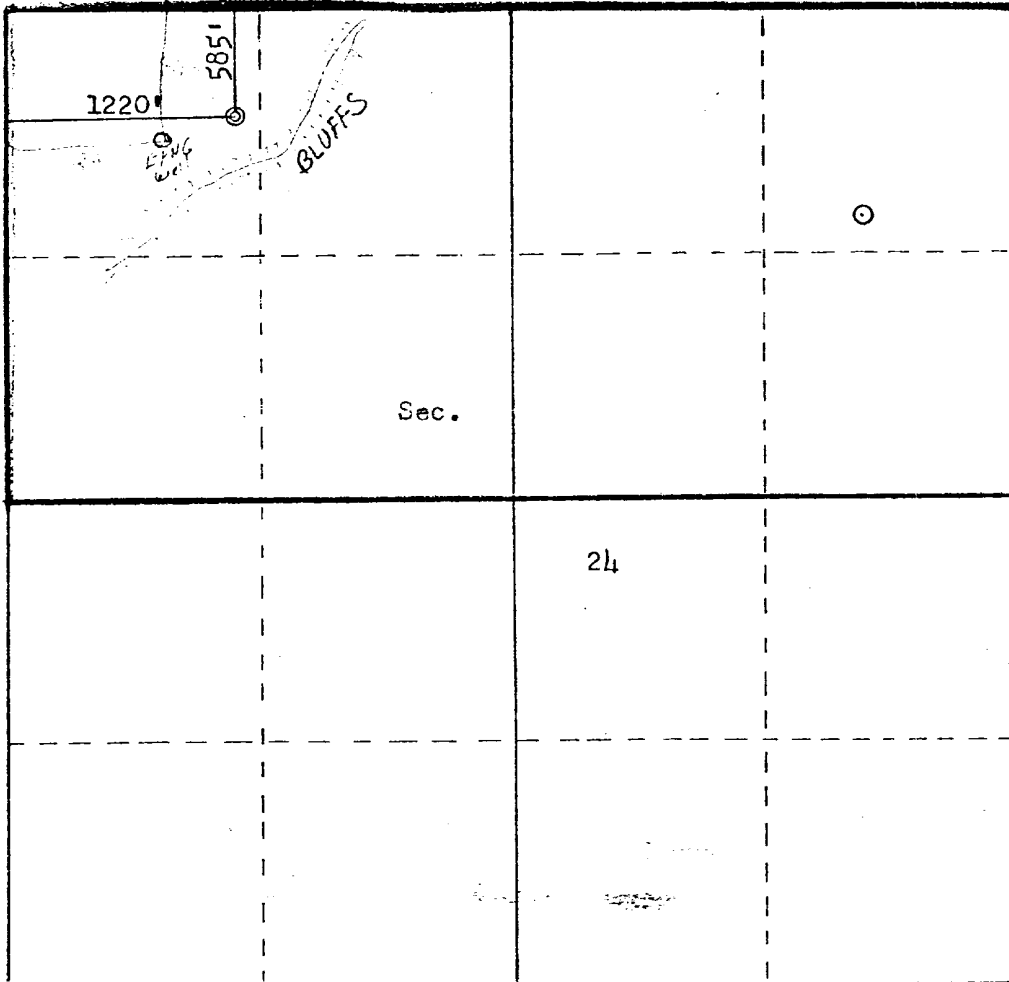

Scale: 1"=1000'

CERTIFICATION

I hereby certify that the information contained herein is true and complete to the best of my knowledge and belief.

*Wayne L. Peterson*

Name

W. L. PETERSON

Position

DISTRICT ENGINEER

Company

AMOCO PRODUCTION COMPANY

Date

2/25/81

I hereby certify that the well location shown on this plat was plotted from field notes of actual surveys made by me or under my supervision, and that the same is true and correct to the best of my knowledge and belief.

Date Surveyed

February 2, 1981

Registered Professional Engineer  
and Land Surveyor

*Fred B. Kerr Jr.*  
Fred B. Kerr Jr.

Certificate No.

3950

MARTINEZ GAS COM G #1E

R10W

R9W

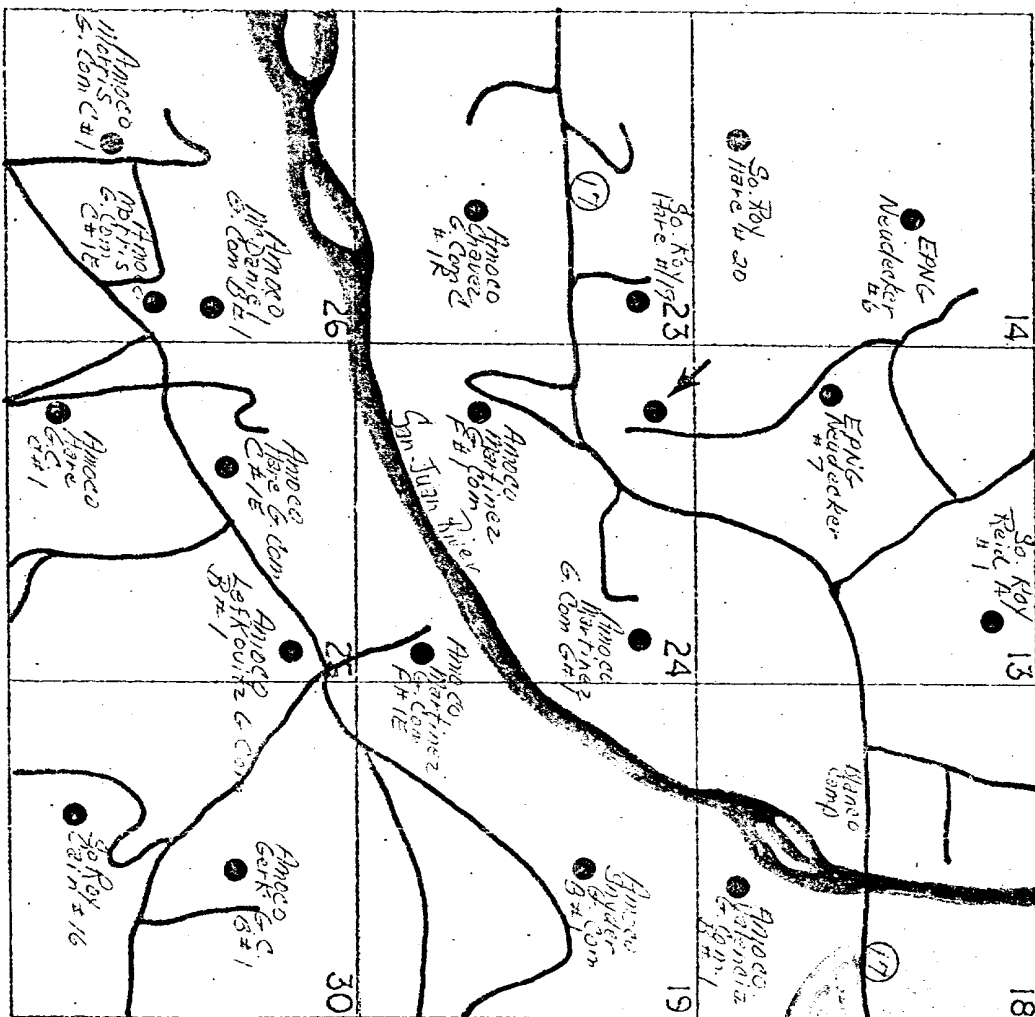

EXISTING BASIN DAKOTA WELLS ●

ROADS —

PROPOSED WELL LOCATION ●

RIVER ~

# Memo

From

Frank J. Chavez

To

Deputy Oil & Gas Inspector

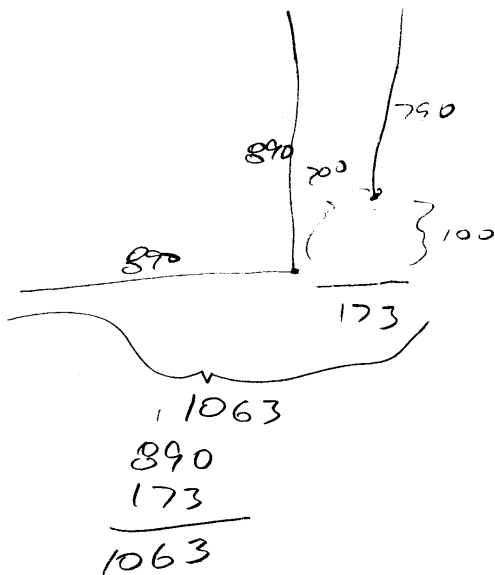

Jo Am Sallegos [Signature]