

NO. OF COPIES RECEIVED		
DISTRIBUTION		
SANTA FE		
FILE		
U.S.G.S.		
LAND OFFICE		
OPERATOR		

NEW MEXICO OIL CONSERVATION COMMISSION

Form C-101
Revised 1-1-65

5A. Indicate Type of Lease	
STATE <input checked="" type="checkbox"/>	FEE <input type="checkbox"/>
5. State Oil & Gas Lease No. B10405	

APPLICATION FOR PERMIT TO DRILL, DEEPEN, OR PLUG BACK

1a. Type of Work			7. Unit Agreement Name		
b. Type of Well OIL WELL <input type="checkbox"/> GAS WELL <input checked="" type="checkbox"/> OTHER <input type="checkbox"/>			8. Farm or Lease Name Wright Com		
2. Name of Operator Tenneco Oil Company			9. Well No. 1		
3. Address of Operator P. O. Box 3249, Englewood, CO 80155			10. Field and Pool, or Wildcat Chacra 40005		
4. Location of Well UNIT LETTER D LOCATED 810 FEET FROM THE north LINE AND 790 FEET FROM THE west LINE OF SEC. 32 TWP. 29N RGE. 9W NMPM			12. County San Juan		
19. Proposed Depth 3290'			19A. Formation Chacra		20. Rotary or C.T. Rotary
21. Elevations (Show whether DF, RT, etc.) 5783' ground	21A. Kind & Status Plug. Bond general	21B. Drilling Contractor Four Corners	22. Approx. Date Work will start ASAP		

23.

PROPOSED CASING AND CEMENT PROGRAM

SIZE OF HOLE	SIZE OF CASING	WEIGHT PER FOOT	SETTING DEPTH	SACKS OF CEMENT	EST. TOP
12-1/4"	8-5/8"	24#	+ 200'	150	Circ cmt to surface
7-7/8"	4-1/2"	10.5#	- 3290'	150	Circ cmt to cover all productive zones

See attached drilling procedure.

Gas is dedicated.

APPROVED FOR
FOR 6/1/82
DRILLING COMMENCED
EXPIRES Sept. 27, 1982

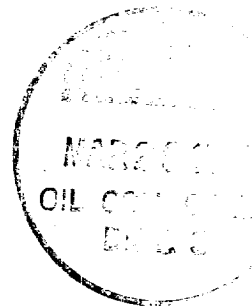

IN ABOVE SPACE DESCRIBE PROPOSED PROGRAM: IF PROPOSAL IS TO DEEPEN OR PLUG BACK, GIVE DATA ON PRESENT PRODUCTIVE ZONE AND PROPOSED NEW PRODUCTIVE ZONE. GIVE BLOWOUT PREVENTER PROGRAM, IF ANY.

I hereby certify that the information above is true and complete to the best of my knowledge and belief.

Signed Ken Russell Title Sr. Production Analyst Date 3/17/82

(This space for State Use)

APPROVED BY Frank T. Chang TITLE STATE ENGINEER DATE MAR 20 1982

CONDITIONS OF APPROVAL, IF ANY:

OIL CONSERVATION DIVISION

STATE OF NEW MEXICO

P. O. BOX 2088

Form C-107

ENERGY AND MINERALS DEPARTMENT

SANTA FE, NEW MEXICO 87501

Revised 10-1-78

All distances must be from the outer boundaries of the Section.

Operator TENNECO OIL COMPANY		Lease WRIGHT COM		Well No. #1	
Unit Letter D	Section 32	Township 29N	Range 9W	County San Juan	
Actual Footage Location of Well: 810 feet from the North line and 790 feet from the West line					
Ground Level Elev: 5783	Producing Formation CHACRA		Pool CHACRA CAYDE		Dedicated Acreage: 160 Acres

1. Outline the acreage dedicated to the subject well by colored pencil or hachure marks on the plat below.
2. If more than one lease is dedicated to the well, outline each and identify the ownership thereof (both as to working interest and royalty).
3. If more than one lease of different ownership is dedicated to the well, have the interests of all owners been consolidated by communitization, unitization, force-pooling, etc?

☐ Yes ☐ No If answer is "yes," type of consolidation _____

If answer is "no," list the owners and tract descriptions which have actually been consolidated. (Use reverse side of this form if necessary.) _____

No allowable will be assigned to the well until all interests have been consolidated (by communitization, unitization, forced-pooling, or otherwise) or until a non-standard unit, eliminating such interests, has been approved by the Commission.

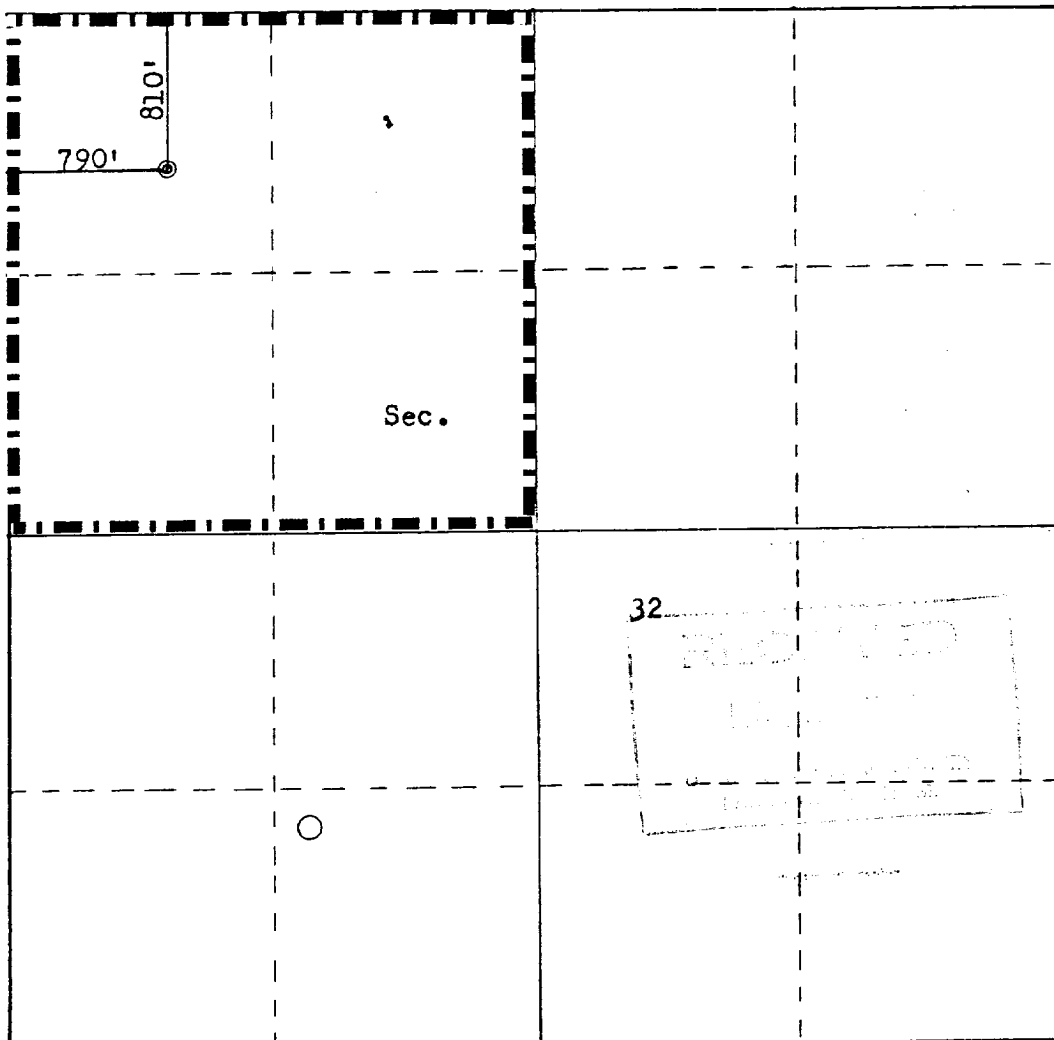

Scale: 1"=1000'

CERTIFICATION

I hereby certify that the information contained herein is true and complete to the best of my knowledge and belief.

Name

Don H. Morrison

Don H. Morrison

Position

Production Analyst

Company

Tenneco Oil Company

Date

September 22, 1981

I hereby certify that the well location shown on this plat was plotted from field notes of actual surveys made by me or under my supervision, and that the same is true and correct to the best of my knowledge and belief.

Date Surveyed

February 9, 1982

Registered Professional Engineer and Land Surveyor

Fred B. Kerr Jr.
Fred B. Kerr Jr.

Certificate No.

3950

4371
INAJAO DAMI



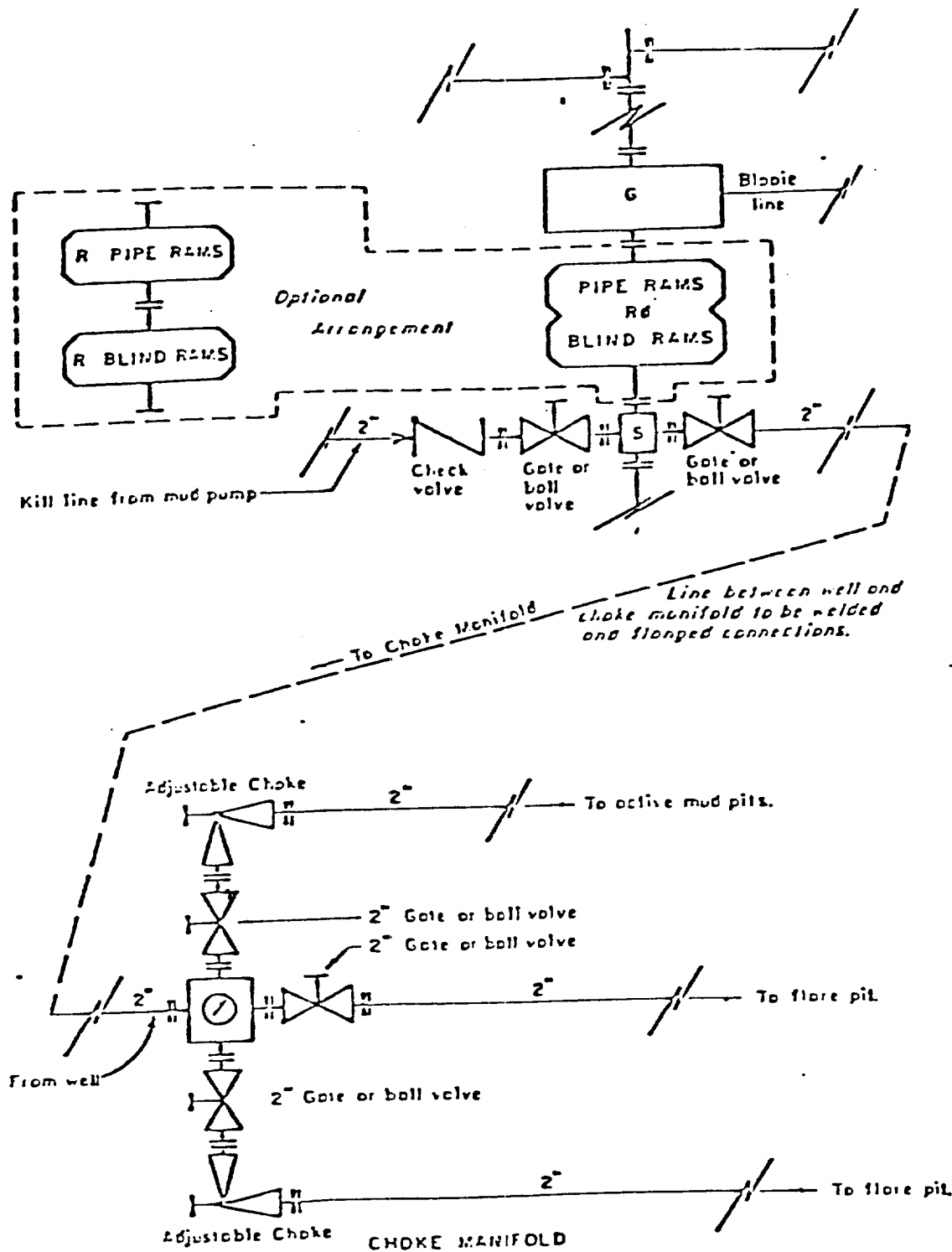

All equipment to be 3,000 psi working pressure except as noted.

- Rd Double ram type preventer with two sets of rams.
- R Single ram type preventer with one set of rams.
- S Drilling spool with side outlet connections for choke and kill lines.
- G Rotating head 150 psi working pressure minimum

ARRANGEMENT C

TENNECO OIL COMPANY
ROCKY MOUNTAIN DIVISION
REQUIRED MINIMUM
BLOWOUT PREVENTER AND
CHOKES MANIFOLD

J. MAGILL 10-26-78 EVI