

UNITED STATES
DEPARTMENT OF THE INTERIOR
GEOLOGICAL SURVEY

30-045-25423

APPLICATION FOR PERMIT TO DRILL, DEEPEN, OR PLUG BACK

1a. TYPE OF WORK

DRILL ☒DEEPEN ☐PLUG BACK ☐

5. LEASE DESIGNATION AND SERIAL NO.

SF-079065

6. IF INDIAN, ALLOTTEE OR TRIBE NAME

7. UNIT AGREEMENT NAME

8. FARM OR LEASE NAME

Hagood

9. WELL NO.

5-E

10. FIELD AND POOL, OR WILDCAT

Basin Dakota

11. SEC., T., R., M., OR BLK.
AND SURVEY OR AREA

A Section 29, T29N, R13W

12. COUNTY OR PARISH

San Juan

New Mexico

b. TYPE OF WELL

OIL
WELL ☐GAS
WELL ☒

OTHER

SINGLE
ZONE ☒MULTIPLE
ZONE ☐

2. NAME OF OPERATOR

Southland Royalty Company

3. ADDRESS OF OPERATOR

P.O. Drawer 570, Farmington, New Mexico 87499-0570

4. LOCATION OF WELL (Report location clearly and in accordance with any State requirements.)*

At surface

685' FNL & 430' FEL

At proposed prod. zone

14. DISTANCE IN MILES AND DIRECTION FROM NEAREST TOWN OR POST OFFICE*

3 miles South of Farmington, New Mexico

15. DISTANCE FROM PROPOSED*

LOCATION TO NEAREST
PROPERTY OR LEASE LINE, FT.
(Also to nearest drlg. unit line, if any)

430'

18. DISTANCE FROM PROPOSED LOCATION*
TO NEAREST WELL, DRILLING, COMPLETED,
OR APPLIED FOR, ON THIS LEASE, FT.

60'

16. NO. OF ACRES IN LEASE

1475.90

19. PROPOSED DEPTH

6120'

17. NO. OF ACRES ASSIGNED
TO THIS WELL

E 320

20. ROTARY OR CABLE TOOLS

Rotary

21. ELEVATIONS (Show whether DF, RT, GR, etc.)

5545'

22. APPROX. DATE WORK WILL START*

February 15, 1982

23.

PROPOSED CASING AND CEMENTING PROGRAM

SIZE OF HOLE	SIZE OF CASING	WEIGHT PER FOOT	SETTING DEPTH	QUANTITY OF CEMENT
12-1/4"	8-5/8"	24#	200'	165 cu.ft. (Circ to surface)
7-7/8"	4-1/2"	10.5#	6120'	STAGE ONE: 320 cu.ft. (Cover Gallup)
				STAGE TWO: 318 cu.ft. (Cover Cliff House.)
				STAGE THREE: 208 cu.ft. (Cover Fruitland)

Surface formation is Ojo Alamo Sandstone.

Top of Fruitland sand is at 979'.

Top of Pictured Cliffs sand is at 1252'.

Fresh water mud will be used to drill from surface to Total Depth.

It is anticipated that an IEL will be run from Total Depth to surface casing and GR-Density
will be run from Total Depth to 900'.

No abnormal pressures or poisonous gases are anticipated in this well.

It is expected that this well will be drilled before April 1, 1982.

This depends on time required for approvals, rig availability and the weather.
Gas is dedicated.

IN ABOVE SPACE DESCRIBE PROPOSED PROGRAM: If proposal is to deepen or plug back, give data on present productive zone and proposed new productive zone. If proposal is to drill or deepen directionally, give pertinent data on subsurface locations and measured and true vertical depths. Give blowout preventer program, if any.

24.

SIGNED

R. E. Fielder

TITLE

District Engineer

DATE

January 19, 1982

(This space for Federal or State office use)

PERMIT NO.

APPROVAL DATE

APPROVED BY

TITLE

DRILLING OPERATIONS AUTHORIZED ARE
SUBJECT TO COMPLIANCE WITH ATTACHED
"GENERAL REQUIREMENTS"This action is subject to administrative
appeal pursuant to 30 CFR 290.

Hold C104 for NSL

OK 7

NMOCC

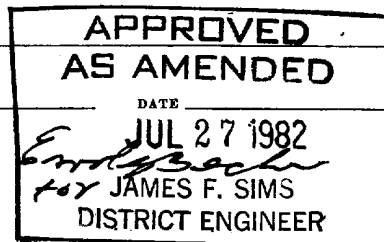

All distances must be from the outer boundaries of the Section.

Operator Southland Royalty Company			Lease Hagood		Well No. 5E
Unit Letter A	Section 29	Township 29N	Range 13W	County San Juan	
Actual Footage Location of Well: 685 feet from the North line and 430 feet from the East line					
Ground Level Elev. 5545	Producing Formation Dakota		Pool Basin	Dedicated Acreage: E 320 Acres	

1. Outline the acreage dedicated to the subject well by colored pencil or hachure marks on the plat below.
2. If more than one lease is dedicated to the well, outline each and identify the ownership thereof (both as to working interest and royalty).
3. If more than one lease of different ownership is dedicated to the well, have the interests of all owners been consolidated by communitization, unitization, force-pooling, etc?

☐ Yes ☐ No If answer is "yes," type of consolidation _____

If answer is "no," list the owners and tract descriptions which have actually been consolidated. (Use reverse side of this form if necessary.) _____

No allowable will be assigned to the well until all interests have been consolidated (by communitization, unitization, forced-pooling, or otherwise) or until a non-standard unit, eliminating such interests, has been approved by the Commission.

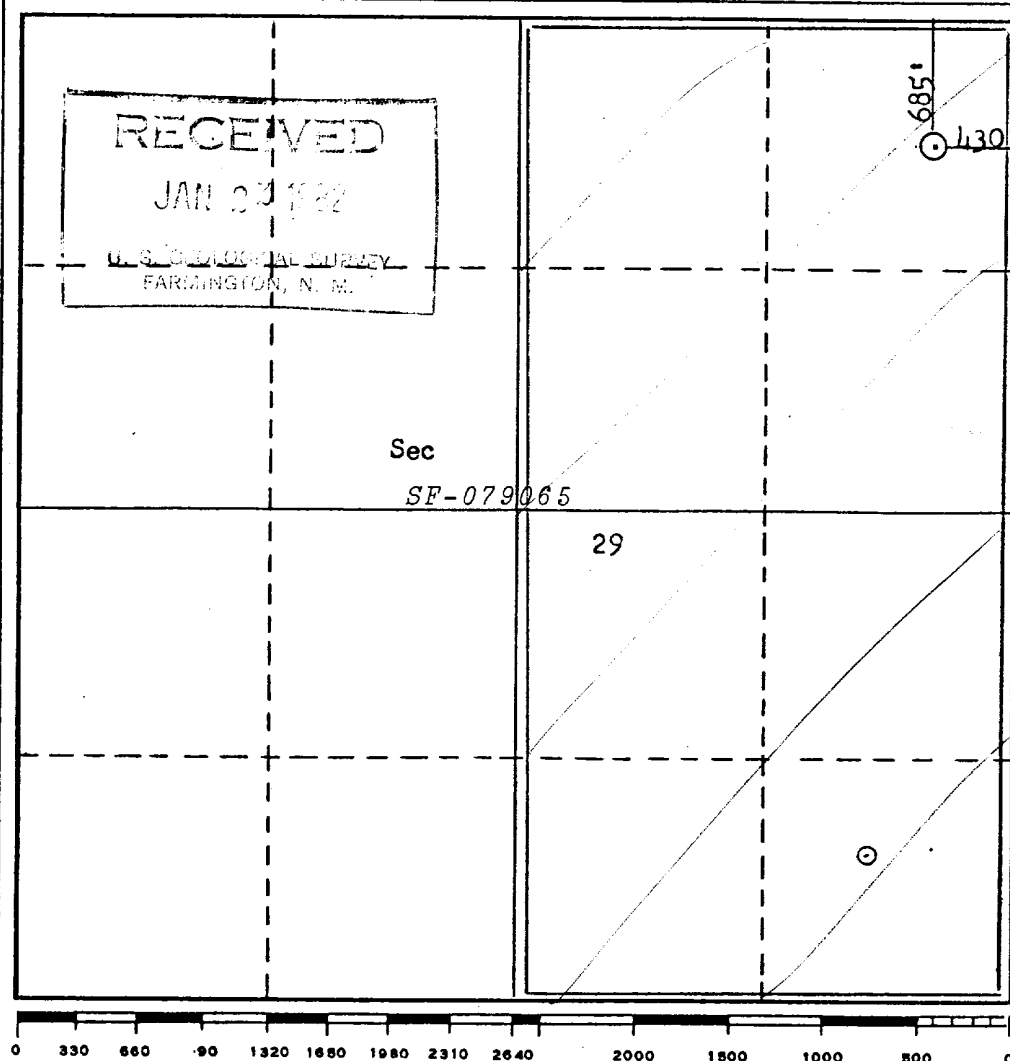

CERTIFICATION

I hereby certify that the information contained herein is true and complete to the best of my knowledge and belief.

R. E. Fielder

Name
R. E. Fielder
Position
District Engineer
Company
Southland Royalty Company
Date
January 19, 1982

I hereby certify that the well location shown on this plat was plotted from field notes of actual surveys made by me or under my supervision, and that the same is true and correct to the best of my knowledge and belief.

Date Surveyed
December 2, 1981
Registered Professional Engineer and/or Land Surveyor
Fred B. Kerr Jr.
Fred B. Kerr Jr.
Certificate No.
3950

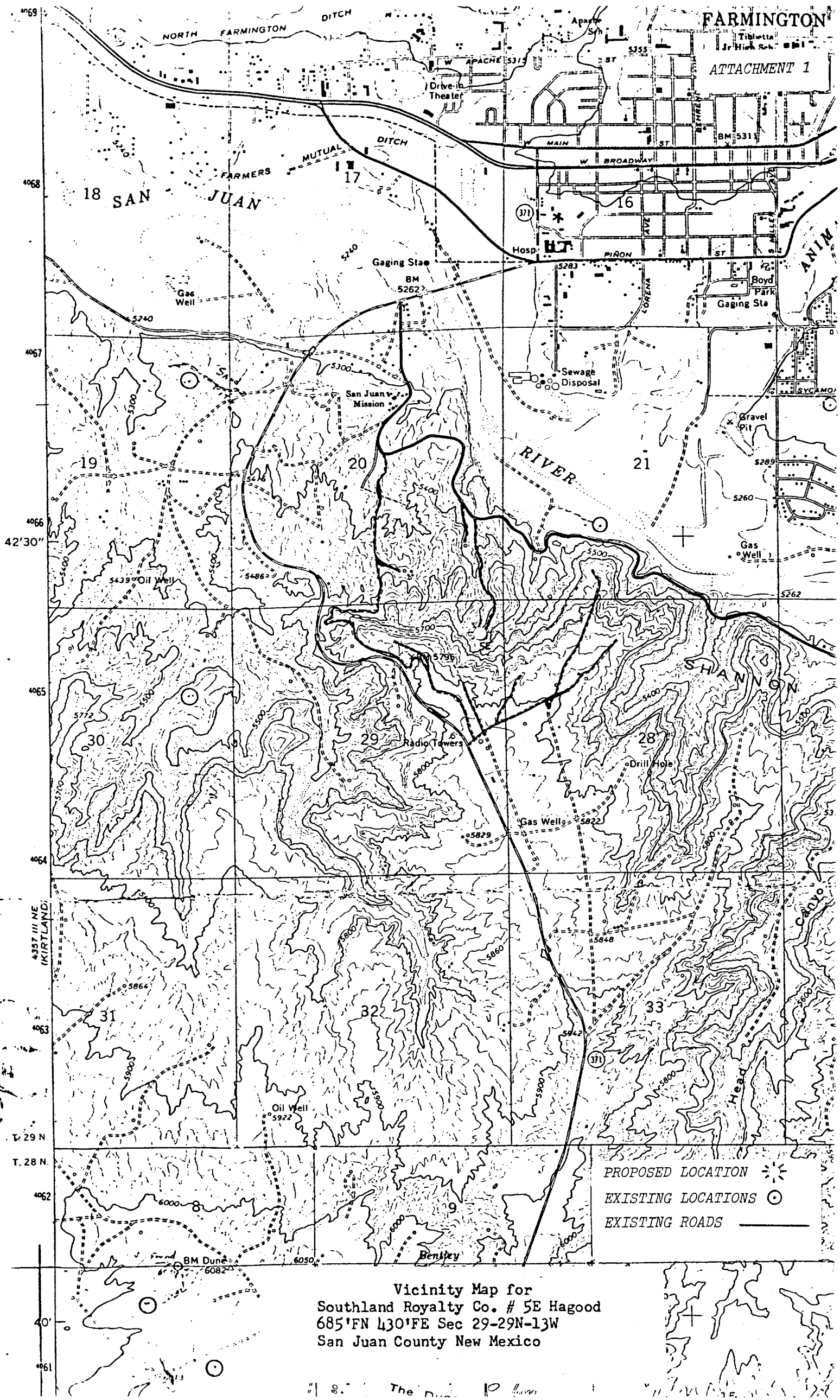

FARMINGTON

ATTACHMENT 1

18 SAN JUAN

RIVER

SHANNON

PROPOSED LOCATION
EXISTING LOCATIONS
EXISTING ROADS

Vicinity Map for
Southland Royalty Co. # 5E Hagood
685'FN 430'FE Sec 29-29N-13W
San Juan County New Mexico

UNITED STATES
DEPARTMENT OF THE INTERIOR
GEOLOGICAL SURVEY

SUNDRY NOTICES AND REPORTS ON WELLS

(Do not use this form for proposals to drill or to deepen or plug back to a different reservoir. Use Form 9-331-C for such proposals.)

1. oil ☐ well gas ☒ well other ☐

2. NAME OF OPERATOR

Southland Royalty Company

3. ADDRESS OF OPERATOR

P.O. Drawer 570, Farmington, NM

4. LOCATION OF WELL (REPORT LOCATION CLEARLY. See space 17 below.)

AT SURFACE: 685' FNL & 430' FEL

AT TOP PROD. INTERVAL:

AT TOTAL DEPTH:

16. CHECK APPROPRIATE BOX TO INDICATE NATURE OF NOTICE, REPORT, OR OTHER DATA

REQUEST FOR APPROVAL TO:

TEST WATER SHUT-OFF ☐

FRACTURE TREAT ☐

SHOOT OR ACIDIZE ☐

REPAIR WELL ☐

PULL OR ALTER CASING ☐

MULTIPLE COMPLETE ☐

CHANGE ZONES ☐

ABANDON* ☐

(other) Spud & Casing Report

SUBSEQUENT REPORT OF:

☐

☐

☐

☐

☐

☐

☐

☐

☒

5. H.A.

SE - 0790

6. IF INDIAN, ALLOTTEE OR TRIBE NAME

7. UNIT AGREEMENT NAME

8. FARM OR LEASE NAME

Hagood

9. WELL NO.

#5E

10. FIELD OR WILDCAT NAME

Basin Dakota

11. SEC., T., R., M., OR BLK. AND SURVEY OR AREA

Section 29, T29N, R13W

12. COUNTY OR PARISH

San Juan

13. STATE

New Mexico

14. API NO.

15. ELEVATIONS (SHOW DF, KDB, AND WD)

5545'

(NOTE: Report results of multiple completion or zone change on Form 9-330.)

17. DESCRIBE PROPOSED OR COMPLETED OPERATIONS (Clearly state all pertinent details, and give pertinent dates, including estimated date of starting any proposed work. If well is directionally drilled, give subsurface locations and measured and true vertical depths for all markers and zones pertinent to this work.)*

8-29-82 Spudded 12-1/4" surface hole at 9:30 pm on 8-28-82 and drilled to a total depth of 245'. Set five joints (225.60') of 8-5/8", 24#, K55 casing at 238.60'. Cemented with 118 cubic feet of Class "B" containing 3% CaCL₂, 1/4# celoflake. Plug down at 3:30 am on 8-29-82. Cemented circulated to surface.

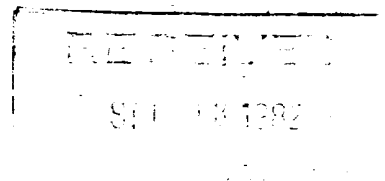
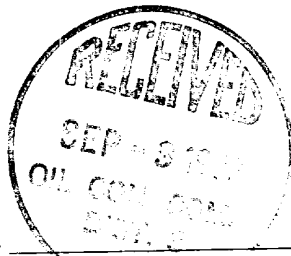

Subsurface Safety Valve: Manu. and Type

Set @ _____ Ft.

18. I hereby certify that the foregoing is true and correct

SIGNED Shirley Perley TITLE Secretary DATE September 1, 1982

(This space for Federal or State office use)

APPROVED BY _____ TITLE _____ DATE _____
CONDITIONS OF APPROVAL, IF ANY.

ACCEPTED FOR RECORD

SEP 07 1982

*See Instructions on Reverse Side

'MOCC

FARMINGTON, N.M.
BY JK