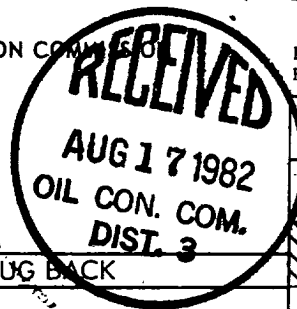

NO. OF COPIES RECEIVED	
DISTRIBUTION	
SANTA FE	
FILE	
U.S.G.S.	
LAND OFFICE	
OPERATOR	

## NEW MEXICO OIL CONSERVATION COMMISSION

Form C-101  
Revised 1-1-85

5A. Indicate Type of Lease

STATE ☐ FEE ☒

6. State Oil &amp; Gas Lease No.

## APPLICATION FOR PERMIT TO DRILL, DEEPEN, OR PLUG BACK

1a. Type of Work b. Type of Well OIL WELL <input checked="" type="checkbox"/> GAS WELL <input type="checkbox"/> OTHER <input type="checkbox"/> SINGLE ZONE <input checked="" type="checkbox"/> MULTIPLE ZONE <input type="checkbox"/>		7. Unit Agreement Name	
2. Name of Operator Union Texas Petroleum Corporation		8. Farm or Lease Name Pierce "A"	
3. Address of Operator P.O. Box 808, Farmington, New Mexico 87401		9. Well No. 4	
4. Location of Well UNIT LETTER A LOCATED 928 FEET FROM THE North LINE AND 670 FEET FROM THE East LINE OF SEC. 34 TWP. 29N RGE. 10W NMPM		10. Field and Pool, or Wildcat Armenta Wildcat Gallup	
12. County San Juan			
19. Proposed Depth 5932		19A. Formation Gallup	
20. Rotary or C.T. Rotary			
21. Elevations (Show whether DF, RT, etc.) 5555 GR		21A. Kind & Status Plug. Bond Current \$50,000. Blanket	
21B. Drilling Contractor		22. Approx. Date Work will start September 1, 1982	

23.

## PROPOSED CASING AND CEMENT PROGRAM

SIZE OF HOLE	SIZE OF CASING	WEIGHT PER FOOT	SETTING DEPTH	SACKS OF CEMENT	EST. TOP
13-3/4"	10-3/4", K-55	40.55	300 Ft.	182	Circulated
9-7/8"	7-5/8", K-55	26.40	4635 Ft.	290	Cover Ojo Alamo
6-3/4"	5-1/2", J-55	15.50	4435' to 5932'	150	Top of the liner

We desire to drill 13-3/4" surface hole to approx. 300'. Set new 10-3/4", K-55, 40.55#, ST & C csg. at T.D. Cement w/approx. 182 sx. of class "B" circulated to surface. W.O.C. pressure test the casing to 800 PSIG for 10 minutes. Drill out w/9-7/8" bit to approx. 4635' using a permaloid, non-dispersed starch base mud as the circulating medium. Run new 7-5/8", 26.40# K-55, ST & C pipe, with a D.V. tool at approx. 2000 ft. Cement the 1st stage w/190 sx of 65/35/6 followed by approx. 100 sx of class "B". Cement 2nd stage w/approx. 160 sx. of 65/35/12 followed by approx. 100 sx of class "B". W.O.C. Drill D.V. tool. Pressure test the csg. to 1500 PSIG for 10 minutes. Drill out w/6-1/4" bit to T.D. of approx. 5932' using natural gas as the circulating medium. Log the well. Run new 5-1/2", 15.50#, J-55, ST & C pipe to T.D. and a liner hanger at approx. 4435'. Cement w/approx. 150 sx of 50-50 poz. to cover the liner hanger. Perf. & frac the Gallup zone. Clean the well up. Run new 2-3/8", E.U.E., 4.7# J-55 tbg. to be set in the Gallup zone. Nipple down the wellhead. Run rods and pump. Set a pumping unit and tanks. Connect to a gathering system and test well.

This gas has previously been dedicated to a transporter.

IN ABOVE SPACE DESCRIBE PROPOSED PROGRAM: IF PROPOSAL IS TO DEEPEN OR PLUG BACK, GIVE DATA ON PRESENT PRODUCTIVE ZONE AND PROPOSED NEW PRODU-  
TIVE ZONE. GIVE BLOWOUT PREVENTER PROGRAM, IF ANY.

I hereby certify that the information above is true and complete to the best of my knowledge and belief.

EXPIRES 2-12-83

Signed Rudy J. Netto Title Field Operations Manager

Date 8-16-82

(This space for State Use)

SUPERVISOR DISTRICT # 3

AUG 17 1982

APPROVED BY

TITLE

DATE

CONDITIONS OF APPROVAL, IF ANY:

All distances must be from the outer boundaries of the Section.

Operator <b>UNION TEXAS PETROLEUM CORP.</b>			Lease <b>PIERCE A</b>		Well No. <b>4</b>
Unit Letter <b>A</b>	Section <b>34</b>	Township <b>29 NORTH</b>	Range <b>10 WEST</b>	County <b>SAN JUAN</b>	
Actual Footage Location of Well: <b>928</b> feet from the <b>NORTH</b> line and <b>670</b> feet from the <b>EAST</b> line					
Ground Level Elev. <b>5555</b>	Producing Formation <b>GALLUP</b>	Pool <b>WILDCAT Armenta</b>		Dedicated Acreage: <b>NE NE 40.00</b> Acres	

1. Outline the acreage dedicated to the subject well by colored pencil or hatchure marks on the plat below.
2. If more than one lease is dedicated to the well, outline each and identify the ownership thereof (both as to working interest and royalty).
3. If more than one lease of different ownership is dedicated to the well, have the interests of all owners been consolidated by communitization, unitization, force-pooling, etc?

☐ Yes ☒ No If answer is "yes," type of consolidation \_\_\_\_\_

If answer is "no," list the owners and tract descriptions which have actually been consolidated. (Use reverse side of this form if necessary.) \_\_\_\_\_

No allowable will be assigned to the well until all interests have been consolidated (by communitization, unitization, forced-pooling, or otherwise) or until a non-standard unit, eliminating such interests, has been approved by the Division

RECEIVED  
AUG 17 1982  
OIL CON. COM.  
DIST. 3

CERTIFICATION

I hereby certify that the information contained herein is true and complete to the best of my knowledge and belief.

*Rudy D. Motto*  
Name

**Rudy D. Motto**  
Position

**Field Operations Manager**  
Company

**Union Texas Petroleum Corp.**

Date  
**August 13, 1982**

I hereby certify that the information shown on this plat was plotted from field notes, actual surveys, made by me or under my supervision, and that the same is true to the best of my knowledge and belief.

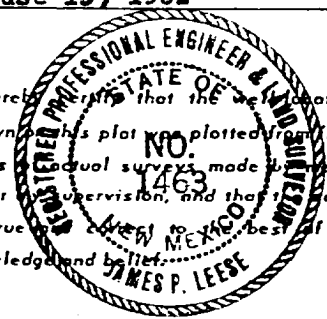

Date Surveyed  
**August 12, 1982**

Registered Professional Engineer  
and/or and Surveyor  
*James P. Leese*  
**James P. Leese**

Certificate No.  
**1463**