

UNITED STATES
DEPARTMENT OF THE INTERIOR
GEOLOGICAL SURVEY

APPLICATION FOR PERMIT TO DRILL, DEEPEN, OR PLUG BACK

1a. TYPE OF WORK DRILL ☒ DEEPEN ☐ PLUG BACK ☐b. TYPE OF WELL OIL WELL ☒ GAS WELL ☐ OTHER ☐ SINGLE ZONE ☒ MULTIPLE ZONE ☐

2. NAME OF OPERATOR

Union Texas Petroleum Corporation

3. ADDRESS OF OPERATOR

P.O. Box 808, Farmington, New Mexico 87401

4. LOCATION OF WELL (Report location clearly and in accordance with any State requirements.)*
At surface1980 Ft./South line and 660 ft./East line
At proposed prod. zone Same as above

14. DISTANCE IN MILES AND DIRECTION FROM NEAREST TOWN OR POST OFFICE*

4-1/2 Miles South East of Bloomfield, New Mexico

15. DISTANCE FROM PROPOSED*
LOCATION TO NEAREST
PROPERTY OR LEASE LINE, FT.
(Also to nearest drlg. unit line, if any) 660 Ft.18. DISTANCE FROM PROPOSED LOCATION*
TO NEAREST WELL, DRILLING, COMPLETED,
OR APPLIED FOR, ON THIS LEASE, FT. 746 Ft.

21. ELEVATIONS (Show whether DF, RT, GR, etc.)

5701 GR

PROPOSED CASING AND CEMENTING PROGRAM

SIZE OF HOLE	SIZE OF CASING	WEIGHT PER FOOT	SETTING DEPTH	QUANTITY OF CEMENT
13-3/4"	10-3/4" K-55	40.50#	300 Ft. (±)	295 cu. ft. (Circulated)
9-5/8"	7-5/8" K-55	26.40#	5134 Ft.	1440 cu. ft. (Base of Surface)
6-3/4"	5-1/2" J-55	15.50#	4934' to 5934'	142 cu. ft. (Top of the liner)

We desire to drill 13-3/4" surface hole to approx. 300' using natural mud as a circulating medium. Run new 10-3/4", K-55, 40.50# pipe to T.D. Cmt. w/approx. 295 cu. ft. of class "B" cmt. to be circulated to surface. W.O.C. Pressure test csg. to 800 PSIG for 10 minutes. Drill out with 9-5/8" bit using a starch base, permaloid, non-dispersed mud as the circulating medium to approx. 5134'. Run new 7-5/8", K-55, 26.40# ST & C pipe to T.D. with a D.V. tool at approx. 2000'. Cement the first stage w/approx. 610' of 65/35/6 followed by approx. 100 cu. ft. of class "B" Cement 2nd stage w/approx. 630 cu. ft. of 65/35/12 followed by approx. 100 cu. ft. of class "B" cmt. to bring cmt. to the base of the surface pipe. Drill out the D.V. tool. Pressure test the csg. to 1500 PSIG for 10 minutes. Drill out with 6-3/4" bit using gas as the circulating medium to approx. 5934'. Log the well. Run new 5-1/2", K-55, 15.50# ST & C pipe and hang off with a liner hanger. Top of hanger at approx. 4934'. Cmt. w/approx. 142 cu. ft. of 50-50 poz mix with 2% gel to come up to the top of the liner hanger. Perforate and fracture the Gallup zone. Clean the well up. Run 2-3/8", E.U.E. J-55, 4.7# tbg. to be landed in the Gallup zone. Nipple down the wellhead. Run rods and rod pump. Set pumping unit and tanks. Test well. Connect to a gathering system.

The gas from this well has previously been dedicated to a transporter.
IN ABOVE SPACE DESCRIBE PROPOSED PROGRAM: If proposal is to deepen or plug back, give data on present productive zone and proposed new productive zone. If proposal is to drill or deepen directionally, give pertinent data on subsurface locations and measured and true vertical depths. Give blowout preventer program, if any.

24. SIGNED Rudy D. Motto TITLE Field Operations ManagerDATE September 10, 1982

(This space for Federal or State office use)

PERMIT NO. _____

APPROVAL DATE _____

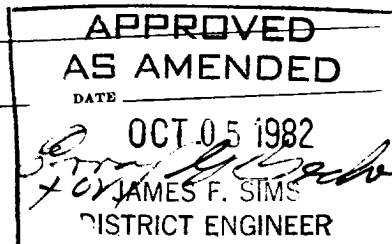
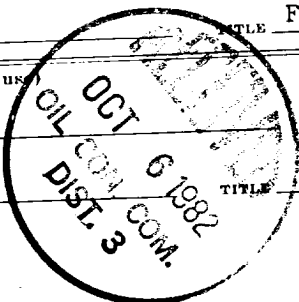
APPROVED BY _____
CONDITIONS OF APPROVAL, IF ANY:

All distances must be from the outer boundaries of the Section.

Operator UNION TEXAS PETROLEUM CORP.			Lease ZACHRY		Well No. 34
Unit Letter I	Section 34	Township 29 NORTH	Range 10 WEST	County SAN JUAN	
Actual Footage Location of Well: 1980 feet from the SOUTH line and 660 feet from the EAST line					
Ground Level Elev. 5701	Producing Formation GALLUP	Pool Armenta Extension		Dedicated Acreage: NE SE 40.00 Acres:	

1. Outline the acreage dedicated to the subject well by colored pencil or hatchure marks on the plat below.
2. If more than one lease is dedicated to the well, outline each and identify the ownership thereof (both as to working interest and royalty).
3. If more than one lease of different ownership is dedicated to the well, have the interests of all owners been consolidated by communitization, unitization, force-pooling, etc?

☐ Yes ☒ No If answer is "yes," type of consolidation _____

If answer is "no," list the owners and tract descriptions which have actually been consolidated. (Use reverse side of this form if necessary.) _____

No allowable will be assigned to the well until all interests have been consolidated (by communitization, unitization, forced-pooling, or otherwise) or until a non-standard unit, eliminating such interests, has been approved by the Division.

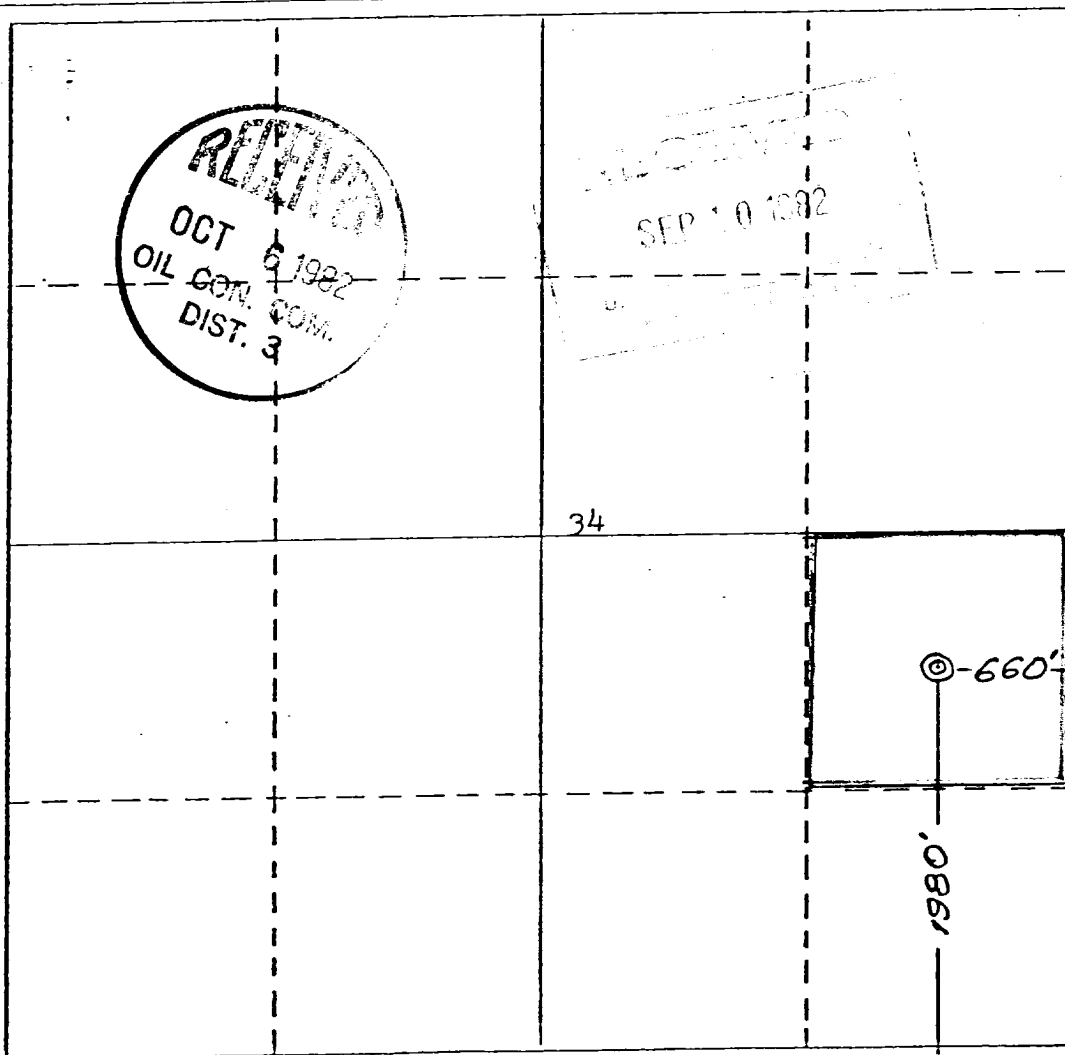

CERTIFICATION

I hereby certify that the information contained herein is true and complete to the best of my knowledge and belief.

Rudy D. Motto
Name

Rudy D. Motto

Position

Area Operations Manager

Company

Union Texas Petroleum Corp.

Date

August 4, 1982

I hereby certify that the location shown on this plat was plotted from field notes or actual survey made by me or under my supervision and that the same is true and correct to the best of my knowledge and belief.

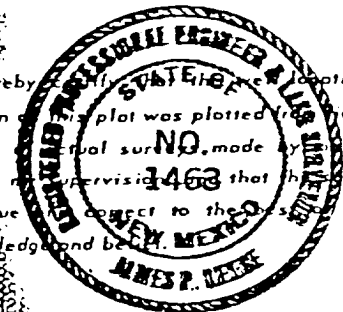

Date Surveyed

July 28, 1982

Registered Professional Engineer and/or Land Surveyor

James P. Leese
James P. Leese

Certificate No.

1463

