



STATE OF NEW MEXICO
ENERGY, MINERALS AND NATURAL RESOURCES DEPARTMENT

OIL CONSERVATION DIVISION
2040 S. PACHECO
SANTA FE, NEW MEXICO 87505
(505) 827-7131

August 30, 1996

RECEIVED
SEP - 5 1996
OIL CON. DIV.
DIST. 3

Amoco Production Company
Southern Rockies Business Unit
P.O. Box 800
Denver, Colorado 80201
Attention: Pamela W. Staley

Administrative Order NSL-3701

Dear Ms. Staley:

Reference is made to your application dated August 13, 1996 for a non-standard Basin-Fruitland coal gas well location for your existing Gallegos Canyon Unit Well No. 332 (API No. 30-045-25475) which was drilled in 1984 and completed in the West Kutz-Pictured Cliffs Pool at a standard gas well location 930 feet from the South line and 1080 feet from the East line (Lot 20/Unit P) of Section 31, Township 29 North, Range 12 West, NMPM, San Juan County, New Mexico.

It is our understanding that the Pictured Cliffs interval will be properly plugged back and said well will be recompleted to the Basin-Fruitland Coal (Gas) Pool, which pursuant to the "*Special Rules and Regulations for the Basin-Fruitland Coal (Gas) Pool*", as promulgated by Division Order No. R-8768, as amended, is unorthodox. Further, Lots 5, 6, 11, 12, 13, 14, 19, and 20 (the E/2 equivalent) of said Section 31 shall be dedicated to the well to form a 313.08-acre gas spacing and proration unit for said pool.

By the authority granted me under the provisions of Rule 8 of said Order No. R-8768, as amended, the above-described unorthodox coal gas well location is hereby approved.

Sincerely,

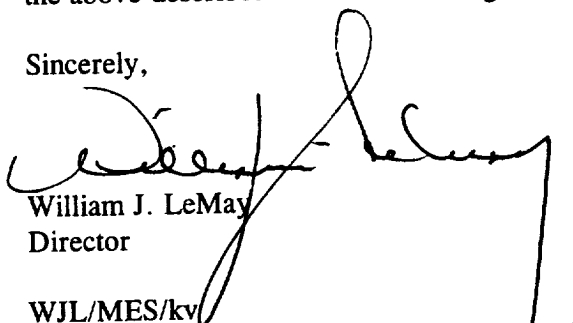

William J. LeMay
Director

WJL/MES/kv

cc: Oil Conservation Division - Aztec
US Bureau of Land Management - Farmington



Southern

Rockies

Business

Unit

August 13, 1996

Mr. William J. LeMay, Director
New Mexico Oil Conservation Division
2040 S. Pacheco Street
P.O. Box 6429
Santa Fe, NM 87505

RECEIVED
AUG 19 1996

Application For Unorthodox Location
Gallegos Canyon Unit Well No. 332
930' FSL, 1080' FEL, Unit P Section 31-T29N-R12W
Basin Fruitland Coal Pool
San Juan County, New Mexico

OIL CON. DIV.
DIST. 3

Amoco Production Company hereby requests administrative approval for an unorthodox well location for the Gallegos Canyon Unit Well No. 332 well in the Basin Fruitland Coal Pool. Amoco plans to recompleting this well from the Pictured Cliffs formation to the Basin Fruitland Coal. This well is at an orthodox location for the Pictured Cliffs, however, the Basin Fruitland Coal Pool Rules require all Fruitland wells to be in the Northeast or Southwest quarter of the section. Because of the recompleting of this well from the Pictured Cliffs, it will be in an unorthodox location in the Fruitland. Attached is a copy of the C-102 for the Pictured Cliffs and the Fruitland Coal formations.

Amoco is the only offset operator in the Fruitland Coal formation, so no notice is required to Offset Operators. Attached are plats showing the location of the well, all wells drilled in the area and the C-102's described above. Should you have questions regarding this application, do not hesitate to call me at (303) 830-5344.

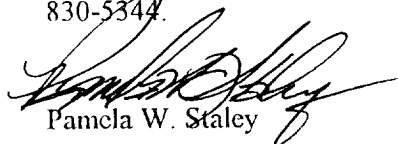
Pamela W. Staley

Attachments

cc: Frank Chavez, Supervisor
NMOCD District III
1000 Rio Brazos Road
Aztec, NM 87410

Mark Yamasaki, Amoco
Patty Haefele, Amoco
Irina Mitselmakher, Amoco

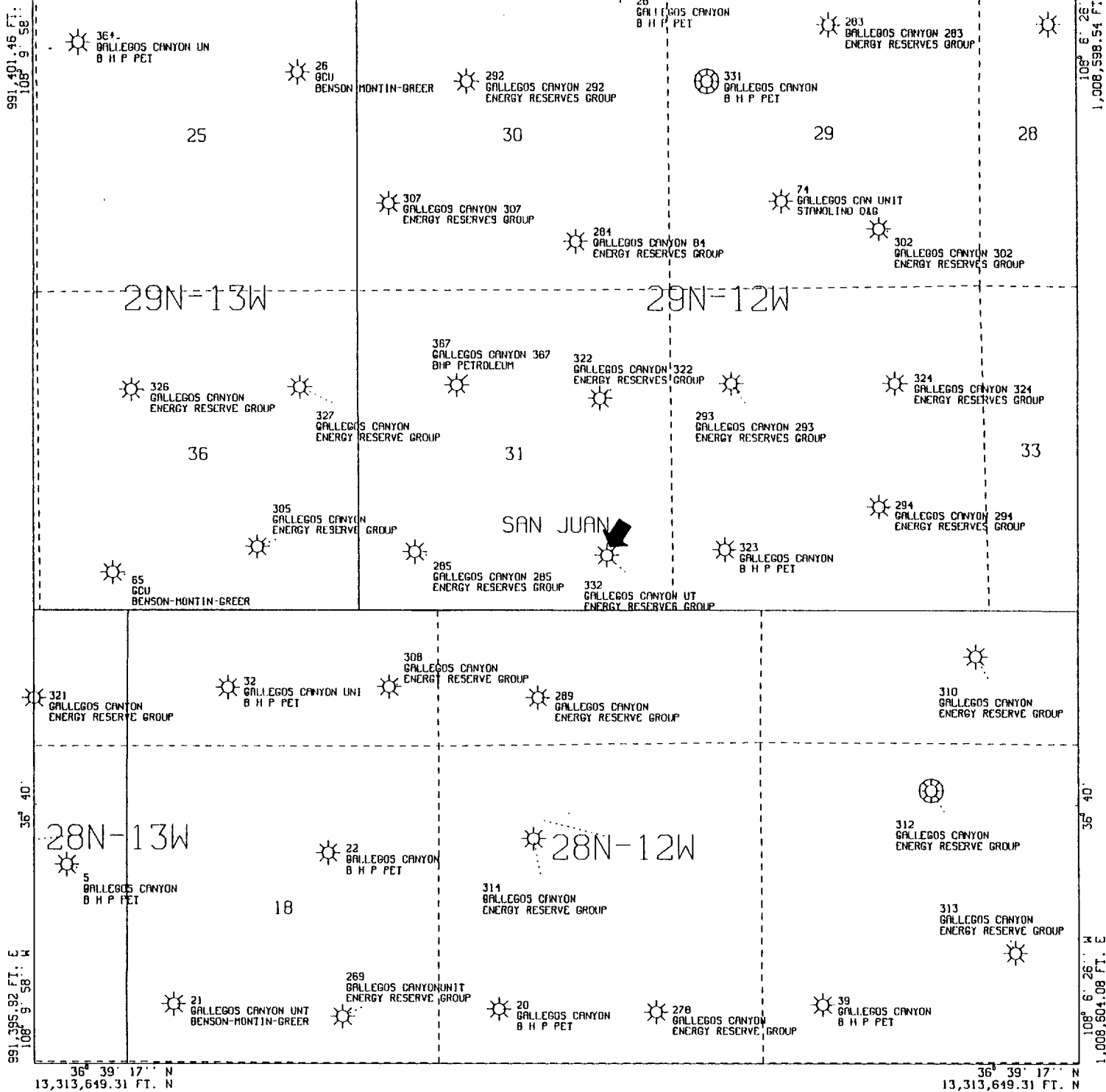

All geological and geophysical data, including the interpretation thereof, appearing on this map is the private and confidential property of Amoco Production Company. The publication or reproduction thereof without the written permission of said Company is strictly prohibited.

POLYCONIC CENTRAL MERIDIAN - 108° 8' 12" W LON
SPHEROID - 6

AMOCO PRODUCTION COMPANY
PLAT MAP
GCU 332 P31-T29N-R12W
Offset Pictured Cliff Wells
SCALE 1 IN. = 2,000 FT. AUG 14, 1996

HORIZONTAL DATUM NAD27

CW507495--RUN#96227090620

39-42.36 WED 14 AUG, 1996 JOB-P0750402, ISSCO DISPLA 10.0

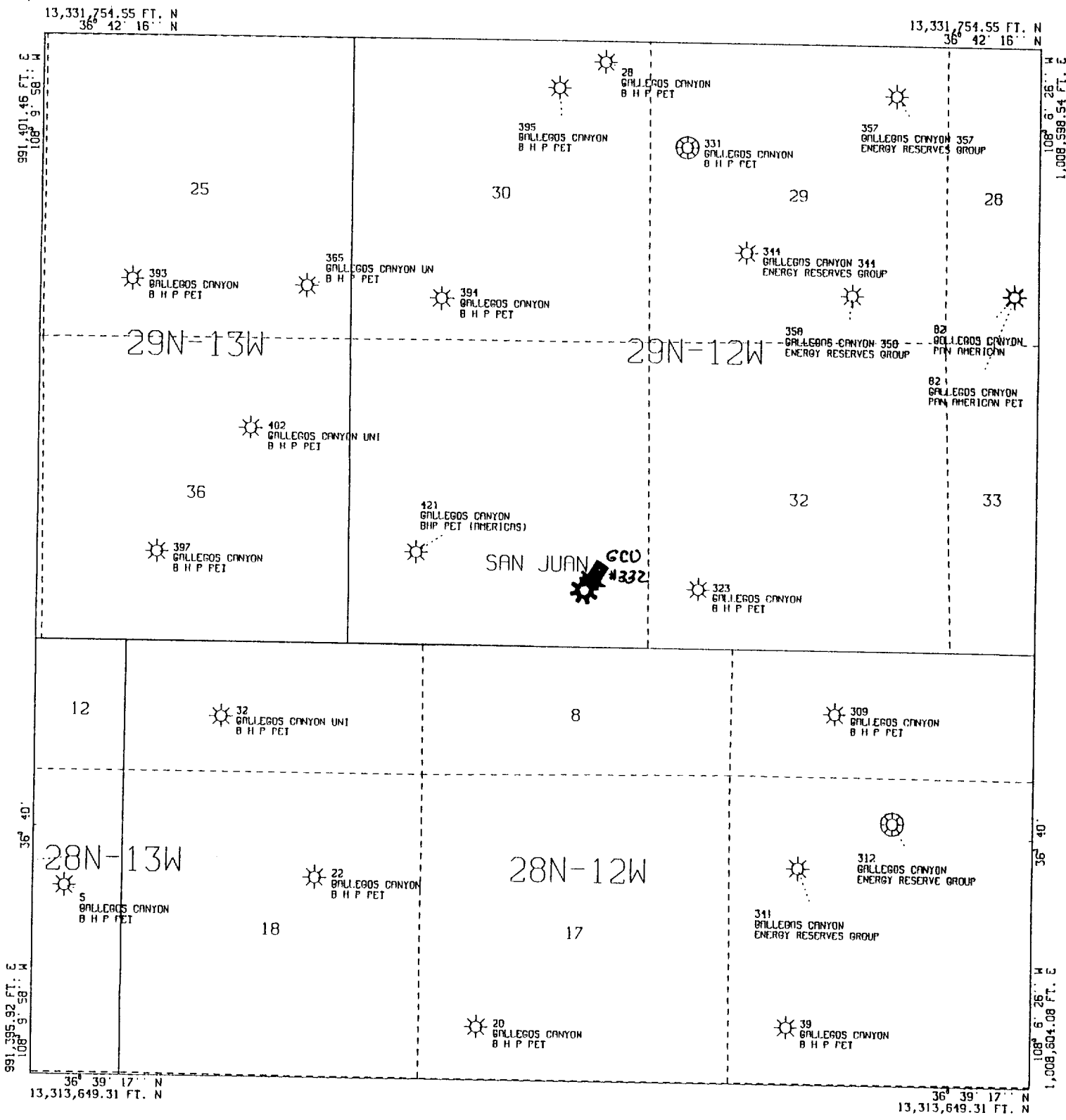

All geological and geophysical data, including the interpretation thereof, appearing on this map is the private and confidential property of Amoco Production Company. The publication or reproduction thereof without the written permission of said Company is strictly prohibited.

POLYCONIC CENTRAL MERIDIAN - 108° 8' 12" W LON SPHEROID - 6

AMOCO PRODUCTION COMPANY
PLAT MAP
GCU 332 P31-T29N-R12W
Offset Fruitland Coal Wells
SCALE 1 IN. = 2,000 FT. AUG 14, 1996

UN-96227093017

APPLICATION FOR APPROVAL OF UNORTHODOX LOCATION UNDER RULE 104-F

**Gallegos Canyon Unit Well No. 332
930' FSL, 1080' FEL, Unit P Section 31-T29N-R12W
Basin Fruitland Coal Pool**

ATTACHMENTS:

- 9-SECTION PLAT SHOWING LOCATION OF ALL OFFSET WELLS
- FORM C-102 FOR PICTURED CLIFFS FORMATION
- FORM C-102 FOR FRUITLAND COAL FORMATION

All distances must be from the outer boundaries of the Section.

| | | | | |
|--|----------------------|--------------------------------------|---------------------|---------------------------|
| Operator ENERGY RESERVES GROUP, INC. | | Lease GALLEGOS CANYON UNIT | | Well No. 332 |
| Unit Letter P | Section 31 | Township 29N- | Range 12W | County San Juan |

Actual Footage Location of Well:

930 feet from the **South** line and **1080** feet from the **East** line

| | | | |
|-----------------------------------|---|--|--|
| Ground Level Elev. 5661 | Producing Formation Pictured Cliffs | Pool West Kutz Pictured Cliffs | Dedicated Acreage: 160 Acres |
|-----------------------------------|---|--|--|

1. Outline the acreage dedicated to the subject well by colored pencil or hachure marks on the plat below.
2. If more than one lease is dedicated to the well, outline each and identify the ownership thereof (both as to working interest and royalty).
3. If more than one lease of different ownership is dedicated to the well, have the interests of all owners been consolidated by communitization, unitization, force-pooling, etc?

☐ Yes ☐ No If answer is "yes," type of consolidation _____

If answer is "no," list the owners and tract descriptions which have actually been consolidated. (Use reverse side of this form if necessary.) _____

No allowable will be assigned to the well until all interests have been consolidated (by communitization, unitization, forced-pooling, or otherwise) or until a non-standard unit, eliminating such interests, has been approved by the Commission.

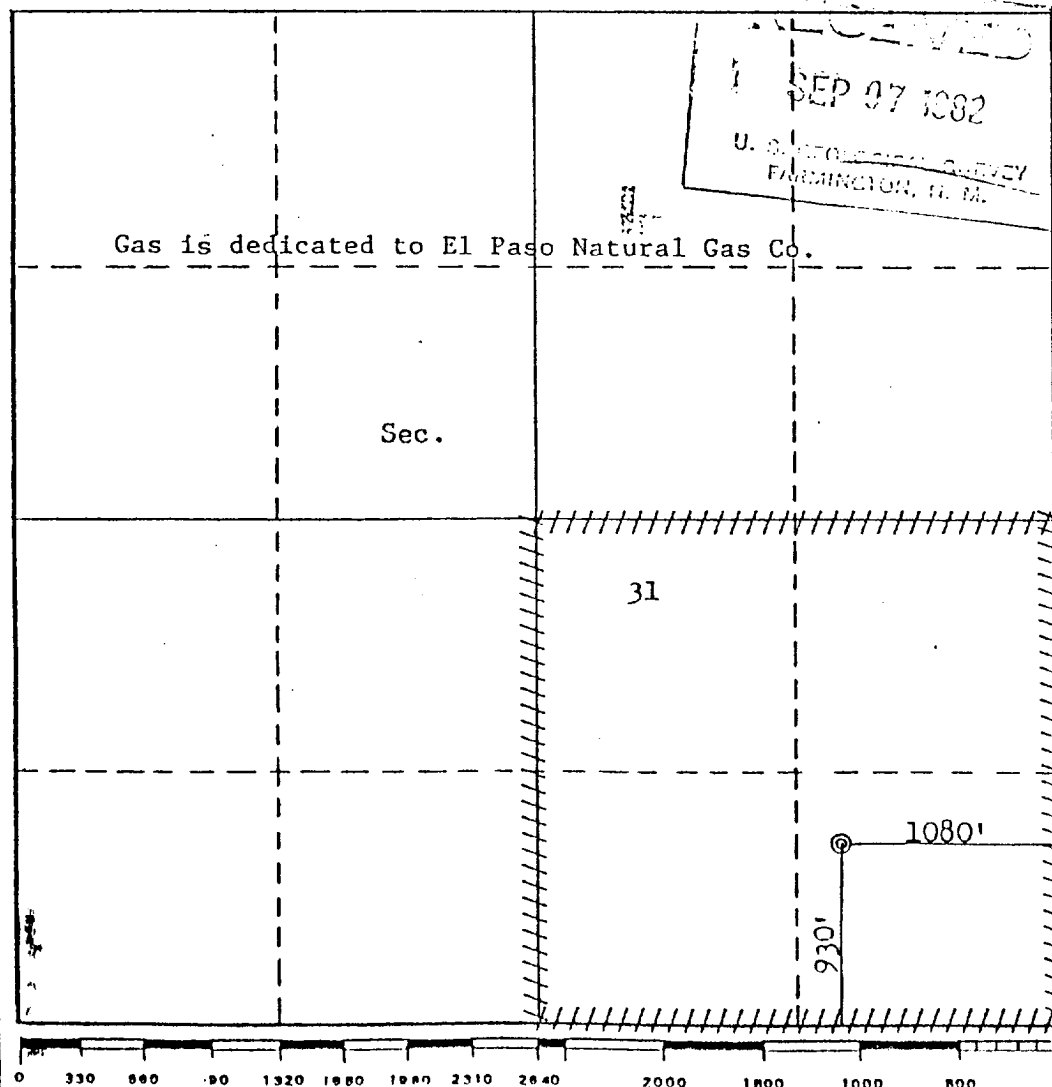

CERTIFICATION

I hereby certify that the information contained herein is true and complete to the best of my knowledge and belief.

Name
[Signature]
Position
Field Services Administrator
Company
Energy Reserves Group, Inc.
Date
May 4, 1982

I hereby certify that the well location shown on this plat was plotted from field notes of actual surveys made by me or under my supervision, and that the same is true and correct to the best of my knowledge and belief.

Date Surveyed
April 29, 1982
Registered Professional Engineer and/or Land Surveyor
[Signature]
Fred B. Kerr Jr.
Certificate No.
3950

District I
PO Box-1988, Hobbs, NM 88241-1988
District II
811 South First, Artesia, NM 88210
District III
1000 Rio Brazos Rd., Aztec, NM 87410
District IV
2040 South Pacheco, Santa Fe, NM 87505

State of New Mexico
Energy, Minerals & Natural Resources Department

OIL CONSERVATION DIVISION
2040 South Pacheco
Santa Fe, NM 87505

Form C-102
Revised October 18, 1994
Instructions on back
Submit to Appropriate District Office
State Lease - 4 Copies
Fee Lease - 3 Copies

☐ AMENDED REPORT

WELL LOCATION AND ACREAGE DEDICATION PLAT

| | | | | |
|----------------------------|---|--------------------|-----------------------------------|--|
| API Number 30-045-25475 | | Pool Code 71629 | Pool Name Basin Fruitland Coal | |
| Property Code 570 | Property Name Gallegos Canyon Unit | | Well Number 332 | |
| OGRID No. 000778 | Operator Name Amoco Production Company | | Elevation 5661' | |

¹⁰ Surface Location

| UL or lot no. | Section | Township | Range | Lot Idn | Feet from the | North/South line | Feet from the | East/West line | County |
|---------------|---------|----------|-------|---------|---------------|------------------|---------------|----------------|----------|
| P | 31 | 29N | 12W | | 930 | South | 1080 | East | San Juan |

¹¹ Bottom Hole Location If Different From Surface

| UL or lot no. | Section | Township | Range | Lot Idn | Feet from the | North/South line | Feet from the | East/West line | County |
|------------------------|---------|-----------------|-------|--------------------|---------------|------------------|---------------|----------------|--------|
| | | | | | | | | | |
| Dedicated Acres 320 | | Joint or Infill | | Consolidation Code | | Order No. | | | |

NO ALLOWABLE WILL BE ASSIGNED TO THIS COMPLETION UNTIL ALL INTERESTS HAVE BEEN CONSOLIDATED
OR A NON-STANDARD UNIT HAS BEEN APPROVED BY THE DIVISION

| | | | | | |
|----|--|--|--|--|--|
| 16 | | | | | 17 OPERATOR CERTIFICATION I hereby certify that the information contained herein is true and complete to the best of my knowledge and belief. Signature <u>Patty Haefele</u> Patty Haefele Printed Name Staff Assistant Title 7/3/96 Date |
| | | | | | |
| | | | | | |
| | | | | | |
| | | | | | 18 SURVEYOR CERTIFICATION I hereby certify that the well location shown on this plat was plotted from field notes of actual surveys made by me or under my supervision, and that the same is true and correct to the best of my belief. 4/19/82 Date of Survey Signature and Seal of Professional Surveyer: on file 3950 Certificate Number |
| | | | | | |
| | | | | | |
| | | | | | |

1080'
930'