



STATE OF NEW MEXICO  
**ENERGY AND MINERALS DEPARTMENT**  
OIL CONSERVATION DIVISION

TONY ANAYA  
GOVERNOR

POST OFFICE BOX 2088  
STATE LAND OFFICE BUILDING  
SANTA FE, NEW MEXICO 87501  
(505) 827-5800

TENNECO OIL EXPLORATION AND  
PRODUCTION  
P.O. Box 3249  
Englewood, CO 80155

Attention: Denise Wilson

Administrative Order NSL-1666

Gentlemen:

Reference is made to your application for a non-standard location for your Valdez Well No. 2 to be located 2460 feet from the North line and 2230 feet from the East line of Section 24, Township 29 North, Range 11 West, Undesignated Gallup Oil Pool, San Juan County, New Mexico.

By authority granted me under the provisions of Rule 104 F of the Division Rules and Regulations, the above-described unorthodox location is hereby approved.

Sincerely,

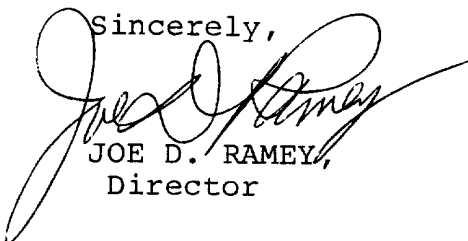

JOE D. RAMEY,  
Director

JDR/RLS/dr

cc: Oil Conservation Division - Aztec  
Oil & Gas Engineering Committee - Hobbs  
Oil and Gas Division - State Land Office - Santa Fe

*Handwritten note:*  
3/27/73



STATE OF NEW MEXICO  
ENERGY AND MINERALS DEPARTMENT

OIL CONSERVATION DIVISION  
AZTEC DISTRICT OFFICE

1000 RIO BRAZOS ROAD  
AZTEC, NEW MEXICO 87410  
(505) 334-6178

OIL CONSERVATION DIVISION  
BOX 2088  
SANTA FE, NEW MEXICO 87501

DATE 3-3-83

RE: Proposed MC \_\_\_\_\_  
Proposed DHC \_\_\_\_\_  
Proposed NSL ✓ \_\_\_\_\_  
Proposed SWD \_\_\_\_\_  
Proposed WFX \_\_\_\_\_  
Proposed PMX \_\_\_\_\_

Gentlemen:

I have examined the application dated 2-24-83  
for the Tenneco Oil Co. Valdez #2 G-24-29N-11W  
Operator Lease and Well No. Unit, S-T-R

and my recommendations are as follows:

Approve  
\_\_\_\_\_  
\_\_\_\_\_  
\_\_\_\_\_  
\_\_\_\_\_  
\_\_\_\_\_

Yours truly,

Jeff A. Edmister

# Tenneco Oil Exploration and Production

A Tenneco Company

Western Rocky Mountain Division

P.O. Box 3249  
Englewood, Colorado 80155  
(303) 740-4800

Delivery Address:  
6061 South Willow Drive  
Englewood, Colorado



February 22, 1983

CERTIFIED MAIL  
Return Receipt Requested

New Mexico Oil Conservation Division  
P.O. Box 2088  
Santa Fe, NM 87501  
Attn: Joe D. Ramey

New Mexico Oil Conservation Division  
1000 Rio Brazos Road  
Aztec, NM 87401  
Attn: Frank Chavez

RECEIVED  
FEB 24 1983  
OIL CON. DIV.  
DIST. 3

RE: Application for Unorthodox Location  
Valdez #2  
2460' FNL, 2230' FEL  
Section 24, T29N, R11W  
San Juan County, New Mexico

Gentlemen:

Attached in duplicate (to each office) are a well location plat (C-102) with an ownership plat for the above referenced well.

Since most of the spacing unit is productive agricultural land and the well location is on non-productive wasteland, this is the most acceptable wellsite location.

A copy of this application is being submitted to all offset operators by certified mail with a request that they furnish your Santa Fe office with a waiver of objection.

Pursuant to the authority of Rule 104-F we respectfully request your approval of an exemption to the standard well location requirements.

Yours very truly,

TENNECO OIL COMPANY

*Denise Wilson*

Denise Wilson  
Production Analyst

DW/ch

## W A I V E R

\_\_\_\_\_ hereby waives objection to Tenneco Oil Company's application for unorthodox location for their Valdez #2, proposed above.

BY: \_\_\_\_\_

DATE: \_\_\_\_\_

OFFSET OPERATORS

Tenneco  
Valdez #2  
2460' FNL, 2230' FEL  
Sec. 24, T29N, R11W  
San Juan County, New Mexico

Charles B. Reynolds & Associates  
Box 1004  
Belen, NM 87002  
Attention: Charles B. Reynolds

Getty Oil Company  
3 Park Central, Suite 700  
1515 Arapahoe Street  
Denver, CO 80202  
Attention: R. B. Elkington

Manana Gas, Inc.  
Box 145 - 610 Reilly Heights  
Farmington, NM 87401  
Attention: E. Hartman

Inland Oil Company  
Box 1313  
Bismarck, ND 58501  
Attention: Berk Strothman

El Pamco, Inc.  
Box 14738  
Albuquerque, NM 87191  
Attention: Horace F. McKay, Jr.

## OIL CONSERVATION DIVISION

STATE OF NEW MEXICO

P. O. BOX 2088

Form C-107  
Revised 10-1-7

OIL AND MINERALS DEPARTMENT

SANTA FE, NEW MEXICO 87501

All distances must be from the outer boundaries of the Section.

Operator <b>TENNECO OIL COMPANY</b>			Lease <b>VALDEZ</b>		Well No. <b>2</b>
Unit Letter <b>G</b>	Section <b>24</b>	Township <b>29N</b>	Range <b>11W</b>	County <b>San Juan</b>	
Actual Footage Location of Well: <b>2460</b> feet from the <b>North</b> line and <b>2230</b> feet from the <b>East</b> line					
Ground Level Elev. <b>5474</b>	Producing Formation <b>Gallup</b>		Pool <b>Und. Gallup</b>		Dedicated Acreage: <b>40</b> Acres

1. Outline the acreage dedicated to the subject well by colored pencil or hachure marks on the plat below.
2. If more than one lease is dedicated to the well, outline each and identify the ownership thereof (both as to working interest and royalty).
3. If more than one lease of different ownership is dedicated to the well, have the interests of all owners been consolidated by communitization, unitization, force-pooling, etc?

☐ Yes ☐ No If answer is "yes," type of consolidation \_\_\_\_\_

If answer is "no," list the owners and tract descriptions which have actually been consolidated. (Use reverse side of this form if necessary.) \_\_\_\_\_

No allowable will be assigned to the well until all interests have been consolidated (by communitization, unitization, forced-pooling, or otherwise) or until a non-standard unit, eliminating such interests, has been approved by the Commission.

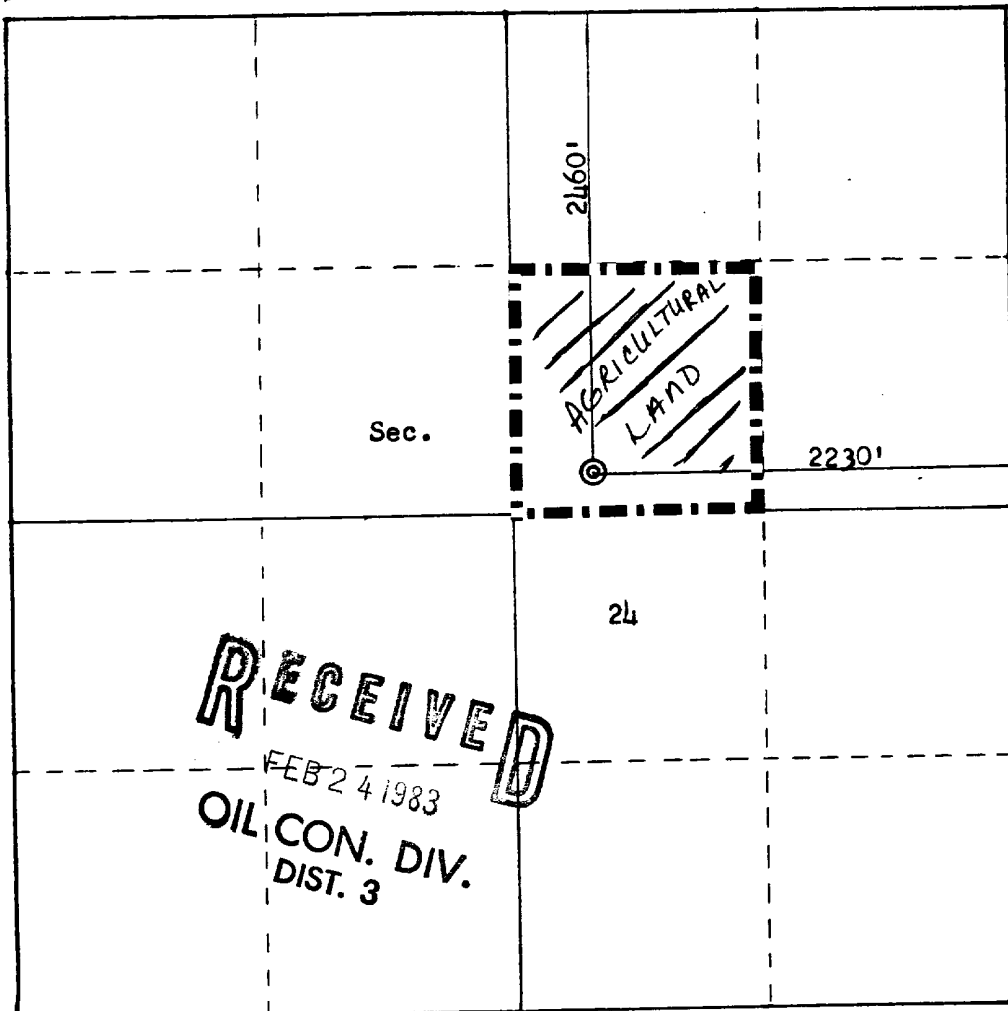

## CERTIFICATION

I hereby certify that the information contained herein is true and complete to the best of my knowledge and belief.

*Denise Wilson*

Name	Denise Wilson
Position	Production Analyst
Company	Tenneco Oil Company
Date	February 22, 1983

I hereby certify that the well location shown on this plat was plotted from field notes of actual surveys made by me or under my supervision, and that the same is true and correct to the best of my knowledge and belief.

Date Surveyed	February 10, 1983
Registered Professional Engineer and Land Surveyor	<i>Fred B. Kerr Jr.</i>
Certificate No.	2950

Tenneco  
Valdez #2  
2460' FNL, 2230' FEL  
Sec. 24, T29N, R11W  
San Juan County, New Mexico

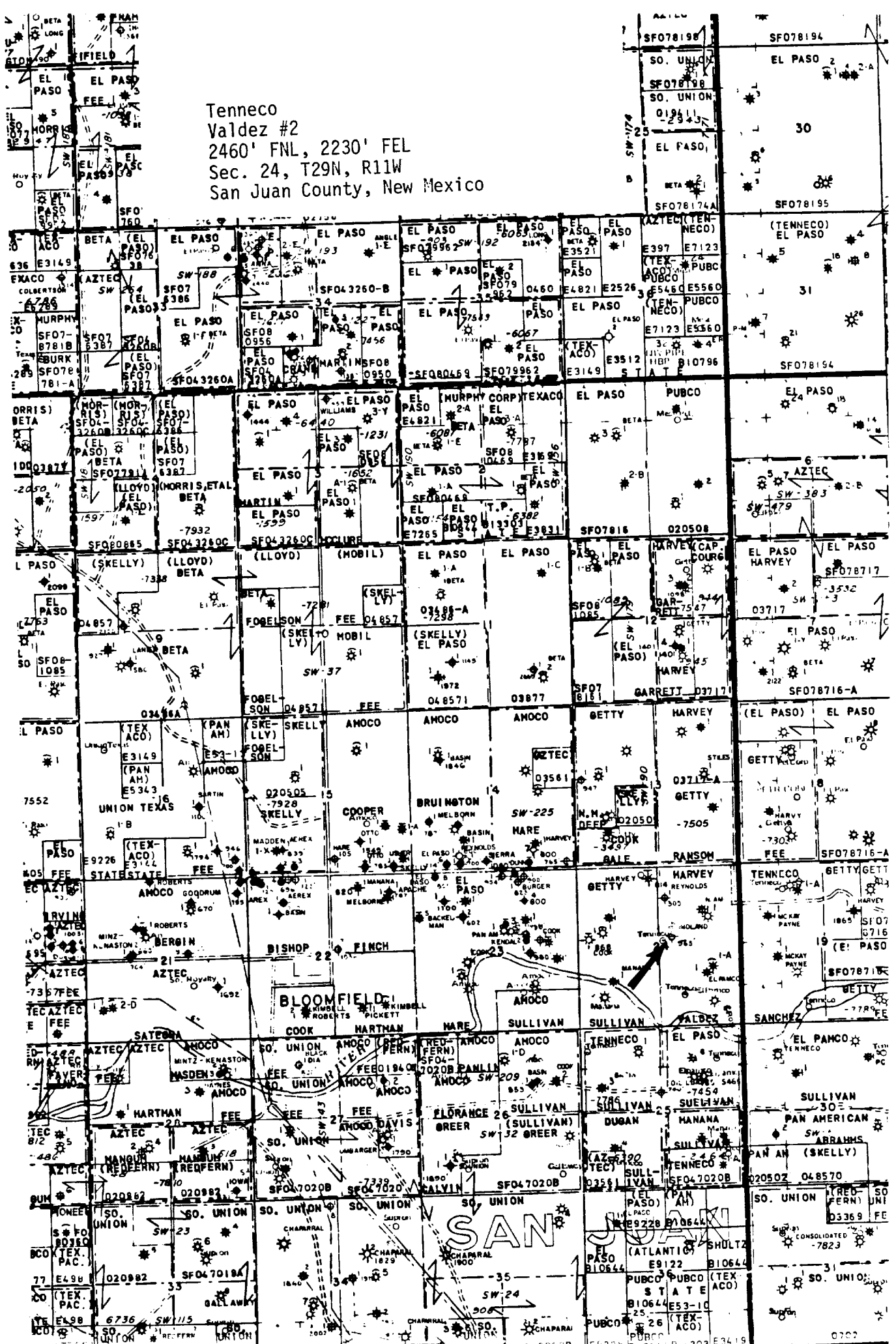

NO. OF COPIES RECEIVED	
DISTRIBUTION	
SANTA FE	
FILE	
U.S.G.S.	
LAND OFFICE	
OPERATOR	

# NEW MEXICO OIL CONSERVATION COMMISSION

Form C-103  
Supersedes Old  
C-102 and C-103  
Effective 1-1-65

<b>SUNDRY NOTICES AND REPORTS ON WELLS</b> <small>(DO NOT USE THIS FORM FOR PROPOSALS TO DRILL OR TO DEEPEN OR PLUG BACK TO A DIFFERENT RESERVOIR. USE "APPLICATION FOR PERMIT" (FORM C-101) FOR SUCH PROPOSALS.)</small>		5a. Indicate Type of Lease State <input type="checkbox"/> Fee <input checked="" type="checkbox"/>
1. <input checked="" type="checkbox"/> OIL WELL <input type="checkbox"/> GAS WELL <input type="checkbox"/> OTHER-		5. State Oil & Gas Lease No.
2. Name of Operator <b>Tenneco Oil Company</b>		7. Unit Agreement Name
3. Address of Operator <b>P.O. Box 3249, Englewood, CO 80155</b>		8. Farm or Lease Name <b>Valdez</b>
4. Location of Well UNIT LETTER <b>G</b> <b>2460</b> FEET FROM THE <b>N</b> LINE AND <b>2230</b> FEET FROM THE <b>E</b> LINE, SECTION <b>24</b> TOWNSHIP <b>29N</b> RANGE <b>11W</b> NMPM.		9. Well No. <b>2</b>
15. Elevation (Show whether DF, RT, GR, etc.) <b>5474' GR</b>		10. Field and Pool, or Wildcat <b>Und. Gallup</b>
12. County <b>San Juan</b>		

16. Check Appropriate Box To Indicate Nature of Notice, Report or Other Data

NOTICE OF INTENTION TO:		SUBSEQUENT REPORT OF:	
PERFORM REMEDIAL WORK <input type="checkbox"/> TEMPORARILY ABANDON <input type="checkbox"/> PULL OR ALTER CASING <input type="checkbox"/> OTHER <input type="checkbox"/>	PLUG AND ABANDON <input type="checkbox"/> CHANGE PLANS <input type="checkbox"/>	REMEDIAL WORK <input type="checkbox"/> COMMENCE DRILLING OPNS. <input type="checkbox"/> CASING TEST AND CEMENT JOBS <input type="checkbox"/> OTHER <input type="checkbox"/>	ALTERING CASING <input type="checkbox"/> PLUG AND ABANDONMENT <input type="checkbox"/>

17. Describe Proposed or Completed Operations (Clearly state all pertinent details, and give pertinent dates, including estimated date of starting any proposed work) SEE RULE 1103.

7/18/83: Spud @ 11am 7/18/83. RU & run 8 jts (283') 9 5/8 36# k-55 ST&C csg. set @ 299 cmt w/300 sx (354CF) C1-B + 1/4#/sx flocele +2% CaCl<sub>2</sub> PD @ 3:15am 7/19/83, Circ, no cmt. gih w/ 1" & cmt 2/ 75 sx (89CF) same slurry @ 35'. Circ 1 bbl cmt to surface.

7/19/83: Test stack, csg, etc to 1000 psi, 20 min. ok.

7/24/83: Reach TD @ 7:30 PM 7/24. TD 5750'.

7/25/83: Run 86 jts 5 1/2 20# N-80 LT&C & 56 jts 5 1/2 17# N-80 LT&C csg set @ 5650, lower DV @ 3317, upper DV @ 1511'. Cmt 1st stage w/ 375 sx howco lite + 1/4#/sx flocele (694CF). Tail w/ 150 sx (177 CF) c1-B + 1/4#/sx flocele

7/26/83: Open DV, cmt 2nd stage w/375 sx (694CF) Howcolite + 1/4#/sx Flocele. Tail w/ 50 sx (59CF) C1-B + 1/4#/sx Flocele. Open upper DV cmt 3rd stage w/400 sx (740)CF Howco Lite + 1/4#/sx Flocele. tail by 50 sx (59CF) C1-B + 1/4#/sx Flocele. Circ mud flush & 10 bbls cmt to surface. Rig release @ 1 pm 7/26/83

18. I hereby certify that the information above is true and complete to the best of my knowledge and belief.

SIGNED John A. Chavez TITLE Production Analyst DATE 7/29/83

Original Signed by FRANK T. CHAVEZ

SUPERVISOR DISTRICT # 3

APPROVED BY \_\_\_\_\_ TITLE \_\_\_\_\_ DATE AUG 5 1983

CONDITIONS OF APPROVAL, IF ANY:

OIL CONSERVATION DIVISION  
P. O. BOX 2088  
SANTA FE, NEW MEXICO 87501

Form C-103  
Revised 10-1-78

NO. OF COPIES RECEIVED	
DISTRIBUTION	
SANTA FE	
FILE	
U.S.G.S.	
LAND OFFICE	
OPERATOR	

5a. Indicate Type of Lease  
State ☐ Fee ☒

5. State Oil & Gas Lease No.

SUNDRY NOTICES AND REPORTS ON WELLS

DO NOT USE THIS FORM FOR PROPOSALS TO DRILL OR TO DEEPEN OR PLUG BACK TO A DIFFERENT RESERVOIR.  
USE "APPLICATION FOR PERMIT -" (FORM C-101) FOR SUCH PROPOSALS.)

1. OIL WELL <input type="checkbox"/> GAS WELL <input checked="" type="checkbox"/> OTHER <input type="checkbox"/>	7. Unit Agreement Name
2. Name of Operator Tenneco Oil Company	8. Farm or Lease Name Valdez
3. Address of Operator P.O. Box 3249, Englewood, CO 80155	9. Well No. 2
4. Location of well UNIT LETTER <u>G</u> <u>2460</u> FEET FROM THE <u>N</u> LINE AND <u>2230</u> FEET FROM THE <u>E</u> LINE, SECTION <u>24</u> TOWNSHIP <u>29N</u> RANGE <u>11W</u> NMPM.	10. Field and Pool, or Wildcat Undes Gallup
15. Elevation (Show whether DF, RT, GR, etc.) 5474' GR	12. County San Juan

16. Check Appropriate Box To Indicate Nature of Notice, Report or Other Data  
NOTICE OF INTENTION TO: SUBSEQUENT REPORT OF:

PERFORM REMEDIAL WORK <input type="checkbox"/>	PLUG AND ABANDON <input type="checkbox"/>	REMEDIAL WORK <input type="checkbox"/>	ALTERING CASING <input type="checkbox"/>
TEMPORARILY ABANDON <input type="checkbox"/>	CHANGE PLANS <input type="checkbox"/>	COMMENCE DRILLING OPNS. <input type="checkbox"/>	PLUG AND ABANDONMENT <input type="checkbox"/>
PULL OR ALTER CASING <input type="checkbox"/>	OTHER <input type="checkbox"/>	CASING TEST AND CEMENT JOB <input type="checkbox"/>	

17. Describe Proposed or Completed Operations (Clearly state all pertinent details, and give pertinent dates, including estimated date of starting any proposed work) SEE RULE 1103.

8/25/83: Drill to PBTD @5706'

8/27/83: Pt csg to 3900 psi, ok. Spot 500 gal 7 1/2% DI HCL @5590'. Perf lower Gallup w/4" csg 1 jspf 5492-96, 5502-22, 5534-90 (80', 80 holes) Acidize w/1600 gal 15% WGTD HCL. Frac well w/41000 gal 70 quality foam & 20# gel w/2% KCL wtr & 86000# 20/40 sd.

8/29/83: Spot 500 gal 7 1/2% HCL @5440' Perf upper Gallup w/1 jspf 5264, 5302, 5332-39 5366-70, 5394-5400, 5412-41 (Total 84'), Acidize w/1500 gal 15% WGTD HCL Frac well w/41000 gal 70 quality foram w/20# gel 7 2% KCL 7 86000# 20/40

8/30/83: TBG, Landed @5550'. RDMOSU.

RECEIVED  
SEP 14 1983  
OIL CON. DIV.  
DIST. 3

18. I hereby certify that the information above is true and complete to the best of my knowledge and belief.

SIGNED John On TITLE Production Analyst DATE 9/2/83

APPROVED BY Original Signed by FRANK T. CHAVEZ TITLE SUPERVISOR DISTRICT # 3 DATE SEP 14 1983

CONDITIONS OF APPROVAL, IF ANY:



# Tenneco Oil Company

A Tenneco Company

Western Rocky Mountain Division

P.O. Box 3249  
Englewood, Colorado 80155  
(303) 740-4800

Delivery Address:  
6162 South Willow Drive  
Englewood, Colorado



OCT 20 1983

OIL CON. DIV.  
DIST. 3

## TABULATIONS OF DEVIATION TESTS

### TENNECO OIL COMPANY

#### DEPTH/INCLINATION(DEGREE)

299' KB	1-1/2
826' KB	1-1/4
1328' KB	1-3/4
1861' KB	1-1/4
2359' KB	3/4
2860' KB	3/4
3183' KB	1

#### DEPTH/INCLINATION(DEGREE)

3488' KB	1
3988' KB	1
4460' KB	1/4
5014' KB	1
5275' KB	1
5509' KB	1
5633' KB	1

### AFFIDAVIT

This is to certify that to the best of my knowledge, the above tabulation details the deviation test taken on Tenneco Oil Company's well: Valdez 2, "G" Section 24, T29N, R11W, San Juan County, New Mexico.

Signed: John Orr

THE STATE OF COLORADO )  
CITY AND COUNTY OF DENVER)

Before me, the undersigned authority, on this day, personally appeared, John Orr, known to me to be an Agent for Tenneco Oil Company, and to be the person whose name is subscribed to the above statement, who, being by me duly sworn or oath, state that he has knowledge of the facts stated herein, and that said statement is true and correct. Subscribed and sworn to before me, a Notary Public in and for said County and State, this

A handwritten signature in cursive script, reading "Linda Hancock".

Notary Public

Linda Hancock

6224 S. Prescott St.  
Littleton, CO 80120

My Commission Expires:

My Commission Expires Sept. 7, 1987

OIL CONSERVATION DIVISION

P. O. BOX 2088

SANTA FE, NEW MEXICO 87501

WELL COMPLETION OR RECOMPLETION REPORT AND LOG

NO. OF COPIES RECEIVED	
DISTRIBUTION	
SANTA FE	
FILE	
U.S.G.S.	
LAND OFFICE	
OPERATOR	

5a. Indicate Type of Lease  
State ☐ Fee ☒

5. State Oil & Gas Lease No.

1a. TYPE OF WELL

OIL WELL ☐ GAS WELL ☒ DRY ☐ OTHER ☐

b. TYPE OF COMPLETION

NEW WELL ☒ WORK OVER ☐ DEEPEN ☐ PLUG BACK ☐ DIFF. RESVR. ☐ OTHER ☐

2. Name of Operator

Tenneco Oil Company

3. Address of Operator

P.O. Box 3249, Englewood, CO 80155 (303) 740-2584

4. Location of Well

UNIT LETTER G LOCATED 2460 FEET FROM THE N LINE AND 2230 FEET FROM

THE E LINE OF SEC. 24 TWP. 29N RGE. 11W NMPM

12. County

San Juan

15. Date Spudded

7/18/83

16. Date T.D. Reached

7/24/83

17. Date Compl. (Ready to Prod.)

9/14/83

18. Elevations (DF, RKB, RT, GR, etc.)

5486' KB

19. Elev. Casinghead

5496' GR

20. Total Depth

5750' KB

21. Plug Back T.D.

5706' KB

22. If Multiple Compl., How Many

---

23. Intervals Drilled By

Rotary Tools

0'-TD

Cable Tools

---

24. Producing Interval(s), of this completion - Top, Bottom, Name

5264 - 5590' KB, Gallup

25. Was Directional Survey Made

NO

26. Type Electric and Other Logs Run

DIL/NGT, LDT - CNL/GR

27. Was Well Cored

NO

28. CASING RECORD (Report all strings set in well)

CASING SIZE	WEIGHT LB./FT.	DEPTH SET	HOLE SIZE	CEMENTING RECORD	AMOUNT PULLED
9 5/8"	36#	299' KB	12 1/4"	354cf CI-B+1/4#/sx flocele	2% CaCl <sub>2</sub> . 1st
5 1/2"	20# & 17#	5650' KB	7 7/8"	stage:694cf Howco lite+1/4#/sx flocele tail	
				w/177cf CI-B+1/4#/sx flocele. 2nd stage: 694	
DV@3317' KB	DV@ 1511' KB			cf Howcolite+1/4#/sx flocele. Tail W/59cf CI-B	

29. LINER RECORD

SIZE	TOP	BOTTOM	SACKS CEMENT	SCREEN

30. TUBING RECORD

SIZE	DEPTH SET	PACKER SET
2 3/8"	5550' KB	---

31. Perforation Record (Interval, size and number)

5264' KB  
5302' KB  
5332-39' KB  
5366-70' KB  
5394-5400' KB  
5412-41' KB  
5492-96' KB  
5502-22' KB 1 JSPF, 164',  
5534-90' KB 164 holes

32. ACID, SHOT, FRACTURE, CEMENT SQUEEZE, ETC.

DEPTH INTERVAL	AMOUNT AND KIND MATERIAL USED
5264-5441' KB 1500	gal 15% wgt'd HCL. Frac'd w/41,000
	gal 70 quality foam w/20# gel
	7+2% KCL7+86000# 20/40 sd.
5492-5590' KB	(SEE REVERSE)

33. PRODUCTION

Date First Production	8/27/83	Production Method (Flowing, gas lift, pumping - Size and type pump)	Flowing	Well Status (Prod. or Shut-in)	Shut-in
Date of Test	9/14/83	Hours Tested	3	Choke Size	3/4"
Flow Tubing Press.	118 psi	Casing Pressure	410 psi	Prod'n. For Test Period	---
		Calculated 24-Hour Rate	---	Oil - Bbl.	---
				Gas - MCF	217
				Water - Bbl.	---
				Oil Gravity - API (Corr.)	---

14. Disposition of Gas (Sold, used for fuel, vented, etc.)

To be sold

Test Witnessed By

15. List of Attachments

Logs forwarded by Schlumberger

16. I hereby certify that the information shown on both sides of this form is true and complete to the best of my knowledge and belief.

SIGNED

TITLE Production Analyst

DATE

9/16/83

## INSTRUCTIONS

+ 1/4#/sx flocele 3rd stage: 740 cf howcolite + 1/4#/sx flocele. Tailed by 59cf Cl-B + 1/4#/sx flocele.

This form is to be filed with the appropriate District Office of the Division not later than 20 days after the completion of any newly-drilled or deepened well. It shall be accompanied by one copy of all electrical and radio-activity logs run on the well and a summary of all special tests conducted, including drill stem tests. All depths reported shall be measured depths. In the case of directionally drilled wells, true vertical depths shall also be reported. For multiple completions, Items 30 through 34 shall be reported for each zone. The form is to be filed in quintuplicate except on state land, where six copies are required. See Rule 1105.

Power Gallup acid & frac record: 1600 gal 15% wgt'd HCL. Frac'd w/41000 gal 70 quality foam + 20# gel w/2% KCL wtr + 86000# 20/40 sd.

## INDICATE FORMATION TOPS IN CONFORMANCE WITH GEOGRAPHICAL SECTION OF STATE

## Southeastern New Mexico

## Northwestern New Mexico

T. Anhy	T. Canyon	T. Ojo Alamo	542	T. Penn. "B"
T. Salt	T. Strawn	T. Kirtland-Fruitland	670	T. Penn. "C"
B. Salt	T. Atoka	T. Pictured Cliffs	1724	T. Penn. "D"
T. Yates	T. Miss	T. Cliff House	3290	T. Leadville
T. 7 Rivers	T. Devonian	T. Menefee	3406	T. Madison
T. Queen	T. Silurian	T. Point Lookout	4066	T. Elbert
T. Grayburg	T. Montoya	T. Mancos	4388	T. McCracken
T. San Andres	T. Simpson	T. Gallup	5266	T. Ignacio Qtzite
T. Glorieta	T. McKee	Base Greenhorn		T. Granite
T. Paddock	T. Ellenburger	T. Dakota		
T. Blinberry	T. Gr. Wash	T. Morrison		
T. Tubb	T. Granite	T. Todilto		
T. Drinkard	T. Delaware Sand	T. Entrada		
T. Abo	T. Bone Springs	T. Wingate		
T. Wolfcamp	T.	T. Chinle		
T. Penn.	T.	T. Permian		
T. Cisco (Bough C)	T.	T. Penn. "A"		

## OIL OR GAS SANDS OR ZONES

No. 1, from	to	No. 4, from	to
No. 2, from	to	No. 5, from	to
No. 3, from	to	No. 6, from	to

## IMPORTANT WATER SANDS

Include data on rate of water inflow and elevation to which water rose in hole.

No. 1, from	to	feet
No. 2, from	to	feet
No. 3, from	to	feet
No. 4, from	to	feet

## FORMATION RECORD (Attach additional sheets if necessary)

From	To	Thickness in Feet	Formation	From	To	Thickness in Feet	Formation
542'	670'	128'	Ojo Alamo				
670'	1494'	824'	Kirtland				
1494'	1724'	230'	Fruitland				
1724'	1810'	86'	Pictured Cliffs				
1810'	2370'	560'	Lewis				
2370'	3290'	920'	Chacra				
3290'	3406'	116'	Cliffhouse				
3406'	4066'	660'	Menefee				
4066'	4388'	322'	Point Lookout				
4388'	5266'	878'	Mancos				
5266'	TD	484'	Gallup				

NOTE: ALL DEPTHS IN TERMS OF KB.

DISTRIBUTION			
ANTA FE			
FILE			
U.S.G.S.			
LAND OFFICE			
TRANSPORTER	OIL		
	GAS		
OPERATOR			
PRORATION OFFICE			

NEW MEXICO OIL CONSERVATION COMMISSION  
REQUEST FOR ALLOWABLE  
AND  
AUTHORIZATION TO TRANSPORT OIL AND NATURAL GAS

Form C-104  
Supersedes Old C-104 and C-111  
Effective 1-1-65

I. Operator  
Tenneco Oil Company  
Address  
P.O. Box 3249, Englewood, Colorado 80155  
Reason(s) for filing (Check proper box)  
New Well ☒ Change in Transporter of:  
Recompletion ☐ Oil ☐ Dry Gas ☐  
Change in Ownership ☐ Casinghead Gas ☐ Condensate ☐  
Other (Please explain)

If change of ownership give name  
and address of previous owner

II. DESCRIPTION OF WELL AND LEASE

Lease Name Valdez	Well No. 2	Pool Name, Including Formation Undes. Gallup	Kind of Lease State, Federal or Fee fee	Lease No.
Location Unit Letter G ; 2460 Feet From The N Line and 2230 Feet From The E Line of Section 24 Township 29N Range 11W , NMPM, San Juan County				

III. DESIGNATION OF TRANSPORTER OF OIL AND NATURAL GAS

Name of Authorized Transporter of Oil <input type="checkbox"/> or Condensate <input checked="" type="checkbox"/> Giant Refining	Address (Give address to which approved copy of this form is to be sent) Box 256, Farmington, NM 87401					
Name of Authorized Transporter of Casinghead Gas <input type="checkbox"/> or Dry Gas <input checked="" type="checkbox"/> El Paso Natural Gas Company	Address (Give address to which approved copy of this form is to be sent) Box 1492, El Paso, TX 79978					
If well produces oil or liquids, give location of tanks.	Unit G	Sec. 24	Twp. 29N	Pge. 11W	Is gas actually connected? no	When ASAP

If this production is commingled with that from any other lease or pool, give commingling order number:

IV. COMPLETION DATA

Designate Type of Completion - (X)	Oil Well	Gas Well	New Well	Workover	Deepen	Plug Back	Same Res'v.	Diff. Res'v.
		X	X					
Date Spudded 07/18/83	Date Compl. Ready to Prod. 09/14/83		Total Depth 5750' KB		P.B.T.D. 5706' KB			
Elevations (DF, RKB, RT, GR, etc., 5846' GR	Name of Producing Formation Gallup		Top Oil/Gas Pay 5264' KB		Tubing Depth 5550' KB			
Perforations 5264-5590					Depth Casing Shoe			
TUBING, CASING, AND CEMENTING RECORD								
HOLE SIZE	CASING & TUBING SIZE		DEPTH SET		SACKS CEMENT			
12-1/4"	9-5/8"		299' KB		354 cf			
7-7/8"	5-1/2"		5650' KB		2423 cf			
--	2-3/8"		5550' KB		---			

V. TEST DATA AND REQUEST FOR ALLOWABLE OIL WELL

(Test must be after recovery of total volume of load oil and must be equal to or exceed top allowable for this depth or be for full 24 hours)

Date First New Oil Run To Tanks	Date of Test	Producing Method (Flow, pump, gas lift, etc.)	
Length of Test	Tubing Pressure	Casing Pressure	Choke Size
Actual Prod. During Test	Oil - Bbls.	Water - Bbls.	Gas - MCF

OCT 20 1983  
OIL CON. DIV  
DIST. 3

GAS WELL

Actual Prod. Test-MCF/D 1738	Length of Test 3 hrs	Bbls. Condensate/MMCF ---	Gravity of Condensate ---
Testing Method (pitot, back pr.) Back Pressure	Tubing Pressure (Shut-in) 665 psi	Casing Pressure (Shut-in) 1075 psi	Choke Size 3/4"

VI. CERTIFICATE OF COMPLIANCE

I hereby certify that the rules and regulations of the Oil Conservation Commission have been complied with and that the information given above is true and complete to the best of my knowledge and belief.

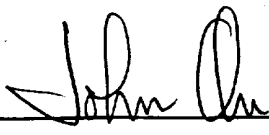
  
(Signature)  
Production Analyst  
(Title)  
10/14/83  
(Date)

OIL CONSERVATION COMMISSION  
OCT 20 1983  
APPROVED \_\_\_\_\_, 19\_\_\_\_  
BY Original Signed by FRANK T. CHAVEZ  
SUPERVISOR DISTRICT # 3  
TITLE \_\_\_\_\_

This form is to be filed in compliance with RULE 1104.  
If this is a request for allowable for a newly drilled or deepened well, this form must be accompanied by a tabulation of the deviation tests taken on the well in accordance with RULE 111.  
All sections of this form must be filled out completely for allowable on new and recompleted wells.  
Fill out only Sections I, II, III, and VI for changes of owner, well name or number, or transporter, or other such change of condition.  
Separate Forms C-104 must be filed for each pool in multiple