

UNITED STATES  
DEPARTMENT OF THE INTERIOR  
GEOLOGICAL SURVEY

30-045-25479

## APPLICATION FOR PERMIT TO DRILL, DEEPEN, OR PLUG BACK

1a. TYPE OF WORK DRILL <input checked="" type="checkbox"/> DEEPEN <input type="checkbox"/> PLUG BACK <input type="checkbox"/>				5. LEASE DESIGNATION AND SERIAL NO. 14-20-603-2200A
b. TYPE OF WELL OIL WELL <input checked="" type="checkbox"/> GAS WELL <input type="checkbox"/> OTHER <input type="checkbox"/> SINGLE ZONE <input checked="" type="checkbox"/> MULTIPLE ZONE <input type="checkbox"/>				6. IF INDIAN, ALLOTTEE OR TRIBE NAME Navajo Tribe
2. NAME OF OPERATOR Slayton Oil Corporation				7. UNIT AGREEMENT NAME N.W. Cha-Cha Unit
3. ADDRESS OF OPERATOR P.O. Box 150, Farmington, N. Mex. 87499				8. FARM OR LEASE NAME
4. LOCATION OF WELL (Report location clearly and in accordance with any State requirements.) At surface 2370 fsl; 870 fwl At proposed prod. zone 2130 a/a				9. WELL NO. #13
14. DISTANCE IN MILES AND DIRECTION FROM NEAREST TOWN OR POST OFFICE* Nine miles west of Farmington on Upper Fruitland Road				10. FIELD AND POOL, OR WILDCAT Cha-Cha Gallup
15. DISTANCE FROM PROPOSED* LOCATION TO NEAREST PROPERTY OR LEASE LINE, FT. (Also to nearest drlg. unit line, if any) 870 270		16. NO. OF ACRES IN LEASE 1431 acres		11. SEC., T., R., M., OR BLK. AND SURVEY OR AREA L sec. 18-T29N-R14W
18. DISTANCE FROM PROPOSED LOCATION* TO NEAREST WELL, DRILLING, COMPLETED, OR APPLIED FOR, ON THIS LEASE, FT. 1300		19. PROPOSED DEPTH 4700		12. COUNTY OR PARISH San Juan
21. ELEVATIONS (Show whether DF, RT, GR, etc.) 5136 ground		22. APPROX. DATE WORK WILL START* May 1, 1984		13. STATE N. Mex.
23. GENERAL REQUIREMENTS DRILLING OPERATIONS AUTHORIZED ARE SUBJECT TO COMPLIANCE WITH ATTACHED TO GENERAL REQUIREMENTS CEMENTING PROGRAM				17. NO. OF ACRES ASSIGNED TO THIS WELL 80 94.65
This action is subject to administrative appeal pursuant to 30 CFR 290.				20. ROTARY OR CABLE TOOLS Rotary
SIZE OF HOLE 12 1/4	SIZE OF CASING 8 5/8	WEIGHT PER FOOT 23#	SETTING DEPTH 250	QUANTITY OF CEMENT 200 sx
7 7/8	4 1/2	9.5#	4700	900 sx

1. Plans are to circulate cement on surface casing
2. Will two-stage long string with second stage from approximately 3350' to surface, designed to circulate cement.

RECEIVED

MAY 16 1984

OIL CON. DIV.  
DIST. 3

IN ABOVE SPACE DESCRIBE PROPOSED PROGRAM: If proposal is to deepen or plug back, give data on present productive zone and proposed new productive zone. If proposal is to drill or deepen directionally, give pertinent data on subsurface locations and measured and true vertical depths. Give blowout preventer program, if any.

24. SIGNED <u>Denny G. Foust</u> TITLE <u>Agent</u> DATE <u>Feb. 7, 1984</u>	
(This space for Federal or State office use)	
PERMIT NO. _____	APPROVAL DATE _____
APPROVED BY _____	TITLE _____
CONDITIONS OF APPROVAL, IF ANY:	

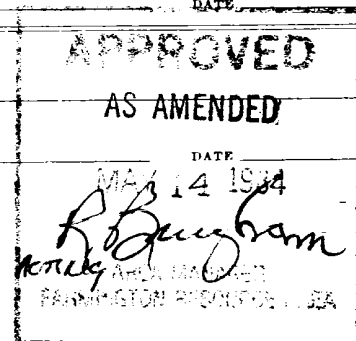

NSP R-7483

NMOCC

All distances must be from the outer boundaries of the Section.

Operator <b>SLAYTON OIL COMPANY</b>			Lease <b>NW CHA CHA UNIT</b>		Well No. <b>13</b>
Unit Letter <b>L</b>	Section <b>18</b>	Township <b>29N</b>	Range <b>11W</b>	County <b>San Juan</b>	
Actual Footage Location of Well:					
<b>2130</b> feet from the <b>South</b> line and <b>870</b> feet from the <b>West</b> line					
Ground Level Elev. <b>5114</b>	Producing Formation <b>Gallup</b>	Pool <b>Cha-Cha Gallup</b>		Dedicated Acreage <b>70.579465</b> Acres	

1. Outline the acreage dedicated to the subject well by colored pencil or hatchure marks on the plat below.
2. If more than one lease is dedicated to the well, outline each and identify the ownership thereof (both as to working interest and royalty).
3. If more than one lease of different ownership is dedicated to the well, have the interests of all owners been consolidated by communitization, unitization, force-pooling, etc?

☐ Yes ☐ No If answer is "yes," type of consolidation \_\_\_\_\_

If answer is "no," list the owners and tract descriptions which have actually been consolidated. (Use reverse side of this form if necessary.) \_\_\_\_\_

No allowable will be assigned to the well until all interests have been consolidated (by communitization, unitization, forced-pooling, or otherwise) or until a non-standard unit, eliminating such interests, has been approved by the Commission.

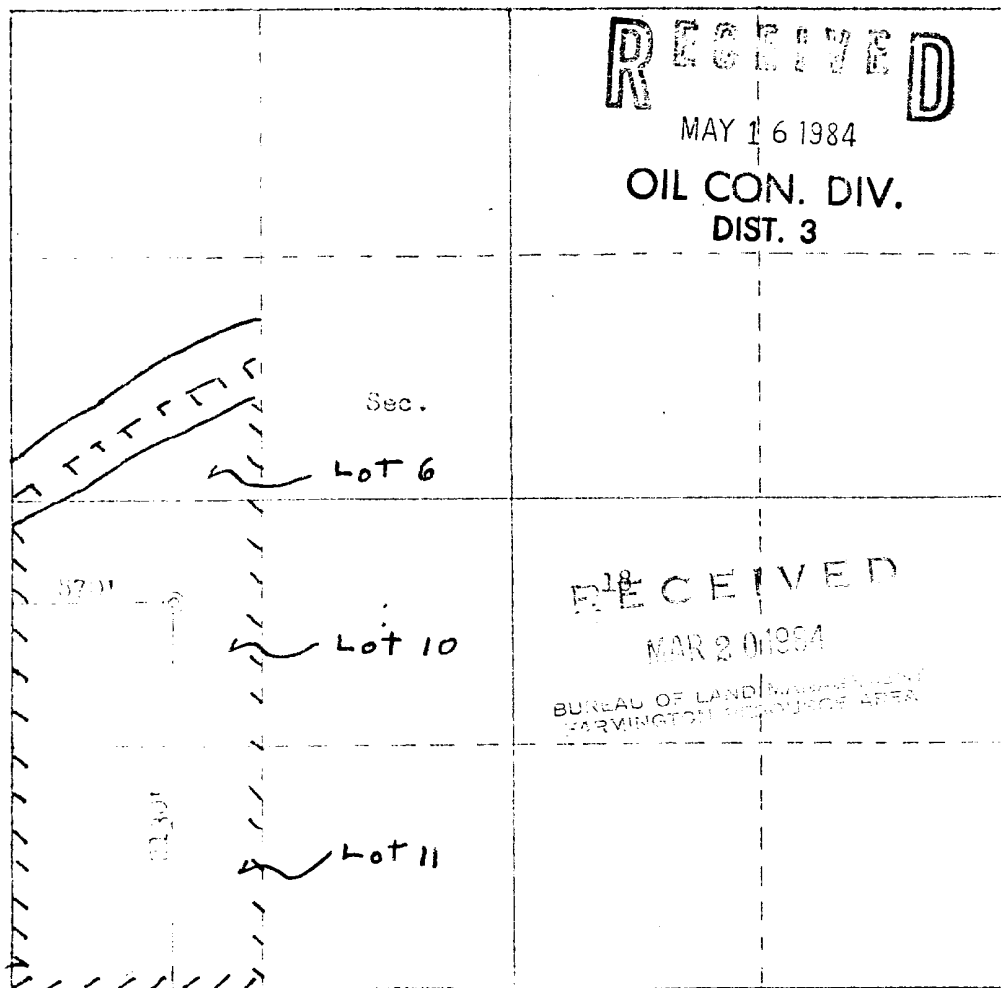

CERTIFICATION

I hereby certify that the information contained herein is true and complete to the best of my knowledge and belief.

*Denny G. Faust*  
Name

*Denny G. Faust*  
Position

*Agent*  
Agent

*Slayton Oil Corp.*  
Company

*3/16/84*  
Date

I hereby certify that the well location shown on this plat was plotted from field notes of actual surveys made by me or under my supervision, and that the same is true and correct to the best of my knowledge and belief.

*February 27, 1984*  
Date Surveyed

*Fred B. Kerr Jr.*  
Registered Professional Engineer and Land Surveyor

*Fred B. Kerr Jr.*  
Certification No. 3950

