

STATE OF NEW MEXICO
ENERGY AND MINERALS DEPARTMENT

OIL CONSERVATION DIVISION
P. O. BOX 2088
SANTA FE, NEW MEXICO 87501

Form C-101
Revised 10-1-78

NO. OF COPIES RECEIVED	
DISTRIBUTION	
SANTA FE	
FILE	
U.S.G.S.	
LAND OFFICE	
OPERATOR	

1A. Indicate Type of Lease
STATE ☐ FEE ☒
3. State Oil & Gas Lease No.

APPLICATION FOR PERMIT TO DRILL, DEEPEN, OR PLUG BACK

1a. Type of Work
DRILL ☒ DEEPEN ☐ PLUG BACK ☐
b. Type of Well
OIL WELL ☐ GAS WELL ☒ OTHER ☐ SINGLE ZONE ☒ MULTIPLE ZONE ☐
2. Name of Operator
Energy Reserves Group, Inc.
3. Address of Operator
P. O. Box 3280; Casper, WY 82602
4. Location of Well
UNIT LETTER P LOCATED 1055 FEET FROM THE South LINE
AND 805 FEET FROM THE East LINE OF SEC. 24 TWP. 29N RST. 13W NEADP

7. Unit Agreement Name
Gallegos Canyon Unit
8. Term or Lease Name
9. Well No.
348
10. Field and Pool, or Wildcat
Unnamed Farmington
12. County
San Juan

15. Proposed Depth 625'
19A. Formation Farmington
20. Rotary or C.T. Rotary
21. Elevations (Show whether DF, RT, etc.) 5297' GR
21A. Kind & Status Plug, Bond Blanket
21B. Drilling Contractor James
22. Approx. Date Work will start Fall 1984

23. PROPOSED CASING AND CEMENT PROGRAM

SIZE OF HOLE	SIZE OF CASING	WEIGHT PER FOOT	SETTING DEPTH	SACKS OF CEMENT	EST. TOP
12-1/4"	8-5/8"	20#	120'	Cement to surface	
6-1/4"	4-1/2"	9.5#	625'	Cement to surface	

It is proposed to drill the above referenced well with rotary tools from the surface to T.D.. Anticipated zone of completion is the Farmington formation.

Estimated Tops: Kirtland @ surface
T.D. 625'

RECEIVED
SEP 25 1984
OIL CON. DIV.
DIST. 3

APPROVAL EXPIRES 3-25-85
UNLESS DRILLING IS COMMENCED.
SPUD NOTICE MUST BE SUBMITTED
WITHIN 10 DAYS.

IN ABOVE SPACE DESCRIBE PROPOSED PROGRAM: IF PROPOSAL IS TO DEEPEN OR PLUG BACK, GIVE DATA ON PRESENT PRODUCTIVE ZONE AND PROPOSED NEW PRODUCTIVE ZONE. GIVE BLOWOUT PREVENTER PROGRAM, IF ANY.

I hereby certify that the information above is true and complete to the best of my knowledge and belief.

Signed William J. Starn Title Administrator, Field Services Date September 20, 1984

(This space for State Use)

APPROVED BY James D. Cherry TITLE SUPERVISOR DISTRICT #3 DATE SEP 25 1984
CONDITIONS OF APPROVAL, IF ANY:

BOP Required

OIL CONSERVATION DIVISION

P. O. BOX 2088

SANTA FE, NEW MEXICO 87501

Form C-107
Revised 10-1-

STATE OF NEW MEXICO

ENERGY AND MINERALS DEPARTMENT

All distances must be from the outer boundaries of the Section.

Operator ENERGY RESERVES GROUP		Lease GALLEGOS CANYON UNIT		Well No. 348
Unit Letter P	Section 24	Township 29N	Range 13W	County San Juan
Actual Footage Location of Well: 1055 feet from the South line and 805 feet from the East line				
Ground Level Elev: 5297	Producing Formation Farmington	Pool W. C. Unnamed Farmington		Dedicated Acreage: 160 Acres

1. Outline the acreage dedicated to the subject well by colored pencil or hatchure marks on the plat below.
2. If more than one lease is dedicated to the well, outline each and identify the ownership thereof (both as to working interest and royalty).
3. If more than one lease of different ownership is dedicated to the well, have the interests of all owners been consolidated by communitization, unitization, force-pooling, etc?

☒ Yes ☐ No If answer is "yes," type of consolidation Unitization

If answer is "no," list the owners and tract descriptions which have actually been consolidated. (Use reverse side of this form if necessary.)

No allowable will be assigned to the well until all interests have been consolidated (by communitization, unitization, forced-pooling, or otherwise) or until a non-standard unit, eliminating such interests, has been approved by the Commission.

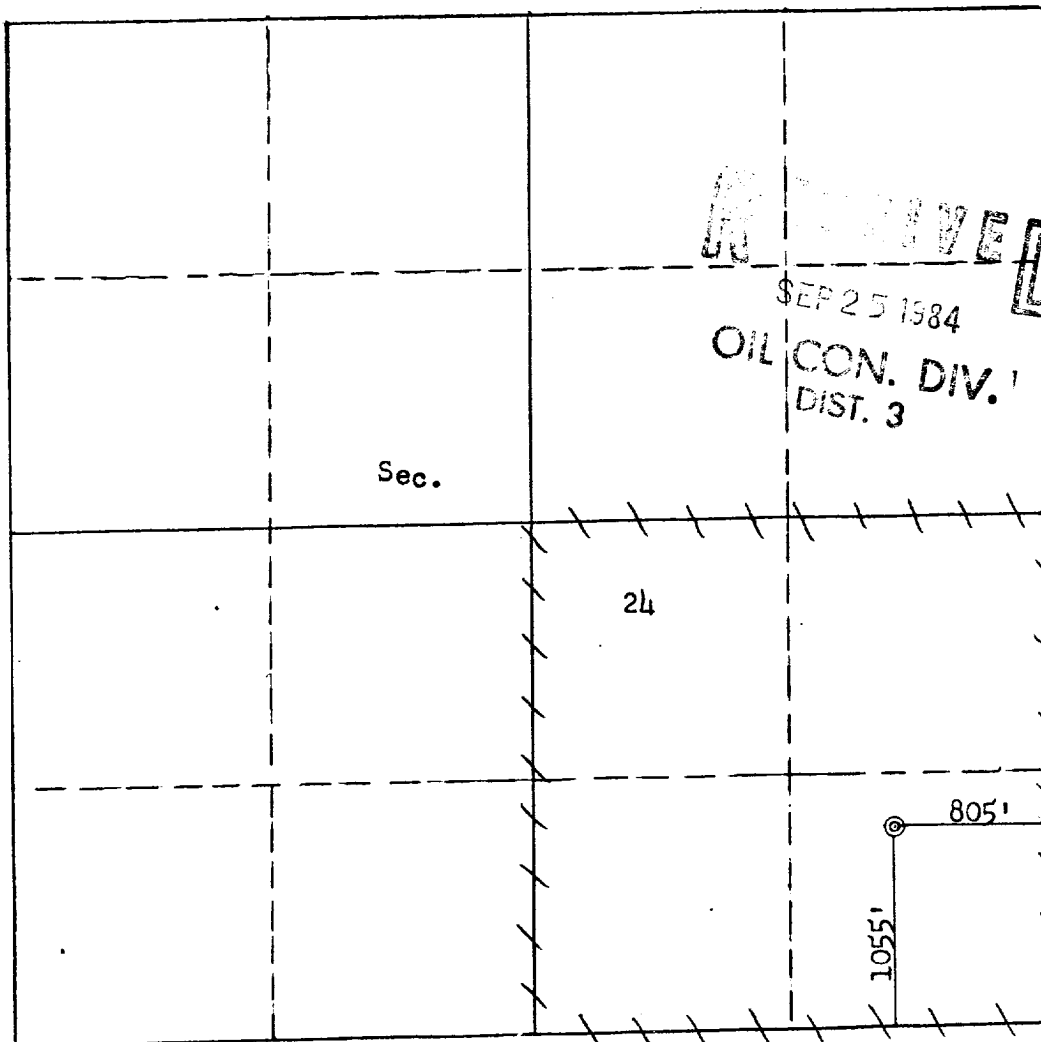

Scale: 1"=1000'

CERTIFICATION

I hereby certify that the information contained herein is true and complete to the best of my knowledge and belief.

Name William J. Fiant
Position Administrator, Field Services
Company Energy Reserves Group, Inc.
Date September 20, 1984

I hereby certify that the well location shown on this plat was plotted from field notes of actual surveys made by me or under my supervision, and that the same is true and correct to the best of my knowledge and belief.

Date Surveyed September 12, 1984
Registered Professional Engineer and Land Surveyor
Fred B. Kerr Jr.
Certificate No. 3950