

NO. OF COPIES RECEIVED		
DISTRIBUTION		
SANTA FE		
FILE		
U.S.G.S.		
LAND OFFICE		
OPERATOR		

OIL CONSERVATION DIVISION

P. O. BOX 2088

SANTA FE, NEW MEXICO 87501

Form C-103
Revised 10-1-70

5a. Indicate Type of Lease	
State <input type="checkbox"/>	Fee <input checked="" type="checkbox"/>
5. State Oil & Gas Lease No.	

SUNDRY NOTICES AND REPORTS ON WELLS

(DO NOT USE THIS FORM FOR PROPOSALS TO DRILL OR TO DEEPEN OR PLUG BACK TO A DIFFERENT RESERVOIR. USE "APPLICATION FOR PERMIT -" (FORM C-101) FOR SUCH PROPOSALS.)

1. OIL WELL <input type="checkbox"/> GAS WELL <input checked="" type="checkbox"/> OTHER-		7. Unit Agreement Name
2. Name of Operator Amoco Production Company		8. Farm or Lease Name Baca Gas Com "A"
3. Address of Operator 501 Airport Drive, Farmington, NM 87401		9. Well No. 1
4. Location of Well UNIT LETTER <u>H</u> <u>1670</u> FEET FROM THE <u>North</u> LINE AND <u>1175</u> FEET FROM THE <u>East</u> LINE, SECTION <u>26</u> TOWNSHIP <u>29N</u> RANGE <u>10W</u> NMPM.		10. Field and Pool, or Wildcat Blanco Mesaverde
15. Elevation (Show whether DF, RT, GR, etc.) 5534' GR		12. County San Juan

16. Check Appropriate Box To Indicate Nature of Notice, Report or Other Data

NOTICE OF INTENTION TO:

PERFORM REMEDIAL WORK <input type="checkbox"/>	PLUG AND ABANDON <input type="checkbox"/>
TEMPORARILY ABANDON <input type="checkbox"/>	CHANGE PLANS <input checked="" type="checkbox"/>
PULL OR ALTER CASING <input type="checkbox"/>	OTHER <input type="checkbox"/>

SUBSEQUENT REPORT OF:

REMEDIAL WORK <input type="checkbox"/>	ALTERING CASING <input type="checkbox"/>
COMMENCE DRILLING OPS. <input type="checkbox"/>	PLUG AND ABANDONMENT <input type="checkbox"/>
CASING TEST AND CEMENT JOBS <input type="checkbox"/>	OTHER <input type="checkbox"/>

17. Describe Proposed or Completed Operations (Clearly state all pertinent details, and give pertinent dates, including estimated date of starting any proposed work) SEE RULE 1103.

Amoco Production Company requests approval to change the casing from 8-5/8", 24#, J-55 to 9-5/8", 32.3#, H-40 and the 4-1/2", 10.5#, K-55 to 7", 40#, K-55. We would also like to dual complete this well as Otero Chacra with 160 acre spacing and Blanco Mesaverde with 320 acre spacing (see plat attached). The new total depth would be 4448'.

RECEIVED

NOV 30 1984

OIL CON. DIV.
DIST. 3

18. I hereby certify that the information above is true and complete to the best of my knowledge and belief.

Original Signed By

SIGNED B. D. ShawTITLE Administrative SupervisorDATE 11/27/84

Original Signed by FRANK T. CHAVEZ

APPROVED BY FRANK T. CHAVEZTITLE SUPERVISOR DISTRICT #3DATE NOV 30 1984

CONDITIONS OF APPROVAL, IF ANY:

All distances must be from the outer boundaries of the Section.

Operator AMOCO PRODUCTION COMPANY			Lease BACA GAS COM "A"		Well No. 1
Unit Letter H	Section 26	Township 29N	Range 10W	County San Juan	
Actual Footage Location of Well: 1670 feet from the North line and 1175 feet from the East line					
Ground Level Elev: 5534	Producing Formation Mesaverde + Chacra		Pool Blanco Mesaverde + Otero Chacra	Dedicated Acreage 320 / 160 Acres	

1. Outline the acreage dedicated to the subject well by colored pencil or hatchure marks on the plat below.
2. If more than one lease is dedicated to the well, outline each and identify the ownership thereof (both as to working interest and royalty).
3. If more than one lease of different ownership is dedicated to the well, have the interests of all owners been consolidated by communitization, unitization, force-pooling, etc?

☒ Yes ☐ No If answer is "yes," type of consolidation Communitized

If answer is "no," list the owners and tract descriptions which have actually been consolidated. (Use reverse side of this form if necessary.)

No allowable will be assigned to the well until all interests have been consolidated (by communitization, unitization, forced-pooling, or otherwise) or until a non-standard unit, eliminating such interests, has been approved by the Commission.

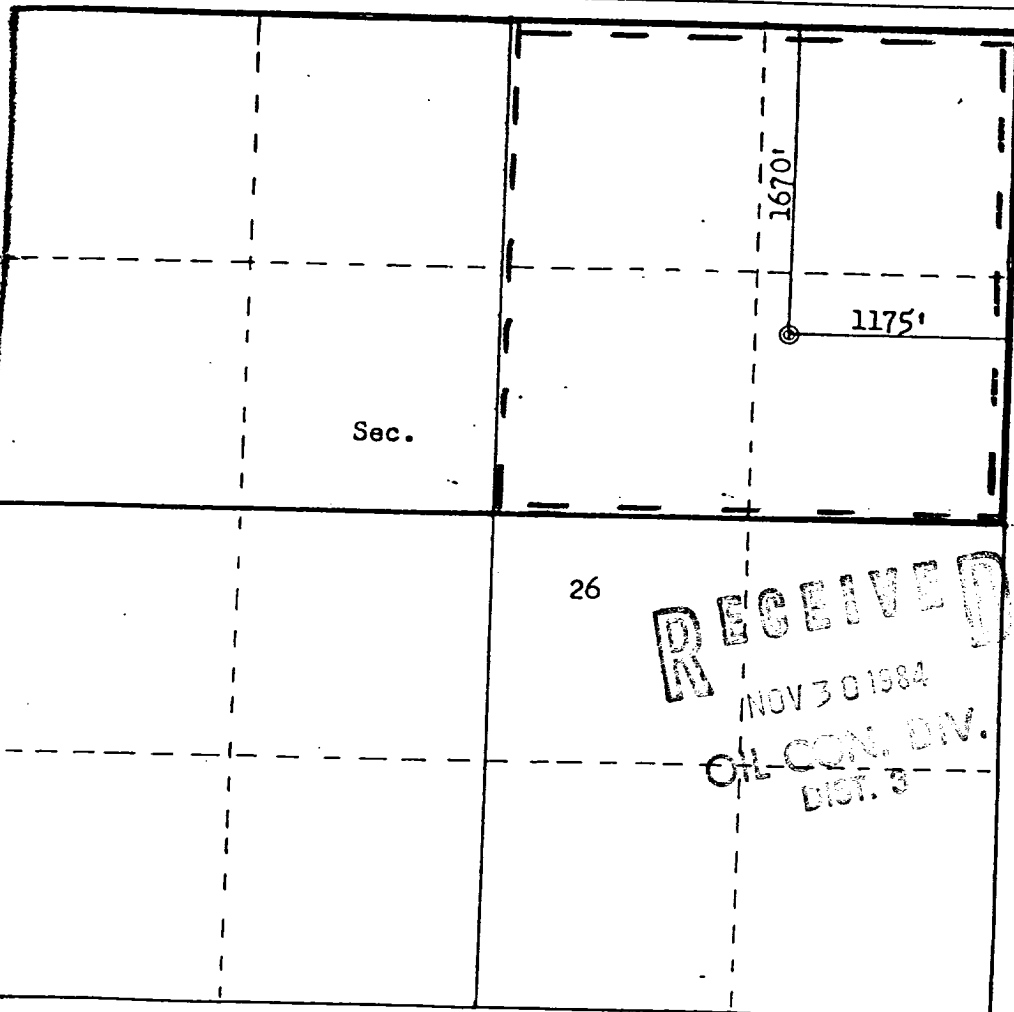

Scale: 1"=1000'

CERTIFICATION

I hereby certify that the information contained herein is true and complete to the best of my knowledge and belief.

Original Signed By
B. D. Shaw

Name
B. D. Shaw
Position
Admin. Supervisor
Company
Amoco Production Company
Date
10-8-84

I hereby certify that the well location shown on this plat was plotted from field notes of actual surveys made by me or under my supervision, and that the same is true and correct to the best of my knowledge and belief.

Date Surveyed
October 6, 1984
Registered Professional Engineer and Land Surveyor
Fred B. Kent Jr.
Certificate No. 11