

UNITED STATES
DEPARTMENT OF THE INTERIOR
BUREAU OF LAND MANAGEMENT

APPLICATION FOR PERMIT TO DRILL, DEEPEN, OR PLUG BACK

1a. TYPE OF WORK

DRILL ☒

DEEPEN ☐

PLUG BACK ☐

b. TYPE OF WELL

OIL
WELL ☒

GAS
WELL ☐

OTHER

SINGLE
ZONE ☐

MULTIPLE
ZONE ☒

2. NAME OF OPERATOR

Amoco Production Co.

3. ADDRESS OF OPERATOR

501 Airport Drive, Farmington, N M 87401

4. LOCATION OF WELL (Report location clearly and in accordance with any State requirements.)

2248' 1650'
2220' FNL x 1450' FEL

At proposed prod. zone

2230' N same

14. DISTANCE IN MILES AND DIRECTION FROM NEAREST TOWN OR POST OFFICE

24 miles west of Farmington

15. DISTANCE FROM PROPOSED LOCATION TO NEAREST PROPERTY OR LEASE LINE, FT. (Also to nearest drg. unit line, if any)

1450'

18. DISTANCE FROM PROPOSED LOCATION TO NEAREST WELL, DRILLING, COMPLETED, OR APPLIED FOR, ON THIS LEASE, FT.

2600' West

16. NO. OF ACRES IN LEASE

4800

17. NO. OF ACRES ASSIGNED TO THIS WELL

40 160740

19. PROPOSED DEPTH

7275'

20. ROTARY OR CABLE TOOLS

rotary

21. ELEVATIONS (Show whether DP, RT, GR, etc.)

5187 GR

DRILLING OPERATIONS AUTHORIZED ARE
SUBJECT TO COMPLIANCE WITH ATTACHED

22. APPROX. DATE WORK WILL START
As soon as permitted

23. GENERAL REQUIREMENTS

This action is subject to administrative
appeal pursuant to 30 CFR 290.

SIZE OF HOLE	SIZE OF CASING	WEIGHT PER FOOT	SETTING DEPTH	QUANTITY OF CEMENT
17-1/2"	13-3/8"	48#, H-40	200'	354 cu ft Class B
12-1/4"	9-5/8"	36#, K-55	2275'	1300 cu ft Class B
8-3/4"	7"	23#, N-80	7275'	1640' cu ft Class B
		20#, K-55		

Amoco proposes to drill the above well to further develop the Hogback Penn & Leadville reservoirs. The well will be drilled to the surface casing point using native mud. The well will then be drilled to a TD with a low solids nondispersed mud system. Completion design will be based on open hole logs. Copy of all logs will be filed upon completion. Amoco's standard blowout prevention will be employed; see attached drawing for blowout preventer design. Upon completion the well site will be cleaned and the reserve pit filled and leveled.

No H2S gas is expected to be encountered based on the drilling and completion of the USG Section 18 #38.

IN ABOVE SPACE DESCRIBE PROPOSED PROGRAM: If proposal is to deepen or plug back, give data on present productive zone and proposed new productive zone. If proposal is to drill or deepen directionally, give pertinent data on subsurface locations and measured and true vertical depths. Give blowout preventer program, if any.

24. SIGNED BDS Shaw TITLE Adm. Supervisor

APPROVED
AS AMENDED

(This space for Federal or State office use)

PERMIT NO.

APPROVAL DATE

APPROVED BY
CONDITIONS OF APPROVAL, IF ANY:

TITLE

NMOCC

*See Instructions On Reverse Side

All distances must be from the outer boundaries of the Section.

Operator AMOCO PRODUCTION COMPANY			Lease USG SECTION 18		Well No. 46
Unit Letter G	Section 18	Township 29 NORTH	Range 16 WEST	County SAN JUAN	

Actual Footage Location of Wells 2230 feet from the NORTH line and 1650 feet from the EAST line					
Ground Level Elev. 5179	Producing Formation Penn/Leadville	Pool Hogback Penn/Unders. Leadville	Dedicated Acreage 160/40 Acres		

1. Outline the acreage dedicated to the subject well by colored pencil or hachure marks on the plat below.
2. If more than one lease is dedicated to the well, outline each and identify the ownership thereof (both as to working interest and royalty).
3. If more than one lease of different ownership is dedicated to the well, have the interests of all owners been consolidated by communitization, unitization, force-pooling, etc?

☐ Yes ☐ No If answer is "yes," type of consolidation _____

If answer is "no," list the owners and tract descriptions which have actually been consolidated. (Use reverse side of this form if necessary.) _____

No allowable will be assigned to the well until all interests have been consolidated (by communitization, unitization, forced-pooling, or otherwise) or until a non-standard unit, eliminating such interests, has been approved by the Division.

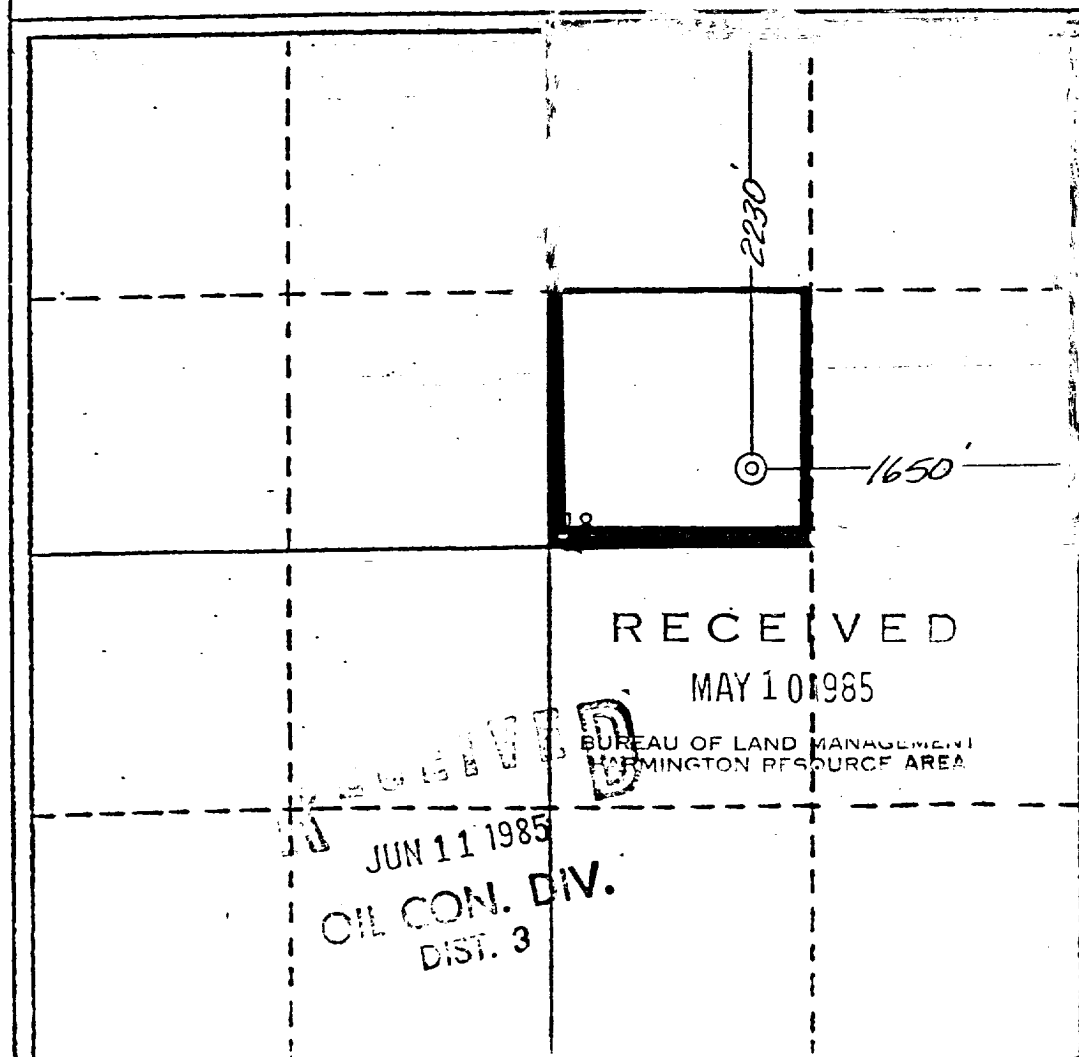

RECEIVED
MAY 10 1985

BUREAU OF LAND MANAGEMENT
HARMINGTON RESOURCE AREA

JUN 11 1985
OIL CON. DIV.
DIST. 3

CERTIFICATION

I hereby certify that the information contained herein is true and complete to the best of my knowledge and belief.

B D Shaw

Name
B. D. Shaw
Position
Adm. Supervisor
Company
Amoco Production Co.
Date
5-9-85

I hereby certify that the location shown on this plat was plotted from field notes of actual survey made by me or under my supervision, and that the same is true and correct to the best of my knowledge and belief.

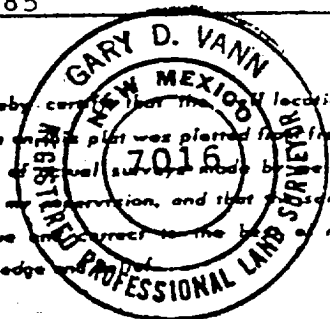

Date Surveyed
May 3, 1985
Registered Professional Engineer and/or Land Surveyor
[Signature]
Gary D. Vann
Certificate No.
7016

