

STATE OF NEW MEXICO  
ENERGY AND MINERALS DEPARTMENT

OIL CONSERVATION DIVISION  
P. O. BOX 2088  
SANTA FE, NEW MEXICO 87501

Form C-101  
Revised 10-1-79

NO. OF COPIES RECEIVED	
DISTRIBUTION	
SANTA FE	
FILE	
U.S.G.S.	
LAND OFFICE	
OPERATOR	

5A. Indicate Type of Lease  
STATE ☐ FEDERAL ☒  
5. State Oil & Gas Lease No.

APPLICATION FOR PERMIT TO DRILL, DEEPEN, OR PLUG BACK

1a. Type of Work b. Type of Well OIL WELL <input type="checkbox"/> GAS WELL <input checked="" type="checkbox"/> OTHER <input type="checkbox"/> SINGLE ZONE <input checked="" type="checkbox"/> MULTIPLE ZONE <input type="checkbox"/>		2. Name of Operator Amoco Production Co.		7. Unit Agreement Name Gallegos Canyon Unit	
3. Address of Operator 501 Airport Drive, Farmington, N M 87401		8. Form or Lease Name		9. Well No. 401	
4. Location of Well UNIT LETTER <u>J</u> LOCATED <u>1680</u> FEET FROM THE <u>South</u> LINE AND <u>2315</u> FEET FROM THE <u>East</u> LINE OF SEC. <u>13</u> TWP. <u>29N</u> RGE. <u>13W</u> NMAPM		10. Field and Pool, or Wildcat W. Kutz Pict Cliff Ext		11. County San Juan	
19. Proposed Depth 1581'		19A. Formation Pict. Cliffs		20. History or C.T. Rotary	
21. Elevations (Show whether D.P., R.T., etc.) 5422' GR.		21A. Kind & Status Plug. Bond Statewide		21B. Drilling Contractor Unknown	
				22. Approx. Date Work will start Unknown	

23.

PROPOSED CASING AND CEMENT PROGRAM

SIZE OF HOLE	SIZE OF CASING	WEIGHT PER FOOT	SETTING DEPTH	SACKS OF CEMENT	EST. TOP
12 1/4"	8 5/8"	32# K-55	300'	300 Sx	Surface
7 7/8"	4 1/2"	11.6# K-55	1581'	400 Sx	Surface

Amoco proposes to drill the above well to further develop the W. Kutz Pictured Cliff Ext. reservoir. The well will be drilled to the surface casing point using native mud. The well will then be drilled to TD with a low solids nondispersed mud system. Completion design will be based on open hole logs. Copy of all logs will be file upon completion. Amoco's standard blowout prevention will be employed; see attached drawing for blowout preventer design. Upon completion the well site will be cleaned and the reserve pit filled and leveled. The gas from this well is dedicated to El Paso Natural Gas Company.

APPROVAL EXPIRES 10-22-86  
UNLESS DRILLING IS COMMENCED.  
SPUD NOTICE MUST BE SUBMITTED  
WITHIN 10 DAYS.

RECEIVED  
FEB 20 1986  
OIL CON. DIV.  
DIST. 3

IN ABOVE SPACE DESCRIBE PROPOSED PROGRAM: IF PROPOSAL IS TO DEEPEN OR PLUG BACK, GIVE DATA ON PRESENT PRODUCTION ZONE AND PROPOSED NEW PRODUCTION ZONE. GIVE BLOWOUT PREVENTER PROGRAM, IF ANY.

I hereby certify that the information above is true and complete to the best of my knowledge and belief.

Signed BS Shaw Title Adm. Supervisor Date 2-7-86

(This space for State Use)

APPROVED BY ORIGINAL SIGNED BY ERNIE BUSCH TITLE GEOLOGIST DISTRICT #3 DATE APR 22 1986

CONDITIONS OF APPROVAL, IF ANY:

All distances must be from the outer boundaries of the Section.

Operator <b>AMOCO PRODUCTION COMPANY</b>		Lease <b>GALLEGOS CANYON UNIT</b>		Well No. <b># 401</b>
Unit Letter <b>J</b>	Section <b>13</b>	Township <b>29 NORTH</b>	Range <b>13 WEST</b>	County <b>SAN JUAN</b>
Actual Footage Location of Well: 1680 feet from the SOUTH line and 2315 feet from the EAST line				
Ground Level Elev. <b>5422</b>	Producing Formation <b>Pictured Cliffs</b>	Pool <b>W. Kutz Pictured Cliff Ext</b>	Dedicated Acreage <b>160</b> Acres	

1. Outline the acreage dedicated to the subject well by colored pencil or hachure marks on the plat below.
2. If more than one lease is dedicated to the well, outline each and identify the ownership thereof (both as to working interest and royalty).
3. If more than one lease of different ownership is dedicated to the well, have the interests of all owners been consolidated by communitization, unitization, force-pooling, etc?

☒ Yes ☐ No If answer is "yes," type of consolidation Unitized

If answer is "no," list the owners and tract descriptions which have actually been consolidated. (Use reverse side of this form if necessary.)

No allowable will be assigned to the well until all interests have been consolidated (by communitization, unitization, forced-pooling, or otherwise) or until a non-standard unit, eliminating such interests, has been approved by the Division.

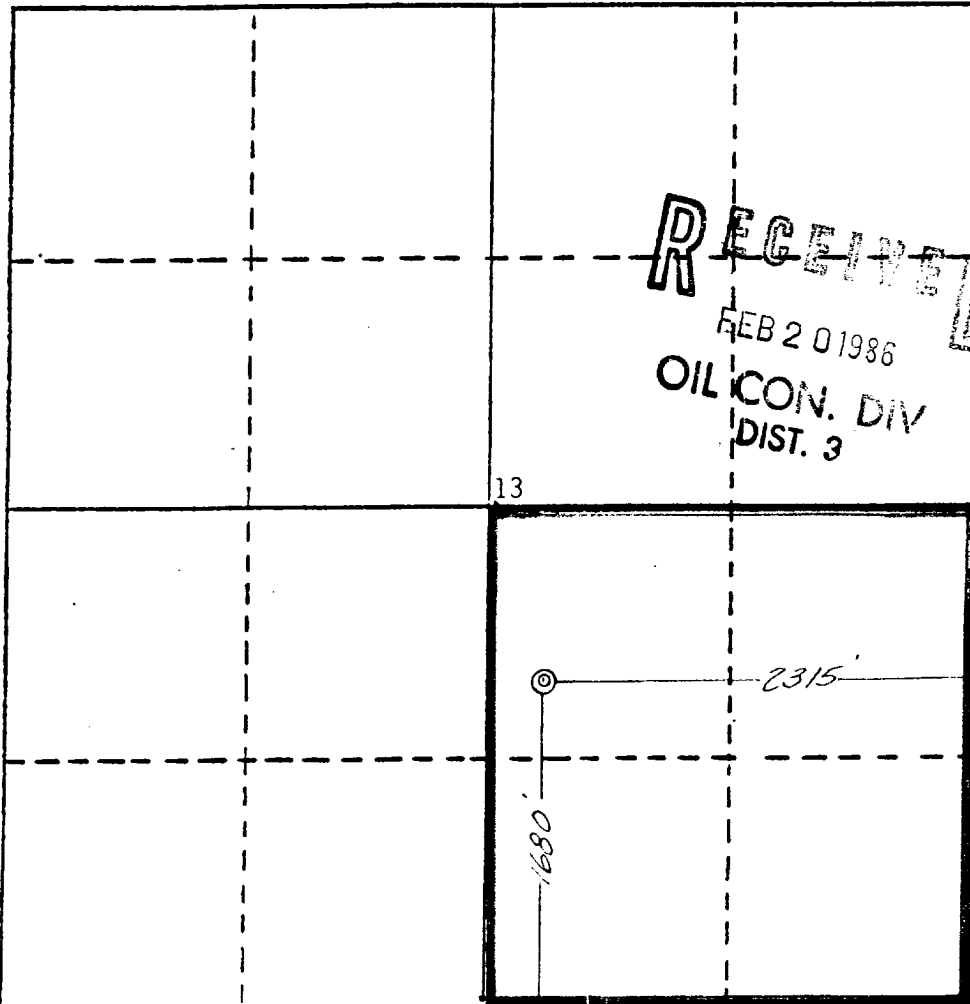

CERTIFICATION

I hereby certify that the information contained herein is true and complete to the best of my knowledge and belief.

*B. D. Shaw*

Name  
**B. D. Shaw**  
Position  
**Adm. Supervisor**  
Company  
**Amoco Production Co.**  
Date  
**February 7, 1986**

I hereby certify that the location shown on this plat was placed from field notes of actual surveys made by me or under my supervision, and that the same is true and correct to the best of my knowledge and belief.

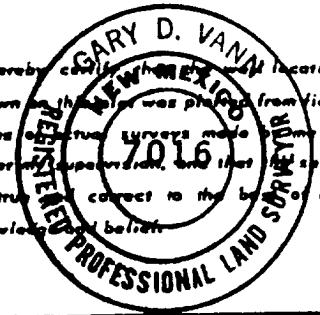

Date Surveyed  
**December 20, 1985**  
Registered Professional Engineer and/or Land Surveyor  
*Gary D. Vann*  
**Gary D. Vann**

Certificate No.  
**7016**

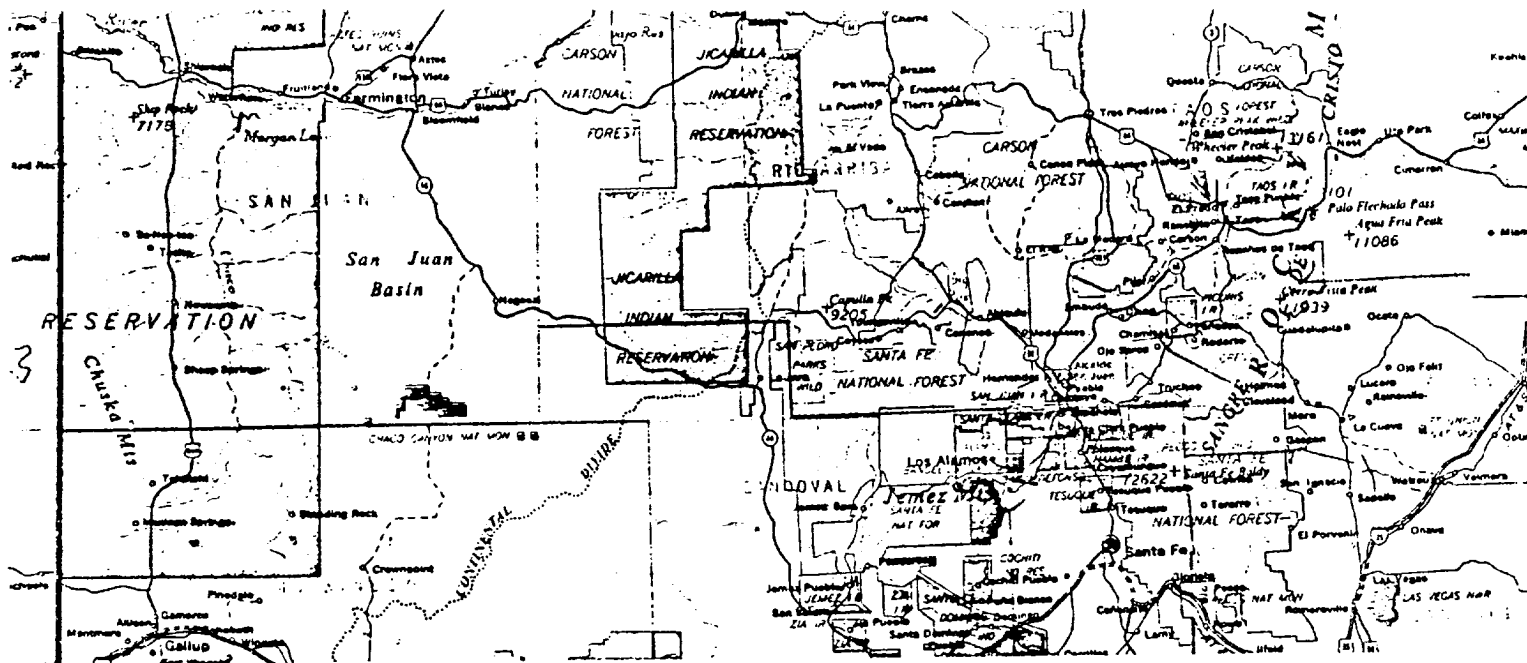

GALLEGOS CANYON UNIT # 401  
 1680' F/SL 2315' F/EL  
 SEC. 13, T29N, R13W, NMPM  
 RAIL POINT: 123 MI. GALLUP, NM  
 MUD POINT: 13 MI. AZTEC, NM  
 CEMENT POINT: 4 MI. FARMINGTON, NM

