

30-045-26767

Form C-101
Revised 1-1-65

NO. OF COPIES RECEIVED	
DISTRIBUTION	
SANTA FE	
FILE	
U.S.G.S.	
LAND OFFICE	
OPERATOR	

NEW MEXICO OIL CONSERVATION COMMISSION

5A. Indicate Type of Lease
STATE ☐ FEE ☒
5. State Oil & Gas Lease No.

APPLICATION FOR PERMIT TO DRILL, DEEPEN, OR PLUG BACK

1a. Type of Work
DRILL ☒ DEEPEN ☐ PLUG BACK ☐
b. Type of Well
OIL WELL ☐ GAS WELL ☒ OTHER ☐ SINGLE ZONE ☒ MULTIPLE ZONE ☐
2. Name of Operator
BHP Petroleum (Americas) Inc.
3. Address of Operator
5613 DTC Parkway, Suite 600, Englewood, Colorado 80111
4. Location of Well
UNIT LETTER D LOCATED 1165 FEET FROM THE North LINE
AND 695 FEET FROM THE West LINE OF SEC. 25 TWP. 29N RGE. 13W NMPM
10. Field and Pool, or Wildcat
W. Kutz Pictured Cliffs
12. County
San Juan
13. Proposed Depth
1305'
19A. Formation
Pictured Cliffs
20. Rotary or C.T.
Rotary
21. Elevations (Show whether DF, RT, etc.)
5362' GR
21A. Kind & Status Plug. Bond
Blanket
21B. Drilling Contractor
Unknown
22. Approx. Date Work will start
As soon as approved

23. PROPOSED CASING AND CEMENT PROGRAM

SIZE OF HOLE	SIZE OF CASING	WEIGHT PER FOOT	SETTING DEPTH	SACKS OF CEMENT	EST. TOP
8-3/4"	7"	20#	120'	35 sx	Surface
6-1/4"	4-1/2"	9.5#	1305'	140 sx	Surface

It is proposed to drill the above referenced well to 1305' with primary production anticipated in the Pictured Cliffs formation.

Estimated formation tops are: Ojo Alamo Surface
Kirtland 5'
Fruitland 880'
Pictured Cliffs 1185'
T.D. 1305'

BOPE will consist of a minimum of an 8" Regan "K" 3000# annular preventer with rotating head.

APPROVAL EXPIRES 9-21-88
UNLESS DRILLING IS COMMENCED.
SPUD NOTICE MUST BE SUBMITTED
WITHIN 10 DAYS

RECEIVED
MAR 18 1988
OIL CON. DIV.
D&E

IN ABOVE SPACE DESCRIBE PROPOSED PROGRAM: IF PROPOSAL IS TO DEEPEN OR PLUG BACK, GIVE DATA ON PRESENT PRODUCTIVE ZONE AND PROPOSED NEW PRODUCTIVE ZONE. CIVIL BLOWOUT PREVENTER PROGRAM, IF ANY.

I hereby certify that the information above is true and complete to the best of my knowledge and belief.
Signed Chuck Williams Title Administrator, Field Services Date 03/16/88
(This space for State Use)

APPROVED BY Emile Busch TITLE DEPUTY OIL & GAS INSPECTOR, DIST. #3 DATE MAR 21 1988
CONDITIONS OF APPROVAL, IF ANY:

HOLD C-104 FOR NSL

NEW MEXICO OIL CONSERVATION COMMISSION
WELL LOCATION AND ACREAGE DEDICATION PLAT

Form C-102
Supersedes C-128
Effective 1-1-65

All distances must be from the outer boundaries of the Section.

Operator BHP PETROLEUM (AMERICAS) INC.			Lease GALLEGOS CANYON UNIT		Well No. 364
Unit Letter D	Section 25	Township 29 N	Range 13 W	County SAN JUAN	
Actual Footage Location of Well: 1165 feet from the NORTH line and 695 feet from the WEST line					
Ground Level Elev: 5362	Producing Formation Pictured Cliffs		Pool W. Kutz Pictured Cliffs		Dedicated Acreage: 160 Acres

1. Outline the acreage dedicated to the subject well by colored pencil or hachure marks on the plat below.
2. If more than one lease is dedicated to the well, outline each and identify the ownership thereof (both as to working interest and royalty).
3. If more than one lease of different ownership is dedicated to the well, have the interests of all owners been consolidated by communitization, unitization, force-pooling, etc?

☒ Yes ☐ No If answer is "yes," type of consolidation unitization

If answer is "no," list the owners and tract descriptions which have actually been consolidated. (Use reverse side of this form if necessary.)

No allowable will be assigned to the well until all interests have been consolidated (by communitization, unitization, forced-pooling, or otherwise) or until a non-standard unit, eliminating such interests, has been approved by the Commission.

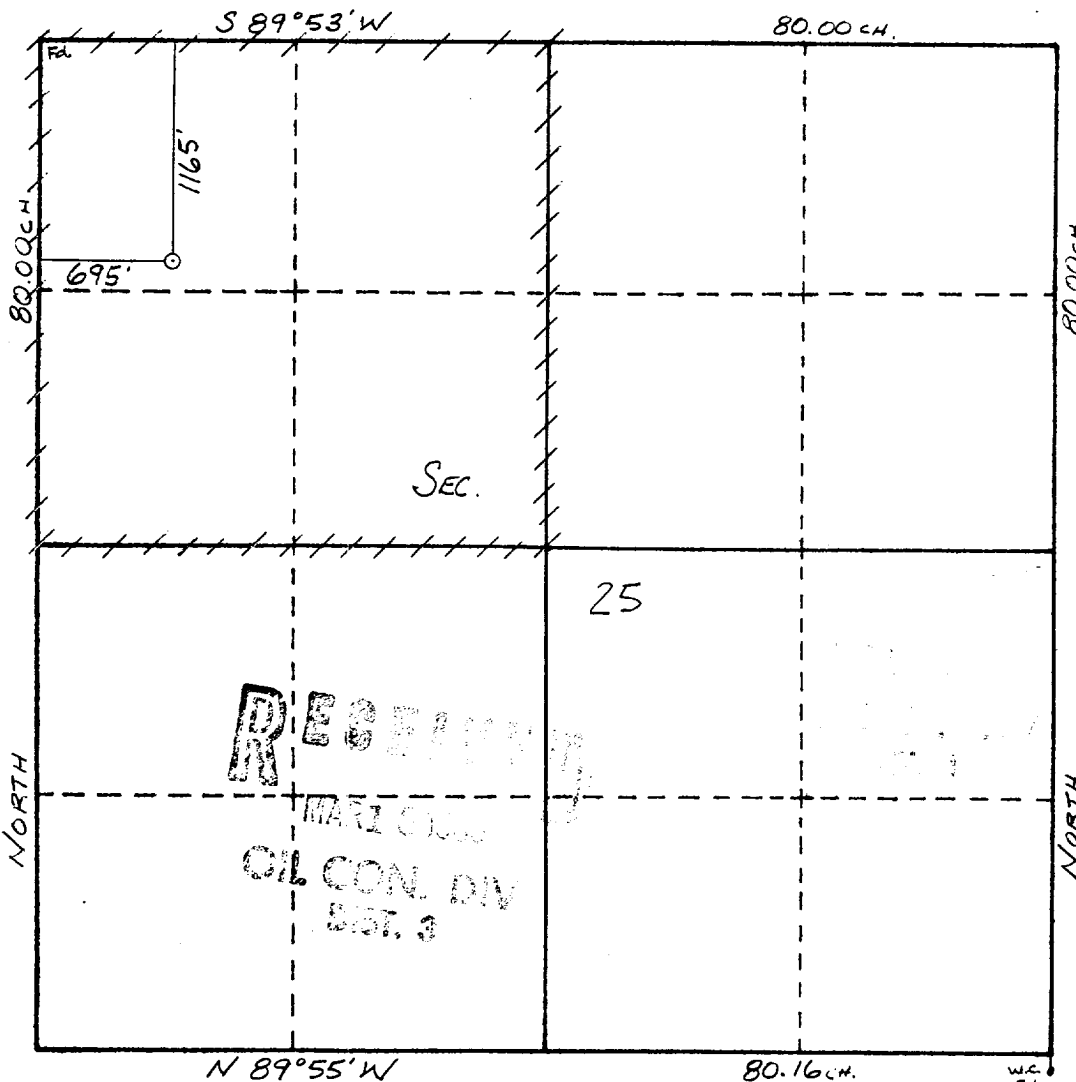

CERTIFICATION

I hereby certify that the information contained herein is true and complete to the best of my knowledge and belief.

Name Chuck Williams
Chuck Williams
Position
Administrator, F.S.
Company
BHP Petroleum (Americas)
Date
03/03/88

I hereby certify that the well location shown on this plat was plotted from field notes of actual surveys made by me or under my supervision, and that the same is true and correct to the best of my knowledge and belief.

Date Surveyed 2-17-88
William W. Mannke
Registered Professional Engineer and Land Surveyor #8466
Certificate No. PROFESSIONAL LAND SURVEYOR

BHP PETROLEUM (AMERICAS) INC.
 #364 GALLEGOS CANYON UNIT
 1165'FNL & 695'FWL
 Sec.25, T29N, R13W
 San Juan Co., N.M.

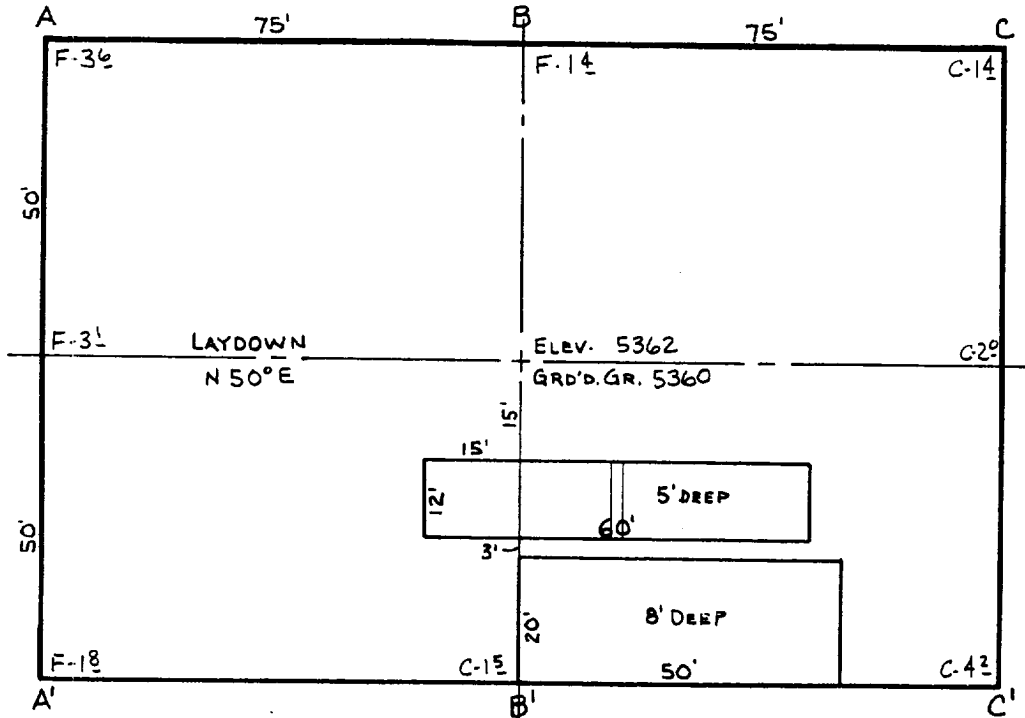

SCALE: 1" = 30'



A-A'		Vert.: 1" = 30'	Horiz.: 1" = 50'	C/L			
5360							
5350							

B-B'							
5360							
5350							

C-C'							
5360							
5350							

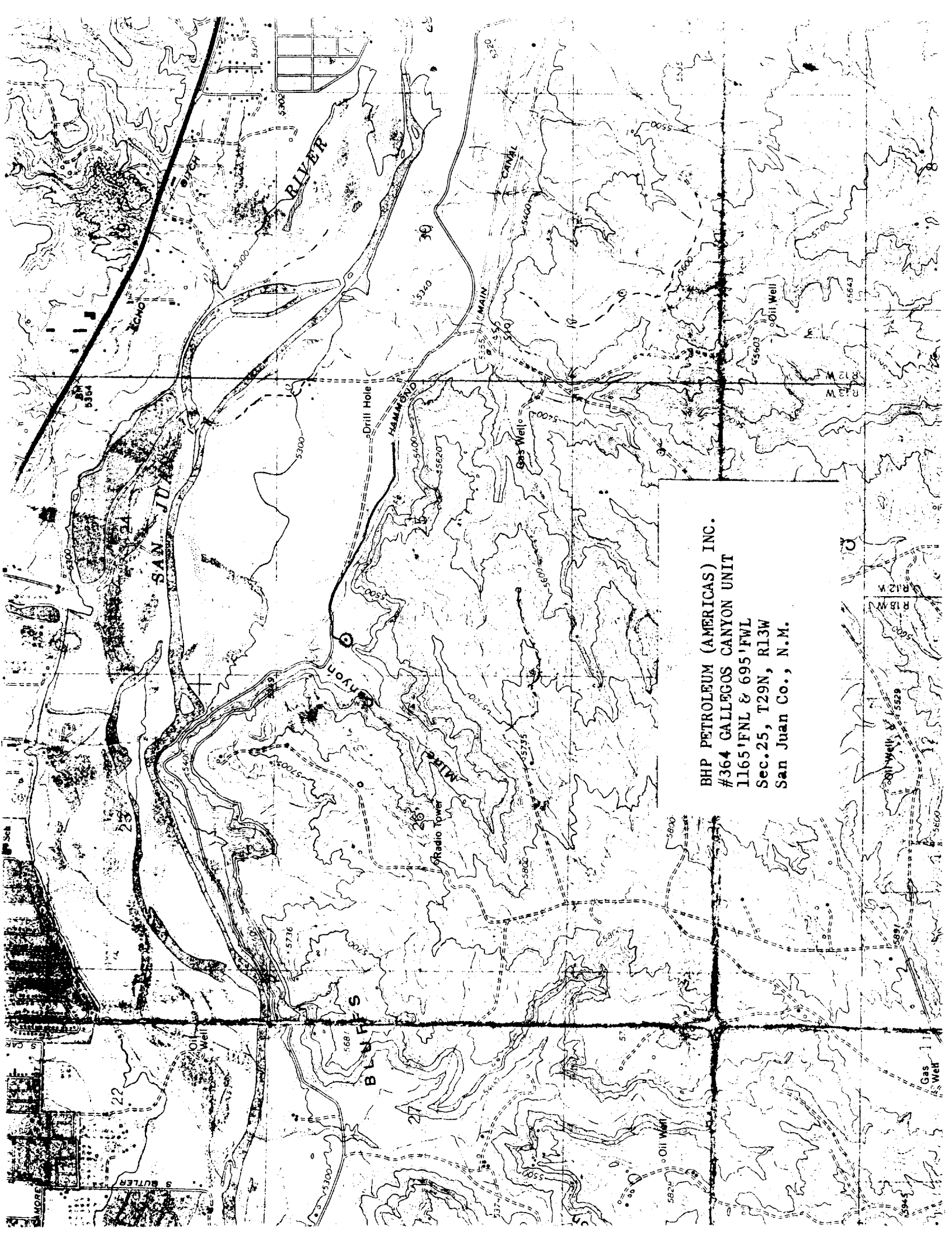

BHP PETROLEUM (AMERICAS) INC.
#364 GALLEGOS CANYON UNIT
1165'FNL & 695'FWL
Sec.25, T29N, R13W
San Juan Co., N.M.