

UNITED STATES  
DEPARTMENT OF THE INTERIOR  
BUREAU OF LAND MANAGEMENT

30-045-26882

APPLICATION FOR PERMIT TO DRILL, DEEPEN, OR PLUG BACK

1A. TYPE OF WORK

DRILL ☒

DEEPEN ☐

PLUG BACK ☐

B. TYPE OF WELL

OIL  
WELL ☐

GAS  
WELL ☒

OTHER

SINGLE  
ZONE ☒

MULTIPLE  
ZONE ☐

2. NAME OF OPERATOR

BHP Petroleum (Americas) Inc.

3. ADDRESS OF OPERATOR

5613 DTC Parkway, Suite 600, Englewood, CO 80111

4. LOCATION OF WELL (Report location clearly and in accordance with any State requirements.)\*

At surface

NWNE, 1265' FNL, 180' FEL

At proposed prod. zone

14. DISTANCE IN MILES AND DIRECTION FROM NEAREST TOWN OR POST OFFICE\*

Approximately 2.5 miles southeast of Farmington, N.M.

15. DISTANCE FROM PROPOSED\*

LOCATION TO NEAREST  
PROPERTY OR LEASE LINE, FT.  
(Also to nearest drlg. unit line, if any)

1265'

16. NO. OF ACRES IN LEASE

1,160

17. NO. OF ACRES ASSIGNED  
TO THIS WELL

160

18. DISTANCE FROM PROPOSED LOCATION\*

TO NEAREST WELL, DRILLING, COMPLETED,  
OR APPLIED FOR, ON THIS LEASE, FT.

200'

19. PROPOSED DEPTH

1675'

20. ROTARY OR CABLE TOOLS

Rotary

21. ELEVATIONS (Show whether DF, RT, GR, etc.)

5722' GR

DRILLING OPERATIONS AUTHORIZED ARE  
SUBJECT TO COMPLIANCE WITH ATTACHED  
"GENERAL REQUIREMENTS".

22. APPROX. DATE WORK WILL START\*

As soon as approved

23.

PROPOSED CASING AND CEMENTING PROGRAM

This action is subject to technical and  
procedural review pursuant to 43 CFR 3165.3  
and appeal pursuant to 43 CFR 3165.4.

SIZE OF HOLE	SIZE OF CASING	WEIGHT PER FOOT	SETTING DEPTH	
8-3/4"	7"	20#	120'	35 sx
6-1/4"	4 1/2"	9.5#	1675'	175 sx

RECEIVED  
APR 2 8 1988  
OIL CONSERVATION  
DIVISION  
BUREAU OF LAND MANAGEMENT  
WASHINGTON, D.C.

RECEIVED  
OIL MAIL ROOM  
03 MAR 15 PM 1:09  
FARMINGTON RESOURCE AREA  
FARMINGTON, NEW MEXICO

IN ABOVE SPACE DESCRIBE PROPOSED PROGRAM: If proposal is to deepen or plug back, give data on present productive zone and proposed new productive zone. If proposal is to drill or deepen directionally, give pertinent data on subsurface locations and measured and true vertical depths. Give blowout preventer program, if any.

24.

SIGNED

*Chuck Williams*  
Chuck Williams

TITLE

Administrator, F.S.

DATE

03/03/88

(This space for Federal or State office use)

PERMIT NO.

APPROVAL DATE

APPROVED  
AS AMENDED

APPROVED BY

TITLE

CONDITIONS OF APPROVAL, IF ANY:

*None for NSL*

NMOCC

APR 19 1988  
*[Signature]*  
AREA MANAGER

\*See Instructions On Reverse Side

**NEW MEXICO OIL CONSERVATION COMMISSION  
WELL LOCATION AND ACREAGE DEDICATION PLAT**

Form C-102  
Supersedes C-128  
Effective 1-1-65

All distances must be from the outer boundaries of the Section.

Operator <b>BHP PETROLEUM (AMERICAS) INC.</b>			Lease <b>GALLEGOS CANYON UNIT</b>		Well No. <b>363</b>
Unit Letter <b>B</b>	Section <b>26</b>	Township <b>29 N</b>	Range <b>13 W</b>	County <b>SAN JUAN</b>	
Actual Footage Location of Well: <b>1265</b> feet from the <b>NORTH</b> line and <b>1805</b> feet from the <b>EAST</b> line					
Ground Level Elev: <b>5722</b>	Producing Formation <b>Pictured Cliffs</b>	Pool <b>W. Kutz Pictured Cliffs</b>		Dedicated Acreage: <b>160</b> Acres	

1. Outline the acreage dedicated to the subject well by colored pencil or hachure marks on the plat below.
2. If more than one lease is dedicated to the well, outline each and identify the ownership thereof (both as to working interest and royalty).
3. If more than one lease of different ownership is dedicated to the well, have the interests of all owners been consolidated by communitization, unitization, force-pooling, etc?

☒ Yes    ☐ No    If answer is "yes," type of consolidation unitization

If answer is "no," list the owners and tract descriptions which have actually been consolidated. (Use reverse side of this form if necessary.) \_\_\_\_\_

No allowable will be assigned to the well until all interests have been consolidated (by communitization, unitization, forced-pooling, or otherwise) or until a non-standard unit, eliminating such interests, has been approved by the Commission.

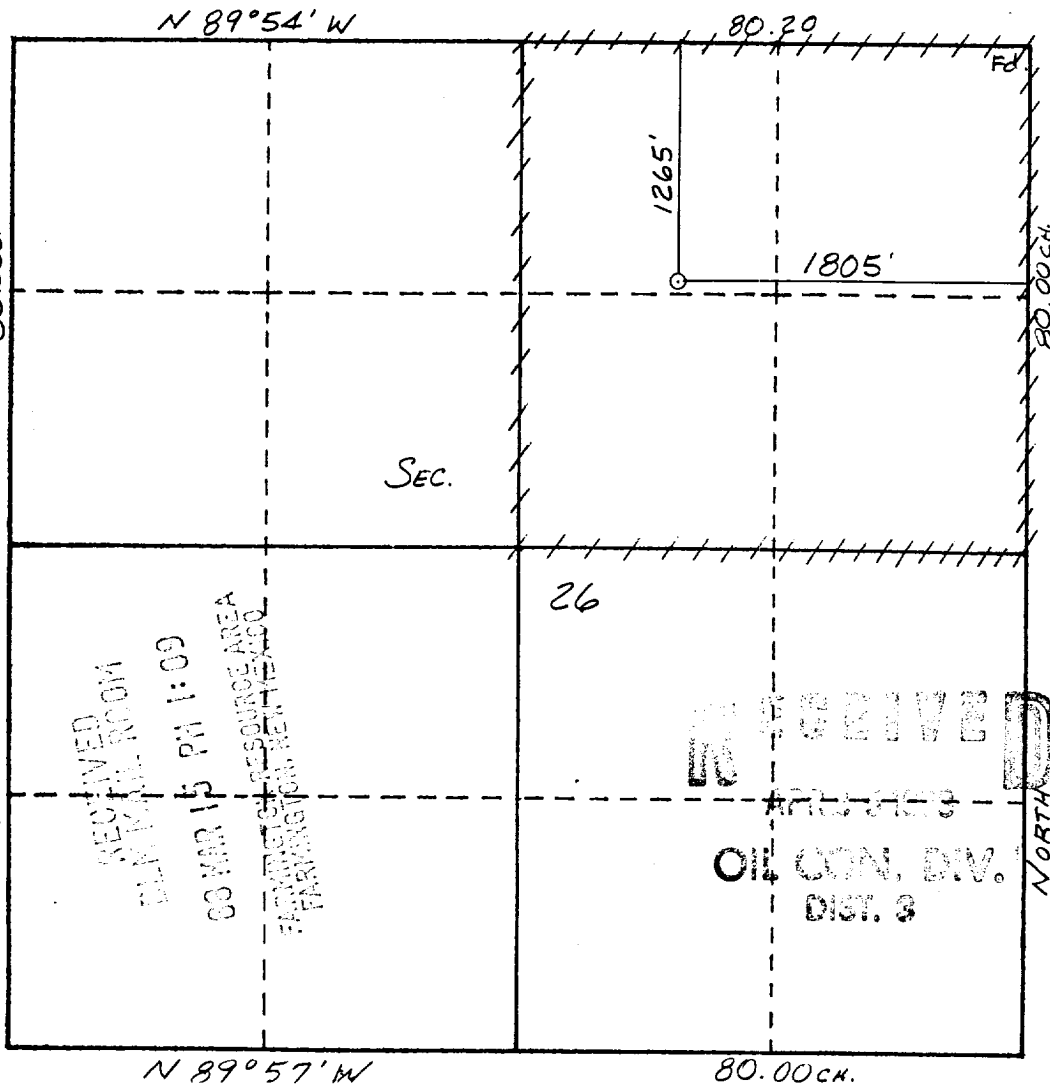

**CERTIFICATION**

I hereby certify that the information contained herein is true and complete to the best of my knowledge and belief.

Name Chuck Williams  
 Chuck Williams  
 Position  
 Administrator, F.S.  
 Company  
 BHP Petroleum (Americas)  
 Date  
 03/03/88

I hereby certify that the well location shown on this plat was plotted from field notes of actual surveys made by me or under my supervision, and that the same is true and correct to the best of my knowledge and belief.

Date Surveyed 2-17-88  
William E. Mink II  
 Registered Professional Engineer  
 and Land Surveyor  
 Certificate No. 8466

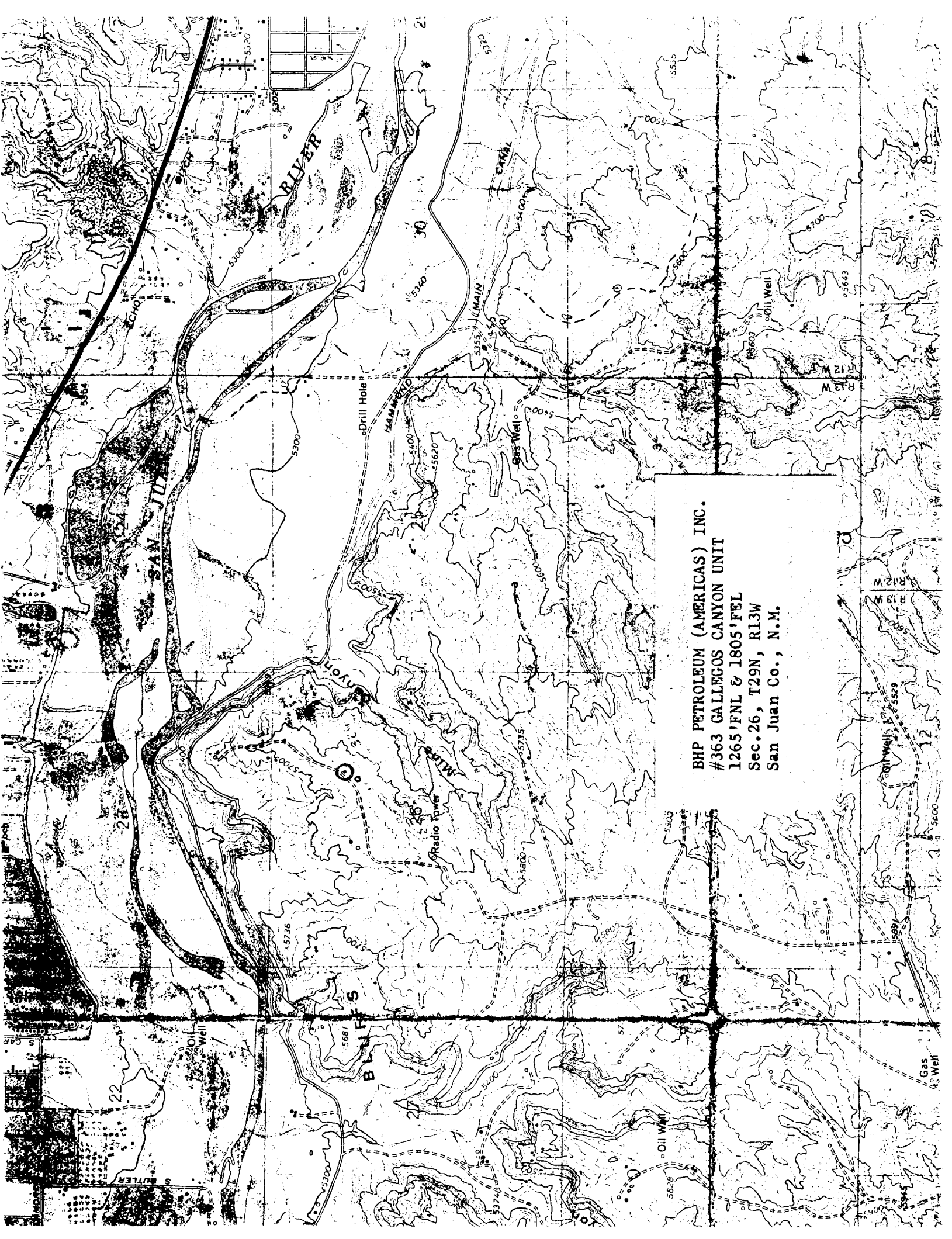

BHP PETROLEUM (AMERICAS) INC.  
#363 GALLEGOS CANYON UNIT  
1265'FNL & 1805'FEL  
Sec.26, T29N, R13W  
San Juan Co., N.M.