

UNITED STATES
DEPARTMENT OF THE INTERIOR
BUREAU OF LAND MANAGEMENT

SUBMIT IN TRIPPLICATE
(Other instructions on re-
verse side)

Form approved
Budget Bureau No. 1004-0135
Expires August 31, 1985

SUNDRY NOTICES AND REPORTS ON WELLS

(Do not use this form for proposals to drill or to deepen or plug back to a different reservoir.
Use "APPLICATION FOR PERMIT—" for such proposals.)

1. OIL WELL <input type="checkbox"/> GAS WELL <input checked="" type="checkbox"/> OTHER <input type="checkbox"/>	7. UNIT AGREEMENT NAME
2. NAME OF OPERATOR Meridian Oil Inc.	8. FARM OR LEASE NAME Howell A
3. ADDRESS OF OPERATOR P.O. Box 4289, Farmington, NM 87499	9. WELL NO. 301
4. LOCATION OF WELL (Report location clearly and in accordance with any State requirements.* See also space 17 below.) At surface 460'S, 1180'W	10. FIELD AND POOL, OR WILDCAT Basin Fruitland Coal
14. PERMIT NO.	11. SEC., T., R., N., OR S.W. 1/4, AND SUBST. OR AREA Sec. 4, 150N, R8W NMPM
15. ELEVATIONS (Show whether OF, BT, OR, etc.) 6249' GL	12. COUNTY OR PARISH San Juan
	13. STATE NM

16.

Check Appropriate Box To Indicate Nature of Notice, Report, or Other Data

NOTICE OF INTENTION TO:

TEST WATER SHUT-OFF

FRACTURE TREAT

SHOOT OR ACIDIZE

REPAIR WELL

(Other) Revision

POLE OR ALTER CASING

MULTIPLE COMPLETE

ABANDON*

CHANGE PLANS

X

SUBSEQUENT REPORT OF:

WATER SHUT-OFF

FRACTURE TREATMENT

SHOOTING OR ACIDIZING

(Other)

REPAIRING WELL

ALTERING CASING

ABANDONMENT*

(Note: Report results of multiple completion on Well Completion or Recompletion Report and Log form.)

17. DESCRIBE PROPOSED OR COMPLETED OPERATIONS (Clearly state all pertinent details, and give pertinent dates, including estimated date of starting any proposed work. If well is directionally drilled, give subsurface locations and measured and true vertical depths for all markers and zones pertinent to this work.)*

Attached is a copy of the C102 showing the revised pool & dedication.

18. I hereby certify that the foregoing is true and correct

SIGNED

TITLE

Regulatory Affairs

DATE

12-22-88

(This space for Federal or State office use)

APPROVED BY

TITLE

DATE

CONDITIONS OF APPROVAL, IF ANY:

*See Instructions on Reverse Side

All distances must be from the outer boundaries of section.

Operator Meridian Oil Co.			Lessee Howell A (SF-078580)			Well No. 301		
Unit Letter M	Section 4	Township T30N	Range R8W	County San Juan				
Actual Footage Location of Wells 460 feet from the South line and 1180 feet from the West line								
Ground Level Elev. 6249	Producing Formation Fruitland Coal		Pool Basin		Dedicated Acreage 320.50 Acres			

1. Outline the acreage dedicated to the subject well by colored pencil or hatchure marks on the plat below.
2. If more than one lease is dedicated to the well, outline each and identify the ownership thereof (both as to working interest and royalty).
3. If more than one lease of different ownership is dedicated to the well, have the interests of all owners been consolidated by communitization, unitization, force-pooling, etc?

☐ Yes ☐ No If answer is "yes," type of consolidation _____

If answer is "no," list the owners and tract descriptions which have actually been consolidated. (Use reverse side of this form if necessary.) _____

No allowable will be assigned to the well until all interests have been consolidated (by communitization, unitization, forced-pooling, or otherwise) or until a non-standard unit, eliminating such interests, has been approved by the Division.

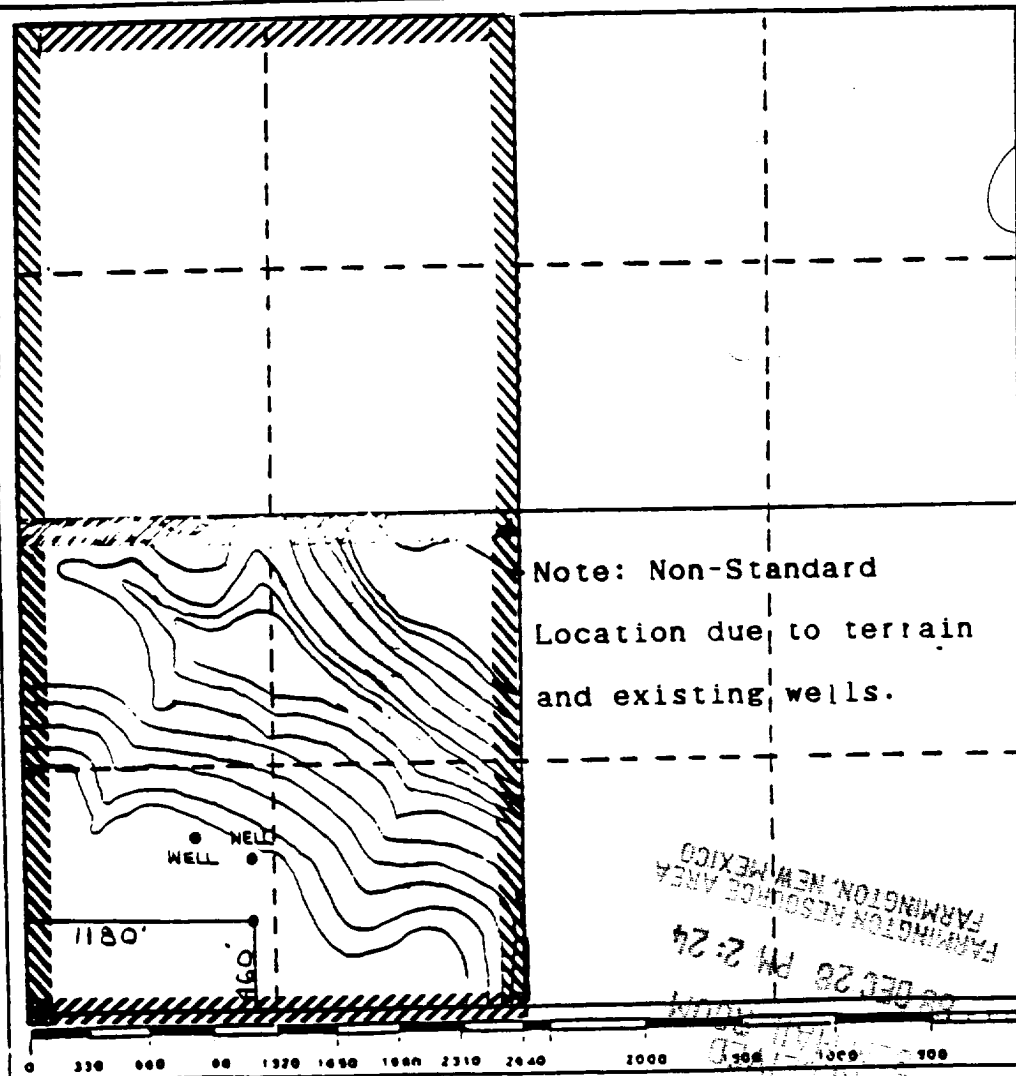

CERTIFICATION

I hereby certify that the information contained herein is true and complete to the best of my knowledge and belief.

Name

Drilling Clerk

Position

Meridian Oil Inc.

Company

12-22-88

Date

I hereby certify that the well location shown on this plat was plotted from field notes of **HOWARD DUGGETT** by me or under my supervision, and that the same is true and correct to the best of my knowledge and belief.

Date Surveyed

April 1988

Registered Professional

R. Howard Duggett

R. Howard Duggett

Certificate No.

9679