

STATE OF NEW MEXICO
ENERGY AND MINERALS DEPARTMENT

OIL CONSERVATION DIVISION
P. O. BOX 2088
SANTA FE, NEW MEXICO 87501

Form C-102
Revised 10-1-78

All distances must be from the outer boundaries of the Section.

| | | | | |
|--|---------------------------------------|--|----------------------|-----------------------------------|
| Operator Meridian Oil Inc. | | Lease Stanolind Gas Com(B-10938-38) | | Well No. 300 |
| Unit Letter P | Section 16 | Township 30 North | Range 8 West | County San Juan |
| Actual Footage Location of Well: 350 feet from the South line and 530 feet from the East line | | | | |
| Ground Level Elev. 6429' | Producing Formation Fruitland Coal | | Pool <i>Basin</i> | Dedicated Acreage: E 320 Acres |

1. Outline the acreage dedicated to the subject well by colored pencil or hachure marks on the plat below.
2. If more than one lease is dedicated to the well, outline each and identify the ownership thereof (both as to working interest and royalty).
3. If more than one lease of different ownership is dedicated to the well, have the interests of all owners been consolidated by communitization, unitization, force-pooling, etc?

☒ Yes ☐ No If answer is "yes," type of consolidation communitization

If answer is "no," list the owners and tract descriptions which have actually been consolidated. (Use reverse side of this form if necessary.)

No allowable will be assigned to the well until all interests have been consolidated (by communitization, unitization, forced-pooling, or otherwise) or until a non-standard unit, eliminating such interests, has been approved by the Division.

* NOTE: Non-standard location due to terrain.

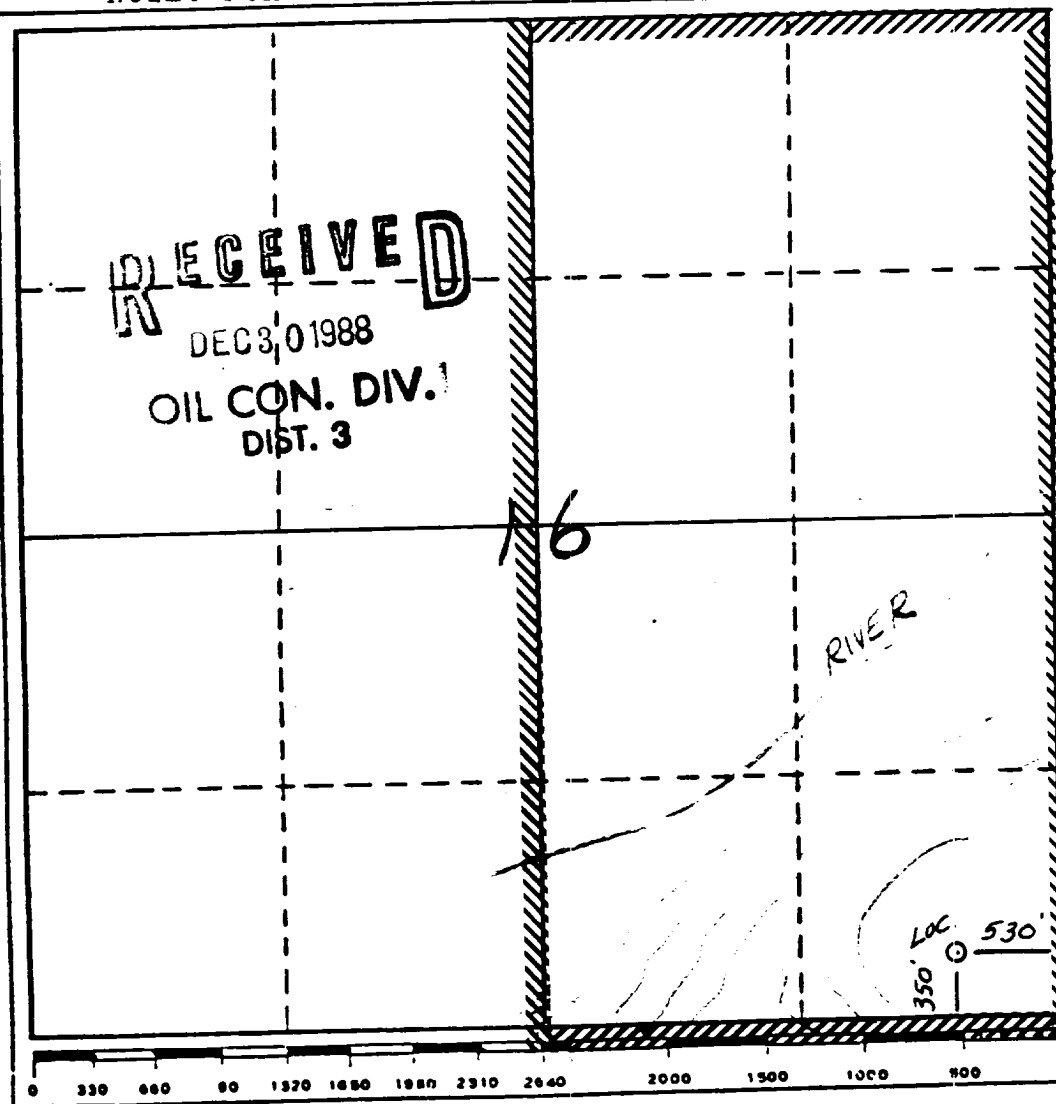

CERTIFICATION

I hereby certify that the information contained herein is true and complete to the best of my knowledge and belief.

J. Bradford

Name: Regulatory Affairs

Position: Meridian Oil Inc.

Company: 12-22-88

Date:

I hereby certify that the location shown on this plat was plotted from field notes of actual surveys made by me or under my supervision, and that the same is true and correct to the best of my knowledge and belief.

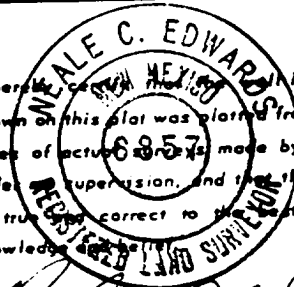

Date Surveyed: 8-11-88

Registered Professional Engineer and/or Land Surveyor:

Neale C. Edwards

Certificate No. 6857