

NO. OF COPIES RECEIVED		
DISTRIBUTION		
SANTA FE		
FILE		
U.S.G.S.		
LAND OFFICE		
OPERATOR		

NEW MEXICO OIL CONSERVATION COMMISSION

Form C-101
Revised 1-4-85

5A. Indicate Type of Lease	
STATE <input checked="" type="checkbox"/>	FEE <input type="checkbox"/>
5. State Oil & Gas Lease No.	
B-10038-34	

APPLICATION FOR PERMIT TO DRILL, DEEPEN, OR PLUG BACK

1a. Type of Work				7. Unit Agreement Name	
b. Type of Well DRILL <input checked="" type="checkbox"/> DEEPEN <input type="checkbox"/> PLUG BACK <input type="checkbox"/>				8. Farm or Lease Name	
OIL WELL <input type="checkbox"/> GAS WELL <input checked="" type="checkbox"/> OTHER <input type="checkbox"/> SINGLE ZONE <input checked="" type="checkbox"/> MULTIPLE ZONE <input type="checkbox"/>				Delhi Com	
2. Name of Operator				9. Well No.	
Meridian Oil Inc.				300	
3. Address of Operator				10. Field and Pool, or Wildcat	
PO Box 4289, Farmington, NM 87499				Undes. Fruitland Coal	
4. Location of Well UNIT LETTER <u>D</u> LOCATED <u>790</u> FEET FROM THE <u>North</u> LINE				12. County	
AND <u>1165</u> FEET FROM THE <u>West</u> LINE OF SEC. <u>16</u> TWP. <u>30N</u> RGE. <u>8W</u> NMPM				San Juan	
19. Proposed Depth		19A. Formation		20. Rotary or C.T.	
2637		Fruitland		Rotary	
21. Elevations (Show whether DF, RT, etc.)		21A. Kind & Status Plug. Bond		22. Approx. Date Work will start	
5835' GL		statewide			

PROPOSED CASING AND CEMENT PROGRAM

SIZE OF HOLE	SIZE OF CASING	WEIGHT PER FOOT	SETTING DEPTH	SACKS OF CEMENT	EST. TOP
12 1/4"	9 5/8"	32.3#	200'	130 cu.ft.	circ. surface
3 3/4"	7"	20.0#	2425	293 cu.ft.	cover Old Alamogordo
6 1/4"	5 1/2"	23.0#	2637'	do not cement	

The Fruitland Coal formation will be completed.

A 3000 psi WP and 6000 psi test double gate preventer equipped with blind and pipe rams will be used for blow out prevention on this well.

This gas is dedicated.

The NW/4 of Section 16 is dedicated to this well.

RECEIVED
SEP 13 1988
OIL CON. DIV.
DIST. 1

IN ABOVE SPACE DESCRIBE PROPOSED PROGRAM; IF PROPOSAL IS TO DEEPEN OR PLUG BACK, GIVE DATA ON PRESENT PRODUCTIVE ZONE AND PROPOSED NEW PRODUCTIVE ZONE. GIVE BLOWOUT PREVENTER PROGRAM, IF ANY.

I hereby certify that the information above is true and complete to the best of my knowledge and belief.

Signed [Signature] Title Regulatory Affairs Date 9-12-88

(This space for State Use)

APPROVED BY [Signature] TITLE DEPUTY OIL & GAS INSPECTOR, DIST #5 DATE SEP 14 1988

CONDITIONS OF APPROVAL, IF ANY:

All distances must be from the outer boundaries of the Section.

Operator Meridian Oil Company			Lease Delhi COM (B-10938-34)		Well No. 300
Unit Letter D	Section 16	Township T30N	Range R8W	County San Juan County	
Actual Footage Location of Well: 790 feet from the North line and 1165 feet from the West line					
Ground Level Elev. 5835	Producing Formation Fruitland Coal		Pool Undesignated		Dedicated Acreage 160 Acres

1. Outline the acreage dedicated to the subject well by colored pencil or hachure marks on the plat below.
2. If more than one lease is dedicated to the well, outline each and identify the ownership thereof (both as to working interest and royalty).
3. If more than one lease of different ownership is dedicated to the well, have the interests of all owners been consolidated by communitization, unitization, force-pooling, etc?

☒ Yes ☐ No If answer is "yes," type of consolidation communitization

If answer is "no," list the owners and tract descriptions which have actually been consolidated. (Use reverse side of this form if necessary.)

No allowable will be assigned to the well until all interests have been consolidated (by communitization, unitization, forced-pooling, or otherwise) or until a non-standard unit, eliminating such interests, has been approved by the Division.

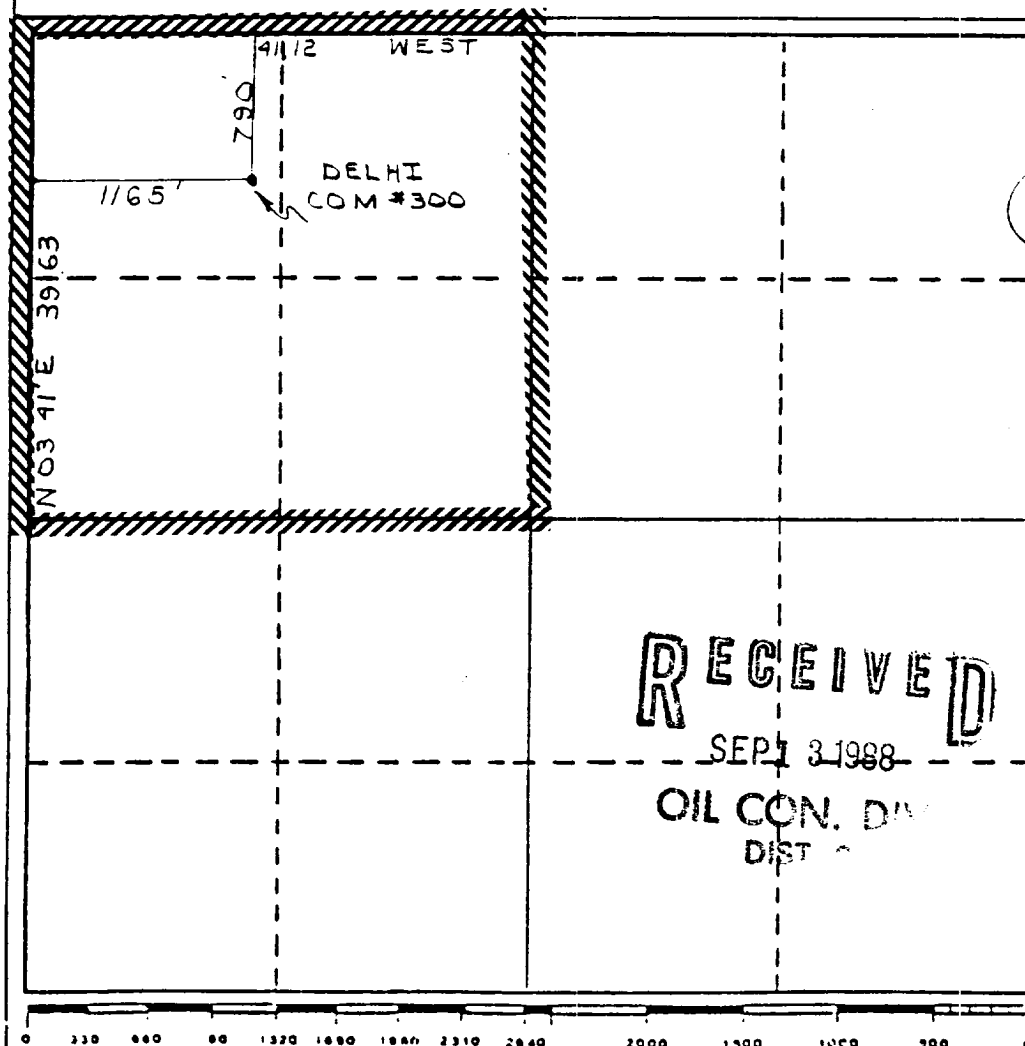

CERTIFICATION

I hereby certify that the information contained herein is true and complete to the best of my knowledge and belief.

R. Howard Daggett
Name

Regulatory Affairs

Position
Meridian Oil Inc.

Company
9-12-88

Date

R. Howard Daggett
I hereby certify that the well location shown on this plat was plotted from field notes of actual surveys made by me or under my supervision, and that the same is true and correct to the best of my knowledge and belief.

Registered Professional
Land Surveyor

Date Surveyed
July 25, 1988

Registered Land Surveyor
R. Howard Daggett

Certificate No.
9679