

UNITED STATES
DEPARTMENT OF THE INTERIOR
GEOLOGICAL SURVEY

APPLICATION FOR PERMIT TO DRILL, DEEPEN, OR PLUG BACK

1a. TYPE OF WORK DRILL <input checked="" type="checkbox"/> DEEPEN <input type="checkbox"/> PLUG BACK <input type="checkbox"/>		5. LEASE DESIGNATION AND SERIAL NO. SF-078596-A	
b. TYPE OF WELL OIL WELL <input type="checkbox"/> GAS WELL <input checked="" type="checkbox"/> OTHER <input type="checkbox"/>		6. INDIAN, ALLOTTEE OR TRIBE NAME	
2. NAME OF OPERATOR Tenneco Oil Company		7. UNIT AGREEMENT NAME	
3. ADDRESS OF OPERATOR P.O. Box 3249, Englewood, CO 80155		8. FARM OR LEASE NAME Florance	
4. LOCATION OF WELL (Report location clearly and in accordance with any State requirements.) At surface NE/4 Sec. 18, 990' FNL, 790' FEL At proposed prod. zone Same		9. WELL NO. 140	
14. DISTANCE IN MILES AND DIRECTION FROM NEAREST TOWN OR POST OFFICE* 1 1/2 miles N of Archuleta		10. FIELD AND POOL, OR WILDCAT Blanco Fruitland	
15. DISTANCE FROM PROPOSED* LOCATION TO NEAREST PROPERTY OR LEASE LINE, FT. (Also to nearest drlg. unit line, if any) 790'		11. SEC., T., R., M., OR BLM. AND SURVEY OR AREA A Sec. 18, T30N, R8W	
16. NO. OF ACRES IN LEASE 1447.31		12. COUNTY OR PARISH San Juan	
17. NO. OF ACRES ASSIGNED TO THIS WELL E/320		13. STATE NM	
18. DISTANCE FROM PROPOSED* LOCATION TO NEAREST WELL, DRILLING, COMPLETED, OR APPLIED FOR, ON THIS LEASE, FT. 600'		19. PROPOSED DEPTH 2490'	
20. ROTARY OR CABLE TOOLS Rotary		21. APPROX. DATE WORK WILL START* 9/1/88	
21. ELEVATIONS (Show whether DF, RT, GR, etc.) 6402' GR		22. APPROX. DATE WORK WILL START* 9/1/88	

PROPOSED CASING AND CEMENTING PROGRAM			
SIZE OF HOLE	SIZE OF CASING	WEIGHT PER FOOT	SETTING DEPTH
12 1/4"	9 5/8"	36#	± 200'
8 3/4"	7"	23#	± 2044'
6 1/2"	5 1/2" - Liner	23#	± 1944-2488

This action is subject to technical and economic review by the Bureau of Land Management and approval of the State Engineer.

See Attached Drilling Procedure.

See Item 1.B in the Surface Use Plan and Map 2 for BLM ROW Application.

IN ABOVE SPACE DESCRIBE PROPOSED PROGRAM: If proposal is to deepen or plug back, give data on present productive zone and proposed new productive zone. If proposal is to drill or deepen directionally, give pertinent data on subsurface locations and measured and true vertical depths. Give blowout preventer program, if any.

24. SIGNED Larry Bell TITLE Administrative Supervisor DATE 8/2/88
(This space for Federal or State office use)

PERMIT NO. _____ APPROVAL DATE _____
APPROVED BY _____ TITLE _____
CONDITIONS OF APPROVAL, IF ANY: _____

APPROVED BY
AS AMENDED
OCT 12 1988
AREA MANAGER

**NEW MEXICO OIL CONSERVATION COMMISSION
WELL LOCATION AND ACREAGE DEDICATION PLAT**

Form C-102
Supersedes C-128
Effective 1-1-65

All distances must be from the outer boundaries of the Section.

Operator TENNECO OIL COMPANY			Lease FLORANCE		Well No. 140
Unit Letter A	Section 18	Township 30 N	Range 8 W	County SAN JUAN	
Actual Footage Location of Well: <div style="display: flex; justify-content: space-between;"> 990 feet from the North line and 790 feet from the East line </div>					
Ground Level Elev. 6402	Producing Formation Fruitland Coal	Pool Blanco Fruitland	Dedicated Acreage: 320 Acres		

1. Outline the acreage dedicated to the subject well by colored pencil or hachure marks on the plat below.
2. If more than one lease is dedicated to the well, outline each and identify the ownership thereof (both as to working interest and royalty).
3. If more than one lease of different ownership is dedicated to the well, have the interests of all owners been consolidated by communitization, unitization, force-pooling, etc?

☐ Yes ☐ No If answer is "yes," type of consolidation _____

If answer is "no," list the owners and tract descriptions which have actually been consolidated. (Use reverse side of this form if necessary.) _____

No allowable will be assigned to the well until all interests have been consolidated (by communitization, unitization, forced-pooling, or otherwise) or until a non-standard unit, eliminating such interests, has been approved by the Commission.

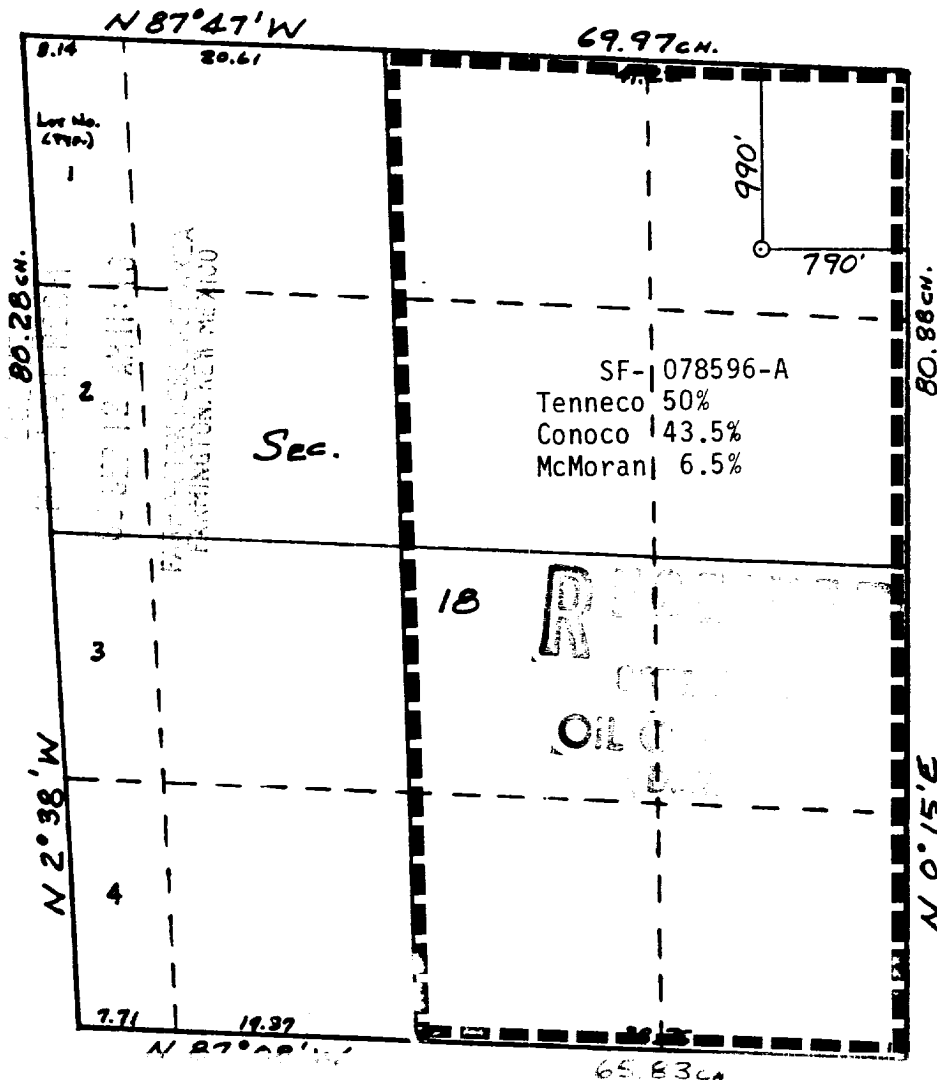

CERTIFICATION

I hereby certify that the information contained herein is true and complete to the best of my knowledge and belief.

Name
Larry Bell *[Signature]*
Position
Admin. Supervisor
Company
Tenneco Oil Company
Date
8/1/88

I hereby certify that the well location shown on this plat was plotted from field notes of actual surveys made by me or under my supervision, and that the same is true and correct to the best of my knowledge and belief.

Date Surveyed
WILLIAM E. MAHNE II
Registered Professional Engineer and
Land Surveyor
#8466
Certificate No. **8466** PROFESSIONAL LAND SURVEYOR

