

UNITED STATES  
DEPARTMENT OF THE INTERIOR  
BUREAU OF LAND MANAGEMENT

APPLICATION FOR PERMIT TO DRILL, DEEPEN, OR PLUG BACK

1a. TYPE OF WORK <b>DRILL</b> <input checked="" type="checkbox"/> <b>DEEPEN</b> <input type="checkbox"/> <b>PLUG BACK</b> <input type="checkbox"/>				1b. TYPE OF WELL OIL WELL <input type="checkbox"/> GAS WELL <input checked="" type="checkbox"/> Coal Seam <input type="checkbox"/> OTHER <input type="checkbox"/>		SINGLE ZONE <input checked="" type="checkbox"/> MULTIPLE ZONE <input type="checkbox"/>	
2. NAME OF OPERATOR Amoco Production Company							
3. ADDRESS OF OPERATOR 2325 East 30th Street, Farmington NM 87401							
4. LOCATION OF WELL (Report location clearly and in accordance with any State requirements.) At surface 1395' FNL x 1490' FEL At proposed prod. zone Same							
14. DISTANCE IN MILES AND DIRECTION FROM NEAREST TOWN OR POST OFFICE* 21 miles northeast of Aztec NM							
10. DISTANCE FROM PROPOSED* LOCATION TO NEAREST PROPERTY OR LEASE LINE, FT. (Also to nearest drig. unit line, if any) 1390'				16. NO. OF ACRES IN LEASE 1,201.16		17. NO. OF ACRES ASSIGNED TO THIS WELL 320-7CE/2	
18. DISTANCE FROM PROPOSED LOCATION* TO NEAREST WELL, DRILLING, COMPLETED, OR APPLIED FOR, ON THIS LEASE, FT. See attached plan 3329'				19. PROPOSED DEPTH		20. ROTARY OR CABLE TOOLS Rotary	
21. ELEVATIONS (Show whether DF, RT, GR, etc.) 6258' GR						22. APPROX. DATE WORK WILL START* As soon as permitted	
23. PROPOSED CASING AND CEMENTING PROGRAM							
SIZE OF HOLE		SIZE OF CASING		WEIGHT PER FOOT		SETTING DEPTH	
12-1/4"		9-5/8"		36# K55		250'	
8-3/4"		7"		20# K55		2859'	
6-1/4"		5-1/2"		23# P110		3069'	
				QUANTITY OF CEMENT			
				200 cf Class B			
				804 cf Class B			

Notice of Staking was submitted 4-6-89.

This well was formerly named Moore 3, 3A (MV) 3A (ET) #8

Lease description:

T30N-R8W, NMPM

Sec. 4: Lots 1,2, S/2 NE/4, SE/4

Sec. 5: Lots 1,2, S/2 NE/4, SE/4

Sec. 8: W/2

Sec. 9: SW/4, W/2 SE/4

There is presently a fruitland well in the SE/4 of Sec 4, T30N, R8W. The Moore #3A will be plugged after completion of this well.

IN ABOVE SPACE DESCRIBE PROPOSED PROGRAM: If proposal is to deepen or plug back, give data on present productive zone and proposed new productive zone. If proposal is to drill or deepen directionally, give pertinent data on subsurface locations and measured and true vertical depths. Give blowout preventer program, if any.

24. SIGNED J. J. Hampton TITLE Admin. Supv. DATE 5/23/89  
(This space for Federal or State office use)

PERMIT NO. \_\_\_\_\_ APPROVAL DATE \_\_\_\_\_  
APPROVED BY \_\_\_\_\_ TITLE \_\_\_\_\_ DATE MAY 30 1989  
CONDITIONS OF APPROVAL, IF ANY: \_\_\_\_\_

APPROVED KH  
AS AMENDED

AREA MANAGER

Hold 6-104 FOR PVR OF MOORE # 3A

\*See Instructions On Reverse Side

Submit to Appropriate  
District Office  
State Lease - 4 copies  
Fee Lease - 3 copies

State of New Mexico  
Energy, Minerals and Natural Resources Department

Form C-102  
Revised 1-1-89

OIL CONSERVATION DIVISION

DISTRICT I  
P.O. Box 1980, Hobbs, NM 88240

P.O. Box 2088  
Santa Fe, New Mexico 87504-2088

DISTRICT II  
P.O. Drawer DD, Artesia, NM 88210

DISTRICT III  
1000 Rio Brazos Rd., Aztec, NM 87410

WELL LOCATION AND ACREAGE DEDICATION PLAT

All Distances must be from the outer boundaries of the section

Operator <b>AMOCO PRODUCTION COMPANY</b>			Lease <b>MOORE 3, 3A (NW) 3A (FT)</b>		Well No. <b># 8</b>
Unit Letter <b>G</b>	Section <b>4</b>	Township <b>30 NORTH</b>	Range <b>8 WEST</b>	County <b>NMPM SAN JUAN</b>	

Actual Footage Location of Well:

1395 feet from the NORTH line and		1490 feet from the EAST line	
Ground level Elev. <b>6258</b>	Producing Formation <b>Fruitland</b>	Pool <b>Basin Fruitland Coal Gas</b>	Dedicated Acreage: <b>320 E/2 320.70 Acres</b>

- Outline the acreage dedicated to the subject well by colored pencil or hatchure marks on the plat below.
- If more than one lease is dedicated to the well, outline each and identify the ownership thereof (both as to working interest and royalty).
- If more than one lease of different ownership is dedicated to the well, have the interest of all owners been consolidated by communization, unitization, force-pooling, etc?  
☐ Yes ☐ No If answer is "yes" type of consolidation \_\_\_\_\_  
If answer is "no" list the owners and tract descriptions which have actually been consolidated. (Use reverse side of this form if necessary.) \_\_\_\_\_  
No allowable will be assigned to the well until all interests have been consolidated (by communization, unitization, forced-pooling, or otherwise) or until a non-standard unit, eliminating such interest, has been approved by the Division.

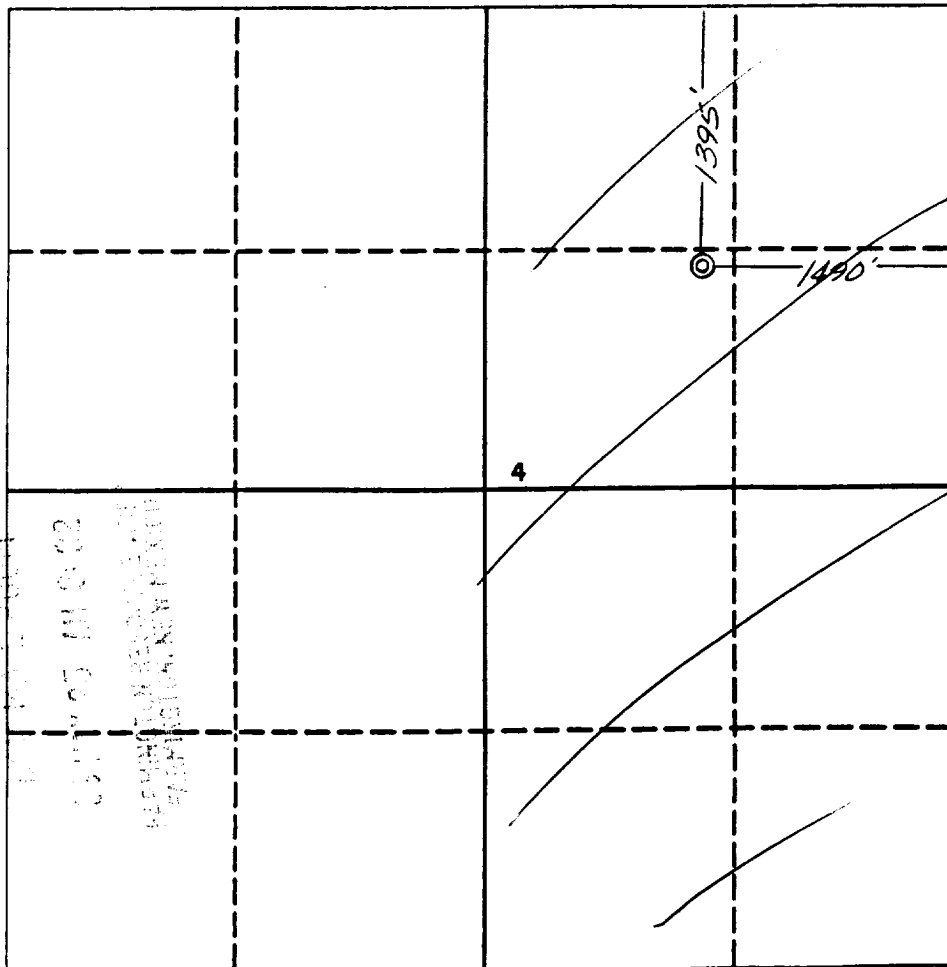

OPERATOR CERTIFICATION

I hereby certify that the information contained herein is true and complete to the best of my knowledge and belief.

Signature <i>C. B. Douglas</i>
Printed Name <b>C. B. Douglas</b>
Position <b>Dist. Admin. Supv.</b>
Company <b>Amoco Production</b>
Date <b>April 6, 1989</b>

SURVEYOR CERTIFICATION

I hereby certify that the well location shown on this plat was plotted from field notes of actual surveys made by me or under my supervision, and that the same is true and correct to the best of my knowledge and belief.

Date Surveyed <b>April 3, 1989</b>
Signature & Seal of Professional Surveyor <i>Gary D. Vann</i>
Gary D. Vann 7016
Certification No. <b>7016</b>

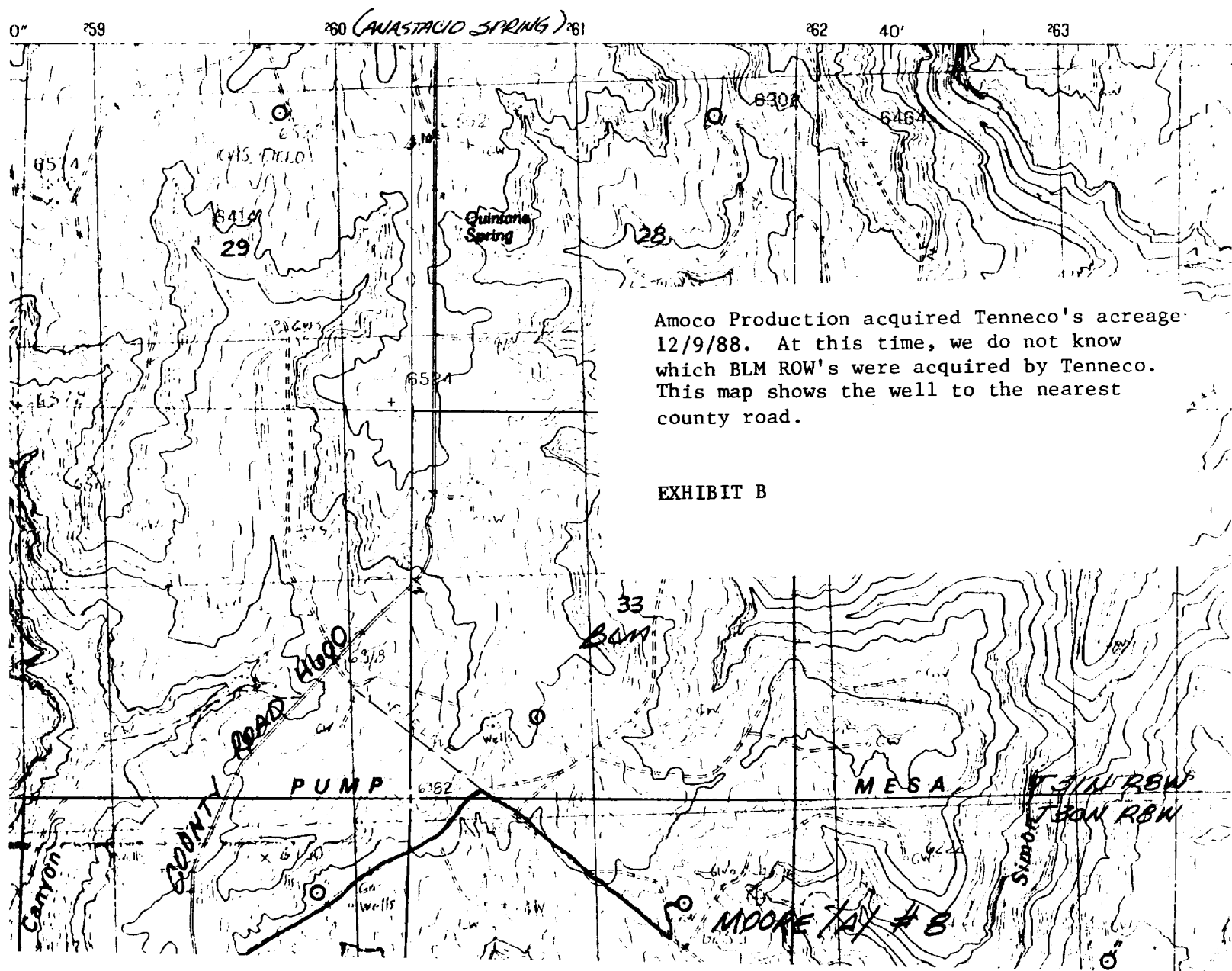

Amoco Production acquired Tenneco's acreage 12/9/88. At this time, we do not know which BLM ROW's were acquired by Tenneco. This map shows the well to the nearest county road.

EXHIBIT B