

UNITED STATES
DEPARTMENT OF THE INTERIOR
BUREAU OF LAND MANAGEMENT

APPLICATION FOR PERMIT TO DRILL, DEEPEN, OR PLUG BACK

1a. TYPE OF WORK DRILL <input checked="" type="checkbox"/> DEEPEN <input type="checkbox"/> PLUG BACK <input type="checkbox"/>				5. LEASE DESIGNATION AND SERIAL NO. SF-078385	
b. TYPE OF WELL OIL WELL <input type="checkbox"/> GAS WELL <input checked="" type="checkbox"/> Coal Seam <input type="checkbox"/> OTHER <input type="checkbox"/>				6. IF INDIAN, ALLOTTED OR TRIBE NAME	
2. NAME OF OPERATOR Amoco Production Company				7. UNIT AGREEMENT NAME	
3. ADDRESS OF OPERATOR 2325 East 30th Street, Farmington NM 87401				8. FARM OR LEASE NAME Florance J	
4. LOCATION OF WELL (Report location clearly and in accordance with any State requirements.) At surface 2200' FNL x 1630' FEL At proposed prod. zone Same				9. WELL NO. 3	
14. DISTANCE IN MILES AND DIRECTION FROM NEAREST TOWN OR POST OFFICE* 29 miles Northeast of Bloomfield NM				10. FIELD AND POOL, OR WILDCAT Basin Fruitland Coal Gas	
15. DISTANCE FROM PROPOSED* LOCATION TO NEAREST PROPERTY OR LEASE LINE, FT. (Also to nearest drlg. unit line, if any) 1630'		16. NO. OF ACRES IN LEASE 1,280.00		17. NO. OF ACRES ASSIGNED TO THIS WELL 320 E/2	
18. DISTANCE FROM PROPOSED LOCATION* TO NEAREST WELL, DRILLING, COMPLETED, OR APPLIED FOR, ON THIS LEASE, FT.		19. PROPOSED DEPTH See attached plan 3290'		20. ROTARY OR CABLE TOOLS Rotary	
21. ELEVATIONS (Show whether DF, RT, GR, etc.) 6384' GR				22. APPROX. DATE WORK WILL START* As soon as permitted	
23. DRILLING OPERATIONS AUTHORIZED ARE SUBJECT TO COMPLIANCE WITH ATTACHED GENERAL REQUIREMENTS					
SIZE OF HOLE	SIZE OF CASING	WEIGHT PER FOOT	SETTING DEPTH	QUANTITY OF CEMENT	
12-1/4"	9-5/8"	36# K55	250'	200 cf Class B	
8-3/4"	7"	20# K55	2843'	800 cf Class B	
6-1/4"	5-1/2"	23# P110	3027'		

Notice of Staking was submitted 4-12-89.

This well was formerly named Florance 48 & 48A (MV) #3.

Lease description:

T30N-R8W, NMPM
Sec. 23: E/2
Sec. 25: W/2
Sec. 34: W/2
Sec. 35: E/2

RECEIVED
JUL 17 1989
N.M. CON. DIV.
DIST. 3

IN ABOVE SPACE DESCRIBE PROPOSED PROGRAM: If proposal is to deepen or plug back, give data on present productive zone and proposed new productive zone. If proposal is to drill or deepen directionally, give pertinent data on subsurface locations and measured and true vertical depths. Give blowout preventer program, if any.

24. SIGNED J. L. Hampton TITLE Admin. Supv. DATE 5/12/89

(This space for Federal or State office use)

PERMIT NO. _____ APPROVAL DATE _____

APPROVED BY _____ TITLE _____ DATE JUL 12 1989

CONDITIONS OF APPROVAL, IF ANY:

Hold c-109 For Simultaneous Redirection in NMOCD
W/ Florance #48A See Instructions On Reverse Side
AREA MANAGER

Submit to Appropriate
District Office
State Lease - 4 copies
Fee Lease - 3 copies

State of New Mexico
Energy, Minerals and Natural Resources Department

Form C-102
Revised 1-1-89

OIL CONSERVATION DIVISION

P.O. Box 2088
Santa Fe, New Mexico 87504-2088

DISTRICT I
P.O. Box 1980, Hobbs, NM 88240

DISTRICT II
P.O. Drawer DD, Artesia, NM 88210

DISTRICT III
1000 Rio Brazos Rd., Aztec, NM 87410

WELL LOCATION AND ACREAGE DEDICATION PLAT

All Distances must be from the outer boundaries of the section

Operator AMOCO PRODUCTION COMPANY		Lease FLORANCE 48 & 48A (M2)		Well No. # 3
Unit Letter G	Section 23	Township 30 NORTH	Range B WEST	County SAN JUAN
Actual Footage Location of Well: 2200 feet from the NORTH line and 1630 feet from the EAST line				
Ground level Elev. 6384	Producing Formation Fruitland	Pool Basin Fruitland Coal Gas		Dedicated Acreage: 320 E/2 Acres

- Outline the acreage dedicated to the subject well by colored pencil or hatchure marks on the plat below.
- If more than one lease is dedicated to the well, outline each and identify the ownership thereof (both as to working interest and royalty).
- If more than one lease of different ownership is dedicated to the well, have the interest of all owners been consolidated by communitization, unitization, force-pooling, etc.?
☐ Yes ☐ No If answer is "yes" type of consolidation _____
If answer is "no" list the owners and tract descriptions which have actually been consolidated. (Use reverse side of this form if necessary.)
No allowable will be assigned to the well until all interests have been consolidated (by communitization, unitization, forced-pooling, or otherwise) or until a non-standard unit, eliminating such interest, has been approved by the Division.

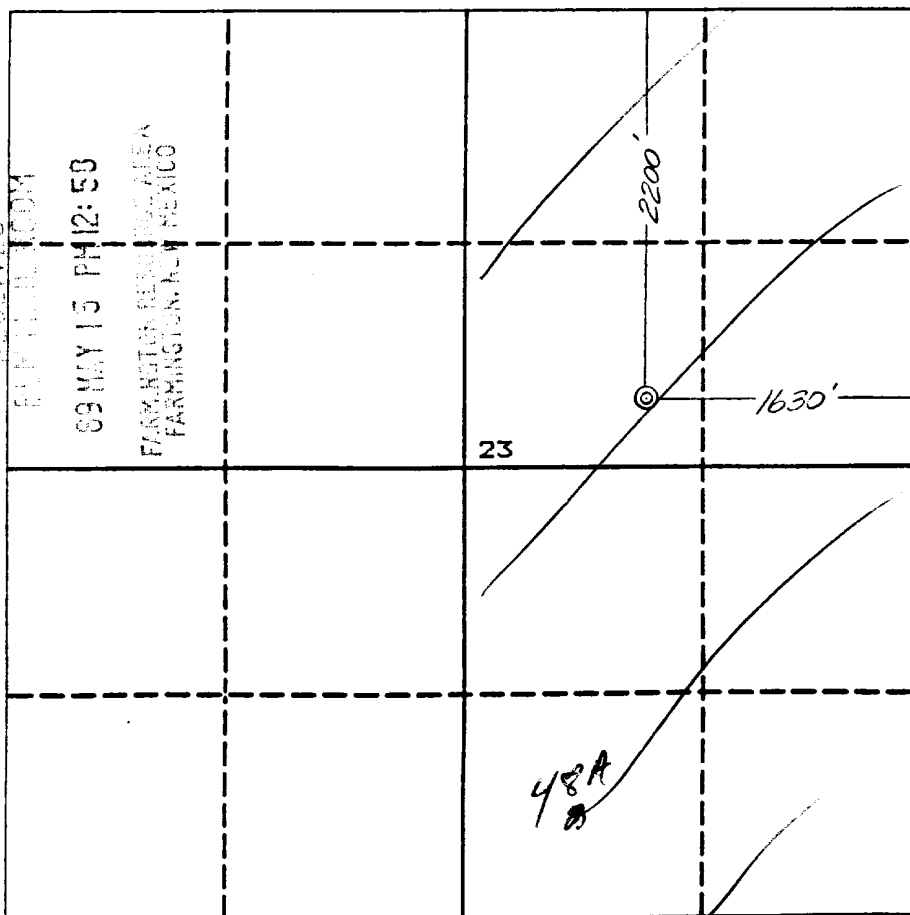

OPERATOR CERTIFICATION

I hereby certify that the information contained herein is true and complete to the best of my knowledge and belief.

Signature
B. D. Shaw

Printed Name
B. D. Shaw

Position
Admin. Supv.

Company
Amoco Production

Date
April 12, 1989

SURVEYOR CERTIFICATION

I hereby certify that the well location shown on this plat was plotted from field notes of actual surveys made by me or under my supervision, and that the same is true and correct to the best of my knowledge and belief.

Date Surveyed
April 6, 1989

Signature & Seal of
Professional Surveyor

GARY D. VANN
NEW MEXICO
REGISTERED PROFESSIONAL LAND SURVEYOR
7016

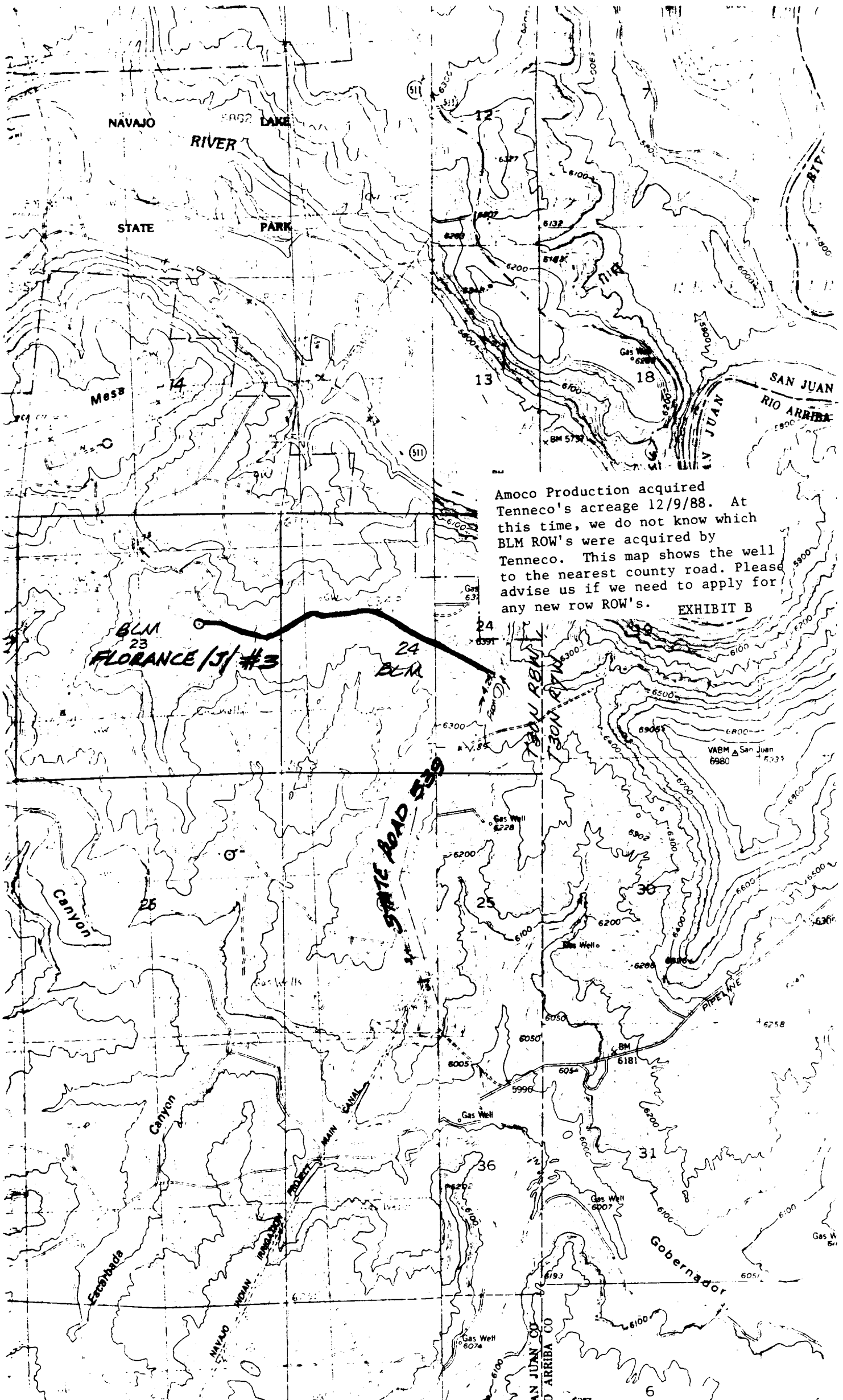

Amoco Production acquired Tenneco's acreage 12/9/88. At this time, we do not know which BLM ROW's were acquired by Tenneco. This map shows the well to the nearest county road. Please advise us if we need to apply for any new row ROW's.

EXHIBIT B

BLM 23
FLORANCE / J / #3

BLM 24

STATE ROAD 539

TEQUILA RIVER

TEQUILA RIVER

SAN JUAN
RIO ARRIBA

Gobernador

SAN JUAN CO
O ARRIBA CO

UNITED STATES
DEPARTMENT OF THE INTERIOR
BUREAU OF LAND MANAGEMENT

SUBMIT IN TRIPLICATE*
(Other instructions on re-
verse side)

Form approved.
Budget Bureau No. 1004-0135
Expires August 31, 1985

SUNDRY NOTICES AND REPORTS ON WELLS

(Do not use this form for proposals to drill or to deepen or plug back to a different reservoir.
Use "APPLICATION FOR PERMIT—" for such proposals.)

5. LEASE DESIGNATION AND SERIAL NO.

SF-078385

6. IF INDIAN, ALLOTTEE OR TRIBE NAME

7. UNIT AGREEMENT NAME

8. FARM OR LEASE NAME

Florance J

9. WELL NO.

3

10. FIELD AND POOL, OR WILDCAT

Basin Fruitland Coal Gas

11. SEC., T., R., M., OR BLK. AND SURVEY OR AREA

Sec. 23, T30N, R8W

12. COUNTY OR PARISH

San Juan New Mexico

13. STATE

1. OIL WELL ☐ GAS WELL ☒ OTHER

2. NAME OF OPERATOR
Amoco Production Company ATTN: J.L. HAMPTON

3. ADDRESS OF OPERATOR
P. O. Box 800 Denver, Colorado 80201

4. LOCATION OF WELL (Report location clearly and in accordance with any State requirements.
See also space 17 below.)
At surface

2200' FNL, 1630' FEL SW/NE

14. PERMIT NO. API
30-045 - 27414

15. ELEVATIONS (Show whether DF, RT, GR, etc.)
6384' GR

16. Check Appropriate Box To Indicate Nature of Notice, Report, or Other Data

TEST WATER SHUT-OFF

FRACTURE TREAT

SHOOT OR ACIDIZE

REPAIR WELL

(Other)

PULL OR ALTER CASING

REPAIR OR COMPLETE

ABANDON*

CHANGE NAME

(Other)

SUBSEQUENT REPORT OF:

WATER SHUT-OFF

FRACTURE TREATMENT

SHOOTING OR ACIDIZING

(Other)

REPAIRING WELL

ALTERING CASING

ABANDONMENT*

(Other)

(NOTE: Report results of multiple completion on Well Completion or Recompletion Report and Log form.)

17. DESCRIBE PROPOSED OR COMPLETED WORK (Clearly state all pertinent details, and give pertinent dates, including estimated date of starting any proposed work. If well is directionally drilled, give subsurface locations and measured and true vertical depths for all markers and zones pertinent to this work.)*

Spud a 12 1/4" surface hole on 7/19/89 at 12:00 hrs. Drilled to 378'.

Set 95/8" 36# K-55 surface casing at 378'. Cemented with 300 5x C18, 2% CaCl2. Circulated 28 BBLs to the surface. Pressure tested casing to 1500 psi. Drilled a 8 3/4" hole to a TD of 3010' on 7/23/89. Set 7" 23# production casing at 3010'. Cemented with 525 5x C1. B Lite, tail w/ 100 5x C1 B w/ 2% CaCl2, 1/4# 5x Floecl. Circulated 43 BBLs good cement to the surface.

Rig Released 7/24/89. Deepened hole to picture cliffs.

Drilled to 3436' T.D.

9/4/89 Ran a 4 1/2" 11.6# K55 Liner from 2769.8' - 3433.2'

Cement with 210 5x Class B. Reverse out 13.5 BBLs.

Rig Released 9/6/89

18. I hereby certify that the foregoing is true and correct

SIGNED J.L. Hampton

TITLE Sr. Staff Admin. Supv.

DATE 12/18/89

(This space for Federal or State office use)

APPROVED BY

TITLE

DATE

CONDITIONS OF APPROVAL, IF ANY:

*See Instructions on Reverse Side

UNITED STATES
DEPARTMENT OF THE INTERIOR
BUREAU OF LAND MANAGEMENT

SUBMIT IN TRIPPLICATE*
(Other instructions on re-
verse side)

Form approved by
Budget Bureau No. 1004-0135
Expires August 31, 1985

SUNDRY NOTICES AND REPORTS ON WELLS

(Do not use this form for proposals to drill or to deepen or plug back to a different reservoir.
Use "APPLICATION FOR PERMIT" for such proposals.)

1. OIL WELL <input type="checkbox"/> GAS WELL <input checked="" type="checkbox"/> OTHER <input type="checkbox"/> Coal Seam	3. LEASE DESIGNATION AND SERIAL NO. SF-078385
2. NAME OF OPERATOR Amoco Production Company Attn: John Hampton	6. IF INDIAN, ALLOTTEE OR TRIBE NAME
3. ADDRESS OF OPERATOR P.O. Box 800, Denver, Colorado 80201	7. UNIT AGREEMENT NAME
4. LOCATION OF WELL (Report location clearly and in accordance with any State requirements. See also space 17 below.) At surface 2200' FNL, 1630' FSL SW/NE	8. FARM OR LEASE NAME Florance J
14. PERMIT NO. <u>API</u> 30-045-27414	9. WELL NO. 3
15. ELEVATIONS (Show whether DF, RT, GR, etc.) 6384' GR	10. FIELD AND POOL, OR WILDCAT Basin Fruitland Coal No
	11. SEC., T., R., M., OR BLK. AND SURVEY OR AREA Sec. 23, T30N-R8W
	12. COUNTY OR PARISH SAN JUAN
	13. STATE New Mexico

16. Check Appropriate Box To Indicate Nature of Notice, Report, or Other Data

TEST WATER SHUT-OFF	FULL OR ALTER CASING	WATER SHUT-OFF	REPAIRING WELL
FRACURE TREAT	MULTIPLE COMPLETE	FRACURE TREATMENT	ALTERING CASING
SHOOT OR ACIDIZE	ABANDON*	SHOOTING OR ACIDIZING	ABANDONMENT*
REPAIR WELL	CHANGE PLANS	(Other) completion info	
(Other)			

17. DESCRIBE PROPOSED OR COMPLETED OPERATIONS (Clearly state all pertinent details, and give pertinent dates, including estimated date of starting any proposed work. If well is to be plugged, give subsurface locations and measured and true vertical depths for all markers and zones pertinent to this work.)

RECEIVED
FEB 05 1990
OIL CON. DIV.
DIST 3

Perforate 10/11/89

3033' - 3040'	w/4JSPF, .42 in. diam., 28 shots, open
3043' - 3045'	12 shots, open
3049' - 3142'	16 shots, open
3056' - 3074'	64 shots, open
3084' - 3094'	40 shots, open
3126' - 3132'	24 shots, open
3152' - 3158'	20 shots, open
3160' - 3165'	24 shots, open
3170' - 3183'	40 shots, open
3184' - 3188'	16 shots, open
3191' - 3196'	20 shots, open

Acidize 10/13/89 with 5040 gal. 15% HCL

Frac down 7" casing with 119112 gal. 30# X-Link gel, 45000 # 40/70 sm, 430000 # 12/20 sm; AIP 1022 psi, AIR 15 BPM.

18. I hereby certify that the foregoing is true and correct

SIGNED JL Hampton/CUB TITLE Sr. Staff Admin. Supr. DATE 12/18/89

(This space for Federal or State office use)

APPROVED BY _____ TITLE _____ DATE _____

CONDITIONS OF APPROVAL, IF ANY: _____

*See Instructions on Reverse Side