

Submit 3 Copies
to Appropriate
District Office

State of New Mexico
Energy, Minerals and Natural Resources Department

Form C-103
Revised 1-1-89

DISTRICT I
P.O. Box 1980, Hobbs, NM 88240

DISTRICT II
P.O. Drawer DD, Artesia, NM 88210

DISTRICT III
1000 Rio Brazos Rd., Aztec, NM 87410

OIL CONSERVATION DIVISION
P.O. Box 2088
Santa Fe, New Mexico 87504-2088

WELL API NO.
5. Indicate Type of Lease STATE <input checked="" type="checkbox"/> FEE <input type="checkbox"/>
6. State Oil & Gas Lease No. E 5382-0
7. Lease Name or Unit Agreement Name FC STATE COM
8. Well No. # 20
9. Pool name or Wildcat Basin Fruitland Coal
10. Elevation (Show whether DF, RKB, RT, GR, etc.) 6403' GR

SUNDRY NOTICES AND REPORTS ON WELLS
(DO NOT USE THIS FORM FOR PROPOSALS TO DRILL OR TO DEEPEN OR PLUG BACK TO A
DIFFERENT RESERVOIR. USE "APPLICATION FOR PERMIT"
(FORM C-101) FOR SUCH PROPOSALS.)

1. Type of Well: OIL WELL <input type="checkbox"/> GAS WELL <input checked="" type="checkbox"/> OTHER	2. Name of Operator MESA OPERATING LIMITED PARTNERSHIP
3. Address of Operator P.O. BOX 2009, AMARILLO, TEXAS 79189	4. Well Location Unit Letter B : 990 Feet From The North Line and 1450 Feet From The East Line Section 2 Township 30N Range 8W NMPM San Juan County
10. Elevation (Show whether DF, RKB, RT, GR, etc.) 6403' GR	

11. Check Appropriate Box to Indicate Nature of Notice, Report, or Other Data	
NOTICE OF INTENTION TO:	SUBSEQUENT REPORT OF:
PERFORM REMEDIAL WORK <input type="checkbox"/>	REMEDIAL WORK <input type="checkbox"/>
TEMPORARILY ABANDON <input type="checkbox"/>	ALTERING CASING <input type="checkbox"/>
PULL OR ALTER CASING <input type="checkbox"/>	COMMENCE DRILLING OPNS. <input type="checkbox"/>
OTHER: <input type="checkbox"/>	PLUG AND ABANDONMENT <input type="checkbox"/>
	CASING TEST AND CEMENT JOB <input type="checkbox"/>
	OTHER: Location Moved <input checked="" type="checkbox"/>

12. Describe Proposed or Completed Operations (Clearly state all pertinent details, and give pertinent dates, including estimated date of starting any proposed work) SEE RULE 1103.

The location on the above referenced well has been moved due to landowner request. An amended Well Location and Acreage Dedication Plat is attached.

RECEIVED
APR 30 1990
OIL CON. DIV.
DIST. 3

xc: NMOCD - (0+5), WF, Reg, Land, Expl., Drilling

I hereby certify that the information above is true and complete to the best of my knowledge and belief.

SIGNATURE Charles L. McKee TITLE Regulatory Analyst DATE 4/27/90

TYPE OR PRINT NAME

TELEPHONE NO.

(This space for State Use)

APPROVED BY Ernie Burch TITLE DEPUTY OIL & GAS INSPECTOR, DIST. #2 DATE MAY 02 1990

CONDITIONS OF APPROVAL, IF ANY:

Submit to Appropriate
District Office
State Leases - 4 copies
Fee Leases - 3 copies

State of New Mexico
Energy, Minerals and Natural Resources Department

Form C-102
Revised 1-1-89

OIL CONSERVATION DIVISION

P.O. Box 2088

Santa Fe, New Mexico 87504-2088

DISTRICT I

P.O. Box 1980, Hobbs, NM 88240

DISTRICT II

P.O. Drawer DD, Artesia, NM 88210

DISTRICT III

1000 Rio Brazos Rd., Aztec, NM 87410

WELL LOCATION AND ACREAGE DEDICATION PLAT

All Distances must be from the outer boundaries of the section

Operator MESA OPERATING LIMITED PARTNERSHIP			Lease FC STATE COM		Well No. 20
Unit Letter B	Section 2	Township 30 N	Range 8 W	County San Juan	
Actual Footage Location of Well: 990 feet from the North line and 1450 feet from the East line					
Ground level Elev. 6403	Producing Formation Fruitland		Pool Basin Fruitland Coal		Dedicated Acreage: N/2 320 Acres

1. Outline the acreage dedicated to the subject well by colored pencil or hatchure marks on the plat below.
2. If more than one lease is dedicated to the well, outline each and identify the ownership thereof (both as to working interest and royalty).
3. If more than one lease of different ownership is dedicated to the well, have the interest of all owners been consolidated by communitization, unitization, force-pooling, etc.?
☒ Yes ☐ No If answer is "yes" type of consolidation Communitization
If answer is "no" list the owners and tract descriptions which have actually been consolidated. (Use reverse side of this form if necessary.)
No allowable will be assigned to the well until all interests have been consolidated (by communitization, unitization, forced-pooling, or otherwise) or until a non-standard unit, eliminating such interest, has been approved by the Division.

0 330 660 990 1320 1650 1980 2310 2640 2000 1500 1000 500 0

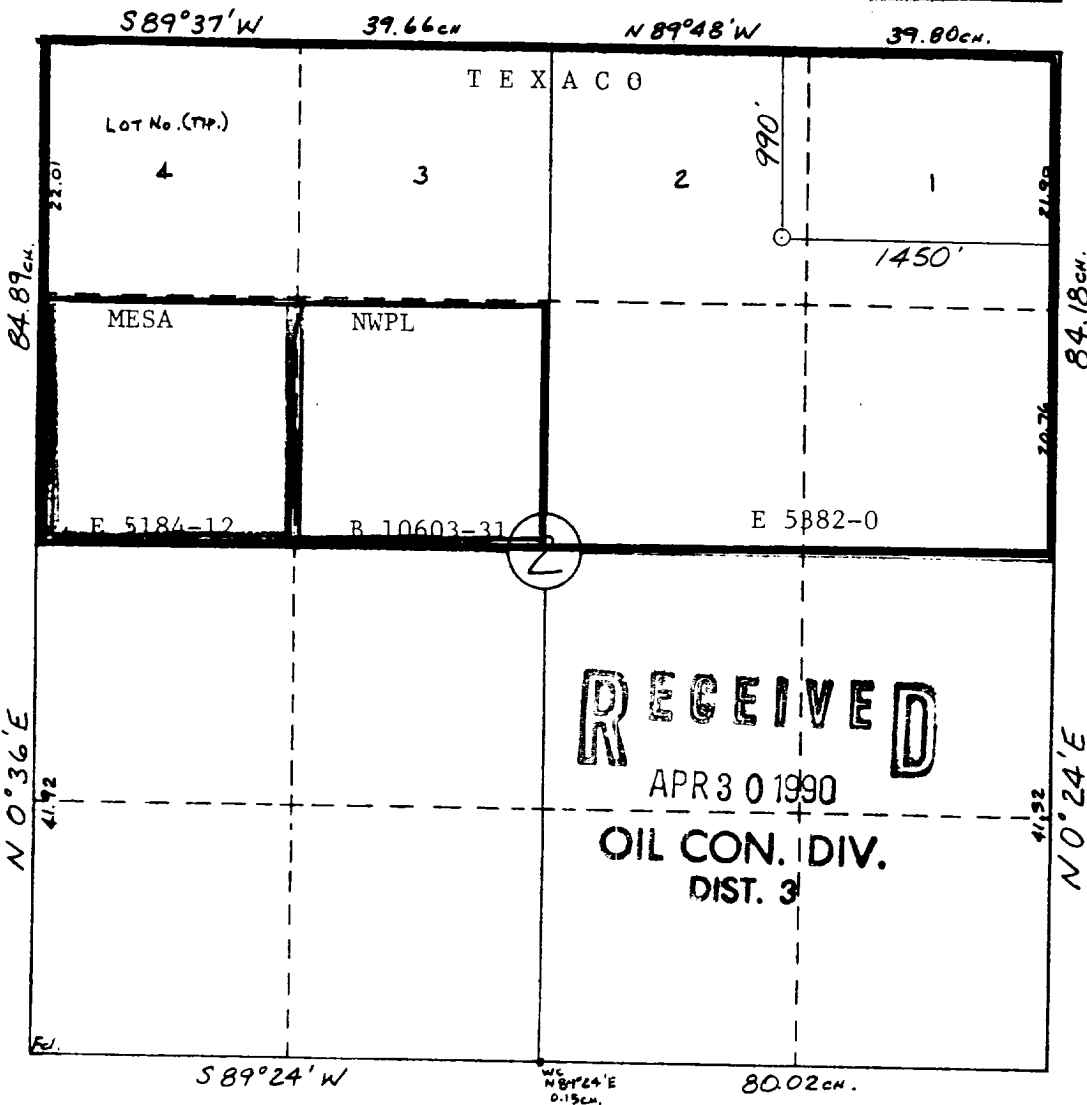

OPERATOR CERTIFICATION

I hereby certify that the information contained herein is true and complete to the best of my knowledge and belief.

Signature
Carol L. McKee

Printed Name
Carol L. McKee

Position
Regulatory Analyst

Company
Mesa Ltd Partnership

Date
4/27/90

SURVEYOR CERTIFICATION

I hereby certify that the well location shown on this plat was plotted from field notes of actual surveys made by me or under my supervision, and that the same is true and correct to the best of my knowledge and belief.

4-23-90

Date Surveyed
William F. Mahnke II

Signature of Professional Surveyor
William F. Mahnke II

Professional Surveyor
NEW MEXICO
#8466
WILLIAM F. MAHNKE II
REGISTERED PROFESSIONAL LAND SURVEYOR