

Submit to Appropriate  
District Office  
State Lease - 6 copies  
Fee Lease - 5 copies

State of New Mexico  
Energy, Minerals and Natural Resources Department

Form C-101  
Revised 1-1-89

OIL CONSERVATION DIVISION

P.O. Box 2088  
Santa Fe, New Mexico 87504-2088

RECEIVED  
JUN 22 1990  
OIL CON. DIV.

DISTRICT I  
P.O. Box 1980, Hobbs, NM 88240

DISTRICT II  
P.O. Drawer DD, Artesia, NM 88210

DISTRICT III  
1000 Rio Brazos Rd., Aztec, NM 87410

API NO. (assigned by OCD on New Wells)

30-045-27911

5. Indicate Type of Lease

STATE ☐ FEE ☒

6. State Oil & Gas Lease No.

7. Lease Name or Unit Agreement Name

FC FEE COM

8. Well No.

# 6

9. Pool name or Wildcat

Basin Fruitland Coal

APPLICATION FOR PERMIT TO DRILL, DEEPEN, OR PLUG BACK

1a. Type of Work:

DRILL ☒ RE-ENTER ☐ DEEPEN ☐ PLUG BACK ☐

b. Type of Well:

OIL WELL ☐ GAS WELL ☒ OTHER ☐

SINGLE ZONE ☐ MULTIPLE ZONE ☐

2. Name of Operator

Mesa Operating Limited Partnership

3. Address of Operator

P.O. Box 2009, Amarillo, Texas 79189

4. Well Location

Unit Letter K : 1800 Feet From The South Line and 1800 Feet From The West Line

Section 9 Township 29N Range 14W NMPM San Juan County

10. Proposed Depth

860'

11. Formation

Fruitland Coal

12. Rotary or C.T.

Rotary

13. Elevations (Show whether DF, RT, GR, etc.)

5314' GR

14. Kind & Status Plug. Bond

Blanket

15. Drilling Contractor

Not Yet Determined

16. Approx. Date Work will start

October 1, 1990

17. PROPOSED CASING AND CEMENT PROGRAM

SIZE OF HOLE	SIZE OF CASING	WEIGHT PER FOOT	SETTING DEPTH	SACKS OF CEMENT	EST. TOP
12 1/4"	8 5/8"	24#	100'	90 sx 'B'/2% CC	Surface
7 7/8"	5 1/2"	17#	860'	100 Poz/100 'B'	Surface
	2 3/8"	4.7#	800'		

Propose to spud well with 12 1/4" hole and drill to 100' and set 8 5/8" surface casing. Will cement with 90 sx (yield = 1.18 Ft<sup>3</sup>, 177 Ft<sup>3</sup>) Class "B" and raise cement to surface. Will nipple up 3000 psi BOP assembly and drill 7 7/8" hole to TD of 860' with fresh water mud system. Will then log well and evaluate for possible commercial production. If successful, will then run 5 1/2" casing to 860' and cement with 100 sx (yield 1.9 Ft<sup>3</sup>/sx, 190 Ft<sup>3</sup>) Pozmix followed by 100 sx (yield = 1.18 Ft<sup>3</sup>/sx, 118 Ft<sup>3</sup>) Class "B" cement. Will move off drilling rig and move in completion unit.

APPROVAL EXPIRES 12-25-90.  
UNLESS DRILLING IS COMMENCED.  
SPUD NOTICE MUST BE SUBMITTED

xc: NMOCD-Aztec (0+5), WF, Reg, Land, Expl., Drilling WITHIN 10 DAYS.

IN ABOVE SPACE DESCRIBE PROPOSED PROGRAM: IF PROPOSAL IS TO DEEPEN OR PLUG BACK, GIVE DATA ON PRESENT PRODUCTIVE ZONE AND PROPOSED NEW PRODUCTIVE ZONE. GIVE BLOWOUT PREVENTER PROGRAM, IF ANY.

I hereby certify that the information above is true and complete to the best of my knowledge and belief.

SIGNATURE

*Carolyn K. McKee*

TITLE

Regulatory Analyst

DATE 6/19/90

TYPE OR PRINT NAME

TELEPHONE NO.

(This space for State Use)

APPROVED BY

*[Signature]*

TITLE

DEPUTY OIL & GAS INSPECTOR, DIST. #3

DATE

JUN 25 1990

CONDITIONS OF APPROVAL, IF ANY:

Submit to Appropriate  
District Office  
State Leases - 4 copies  
Fee Leases - 3 copies

State of New Mexico  
Energy, Minerals and Natural Resources Department

Form C-102  
Revised 1-1-89

OIL CONSERVATION DIVISION

P.O. Box 2088  
Santa Fe, New Mexico 87504-2088

DISTRICT I

P.O. Box 1980, Hobbs, NM 88240

DISTRICT II

P.O. Drawer DD, Artesa, NM 88210

DISTRICT III

1000 Rio Brazos Rd., Aztec, NM 87410

WELL LOCATION AND ACREAGE DEDICATION PLAT

All Distances must be from the outer boundaries of the section

Operator <b>MESA OPERATING LIMITED PARTNERSHIP</b>			Lease <b>FC FEE COM</b>		Well No <b>6</b>
Unit Letter <b>K</b>	Section <b>9</b>	Township <b>29 N</b>	Range <b>14 W</b>	County <b>San Juan</b>	
Actual Footage Location of Well: <b>1800</b> feet from the <b>South</b> line and <b>1800</b> feet from the <b>West</b> line					
Ground level Elev. <b>5314</b>	Producing Formation <b>Fruitland Coal</b>	Pool <b>Basin Fruitland Coal</b>			Dedicated Acreage: <b>S/2 320</b> Acres

1. Outline the acreage dedicated to the subject well by colored pencil or hatchure marks on the plat below.
2. If more than one lease is dedicated to the well, outline each and identify the ownership thereof (both as to working interest and royalty).
3. If more than one lease of different ownership is dedicated to the well, have the interest of all owners been consolidated by communitization, unitization, force-pooling, etc.?  
☒ Yes ☐ No If answer is "yes" type of consolidation Communitization  
If answer is "no" list the owners and tract descriptions which have actually been consolidated. (Use reverse side of this form if necessary.)  
No allowable will be assigned to the well until all interests have been consolidated (by communitization, unitization, forced-pooling, or otherwise) or until a non-standard unit, eliminating such interest, has been approved by the Division.

530 660 990 1320 1650 1980 2310 2640 2000 1500 1000 500 0

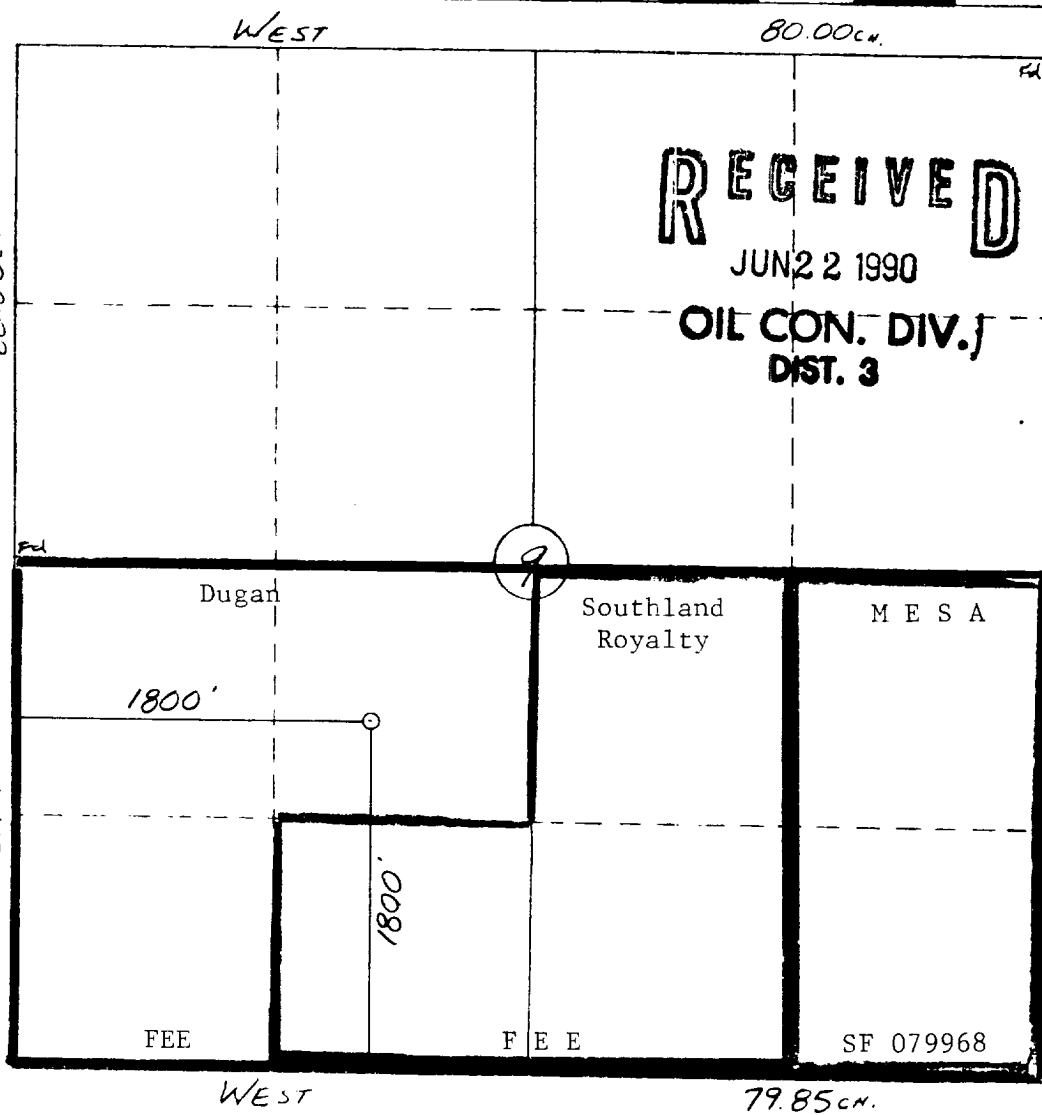

OPERATOR CERTIFICATION

I hereby certify that the information contained herein is true and complete to the best of my knowledge and belief.

Signature *Carolyn L. McKee*

Printed Name  
Carolyn L. McKee

Position  
Regulatory Analyst

Company  
Mesa Ltd Partnership

Date  
6/19/90

SURVEYOR CERTIFICATION

I hereby certify that the well location shown on this plat was plotted from field notes of actual surveys made by me or under my supervision, and that the same is true and correct to the best of my knowledge and belief.

6-8-90

Date Surveyed  
William E. Mahbke II

Signature & Seal of Professional Surveyor  
Professional Surveyor  
#8466  
Certified Professional Land Surveyor