

UNITED STATES
DEPARTMENT OF THE INTERIOR
BUREAU OF LAND MANAGEMENT

APPLICATION FOR PERMIT TO DRILL, DEEPEN, OR PLUG BACK

1a. TYPE OF WORK

DRILL ☒

DEEPEN ☐

PLUG BACK ☐

b. TYPE OF WELL

OIL
WELL ☒

GAS
WELL ☐

OTHER

SINGLE
ZONE ☐

MULTIPLE
ZONE ☐

2. NAME OF OPERATOR

Tiffany Gas Company

3. ADDRESS OF OPERATOR

P.O. Drawer 3307—Farmington, N.M. 87499

4. LOCATION OF WELL (Report location clearly and in accordance with any State requirements.)*
At surface

1675' FSL & 350' FWL
At proposed prod. zone

same

14. DISTANCE IN MILES AND DIRECTION FROM NEAREST TOWN OR POST OFFICE*

7 miles Southeast of Shiprock, N.M.

10. DISTANCE FROM PROPOSED*

LOCATION TO NEAREST
PROPERTY OR LEASE LINE, FT.
(Also to nearest drlg. unit line, if any)

16. NO. OF ACRES IN LEASE

4800

17. NO. OF ACRES ASSIGNED
TO THIS WELL

40 joint

18. DISTANCE FROM PROPOSED LOCATION*
TO NEAREST WELL, DRILLING, COMPLETED,
OR APPLIED FOR, ON THIS LEASE, FT.

19. PROPOSED DEPTH

753'

20. ROTARY OR CABLE TOOLS

Rotary

21. ELEVATIONS (Show whether DF, RT, GR, etc.)

5033' GR This action is subject to technical and

22. APPROX. DATE WORK WILL START*

May 1990

23. procedural review pursuant to 43 CFR 3165.3
and appeal pursuant to 43 CFR 3165.4.
PROPOSED CASING AND CEMENTING PROGRAM

DRILLING OPERATIONS AUTHORIZED ARE
SUBJECT TO COMPLIANCE WITH ATTACHED

SIZE OF HOLE	SIZE OF CASING	WEIGHT PER FOOT	SETTING DEPTH
8 3/4"	7"	23#	45'
6 1/4"	4 1/2"	10.5#	740'

GENERAL REQUIREMENTS:
35sx (41.3CF)
80sx (94.4CF)

Operator plans to set 4 1/2" casing at the top of the Dakota, drill one to two feet into Dakota pay sand, and complete in open hole.

Multiple requirements are attached.

RECEIVED
JUN 29 1990
OIL CON. DIV.
DIST. 3

RECEIVED
JUN 12 1990 11:35
MAIL ROOM

IN ABOVE SPACE DESCRIBE PROPOSED PROGRAM: If proposal is to deepen or plug back, give data on present productive zone and proposed new productive zone. If proposal is to drill or deepen directionally, give pertinent data on subsurface locations and measured and true vertical depths. Give blowout preventer program, if any.

24.

SIGNED Jim Hicks

TITLE Agent, Tiffany Gas Company

DATE 3/9/90

(This space for Federal or State office use)

PERMIT NO. _____

APPROVAL DATE _____

APPROVED
AS AMENDED

APPROVED BY _____

TITLE _____

DATE _____

CONDITIONS OF APPROVAL, IF ANY:

JUN 26 1990

Ken Townsend
FOR AREA MANAGER

NMOCD

*See Instructions On Reverse Side

Submit to Appropriate
District Office
State Lease - 4 copies
Fee Lease - 3 copies

State of New Mexico
Energy, Minerals and Natural Resources Department

Form C-102
Revised 1-1-89

OIL CONSERVATION DIVISION

P.O. Box 2088

Santa Fe, New Mexico 87504-2088

DISTRICT I

P.O. Box 1980, Hobbs, NM 88240

DISTRICT II

P.O. Drawer DD, Artesia, NM 88210

DISTRICT III

1000 Rio Brazos Rd., Aztec, NM 87410

WELL LOCATION AND ACREAGE DEDICATION PLAT

All Distances must be from the outer boundaries of the section

Operator TIFFANY GAS COMPANY			Lease USG SECTION 18		Well No. 56
Unit Letter L	Section 7	Township 29 N	Range 16 W	County San Juan	
Actual Footage Location of Well: 1675 feet from the South line and 350 feet from the West line					
Ground level Elev. 5033	Producing Formation Dakota		Pool Hogback Dakota EXT		Dedicated Acreage: 40 Acres
<p>1. Outline the acreage dedicated to the subject well by colored pencil or hatchure marks on the plat below.</p> <p>2. If more than one lease is dedicated to the well, outline each and identify the ownership thereof (both as to working interest and royalty).</p> <p>3. If more than one lease of different ownership is dedicated to the well, have the interest of all owners been consolidated by communitization, unitization, force-pooling, etc.? <input type="checkbox"/> Yes <input type="checkbox"/> No If answer is "yes" type of consolidation _____ If answer is "no" list the owners and tract descriptions which have actually been consolidated. (Use reverse side of this form if necessary.) _____ No allowable will be assigned to the well until all interests have been consolidated (by communitization, unitization, forced-pooling, or otherwise) or until a non-standard unit, eliminating such interest, has been approved by the Division.</p>					

0 330 660 990 1320 1650 1980 2310 2640 2000 1500 1000 500 0

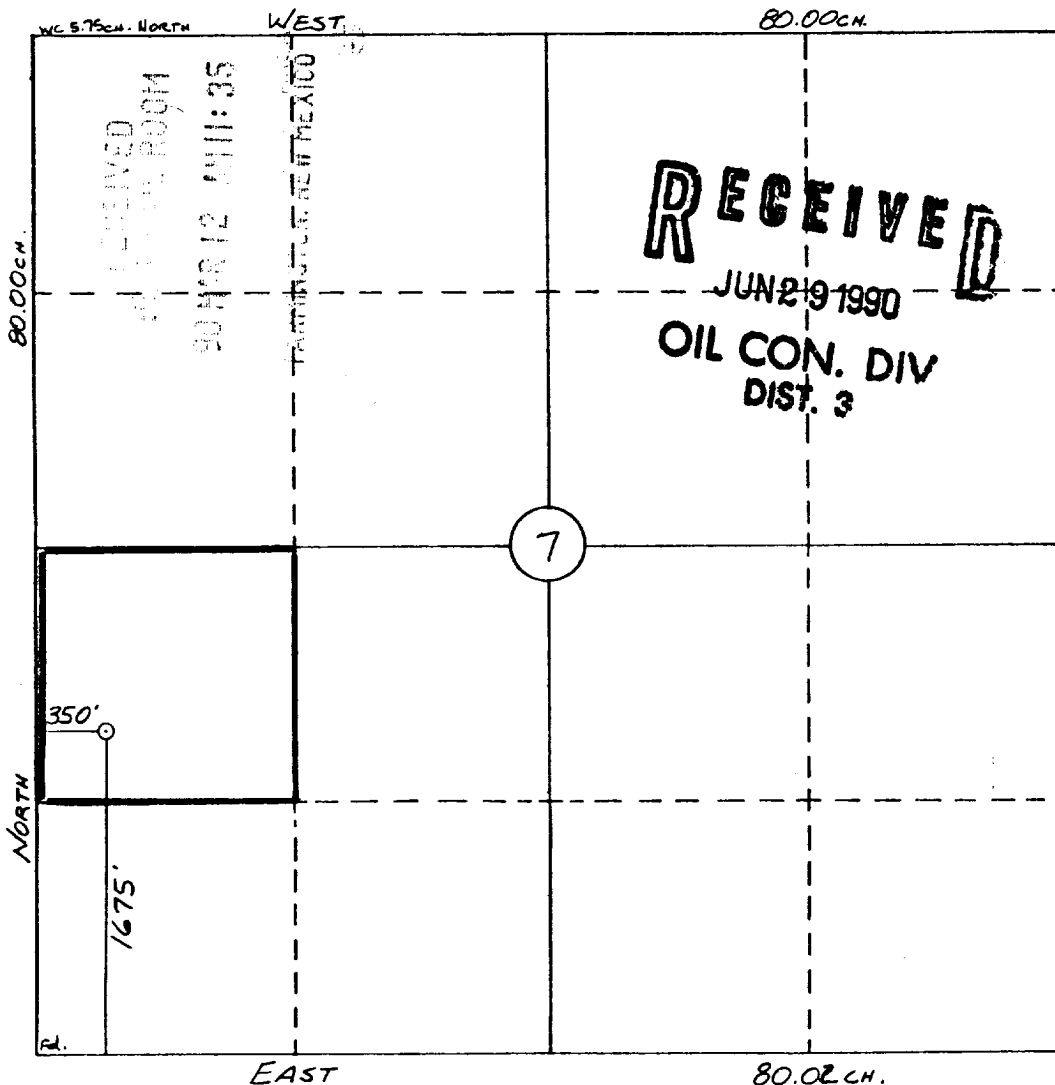

OPERATOR CERTIFICATION

I hereby certify that the information contained herein is true and complete to the best of my knowledge and belief.

Signature

Printed Name

Jim Hicks

Position

Agent

Company

Tiffany Gas Company

Date

3/9/90

SURVEYOR CERTIFICATION

I hereby certify that the well location shown on this plat was plotted from field notes of actual surveys made by me or under my supervision, and that the same is true and correct to the best of my knowledge and belief.

3-5-90

Date Surveyed

William E. Mahke II

Signature & Seal of Professional Surveyor

Certificate No.

8466

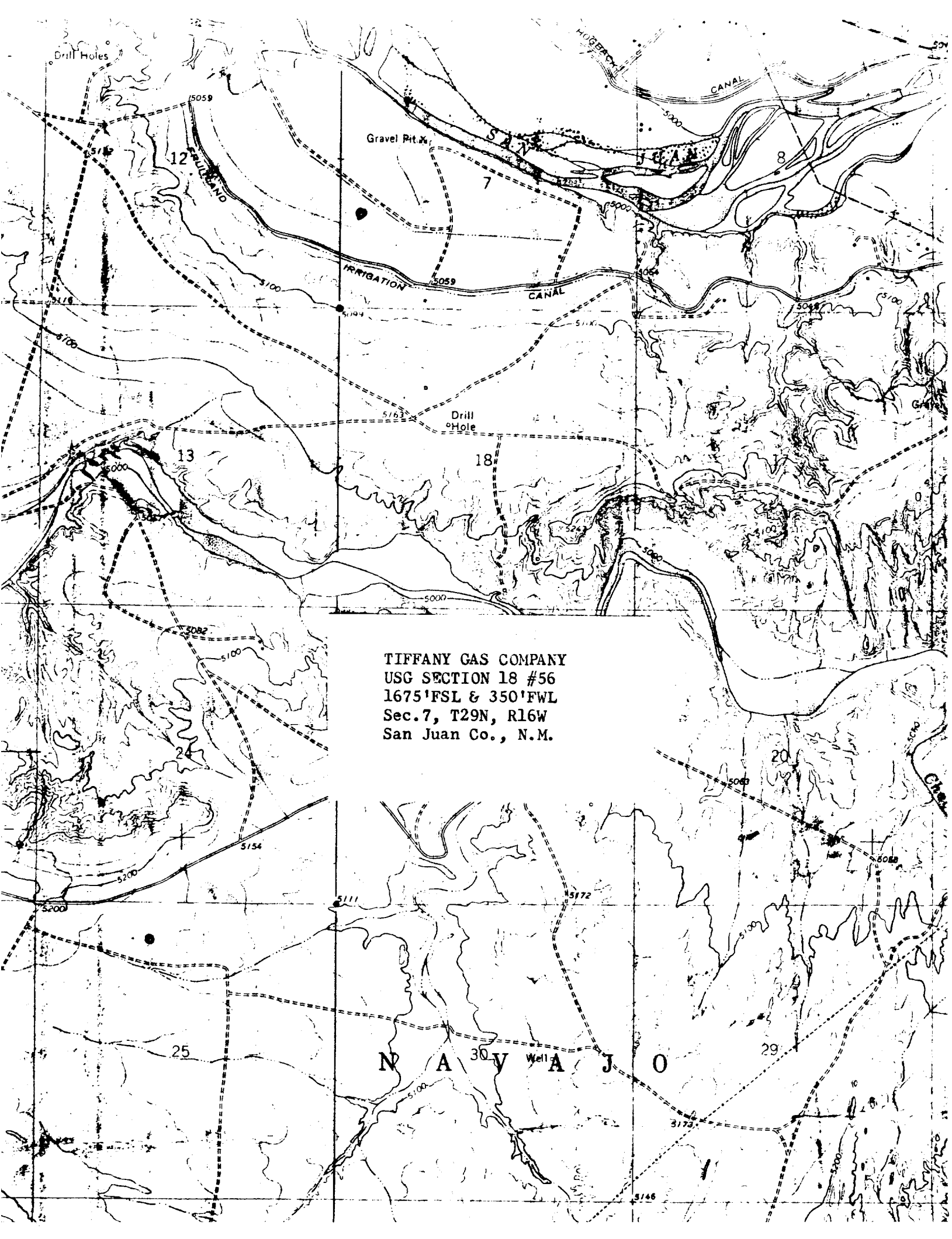

TIFFANY GAS COMPANY
USG SECTION 18 #56
1675' FSL & 350' FWL
Sec. 7, T29N, R16W
San Juan Co., N.M.

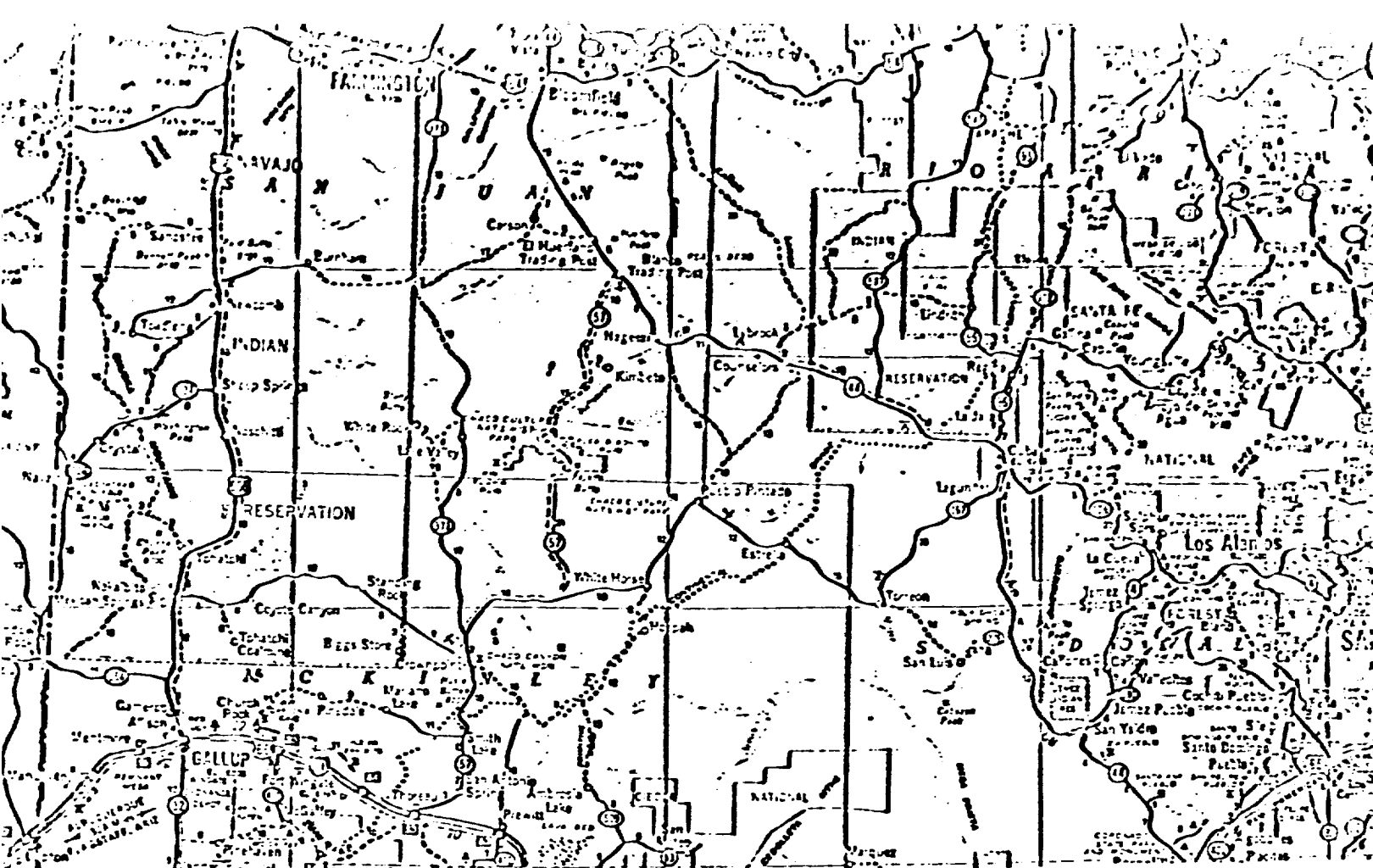

USG SECTION 18 -56

1675' FSL & 350' FWL

Sec. 7, T29N, R16W

MUD POINT: 23 Miles FARMINGTON

CEMENT POINT: 23 Miles FARMINGTON

EXHIBIT A

