

Submit to Appropriate
District Office
State Lease - 6 copies
Fee Lease - 5 copies

State of New Mexico
Energy, Minerals and Natural Resources Department

Form C-101
Revised 1-1-89

OIL CONSERVATION DIVISION

DISTRICT I
P.O. Box 1980, Hobbs, NM 88240

DISTRICT II
P.O. Drawer DD, Artesia, NM 88210

DISTRICT III
1000 Rio Brazos Rd., Aztec, NM 87410

P.O. Box 2088
Santa Fe, New Mexico 87504-2088

API NO. (assigned by OCD on New Wells)
30-045-28173
5. Indicate Type of Lease STATE <input type="checkbox"/> FEE <input checked="" type="checkbox"/>
6. State Oil & Gas Lease No.

APPLICATION FOR PERMIT TO DRILL, DEEPEN, OR PLUG BACK

1a. Type of Work: DRILL <input checked="" type="checkbox"/> RE-ENTER <input type="checkbox"/> DEEPEN <input type="checkbox"/> PLUG BACK <input type="checkbox"/>		7. Lease Name or Unit Agreement Name FC FEE COM
b. Type of Well: OIL WELL <input type="checkbox"/> GAS WELL <input checked="" type="checkbox"/> OTHER <input type="checkbox"/> SINGLE ZONE <input checked="" type="checkbox"/> MULTIPLE ZONE <input type="checkbox"/>		
2. Name of Operator MESA OPERATING LIMITED PARTNERSHIP		8. Well No. # 5 N/319.46
3. Address of Operator P.O. BOX 2009, AMARILLO, TEXAS 79189		9. Pool name or Wildcat BASIN FRUITLAND COAL
4. Well Location Unit Letter A : 1105 Feet From The North Line and 975 Feet From The East Line Section 1 Township 29N Range 13W NMPM SAN JUAN County		

10. Proposed Depth 1590'		11. Formation Fruitland Coal	12. Rotary or C.T. Rotary
13. Elevations (Show whether DF, RT, GR, etc.) 5450' GR	14. Kind & Status Plug. Bond BLANKET	15. Drilling Contractor NOT YET DETERMINED	16. Approx. Date Work will start

17. PROPOSED CASING AND CEMENT PROGRAM					
SIZE OF HOLE	SIZE OF CASING	WEIGHT PER FOOT	SETTING DEPTH	SACKS OF CEMENT	EST. TOP
12 1/4"	8 5/8"	24#	200'	150 sx 'B'+2%CC	SURFACE
7 7/8"	5 1/2"	15.5#	1590'	175 Poz/150 'B'	SURFACE
	2 3/8"	4.7#	1540'		

Propose to spud well with 12 1/4" hole and drill to 200' and set 8 5/8" surface casing. Will cement with 150 sx (yield = 1.18 Ft³, 177 Ft³) of Class "B" and raise cement to surface. Will nipple up 3000 psi BOP assembly and drill 7 7/8" hole to TD of 1590' with fresh water mud system. Will then log well and evaluate for possible commercial production. If successful, will then run 5 1/2" casing to 1590' and cement with 175sx Pozmix (yield - 1.8 Ft³, 315Ft³) followed by 150 sx Class "B" cement (yield - 1.18 Ft³, 177Ft³). Will move off drilling rig and move in completion unit.

RECEIVED
AUG 23 1990

xc: NMOCD-A (0+6) WF, Reg, Land, Expl., Drilling
IN ABOVE SPACE DESCRIBE PROPOSED PROGRAM: IF PROPOSAL IS TO DEEPEN OR PLUG BACK, GIVE DATA ON PRESENT PRODUCTION ZONE AND PROPOSED NEW PRODUCTIVE ZONE. GIVE BLOWOUT PREVENTER PROGRAM, IF ANY.

I hereby certify that the information above is true and complete to the best of my knowledge and belief.

SIGNATURE Carolyn L. McKee TITLE Sr. Regulatory Analyst DATE 8/20/90
TYPE OR PRINT NAME Carolyn L. McKee TELEPHONE NO. (806) 378-1000

(This space for State Use)

APPROVED BY Ernie Burch TITLE DEPUTY OIL & GAS INSPECTOR, DIST. #3 DATE AUG 24 1990

CONDITIONS OF APPROVAL, IF ANY:

APPROVAL EXPIRES 2-24-91
UNLESS DRILLING IS COMMENCED.
SPUD NOTICE MUST BE SUBMITTED
WITHIN 10 DAYS

Submit to Appropriate
District Office
State Lease - 4 copies
Fee Lease - 3 copies

State of New Mexico
Energy, Minerals and Natural Resources Department

Form C-102
Revised F-1-89

OIL CONSERVATION DIVISION

P.O. Box 2088
Santa Fe, New Mexico 87504-2088

DISTRICT I
P.O. Box 1980, Hobbs, NM 88240

DISTRICT II
P.O. Drawer DD, Artesia, NM 88210

DISTRICT III
1000 Rio Brazos Rd., Aztec, NM 87410

WELL LOCATION AND ACREAGE DEDICATION PLAT

All Distances must be from the outer boundaries of the section

Operator MESA OPERATING LIMITED PARTNERSHIP			Lease FC FEE COM		Well No. 5
Unit Letter A	Section 1	Township 29 N	Range 13 W	County San Juan	
Actual Footage Location of Well: 1105 feet from the North line and 975 feet from the East line					
Ground level Elev. 5450	Producing Formation Fruitland Coal	Pool Basin Fruitland Coal		Dedicated Acreage: N/2 320 319.40 Acres	

1. Outline the acreage dedicated to the subject well by colored pencil or hachure marks on the plat below.

2. If more than one lease is dedicated to the well, outline each and identify the ownership thereof (both as to working interest and royalty).

3. If more than one lease of different ownership is dedicated to the well, have the interest of all owners been consolidated by communitization, unitization, force-pooling, etc.?

☒ Yes

☐ No

If answer is "yes" type of consolidation Communitization

If answer is "no" list the owners and tract descriptions which have actually been consolidated. (Use reverse side of this form if necessary.)

No allowable will be assigned to the well until all interests have been consolidated (by communitization, unitization, forced-pooling, or otherwise) or until a non-standard unit, eliminating such interest, has been approved by the Division.

330 660 990 1320 1650 1980 2310 2640 2970 3300 3630 3960 4290 4620 4950 5280 5610 5940 6270 6600 6930 7260 7590 7920 8250 8580 8910 9240 9570 9900 0

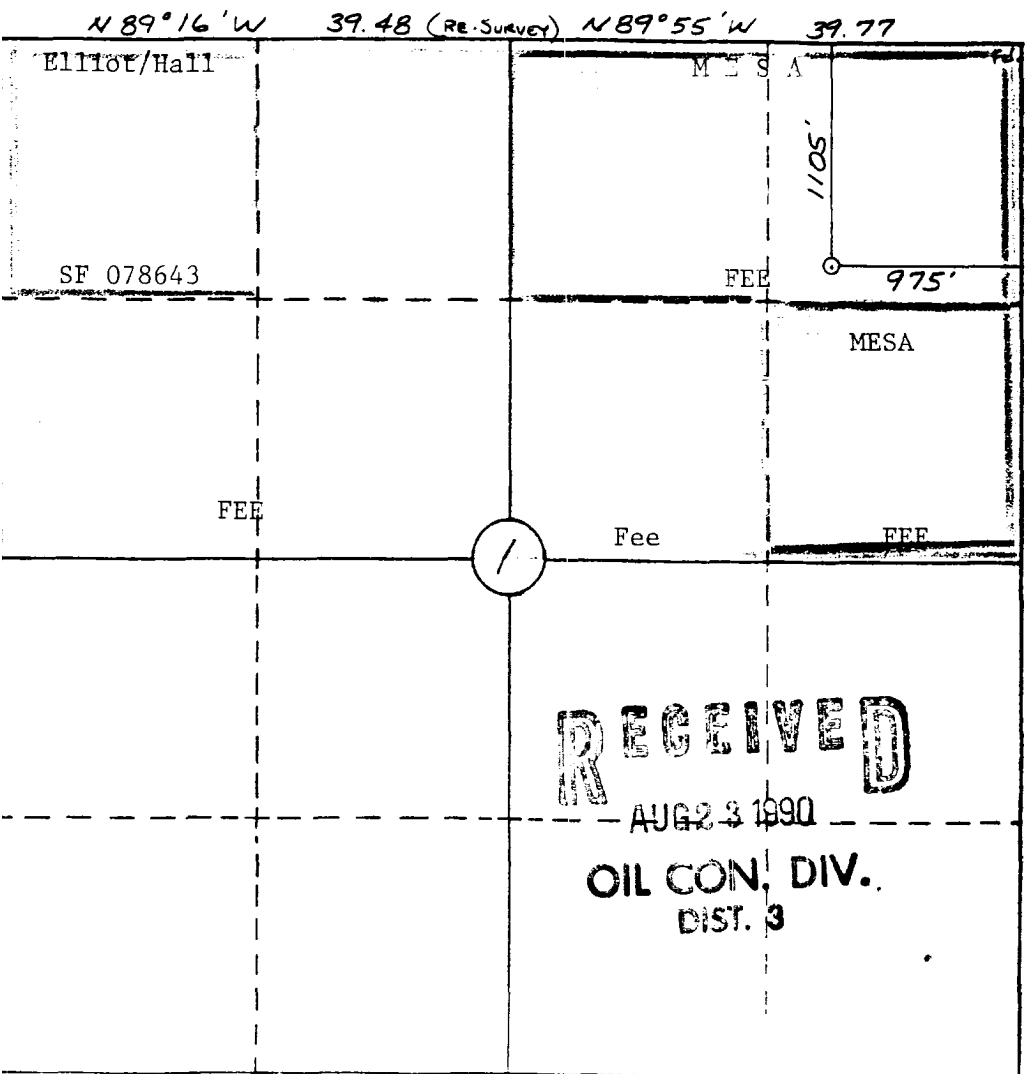

OPERATOR CERTIFICATION

I hereby certify that the information contained herein is true and complete to the best of my knowledge and belief.

Signature

Printed Name

Carolyn L. McKee

Position

Sr. Regulatory Analyst

Company

Mesa Ltd Partnership

Date

8/20/90

SURVEYOR CERTIFICATION

I hereby certify that the well location shown on this plat was plotted from field notes of actual surveys made by me or under my supervision, and that the same is true and correct to the best of my knowledge and belief.

6-25-90

Date Surveyed

William E. Mahnke II

Signature & Seal of
Professional Surveyor

#8456

Certificate No.

8486