

Submit to Appropriate
District Office
State Lease - 6 copies
Fee Lease - 5 copies

State of New Mexico
Energy, Minerals and Natural Resources Department

Form C-101
Revised 1-1-89

DISTRICT I
P.O. Box 1980, Hobbs, NM 88240

DISTRICT II
P.O. Drawer DD, Artesia, NM 88210

DISTRICT III
1000 Rio Brazos Rd., Aztec, NM 87410

OIL CONSERVATION DIVISION

P.O. Box 2088
Santa Fe, New Mexico 87504-2088

OIL CON. DIV.
DIST. 3

API NO. (assigned by OCD on New Wells)

5. Indicate Type of Lease

STATE ☒ FEE ☐

6. State Oil & Gas Lease No.
E 6348

7. Lease Name or Unit Agreement Name

FC STATE COM

8. Well No. # 22

9. Pool name or Wildcat
BASIN FRUITLAND COAL

APPLICATION FOR PERMIT TO DRILL, DEEPEN, OR PLUG BACK

1a. Type of Work:

DRILL ☒ RE-ENTER ☐ DEEPEN ☐ PLUG BACK ☐

b. Type of Well:

OIL WELL ☐ GAS WELL ☒ OTHER ☐
SINGLE ZONE ☒ MULTIPLE ZONE ☐

2. Name of Operator
MESA OPERATING LIMITED PARTNERSHIP

3. Address of Operator
P.O. BOX 2009, AMARILLO, TEXAS 79189

4. Well Location
Unit Letter G : 2110 Feet From The North Line and 1355 Feet From The East Line

Section 36 Township 29N Range 10W NMPM SAN JUAN County

10. Proposed Depth
2110'

11. Formation
Fruitland Coal

12. Rotary or C.T.
Rotary

13. Elevations (Show whether DF, RT, GR, etc.)
5659' GR

14. Kind & Status Plug. Bond
BLANKET

15. Drilling Contractor
NOT YET DETERMINED

16. Approx. Date Work will start

17.

PROPOSED CASING AND CEMENT PROGRAM

SIZE OF HOLE	SIZE OF CASING	WEIGHT PER FOOT	SETTING DEPTH	SACKS OF CEMENT	EST. TOP
12 1/4"	8 5/8"	24#	200'	150 sx 'B' 7/2%CC	SURFACE
7 7/8"	5 1/2"	15.5#	2110'	250 Poz/150 'B'	SURFACE
	2 3/8"	4.7#	2060'		

Propose to spud well with 12 1/4" hole and drill to 200' and set 8 5/8" surface casing. Will cement with 150 sx (yield = 1.18 Ft³, 177 Ft³) of Class "B" and raise cement to surface. Will nipple up 3000 psi BOP assembly and drill 7 7/8" hole to TD of 2110' with fresh water mud system. Will then log well and evaluate for possible commercial production. If successful, will then run 5 1/2" casing to 2110' and cement with 250sx Pozmix (yield - 1.8 Ft³, 450 Ft³) followed by 150 sx Class "B" cement (yield - 1.18 Ft³, 177 Ft³). Will move off drilling rig and move in completion unit.

APPROVAL EXPIRES 2-24-91
UNLESS DRILLING IS COMMENCED.
SPUD NOTICE MUST BE SUBMITTED
WITHIN 10 DAYS.

IN ABOVE SPACE DESCRIBE PROPOSED PROGRAM: xc: NMOCD-A (0+6) WF, Reg, Land, Expl., Drilling
IF PROPOSAL IS TO DEEPEN OR PLUG BACK, GIVE DATA ON PRESENT PRODUCTIVE ZONE AND PROPOSED NEW PRODUCTIVE ZONE. GIVE BLOWOUT PREVENTER PROGRAM, IF ANY.

I hereby certify that the information above is true and complete to the best of my knowledge and belief.

SIGNATURE Carolyn L. McKee TITLE Sr. Regulatory Analyst DATE 8/20/90

TYPE OR PRINT NAME Carolyn L. McKee TELEPHONE NO. (806) 378-1000

(This space for State Use)

APPROVED BY [Signature] DEPUTY OIL & GAS INSPECTOR, DIST. #3 DATE AUG 24 1990

CONDITIONS OF APPROVAL, IF ANY:

Submit to Appropriate
District Office
State Lease - 4 copies
Fee Lease - 3 copies

State of New Mexico
Energy, Minerals and Natural Resources Department

Form C-102
Revised 1-1-89

OIL CONSERVATION DIVISION

P.O. Box 2088

Santa Fe, New Mexico 87504-2088

DISTRICT I

P.O. Box 1980, Hobbs, NM 88240

DISTRICT II

P.O. Drawer DD, Artesia, NM 88210

DISTRICT III

1000 Rio Brazos Rd., Aztec, NM 87410

WELL LOCATION AND ACREAGE DEDICATION PLAT

All Distances must be from the outer boundaries of the section

Operator MESA OPERATING LIMITED PARTNERSHIP			Lease FC STATE COM		Well No. 22
Unit Letter G	Section 36	Township 29 N	Range 10 W	County San Juan	
Actual Footage Location of Well: 2110 feet from the North line and 1355 feet from the East line					
Ground level Elev. 5659	Producing Formation Fruitland Coal		Pool Basin Fruitland Coal	Dedicated Acreage: E/2 320 Acres	

1. Outline the acreage dedicated to the subject well by colored pencil or hatchure marks on the plat below.

2. If more than one lease is dedicated to the well, outline each and identify the ownership thereof (both as to working interest and royalty).

3. If more than one lease of different ownership is dedicated to the well, have the interest of all owners been consolidated by communitization, unitization, force-pooling, etc.?



☐ No

If answer is "yes" type of consolidation Communitization

If answer is "no" list the owners and tract descriptions which have actually been consolidated. (Use reverse side of this form if necessary.)

No allowable will be assigned to the well until all interests have been consolidated (by communitization, unitization, forced-pooling, or otherwise) or until a non-standard unit, eliminating such interest, has been approved by the Division.

0 330 660 990 1320 1650 1980 2310 2640 2000 1500 1000 500 0

(WEST)

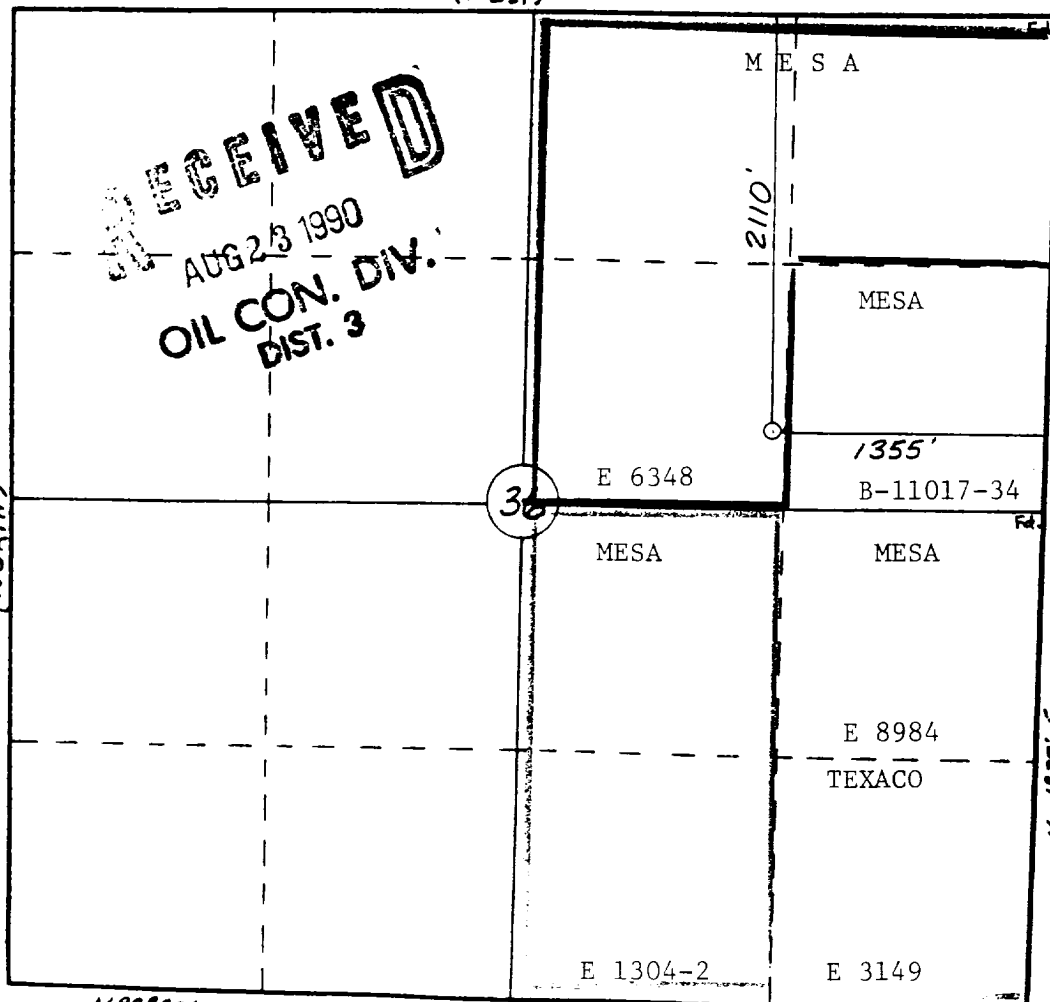

OPERATOR CERTIFICATION

I hereby certify that the information contained herein is true and complete to the best of my knowledge and belief.

Signature

Printed Name

Carolyn L. McKee

Position

Sr. Regulatory Analyst

Company

Mesa Limited Partnership

Date

8/20/90

SURVEYOR CERTIFICATION

I hereby certify that the well location shown on this plat was plotted from field notes of actual surveys made by me or under my supervision, and that the same is true and correct to the best of my knowledge and belief.

6-20-90

Date Surveyed

William E. Mahmke II

Signature & Seal of
Professional Surveyor

#8466

Certificate No.

8466