

UNITED STATES
DEPARTMENT OF THE INTERIOR
BUREAU OF LAND MANAGEMENT

SUBMIT IN TRIPPLICATE*
(Other instructions on re-
verse side)

Form approved.
Budget Bureau No. 1004-0135
Expires August 31, 1985

SUNDRY NOTICES AND REPORTS ON WELLS

(Do not use this form for proposals to drill or to deepen or plug back to a different reservoir.
Use "APPLICATION FOR PERMIT—" for such proposals.)

1. OIL WELL <input type="checkbox"/> GAS WELL <input checked="" type="checkbox"/> OTHER <input type="checkbox"/>	7. UNIT AGREEMENT NAME
2. NAME OF OPERATOR	Gallegos Canyon Unit
3. ADDRESS OF OPERATOR	Gallegos Canyon Unit
5847 San Felipe Suite 3600 Houston, Texas 77057	WELL NO.
4. LOCATION OF WELL (Report location clearly and in accordance with any State requirements.* See also space 17 below.) At surface	512
NW SE 1530' FSL & 1715' FEL	10. FIELD AND POOL OR WILDCAT
14. PERMIT NO.	W. Kutz Pictured Cliffs
15. ELEVATIONS (Show whether DF, RT, GR, etc.)	11. SEC., T., R., M., OR BLK. AND SURVEY OR AREA
5397' GR	Sec. 26 T29N R12W
16. Check Appropriate Box To Indicate Nature of Notice, Report, or Other Data	12. COUNTY OR PARISH
NOTICE OF INTENTION TO:	San Juan
TEST WATER SHUT-OFF <input type="checkbox"/> PULL OR ALTER CASING <input type="checkbox"/> WATER SHUT-OFF <input type="checkbox"/> REPAIRING WELL <input type="checkbox"/>	13. STATE
FRACTURE TREAT <input type="checkbox"/> MULTIPLE COMPLETE <input type="checkbox"/> FRACTURE TREATMENT <input type="checkbox"/> ALTERING CASING <input type="checkbox"/>	
SHOOT OR ACIDIZE <input type="checkbox"/> ABANDON* <input type="checkbox"/> SHOOTING OR ACIDIZING <input type="checkbox"/> ABANDONMENT* <input type="checkbox"/>	
REPAIR WELL <input type="checkbox"/> CHANGE PLANS <input type="checkbox"/> (Other) <input type="checkbox"/>	
17. DESCRIBE PROPOSED OR COMPLETED OPERATIONS (Clearly state all pertinent details, and give pertinent dates, including estimated date of starting any proposed work. If well is directionally drilled, give subsurface locations and measured and true vertical depths for all markers and zones pertinent to this work.)*	

BHP respectfully requests that the APD approval as amended, dated September 5, 1990 for GCU # 512 be amended to allow the well to be drilled 1530' FSL, 1715' FEL Sec. 26 T29N, R12W instead of the approved location of 1620' FSL, 1850' FEL.

The proposed move is to avoid a buried pipeline under the originally proposed location.

The ground elevation between the originally submitted location and this location is only 4', thus the downhole program will not change. All other conditions of the originally submitted APD remain the same.

A cultural inventory of the requested well location is being conducted by San Juan College.

RECEIVED
DEC 21 1990
OIL CON. DEPT.
DIST. 3

APPROVED
DEC 12 1990
AREA MANAGER

18. I hereby certify that the foregoing is true and correct	TITLE	DATE
SIGNED <u>Chuck Williams</u>	Field Services Administrator	November 26, 1990
(This space for Federal or State office use)		
APPROVED BY	TITLE	DATE
CONDITIONS OF APPROVAL, IF ANY:		

*See Instructions on Reverse Side

NMOCD

Submit to Appropriate
District Office
State Lease - 4 copies
Fee Lease - 3 copies

State of New Mexico
Energy, Minerals and Natural Resources Department

Form C-102
Revised 1-1-89

OIL CONSERVATION DIVISION

DISTRICT I
P.O. Box 1980, Hobbs, NM 88240

P.O. Box 2088

Santa Fe, New Mexico 87504-2088

DISTRICT II
P.O. Drawer DD, Artesia, NM 88210

DISTRICT III
1000 Rio Brazos Rd., Aztec, NM 87410

WELL LOCATION AND ACREAGE DEDICATION PLAT

All Distances must be from the outer boundaries of the section

Operator BHP PETROLEUM (AMERICAS) INC.		Lease GALLEGOS CANYON UNIT		Well No. 512
Unit Letter J	Section 26	Township 29 N	Range 12 W	County San Juan
Actual Footage Location of Well: 1530 feet from the South line and 1715 feet from the East line				
Ground level Elev. 5397	Producing Formation Pictured Cliffs	Pool W. Kutz Pictured Cliffs	Dedicated Acreage 160 Acres	
<p>1. Outline the acreage dedicated to the subject well by colored pencil or hatchure marks on the plat below.</p> <p>2. If more than one lease is dedicated to the well, outline each and identify the ownership thereof (both as to working interest and royalty).</p> <p>3. If more than one lease of different ownership is dedicated to the well, have the interest of all owners been consolidated by communitization, unitization, force-pooling, etc.? <input type="checkbox"/> Yes <input type="checkbox"/> No If answer is "yes" type of consolidation _____</p> <p>If answer is "no" list the owners and tract descriptions which have actually been consolidated. (Use reverse side of this form if necessary.) _____</p> <p>No allowable will be assigned to the well until all interests have been consolidated (by communitization, unitization, forced-pooling, or otherwise) or until a non-standard unit, eliminating such interest, has been approved by the Division.</p>				

0 320 640 960 1280 1600 1920 2240 2560 2880 3200 3520 3840 4160 4480 4800 5120 5440 5760 6080 6400

N 89°08'W 39.56cm

N 89°51'W

40.02cm

RECEIVED
DEC 21 1990
OIL CON. DIV.
DIST. 3

26

1715'

1530'

S 89°47'W

79.42cm

OPERATOR CERTIFICATION

I hereby certify that the information contained herein is true and complete to the best of my knowledge and belief.

Signature
Chuck Williams
Printed Name
Chuck Williams
Position
Field Services Administrator
Company
BHP Petroleum (Americas), Inc.
Date
November 26, 1990

SURVEYOR CERTIFICATION

I hereby certify that the well location shown on this plat was plotted from field notes of actual surveys made by me or under my supervision, and that the same is true and correct to the best of my knowledge and belief.
11-19-90

Date Surveyed
William E. Mahnke II

Signature of Seal of Professional Surveyor
WILLIAM E. MAHNKE II
#8466

Certificate No.
8466
NEW MEXICO
PROFESSIONAL LAND SURVEYOR

BHP PETROLEUM (AMERICAS) INC.
 GALLEGOS CANYON UNIT #512
 1530' FSL & 1715' FFL
 Sec. 26, T29N, R12W
 San Juan Co., N.M.

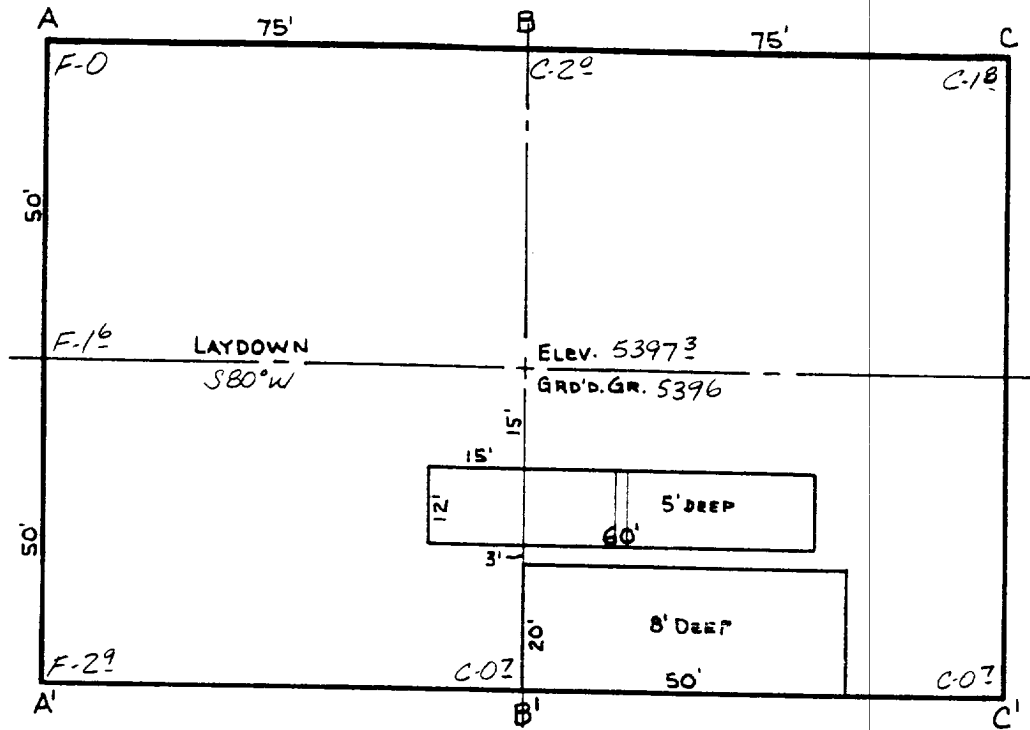

SCALE: 1" = 30'



A-A'		Vert.: 1" = 30'	Horiz.: 1" = 50'	C/L		
5400						
5390						

B-B'		Vert.: 1" = 30'	Horiz.: 1" = 50'	C/L		
5400						
5390						

C-C'		Vert.: 1" = 30'	Horiz.: 1" = 50'	C/L		
5400						
5390						

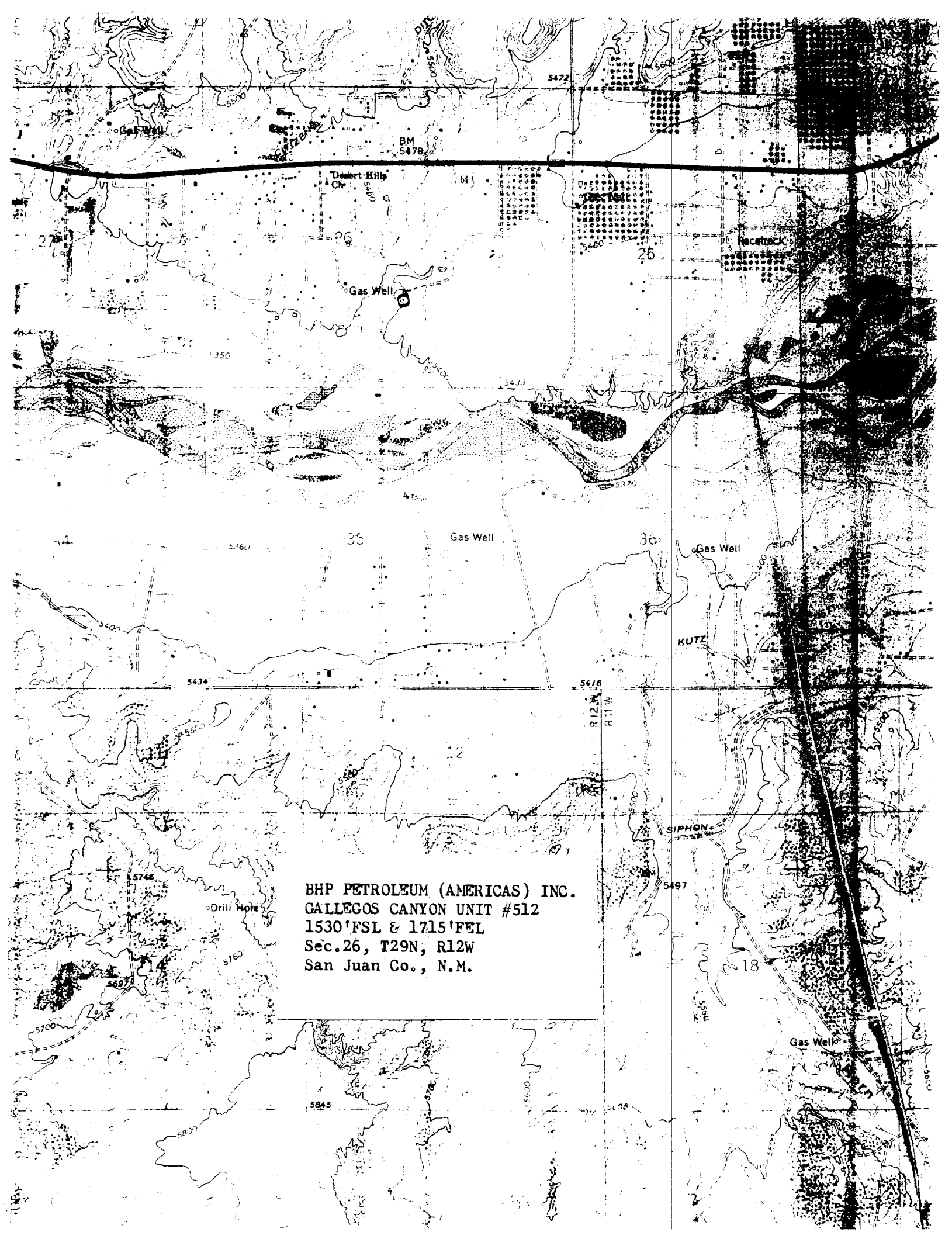
A detailed topographic map of the Gallegos Canyon Unit #512. The map shows a complex network of contour lines, with elevations ranging from 5350 to 5700 feet. Several gas wells are marked with dots and labeled, including 'Gas Well' in the upper center, 'Gas Well' in the middle right, and 'Gas Well' in the lower right. A 'Drill Hole' is marked in the lower left. The map is divided into sections by a grid, with section numbers 25, 26, 35, 36, and 18 visible. A prominent road or path runs vertically along the right side of the map. The text 'BHP PETROLEUM (AMERICAS) INC. GALLEGOS CANYON UNIT #512 1530'FSL & 1715'FEL Sec.26, T29N, R12W San Juan Co., N.M.' is printed in the lower center. Other labels include 'Desert Hills Cr.', 'KUTZ', 'SIPHON', 'R12W', 'R11W', 'BM 5478', '5472', '5460', '5434', '5433', '5436', '5497', '5498', '5499', '5500', '5501', '5502', '5503', '5504', '5505', '5506', '5507', '5508', '5509', '5510', '5511', '5512', '5513', '5514', '5515', '5516', '5517', '5518', '5519', '5520', '5521', '5522', '5523', '5524', '5525', '5526', '5527', '5528', '5529', '5530', '5531', '5532', '5533', '5534', '5535', '5536', '5537', '5538', '5539', '5540', '5541', '5542', '5543', '5544', '5545', '5546', '5547', '5548', '5549', '5550', '5551', '5552', '5553', '5554', '5555', '5556', '5557', '5558', '5559', '5560', '5561', '5562', '5563', '5564', '5565', '5566', '5567', '5568', '5569', '5570', '5571', '5572', '5573', '5574', '5575', '5576', '5577', '5578', '5579', '5580', '5581', '5582', '5583', '5584', '5585', '5586', '5587', '5588', '5589', '5590', '5591', '5592', '5593', '5594', '5595', '5596', '5597', '5598', '5599', '5600'.

BHP PETROLEUM (AMERICAS) INC.
GALLEGOS CANYON UNIT #512
1530'FSL & 1715'FEL
Sec.26, T29N, R12W
San Juan Co., N.M.