

UNITED STATES
DEPARTMENT OF THE INTERIOR
BUREAU OF LAND MANAGEMENT

APPLICATION FOR PERMIT TO DRILL, DEEPEN, OR PLUG BACK

1a. TYPE OF WORK

DRILL ☒

DEEPEN ☐

PLUG BACK ☐

b. TYPE OF WELL

OIL
WELL ☐

GAS
WELL ☒

OTHER

SINGLE
ZONE ☒

MULTIPLE
ZONE ☐

2. NAME OF OPERATOR

BHP Petroleum (Americas) Inc.

3. ADDRESS OF OPERATOR

5847 San Felipe Suite 3600 Houston, Texas 77057-3005

4. LOCATION OF WELL (Report location clearly and in accordance with any State requirements.)*

At surface

NE SE
At proposed prod. zone

1660 FSL 795 FEL

14. DISTANCE IN MILES AND DIRECTION FROM NEAREST TOWN OR POST OFFICE*

Approximately 3 miles East of Farmington, N.M.

15. DISTANCE FROM PROPOSED*

LOCATION TO NEAREST
PROPERTY OR LEASE LINE, FT. Approx. 3365 from
(Also to nearest drlg. unit line, if any) unit boundary

16. NO. OF ACRES IN LEASE

2561.19 160

17. NO. OF ACRES ASSIGNED
TO THIS WELL

160 158.42

18. DISTANCE FROM PROPOSED LOCATION*
TO NEAREST WELL, DRILLING, COMPLETED,
OR APPLIED FOR, ON THIS LEASE, FT.

< 150'

19. PROPOSED DEPTH

1801

20. ROTARY OR CABLE TOOLS

Rotary

21. ELEVATIONS (Show whether DF, RT, GR, etc.)

5696' GR

This action is subject to technical and
procedural review pursuant to 43 CFR 3165.3
and appeal pursuant to 43 CFR 3165.4.

22. APPROX. DATE WORK WILL START*

Fall '90

23.

PROPOSED CASING AND CEMENTING PROGRAM

DRILLING OPERATIONS AUTHORIZED ARE
SUBJECT TO COMPLIANCE WITH ATTACHED
GENERAL REQUIREMENTS

SIZE OF HOLE	SIZE OF CASING	WEIGHT PER FOOT	SETTING DEPTH	GENERAL REQUIREMENTS
8 3/4 "	7"	20#	±130	50 sx (57.5 cu. ft.)
6 1/4 "	4 1/2"	10.5#	±1801	226sx (279 cu. ft.)

RECEIVED
SEP 14 1990
OIL CON. DIV.
DIST. 3

IN ABOVE SPACE DESCRIBE PROPOSED PROGRAM: If proposal is to deepen or plug back, give data on present productive zone and proposed new productive zone. If proposal is to drill or deepen directionally, give pertinent data on subsurface locations and measured and true vertical depths. Give blowout preventer program, if any.

24.

SIGNED

Chuck Williams

TITLE

Field Services Administrator

DATE 9/17/90

(This space for Federal or State office use)

AS APPROVED

PERMIT NO.

APPROVAL DATE

SEP 12 1990

APPROVED BY

CONDITIONS OF APPROVAL, IF ANY:

TITLE

AREA MANAGER

NMOCD

*See Instructions On Reverse Side

Submit to Appropriate
District Office
State Lease - 4 copies
Fee Lease - 3 copies

State of New Mexico
Energy, Minerals and Natural Resources Department

Form C-182
Revised 1-1-89

OIL CONSERVATION DIVISION

P.O. Box 2088

Santa Fe, New Mexico 87504-2088

DISTRICT I

P.O. Box 1980, Hobbs, NM 88240

DISTRICT II

P.O. Drawer DD, Artesia, NM 88210

DISTRICT III

1000 Rio Brazos Rd., Aztec, NM 87410

WELL LOCATION AND ACREAGE DEDICATION PLAT

All Distances must be from the outer boundaries of the section

Operator BHP PETROLEUM (AMERICAS) INC.			Lease GALLEGOS CANYON UNIT		Well No. 505
Unit Letter I	Section 17	Township 29 N	Range 12 W	County San Juan	
Actual Footage Location of Well: 1660 feet from the South line and 795 feet from the East line					
Ground level Elev. 5696	Producing Formation Pictured Cliffs		Pool W. Kutz Pictured Cliffs	Dedicated Acreage: 160-158.42 Acres	

- Outline the acreage dedicated to the subject well by colored pencil or hatchure marks on the plat below.
- If more than one lease is dedicated to the well, outline each and identify the ownership thereof (both as to working interest and royalty).
- If more than one lease of different ownership is dedicated to the well, have the interest of all owners been consolidated by communitization, unitization, force-pooling, etc.?
☐ Yes ☐ No If answer is "yes" type of consolidation _____
If answer is "no" list the owners and tract descriptions which have actually been consolidated. (Use reverse side of this form if necessary).
No allowable will be assigned to the well until all interests have been consolidated (by communitization, unitization, forced-pooling, or otherwise) or until a non-standard unit, eliminating such interest, has been approved by the Division.

0 330 660 990 1320 1650 1980 2310 2640 2970 3300 0

N 89°38'W 39.82ca. S 87°41'W 39.87ca.

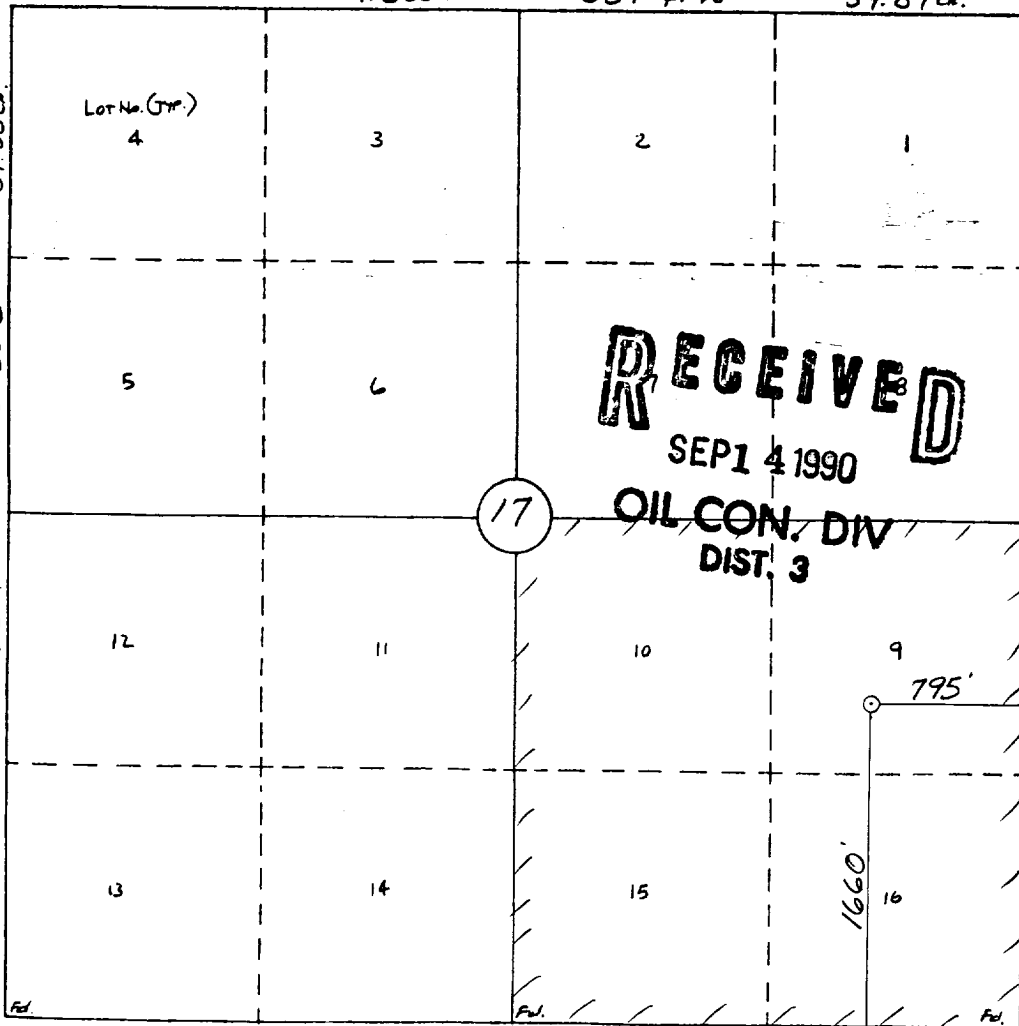

OPERATOR CERTIFICATION

I hereby certify that the information contained herein is true and complete to the best of my knowledge and belief.

Signature
Charles K. Williams

Printed Name
Charles K. Williams

Position
Field Services Administrator

Company
BHP Petroleum (Americas) Inc.

Date
7/24/90

SURVEYOR CERTIFICATION

I hereby certify that the well location shown on this plat was plotted from field notes of actual surveys made by me or under my supervision, and that the same is true and correct to the best of my knowledge and belief.
7-18-90

Date Surveyed
William E. Mahnke II

Signature & Seal of Professional Surveyor

Professional Surveyor
#8466

Certificate No.
8466

BHP PETROLEUM (AMERICAS) INC.
GALLEGOS CANYON UNIT #505
1660'FSL & 795'FEL
Sec.17, T29N, R12W
San Juan Co., N.M.

