

APPLICATION FOR AUTHORIZATION TO INJECT

UNCO DISPOSAL well #1

E-2-29w-12w

- I. Purpose: ☐ Secondary Recovery ☐ Pressure Maintenance ☒ Disposal ☐ Storage
Application qualifies for administrative approval? ☐ yes ☐ no
- II. Operator: Coleman Oil and Gas, Inc.
Address: P.O. Drawer 3337, Farmington, NM 87499
Contact party: L.O. Van Ryan Phone: (505) 325-8900
- III. Well data: Complete the data required on the reverse side of this form for each well proposed for injection. Additional sheets may be attached if necessary.
Attachment #1 and #2
- IV. Is this an expansion of an existing project? ☐ yes ☒ no
If yes, give the Division order number authorizing the project _____.
- V. Attach a map that identifies all wells and leases within two miles of any proposed injection well with a one-half mile radius circle drawn around each proposed injection well. This circle identifies the well's area of review. Attachment #3
- VI. Attach a tabulation of data on all wells of public record within the area of review which penetrate the proposed injection zone. Such data shall include a description of each well's type, construction, date drilled, location, depth, record of completion, and a schematic of any plugged well illustrating all plugging detail. Attachment #4
- VII. Attach data on the proposed operation, including: Attachment #5
1. Proposed average and maximum daily rate and volume of fluids to be injected;
 2. Whether the system is open or closed;
 3. Proposed average and maximum injection pressure;
 4. Sources and an appropriate analysis of injection fluid and compatibility with the receiving formation if other than reinjected produced water; and
 5. If injection is for disposal purposes into a zone not productive of oil or gas at or within one mile of the proposed well, attach a chemical analysis of the disposal zone formation water (may be measured or inferred from existing literature, studies, nearby wells, etc.).
- VIII. Attach appropriate geological data on the injection zone including appropriate lithologic detail, geological name, thickness, and depth. Give the geologic name, and depth to bottom of all underground sources of drinking water (aquifers containing waters with total dissolved solids concentrations of 10,000 mg/l or less) overlying the proposed injection zone as well as any such source known to be immediately underlying the injection interval. Attachment #6
- IX. Describe the proposed stimulation program, if any. Attachment #7
- X. Attach appropriate logging and test data on the well. (If well logs have been filed with the Division they need not be resubmitted.) Attachment #8
- XI. Attach a chemical analysis of fresh water from two or more fresh water wells (if available and producing) within one mile of any injection or disposal well showing location of wells and dates samples were taken. Attachment #9
- XII. Applicants for disposal wells must make an affirmative statement that they have examined available geologic and engineering data and find no evidence of open faults or any other hydrologic connection between the disposal zone and any underground source of drinking water. Attachment #10
- XIII. Applicants must complete the "Proof of Notice" section on the reverse side of this form.
- XIV. Certification
- I hereby certify that the information submitted with this application is true and correct to the best of my knowledge and belief.
- Name: L.O. Van Ryan Title: Agent
Signature: [Signature] Date: 6-26-91
- * If the information required under Sections VI, VIII, X, and XI above has been previously submitted, it need not be duplicated and resubmitted. Please show the date and circumstance of the earlier submittal.

Attachment #1

Item III: Well Data - Injection Well

A.

1. Lease Name: Sunco Disposal Well
Well No: 1
Location: 1595' FNL and 1005' FWL of Section 2,
T29N, R12W

2. Casing Program

<u>Hole Size</u>	<u>Casing Size</u>	<u>Depth Set</u>	<u>Cement</u>
12 1/2"	8 5/8", 24#, J-55	200'	150 sks cl A cement with 2% CaCl ₂ and 1/4# Flocel per sack (Circ to surface)
7 7/8"	5 1/2", 15.5#, J-55	4760'	2 stage job w/stage tool at 2250' <u>1st stage:</u> 191 sks 65:35 Poz w/6% gel, 5# gilsonite /sk and 1/4# Flocele/sk, 263 sks cl B cem w/5# gil- sonite/sk and 1/4# Flocele sk <u>2nd stage:</u> 368 sks 65:35 Poz w/6% gel, 5# gilsonite /sk, 1/4# Flocele/sk and 2% CaCl ₂ followed by 60 sks Cl B cem w/2% CaCl ₂ (Circ to surface)

3. Tubing Program

2 7/8", 6.5#, J-55, EUE plastic lined tubing

4. Packer

5 1/2" Baker, compression set type packer to
be set at 4340'.

B.

1. Injection formation: Point Lookout section of
the Mesa Verde formation.
2. Interval to be perforated: 4380' to 4480'.
3. The well is to be drilled for injection purposes.
4. No other zones will be perforated.
5. Depth of next higher oil and gas zone:
2285' (bottom of Pictured Cliffs formation)
Depth of next lower oil and gas zone:
6550' (top of Dakota formation)

Attachment "Z"

WELL NAME: SUNCO Disposal Well 1 OFF: _____
LOCATION: 1595' FNL AND 1005' FWL Sec 2, T29N, R12W
FIELD: Salt Water Disposal COUNTY: SAN JUAN STATE: NM
PROG FM AND INTERVAL: Injection Zone - Point Lookout
formation from 4380' to 4480'

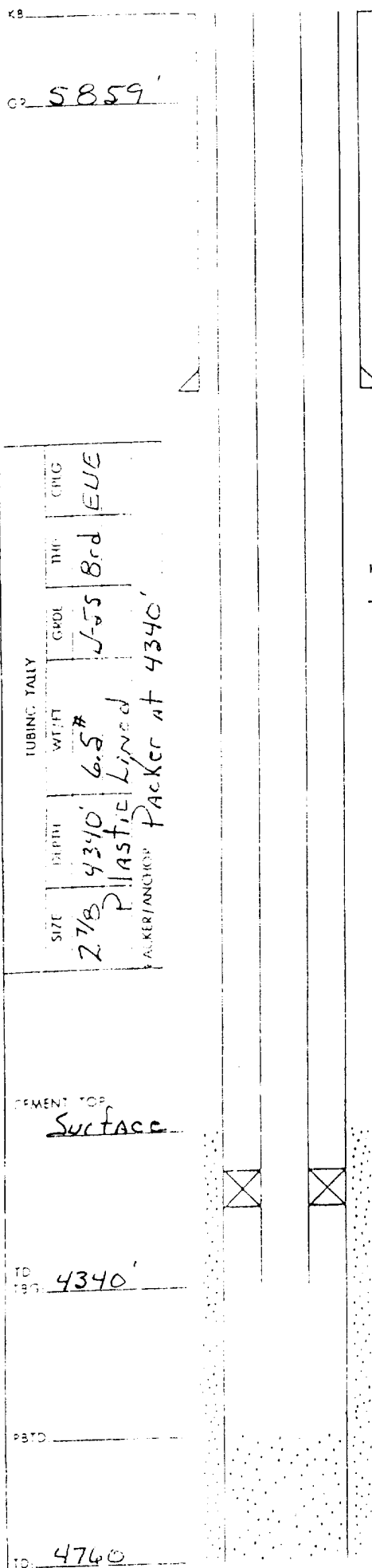

CASING					
O.D.	WT/FT	GRADE	CPLG	INTERVAL	N/U
8 5/8	24#	J-55	ST4C	0 - 200'	
5 1/2	15.5#	J-55	ST4C	0 - 4760'	

REMARKS: 8 5/8 cement - 150 sks of B cement w/ 2% CaCl₂ AND 1/4" Flocc per sk. - Circ to the surface (180 cu. ft.)

PRIMARY CEMENT

5 1/2" - 1st stage 190 sks 45:35 Poz w/6% gel, 5# gilsonite/sk AND 1/4" Flocc/sk followed by 265 sks of B cem w/5# gilsonite/sk AND 1/4" Flocc/sk (664 cu. ft.) - 2nd stage (Tool at 2250') 370 sks of 45:35 Poz w/6% gel, 5# gilsonite/sk, 1/4" Flocc/sk AND 2% CaCl₂ followed by 60 sks of B cem w/2% CaCl₂ (722 cu. ft.)

PERFORATION

INTERVALS	DENSITY	DESCRIPTION
4380 - 4480	1 SPF	
REMARKS		

STIMULATION HISTORY

INTERVAL		SD VOL.	DATE
4380 - 4480	Brkdwn w/15% HCl & Balls		

ORIGINAL ROD STRING

CURRENT ROD STRING

No. RODS	SIZE	TYPE	No. RODS	SIZE	TYPE

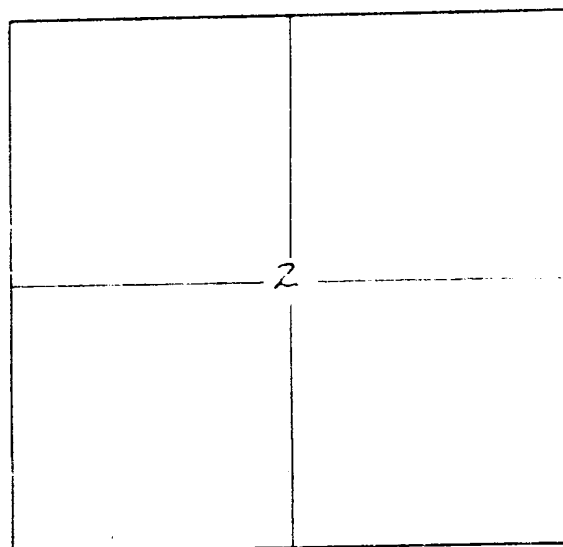

T29N R12W

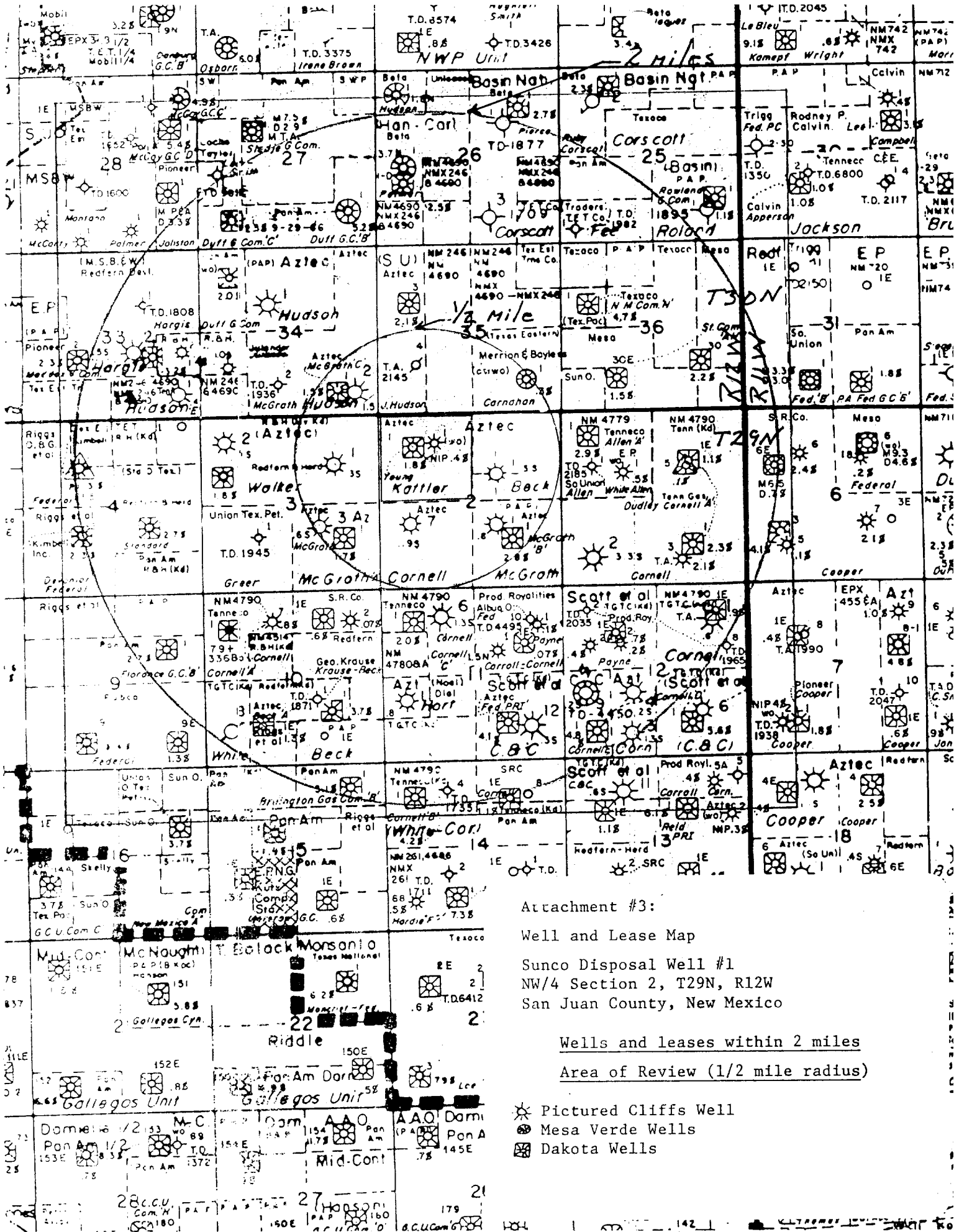

Attachment #3:

Well and Lease Map

Sunco Disposal Well #1
NW/4 Section 2, T29N, R12W
San Juan County, New Mexico

Wells and leases within 2 miles

Area of Review (1/2 mile radius)

- ★ Pictured Cliffs Well
- Mesa Verde Wells
- Dakota Wells

Attachment #4

Item VI: Wells within the Area of Review
(Which Penetrate the Point Lookout Formation)

<u>Well Name</u>	<u>Location</u>	<u>Type</u>	<u>Date Drilled</u>	<u>Depth</u>	<u>Status</u>
Township 30 North, Range 12 West					
McGrath C #1	P Sec 34	Basin Dakota	2-63	6637'	Producing
Carnahan Com #1	P Sec 35	Flora Vista Mesa Verde	1-61	6760'	Producing*
Carnahan Com #2	P Sec 35	Basin Dakota	7-84	6780'	Producing
Township 29 North, Range 12 West					
Young #1	D Sec 2	Basin Dakota	8-61	6739'	Producing
McGrath B #1	J Sec 2	Basin Dakota	12-61	6720'	Producing
McGrath A #1	I Sec 3	Basin Dakota	3-64	6688'	Producing

Completion Reports for these wells are attached.

* The Carnahan Com #1 was originally completed in the Dakota formation. The Dakota was plugged in 1972 by setting a bridge plug at 6400' and capped with 5 sacks of cement.

U. S. LAND OFFICE SANTA FE

SERIAL NUMBER 077222

LEASE OR PERMIT TO PROSPECT

UNITED STATES

DEPARTMENT OF THE INTERIOR

GEOLOGICAL SURVEY

U.S. AIR FORCE OFFICE
OF SPECIAL INVESTIGATION

LOG OF OIL OR GAS WELL

LOCATE WELL CORRECTLY

Company AMTEC OIL AND GAS COMPANY Address F. O. DEARER 570 FARMINGTON, N. MEX.
Lessor or Tract MOGUTH Field BASIN DAKOTA State NEW MEXICO
Well No. C-1 Sec. 34 T. 30N R. 12W Meridian N.M.F.M. County SAN JUAN
Location 870 ft. N. of E. Line and 1190 ft. W. of E. Line of SECTION 34 Elevation 5774 s.l.
(Survey floor relative to sea level)

The information given herewith is a complete and correct record of the well and all work done thereon so far as can be determined from all available records.

Signed

Date MARCH 7, 1963

JOE C. SALMON

Title **DISTRICT SUPERINTENDENT**

The summary on this page is for the condition of the well at above date.

Commenced drilling FEBRUARY 7, 1963 Finished drilling FEBRUARY 18, 1963

OIL OR GAS SANDS OR ZONES

(Denote gas by G)

No. 1, from 6387 to 6400 a No. 4, from to
No. 2, from 6462 to 6484 a No. 5, from to
No. 3, from 6482 to 6576 a No. 6, from to

IMPORTANT WATER SANDS

No. 1, from to No. 3, from to

No. 2, from to No. 4, from to

CASING RECORD

Size casing	Weight per foot	Threads per inch	Make	Amount	Kind of shoe	Cut and pulled from	Perforated		Purpose
							From—	To—	
8 7/16	24	8 rd.	J-55	311					
1 1/2	9.7	8 rd.	J-55	5162					
2 7/8	4.7	8 rd.	J-55	6799					
4 1/2	11.6	8 rd.	J-55	1163					

MUDDING AND CEMENTING RECORD

	Size casing	Where set	Number sacks of cement	Method used	Mud gravity	Amount of mud used
MARK 8	7/8	323	225	Displacement		
1	1/2	6631	925	Twe Plug		
2	7/8	6104	-----	-----		

PLUGS AND ADAPTERS

Heaving plug—Material _____ Length _____ Depth set _____

Adapters—Material _____ Size _____

SHOOTING RECORD

Size	Shell used	Explosive used	Quantity	Date	Depth shot	Depth cleaned out
------	------------	----------------	----------	------	------------	-------------------

From 10/16, 950 gals water & 72,000# sand, Breakdown pr.-1400#, Avg. Trtg. Pr.-2750#, Max. Trtg. Pr.-3000#, A.I.R.-30.6 bpm, Flushed w/150 bbls, dropped 65 balls, I.S.I.-1500#, 10 ctn S.I.-1150#, Shut In for 1 hr., Max. Int. nipple- 6374'.

TOOLS USED

Rotary tools were used from 0 feet to 6631 feet, and from 0 feet to 6605 feet.
Cable tools were used from 0 feet to 6631 feet, and from 0 feet to 6605 feet.

DATES

FEBRUARY 21, 1963 The production for the first 24 hours was emulsion; % water; and % sediment. If gas well, cu. ft. per 24 hours Rock pressure, lbs. per sq. in.	Put to producing, 19_____ barrels of fluid of which % was oil; % Gravity, °Bé. _____ Gallons gasoline per 1,000 cu. ft. of gas _____ ACF-1,577
--	--

NUMBER OF COPIES RECEIVED	
COPIES	RECEIVED
DATE	TIME
BY	FOR
REMARKS	
DATE	TIME
BY	FOR
REMARKS	
DATE	TIME
BY	FOR
REMARKS	

NEW MEXICO OIL CONSERVATION COMMISSION

Santa Fe, New Mexico

WELL RECORD

Mail to District Office, Oil Conservation Commission, to which Form C-101 was sent not later than twenty days after completion of well. Follow instructions in Rules and Regulations of the Commission. Submit in **QUINTUPLICATE** If State Land submit 6 Copies

T
3
0
NAREA 640 ACRES
LOCATE WELL CORRECTLY

Texas Eastern Transmission Corporation

Carnahan Unit

(Company or Operator)

(Land)

Well No. 1, in SE SE 35 of 35, T. 30N, R. 12W, NMPM.
Dakota San Juan County.

Well is 990 feet from South line and 990 feet from East line
of Section 35. If State Land the Oil is State Land.

Drilling Commenced December 19, 19 60 Drilling was Completed January 15, 19 61

Name of Drilling Contractor Exeter Drilling CompanyAddress 919 Midland Savings Bldg, Denver 2, Colorado

Elevation above sea level at Top of Tubing Head 5,911.4
March 1, 19 61 The information given is to be kept confidential until

Dakota Gas ~~CONSERVATION~~ UNITS
No. 1, from 6,521 to 6,534 No. 4, from 6,690 to 6,706
No. 2, from 6,603 to 6,624 No. 5, from to
No. 3, from 6,653 to 6,663 No. 6, from to

IMPORTANT WATER SANDS

Include data on rate of water inflow and elevation to which water rose in hole.

No. 1, from None to feet.
No. 2, from to feet.
No. 3, from to feet.
No. 4, from to feet.

CASING RECORD

SIZE	WEIGHT PER FOOT	NEW OR USED	AMOUNT	KIND OF SHOE	CUT AND PULLED FROM	PERFORATIONS	PURPOSE
8 5/8"	24#	New	291.55	-	-	-	Surface set @ 301'
4 1/2"	9.5&11.6#	New	6,760.74	Halliburton	-	6521-34 6603-24 6653-63 6690-6706	Production

MUDDING AND CEMENTING RECORD

SIZE OF HOLE	SIZE OF CASING	WHERE SET	NO. BAGS OF CEMENT	METHOD USED	MUD GRAVITY	AMOUNT OF MUD USED
12"	8 5/8	301	200	Displacement	Native	-
7 7/8"	4 1/2	6,760	250 sx. Fosmix 8, 50-50, 4# gel + 75sx. Latex	Displacement	9.4#/gal.	107 bbls.

RECORD OF PRODUCTION AND STIMULATION

(Record the Process used, No. of Qts. or Gals. used, interval treated or shot.)

Fractured: Using Halliburton "Slick Gel Water Frac" 6690-6703 and 6653-63 w/40,000# 20-40 sand and 48,614 bbls. water

6603-6624 with 40,000# 20-40 sand and 40,177 bbls. water

6521-6534 with 30,000# 20-40 sand and 31,983 bbls. water

Result of Production Stimulation

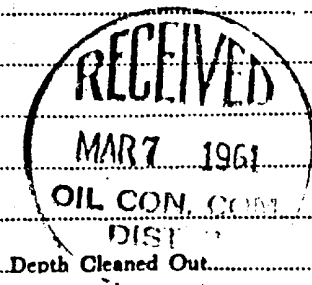
Absolute Potential = 3,226 MCF/day

NO. OF COPIES RECEIVED	5
DISTRIBUTION:	
SANTA FE	1
FILE	1
U.S.G.S.	2
LAND OFFICE	
OPERATOR	1

NEW MEXICO OIL CONSERVATION COMMISSION

Form C-101
Revised 1-1-65

5A. Indicate Type of Lease STATE <input type="checkbox"/> FEE <input checked="" type="checkbox"/>
5. State Oil & Gas Lease No.
7. Unit Agreement Name
8. Farm or Lease Name Carnahan
9. Well No. 1
10. Field and Pool, or Wildcat Undesignated MV
12. County San Juan
19. Proposed Depth 3800
19A. Formation MV (Cliffhouse)
20. Rotary or C.T. Both
21A. Kind & Status Plug. Bond Statewide
21B. Drilling Contractor L & M Well Service
22. Approx. Date Work will start February 15, 1972

APPL CATION FOR PERMIT TO DRILL, DEEPEN, OR PLUG BACK	
a. Type of Work	
b. Type of Well OIL WELL <input type="checkbox"/> GAS WELL <input checked="" type="checkbox"/> OTHER <input type="checkbox"/>	DRILL <input type="checkbox"/> DEEPEN <input type="checkbox"/> PLUG BACK <input type="checkbox"/>
c. Name of Operator J. Gregory Merrion and Robert L. Bayless	
d. Address of Operator P. O. Box 1541, Farmington, New Mexico 87401	
e. Location of Well UNIT LETTER P LOCATED 990 FEET FROM THE South LINE	
f. 990 FEET FROM THE East LINE OF SEC. 35 TWP. 30N RGE. 12 W NMPM	
g. 19. Proposed Depth 3800 19A. Formation MV (Cliffhouse) 20. Rotary or C.T. Both	
h. i. Elevations (Show whether DF, RT, etc.) 5911 Gr 21A. Kind & Status Plug. Bond Statewide 21B. Drilling Contractor L & M Well Service 22. Approx. Date Work will start February 15, 1972	

PROPOSED CASING AND CEMENT PROGRAM

SIZE OF HOLE	SIZE OF CASING	WEIGHT PER FOOT	SETTING DEPTH	SACKS OF CEMENT	EST. TOP

Perforated Cliffhouse (Mesaverde) 3766-80 with 28 shots fraced with 500# 20-40 sand and 5000 gallons water I.P. 312 MCF - Waiting Pipeline Connection



ABOVE SPACE DESCRIBE PROPOSED PROGRAM: IF PROPOSAL IS TO DEEPEN OR PLUG BACK, GIVE DATA ON PRESENT PRODUCTIVE ZONE AND PROPOSED NEW PRODUCTIVE ZONE. GIVE FLOWOUT PREVENTER PROGRAM, IF ANY.

I hereby certify that the information above is true and complete to the best of my knowledge and belief.

Signed W. Bayless Title Operator Date April 17, 1972

(This space for State Use)

Original Signed by Emery C. Arnold TITLE SUPERVISOR DIST. #3 DATE APR 18 1972

PROVED BY _____ TITLE _____ DATE _____

CONDITIONS OF APPROVAL, IF ANY:

AP COMES RECEIVED	3
DISTRIBUTION	
ANTA FE	1
FILE	1
U.S.G.S.	
LAND OFFICE	
OPERATOR	1

NEW MEXICO OIL CONSERVATION COMMISSION

Form C-103
Supersedes Old
C-102 and C-103
Effective 1-1-65

SUNDRY NOTICES AND REPORTS ON WELLS <small>(DO NOT USE THIS FORM FOR PROPOSALS TO DRILL OR TO DEEPEN OR PLUG BACK TO A DIFFERENT RESERVOIR. USE "APPLICATION FOR PERMIT -" (FORM C-101) FOR SUCH PROPOSALS.)</small>		5a. Indicate Type of Lease State <input type="checkbox"/> Fee <input checked="" type="checkbox"/>
5. State Oil & Gas Lease No.		
7. Unit Agreement Name		
8. Farm or Lease Name Carnahan		
9. Well No. 1		
10. Field and Pool, or Wildcat Basin Dakota		
11. Elevation (Show whether DF, RT, GR, etc.) 5911 GL		12. County San Juan

Check Appropriate Box To Indicate Nature of Notice, Report or Other Data	
NOTICE OF INTENTION TO:	SUBSEQUENT REPORT OF:
PERFORM REMEDIAL WORK <input type="checkbox"/> TEMPORARILY ABANDON <input type="checkbox"/> PLUG OR ALTER CASING <input type="checkbox"/> OTHER <input type="checkbox"/>	PLUG AND ABANDON <input type="checkbox"/> CHANGE PLANS <input type="checkbox"/> OTHER <input type="checkbox"/>
REMEDIAL WORK <input type="checkbox"/> COMMENCE DRILLING OPNS. <input type="checkbox"/> CASING TEST AND CEMENT JOB <input type="checkbox"/> OTHER <input type="checkbox"/>	ALTERING CASING <input type="checkbox"/> PLUG AND ABANDONMENT <input checked="" type="checkbox"/> OTHER <input type="checkbox"/>

Describe Proposed or Completed Operations (Clearly state all pertinent details, and give pertinent dates, including estimated date of starting any proposed work) SEE RULE 1103.

On 2-8-72 moved in L and M Well Service, blew down casing, unseated packer and pulled tubing. Set Bridge Plug at 6400' and spotted 5 sack neat cement from 6400' to 6340'. Ran tubing with Baker Model R Packer and found top of corroded casing at 3802', bottom @ 4277'. Set Packer at 3627' and squeezed with 400 cu. ft. of Dowell cement in three batches. 1st batch 200 cu. ft. over displaced; second batch 160 cu. ft. over displaced; third batch 40 cu. ft. squeezed to 2700' psi.

Dakota now plugged and abandoned.



I, I hereby certify that the information above is true and complete to the best of my knowledge and belief.

SIGNED <u>Bugsy Merrion</u> APPROVED BY <u>Emmy C. Lewis</u> CONDITIONS OF APPROVAL, IF ANY:	TITLE <u>Operator</u> TITLE <u>SUPERVISOR DIST. #3</u>	DATE <u>2-10-72</u> DATE <u>FEB 11 1972</u>
--	---	--

OIL CONSERVATION DIVISION

P. O. BOX 2088

SANTA FE, NEW MEXICO 87501

WELL COMPLETION OR RECOMPLETION REPORT AND LOG

DATE OF COMPLETION	
DISTRIBUTION	
DATE	
NAME	
ADDRESS	
PHONE	
OPERATOR	

5a. Indicate Type of Lease
State ☐ Fee ☒

5. State Oil & Gas Lease No.

TYPE OF WELL
OIL WELL ☐ GAS WELL ☒ DRY ☐ OTHER ☐

TYPE OF COMPLETION
☒ WORK OVER ☐ DEEPEN ☐ PLUG BACK ☐ DIFF. RESV. ☐ OTHER ☐

7. Unit Agreement Name

Operator
Prion Oil & Gas Corporation
Address of Operator
P. O. Box 1017, Farmington, New Mexico 87499
Location of Well

8. Farm or Lease Name
Carnahan Com

9. Well No.
2

10. Field and Pool, or Wildcat
Basin Dakota

Direction ☒ P LOCATED 109.0 FEET FROM THE South 1070
East 35 30N 12W
LINE OF SEC. TWP. RGE. NMPM

12. County
San Juan

Spudded 15/84	16. Date T.D. Reached 6/24/84	17. Date Compl. (Ready to Prod.) 7/23/84	18. Elevations (DF, RKB, RT, GR, etc.) 5918' KB	19. Elev. Casinghead 5905' GL
Depth 20' KB	21. Plug Back T.D. 6735' KB	22. If Multiple Compl., How Many	23. Intervals Drilled By Rotary Tools 0 - TD	Cable Tools
24. Logging Interval(s), of this completion - Top, Bottom, Name 14 - 6529' KB, Dakota				25. Was Directional Survey Made No
Electric and Other Logs Run S Induction, compensated Density Logs				27. Was Well Cored No

CASING RECORD (Report all strings set in well)

PIPE SIZE	WEIGHT LB./FT.	DEPTH SET	HOLE SIZE	CEMENTING RECORD	AMOUNT PULLED
5/8"	24 #/ft, J-5	230' KB	12-1/4"	170 sx (350 cu. ft.) Class B	
1-1/2"	10.5 #/ft, J-55	6777' KB	7-7/8"	400 sx (488 cu. ft.) Class H	325 sx 376.5'
				600 sx (1236 cu. ft.) Class B	
				100 sx (122 cu. ft.) Class B	

LINER RECORD

PIPE SIZE	TOP	BOTTOM	SACKS CEMENT	SCREEN	SIZE	DEPTH SET	PACKER SET
					2-3/8"	6530' KB	

Log Record (Interval, size and number)
29, 6538, 6541, 6617, 6620, 6625, 6629,
32, 6700, 6705, 6710, 6714, 12 holes, 0.32"
diameter.

32. ACID, SHOT, FRACTURE, CEMENT SQUEEZE, ETC.	
DEPTH INTERVAL	AMOUNT AND KIND MATERIAL USED
6529 - 6714' KB	75 Quality Foam
	434 Bbls H2O
	1,700,198 SCF N ₂
	55,000 # 20/40 sand

PRODUCTION

Production 7/84	Production Method (Flowing, gas lift, pumping - Size and type pump) Flowing	Well Status (Prod. or Shut-in) Shut in
Test 7/84	Hours Tested 3	Coke Size 20/64
Prod'n. For Test Period	Oil - Bbl. 2 Bbls	Gas - MCF 603 MCF/D
Water - Bbl. trace	Gas - Oil Ratio 37,688	
Casing Pressure 950 PSI	Calculated 24-Hour Rate 16	Oil Gravity - API (Corr.) 48°
Flowing Pressure PSI	Gas - MCF 603 MCF/D	Water - Bbl. trace
Flowing Temperature (Solid, used for fuel, vented, etc.) Vented	Test Witnessed By Tim Merilatt	

I certify that the information shown on both sides of this form is true and complete to the best of my knowledge and belief.

Operations Manager

8/6/84

COPIES RECEIVED	
DISTRIBUTION	
TO	BY
DATE	INITIALS
TO OFFICE	
IMPORTER	OIL
EXPORTER	GAS
TO OFFICE	
TO OFFICE	

Obvised 7/1/58
(Form C-100)

0									

NEW MEXICO OIL CONSERVATION COMMISSION
Santa Fe, New Mexico

WELL RECORD

Mail to District Office, Oil Conservation Commission, to which Form C-101 was sent not later than twenty days after completion of well. Follow instructions in Rules and Regulations of the Commission. Submit in QUINTUPLICATE If State Land submit 6 Copie.

AREA 640 ACRES
LOCATE WELL CORRECTLY

Attec Oil & Gas Company Young
(Company or Operator) (Lease)

Well No. 1-D, in NW 1/4 of Sec 2, T. 22N, R. 12W, NMPM.
Basin Dakota Pool, San Juan County.
Well is 290 feet from North line and 290 feet from West line
of Section 2. If State Land the Oil and Gas Lease No. is
Drilling Commenced 8/1/61, 19. Drilling was Completed 8/13/61, 19.
Name of Drilling Contractor Summit Drilling Company
Address Box # 190, Farmington, New Mexico
Elevation above sea level at Top of Tubing Head G.L. - 5847 The information given is to be kept confidential until non-confidential, 19.

OIL SANDS OR ZONES

No. 1, from 6445 to 6456 No. 4, from to
No. 2, from 6521 to 6546 No. 5, from to
No. 3, from 6602 to 6644 No. 6, from to

IMPORTANT WATER SANDS

Include data on rate of water inflow and elevation to which water rose in hole.

No. 1, from to feet.
No. 2, from to feet.
No. 3, from to feet.
No. 4, from to feet.

CASING RECORD

SIZE	WEIGHT PER FOOT	NEW OR USED	AMOUNT	KIND OF SHOE	CUT AND PULLED FROM	PERFORATIONS	PURPOSE
8 5/8	21	NEW	294				
4 1/2	11.6	NEW	1162				
4 1/2	9.5	NEW	5566				
2 3/8	4.7	NEW	6426				

MUDDING AND CEMENTING RECORD

SIZE OF HOLE	SIZE OF CASING	WHERE SET	NO. BAGS OF CEMENT	METHOD USED	MUD GRAVITY	AMOUNT OF MUD USED
12 1/4	8 5/8	307	275	displacement		
7 7/8	4 1/2	6732	700	two plug		
	2 3/8	6436				

RECORD OF PRODUCTION AND STIMULATION

(Record the Process used, No. of Qts. or Gals. used, interval treated or shot.)

Sand-water forced with 60,000# 20/40 sand, 30,000# 10/20 sand, 2036 Bbls. water
flushed with 160 Bbls. water.
Result of Production Stimulation Maximum - 3400, Avg. 2800, I.R. - 33.3 bpm, dropped 108 rubber ball
sealers, 5 min. shut-in pr. - 1200
Depth Cleaned Out 6705

COPIES RECEIVED	6
DISTRIBUTION	
TA FE	1
E	1
G.S.	
ID OFFICE	
RATOR	4

NEW MEXICO OIL CONSERVATION COMMISSION

Form C-103
Supersedes Old
C-102 and C-103
Effective 1-1-65

5a. Indicate Type of Lease	
State <input type="checkbox"/>	Fee <input checked="" type="checkbox"/>
5. State Oil & Gas Lease No.	

SUNDRY NOTICES AND REPORTS ON WELLS

(DO NOT USE THIS FORM FOR PROPOSALS TO DRILL OR TO DEEPEN OR PLUG BACK TO A DIFFERENT RESERVOIR. USE "APPLICATION FOR PERMIT -" (FORM C-101) FOR SUCH PROPOSALS.)

OIL WELL ☐ GAS WELL ☒ OTHER ☐

Name of Operator

Astec Oil & Gas Company

Address of Operator

Drawer 570, Farmington, New Mexico

Location of Well

UNIT LETTER J 1050 FEET FROM THE South LINE AND 1650 FEET FROM

THE East LINE, SECTION 2 TOWNSHIP 29 RANGE 12 NMPM.

15. Elevation (Show whether DF, RT, GR, etc.)

5892 Gr

7. Unit Agreement Name

8. Farm or Lease Name

McGrath B

9. Well No.

#1

10. Field and Pool, or Wildcat

Basin Dakota

12. County

San Juan

Check Appropriate Box To Indicate Nature of Notice, Report or Other Data

NOTICE OF INTENTION TO:

ORM REMEDIAL WORK ☐
ORARILY ABANDON ☐
OR ALTER CASING ☐

PLUG AND ABANDON ☐
CHANGE PLANS ☐

OTHER ☐

SUBSEQUENT REPORT OF:

REMEDIAL WORK ☒
COMMENCE DRILLING OPNS. ☐
CASING TEST AND CEMENT JOBS ☐
OTHER ☐

ALTERING CASING ☐
PLUG AND ABANDONMENT ☐

Describe Proposed or Completed Operations (Clearly state all pertinent details, and give pertinent dates, including estimated date of starting any proposed work) SEE RULE 1103.

12-11-69 Moved on workover unit.

12-12-69 Pulled 2-3/8" tbg. set bridge plug at 6000'. Ran corrosion log. Found bad pipe @ 1930' & 5900'. Went in hole with packer. Set @ 2000'. Pressure up to 2000# above packer. Leaked off to 200# in 3 min.

12-13-69 Found hole @ 2584 cmt with 150 sx class A with 12.5# gilsonite, 2% calc. & 100 sbs class A, & 2% calc.

12-14-69 Drlg out cmt. Tested csg to 1500#. Held ok! Pulled out & started blowing down.

12-15-69 Drlg plug @ 6000'. Cleaned out to the bottom. Trip out hole. Ran prod. string 245 jts 2-3/8" EUE tubing. Landed @ 6442'. Rig down.

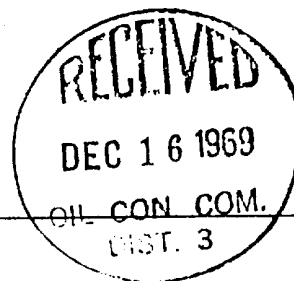

I hereby certify that the information above is true and complete to the best of my knowledge and belief.

[Signature]

TITLE District Superintendent

DATE December 15, 1969

APPROVED BY [Signature]

TITLE SUPERVISOR DIST. #3

DATE DEC 16 1969

CONDITIONS OF APPROVAL, IF ANY:

14

						X	

NUMBER OF COPIES RECEIVED	
DISTRIBUTION	
SANTA FE	
FILE	
DISC.	
LAND OFFICE	
TRANSPORTER	OIL GAS
INFORMATION OFFICE	
OPERATOR	

✱

AREA 640 ACRES
LOCATE WELL CORRECTLY

MORRATH "A"

(Company or Operator)

(L-250)

Basin Dakota

Pool.....**San Juan**

Country.

Well is 1720 feet from South line and 990 feet from East line

of Section.....3..... If State Land the Oil and Gas Lease No. is.....Patented.....

Drilling Commenced.....3-14....., 19. 64. Drilling was Completed.....3-29....., 19. 64.

Name of Drilling Contractor..... Ampalco

Address.....

Elevation above sea level at Top of Tubing Head..... The information given is to be kept confidential until
..... 19.....

No. 1, from 6432 to 6440 No. 4, from.....to.....
No. 2, from 6452 to 6456 No. 5, from.....to.....
No. 3, from 6504 to 6524 No. 6, from.....to.....

Include data on rate of water inflow and elevation to which water rose in hole.

No. 1, from.....to.....feet.

No. 2, from.....to.....feet.

No. 3, from.....to.....feet.

No. 4, from.....to.....feet.

SIZE	WEIGHT PER FOOT	NEW OR USED	AMOUNT	KIND OF SHOE	CUT AND PULLED FROM	PERFORATIONS	PURPOSE
8 5/8"	24"	New	9 jts.				
4 1/2"	9.5 & 11.6	New	213 jts.				

MUDGING AND CEMENTING RECORD						
SIZE OF HOLE	SIZE OF CASING	WHERE SET	NO. BAGS OF CEMENT	METHOD USED	MUD GRAVITY	AMOUNT OF MUD USED
7 7/8	4 1/2"	6308	500 BAGS			

RECEIVED

APR 15 1964

(Record the Process used, No. of Qts. or Gals. used, interval treated or shot.)

Fract well with 62,070 gals treated w/br; 60,000 # 20-40 sd; 10,000# 10-20 sand

Result of Production Stimulation..... No IM pressure; Max. press. 3400#; Minimum pressure 2800#;

Pressure treating pressure 3100#; AIR 41.5 EFM; LSP 1200#; SI 5 min. 800#

Flushed w/ 1500 gals wtr treated w/ 1% cao12 & 20% Depth Cleaned Out..... 6552+
1000 gals WAC8

AMOUNT OF
MUD-USED

RECEIVED

APR 15 1964

OIL CON. COM.
DIST. 3

Attachment #5

Item VII: Data on Proposed Injection Well

1. Average daily injection: Rate 3 BPM
Volume 1200 BPD
2. This will be an open system
3. Average injection pressure is expected to be 1000psi.
Maximum injection pressure is 1700psi.
4. This well will be used to dispose of produced water from Fruitland Coal-Gas Wells and from conventional wells in the San Juan Basin.

Water analysis from several wells producing from these formations are attached.

5. The proposed zone for injection is the Point Lookout formation which does not produce oil or gas in this area. A drill stem test was conducted on this zone in the McGrath #4 well (Unit B sec 34, T30N, R12W) which is less than 1-1/2 miles from this location. The DST recovered 400' of slightly gas cut mud, 90' of slightly gas cut water and 2000 cc of water in the sample chamber. An analysis of the water recovered is attached. The water from the sample chamber is closest to the actual formation water. The calculated Total Dissolved Solids for this water is 17,180 mg/l. This is the closest test or water analysis for the Point Lookout formation and should be representative of what this well will encounter.

Attachment 5A

Water Analysis - Produced Waters										Item VII #4:
Location:	NA	CA	Mg	K	Cl	SO4	CO3	HCO3	OH	Total Dissolved Solids
Fruitland Coal-Gas Wells										
SW/4 Sec 3, T29N, R14W	9,365	110	49	153	13,256	0	0	2,847	0	25,780
NE/4 Sec 7, T31N, R9W	5,794	42	36	27	1,194	0	0	13,664	0	20,757
SW/4 Sec 12, T32N, R8W	3,814	93	--	No Test	3,315	0	0	4,891	0	12,152
SW/4 Sec 15, T32N, R11W	3,739	96	17	233	4,748	0	0	2,489	0	11,322
NE/4 Sec 36, T32N, R11W	4,318	108	24	150	2,956	0	0	7,052	0	14,608
Pictured Cliffs Wells										
SE/4 Sec 1, T23N, R6W	11,590	625	154	84	18,748	0	0	1,287	-	32,488
SE/4 Sec 2, T23N, R4W	770	60	12	18	639	300	0	832	-	2,631
NW/4 Sec 6, T31N, R10W	530	92	21	2	177	0	0	1,491	-	2,313
Dakota Wells										
NW/4 Sec 18, T26N, R7W	772	76	16	30	861	535	0	244	0	2,534
NE/4 Sec 8, T27N, R9W	1,173	0	24	26	1,404	25	0	830	-	3,481
SE/4 Sec 5, T27N, R10W	553	56	96	6	856	25	0	573	-	2,146
SW/4 Sec 28, T27N, R10W	2,001	16	0	60	1,592	750	0	1,760	-	6,179
SW/4 Sec 26, T31N, R6W	5,830	120	49	90	5,874	3,838	0	1,230	0	17,031

LABORATORY WATER

Item VII 5

To Southland Royalty
Attn: Doug Harris
Box 570
Farmington, N.M. 87499

Date 9/12/84

This report is the property of Halliburton Company and neither it nor any part thereof nor a copy thereof is to be published or disclosed without first securing the express written approval of laboratory management. It may however, be used in the course of regular business operations by any person or concern and employees thereof receiving such report from Halliburton Company.

4255-4377Submitted by Doug Harris Date Rec. _____Well No. McGrath #4 Depth 4255' - 4377' Formation Point LookoutCounty _____ Field _____ Source DST 12 4255' - 4377'

	<u>Top Recovery</u>	<u>Bottom Recovery</u>	<u>Sample Chamber</u>
Resistivity	<u>3.16 @ 65°F</u>	<u>.97 @ 71°F</u>	<u>.68 @ 68°F</u>
Specific Gravity			
pH	<u>8.47</u>	<u>7.53</u>	<u>7.86</u>
Calcium (Ca)	<u>55</u>	<u>210</u>	<u>210</u> *MPI
Magnesium (Mg)	<u>NT</u>	<u>NT</u>	<u>35</u>
Chlorides (Cl)	<u>2900</u>	<u>6950</u>	<u>9900</u>
Sulfates (SO ₄)			
Bicarbonates (HCO ₃)	<u>320</u>	<u>705</u>	<u>670</u>
Soluble Iron (Fe)	<u>NT</u>	<u>NT</u>	<u>NT</u>

Remarks:

*Milligrams per liter

Respectfully submitted,

Analyst: _____
cc:

HALLIBURTON COMPANY

By B. L. Rain

NOTICE

This report is limited to the described sample tested. Any user of this report agrees that Halliburton shall not be liable for any loss or damage, whether it be to act or omission, resulting from such report or its use.

Attachment #7

Item IX:

The proposed stimulation program is to breakdown the perforated interval 4380' to 4480' with 5,000 to 7,500 gals of 15% of HCl and ball sealers.

Attachment #8

Item X:

Logging and Test Data

It is proposed to run the following logs:

Induction - Electric from T.D. to
surface casing

Formation Density from T.D. to 3500'

No drill stem tests are proposed.

Attachment #9

Item XI:

The State Engineers Office shows only one water well within 1 mile of this proposed well. This well was drilled in the SE, SE of section 34, T30N, R12W in 1977 and was capped with a steel plate welded over the casing. It is not producing.

Attachment #10

Item XII:

I have examined the geologic and engineering data in this area along with the well records. There is no evidence of open faults or any other hydrologic connection between the Point Lookout formation (the disposal zone) and any underground source of drinking water.

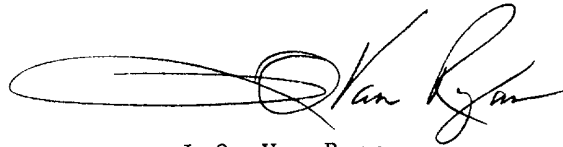
A handwritten signature in dark ink, appearing to read "L.O. Van Ryan". The signature is stylized with a large, sweeping loop at the beginning and a long, horizontal stroke extending to the right.

L.O. Van Ryan

Item XIV: Proof of Notice

Owner of the surface is George Coleman, the applicant
in this case.

Leasehold Operators within 1/2 mile of this location:

<u>Operator and Address</u>	<u>Location of Lease</u>	<u>Date Mailed</u>
Merrion Oil and Gas P.O. Nox 840 Farmington, NM 87499	SE/4 Sec 35, T30N R12W	6-26-91
Southland Royalty Company (Meridian Oil Inc.) P.O. Box 4289 Farmington, NM 87499	SE/4 Sec 34, SW/4 Sec 35, T30N, R12W All of Sec 2 & E/2 Sec 3, T29N, R12W	6-26-91

P 684 162 543

RECEIPT FOR CERTIFIED MAIL

NO INSURANCE COVERAGE PROVIDED
NOT FOR INTERNATIONAL MAIL

(See Reverse)

Sent to Bureau of Land Management	Street and No. 1235 La Plata Hwy	P.O. State and ZIP Code Farmington, NM 87401	Postage \$ 1.44	Certified Fee 1.00	Special Delivery Fee	Restricted Delivery Fee	Return Receipt showing to whom and Date Delivered 1.00	Return Receipt showing Date and Address of Delivery	TOTAL Postage and Fees 3.44	Postmark or Date
--------------------------------------	-------------------------------------	---	--------------------	-----------------------	----------------------	-------------------------	---	---	--------------------------------	------------------

PS Form 3800, June 1985

P 838 253 942

RECEIPT FOR CERTIFIED MAIL

NO INSURANCE COVERAGE PROVIDED
NOT FOR INTERNATIONAL MAIL

(See Reverse)

Sent to McCracken Oil & Gas	Street and No. P.O. Box 840	P.O. State and ZIP Code Farmington, NM 87495	Postage \$ 1.44	Certified Fee 1.00	Special Delivery Fee	Restricted Delivery Fee	Return Receipt showing to whom and Date Delivered 1.00	Return Receipt showing Date and Address of Delivery	TOTAL Postage and Fees 3.44	Postmark or Date
--------------------------------	--------------------------------	---	--------------------	-----------------------	----------------------	-------------------------	---	---	--------------------------------	------------------

PS Form 3800, June 1985

P 838 253 943

RECEIPT FOR CERTIFIED MAIL

NO INSURANCE COVERAGE PROVIDED
NOT FOR INTERNATIONAL MAIL

(See Reverse)

Sent to Southland Royalty (McCracken Oil & Gas)	Street and No. P.O. Box 4289	P.O. State and ZIP Code Farmington, NM 87495	Postage \$ 1.44	Certified Fee 1.00	Special Delivery Fee	Restricted Delivery Fee	Return Receipt showing to whom and Date Delivered 1.00	Return Receipt showing Date and Address of Delivery	TOTAL Postage and Fees 3.44	Postmark or Date
---	---------------------------------	---	--------------------	-----------------------	----------------------	-------------------------	---	---	--------------------------------	------------------

PS Form 3800, June 1985

The Far Side

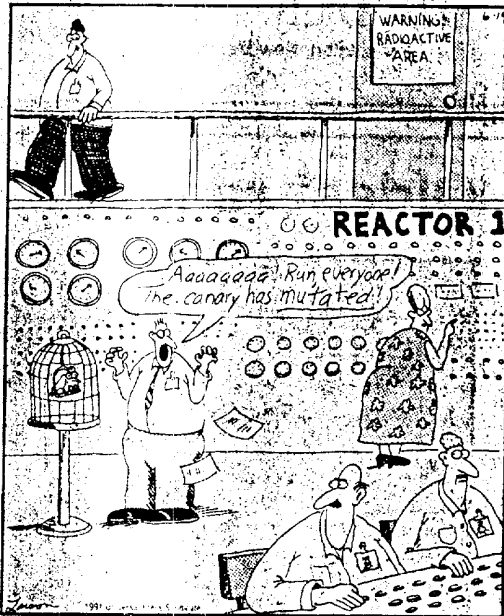

Inside a nuclear power plant

Legal

LEGAL NOTICE

INTENT TO DISPOSE OF WATER IN THE SUBSURFACE

Coleman Oil and Gas, Inc. Proposes to dispose of produced water in the Point Lookout formation. The injection well will be the Sunco Disposal Well #1, located 1595' FNL and 1005' FWL of Section 2, T29N, R12W, NMPM, San Juan County, New Mexico. Depth of injection will be from 4380' to 4480'. Maximum anticipated injection rate is 1200 BWPD at a maximum surface injection pressure of 1700 psi.

Questions should be addressed to: L.O. Van Ryan, 207 W. 38th St., Farmington, NM 87401. Phone: number (505) 325-8900.

Interested parties must file objections or requests for hearing with the Oil Conservation Division, P.O. Box 2088, Santa Fe, NM 87501 within 15 days.

Legal No. 27899 published in the Farmington Daily Times, Farmington, New Mexico on Wednesday, Thursday, and Friday, June 19, 20 and 21, 1991.

NOTICE TO BIDDERS

Sealed bids will be received by San Juan College, San Juan County, Farmington, New Mexico at the office of the Purchasing Secretary, Business Office, 4601 College Blvd., Farmington, New Mexico 87401, until the hour of 4:00 p.m. on the 2nd day of July at which time bids duly delivered and submitted will be opened and read for

proposals, thus, delayed will not be considered and will be returned unopened.

Further details may be obtained at the office of the Purchasing Secretary, Business Office, San Juan College, Farmington, New Mexico. San Juan College reserves the right to accept or reject any or all bids.

Until the final award by San Juan College, said

FARMINGTON PUMPING SERVICE

OIL AND GAS PROPERTY MANAGEMENT • CONTRACT PUMPING • CONSULTING ENGINEERING

207 W. 38th St. Farmington, NM 87401 (505) 325-8900

June 26, 1991

Bureau of Land Management
1235 La Plata Hwy
Farmington, NM 87401

Gentlemen:

Coleman Oil and Gas, Inc. is making application to drill a disposal well in the NW/4 of Section 2, T29N, R12W of San Juan County, New Mexico.

A copy of the application is attached for your information as a lease hold operator within one-half mile of the disposal well location.

Objections or requests for hearing must be filed with the Oil Conservation Division, P.O. Box 2088, Santa Fe, New Mexico 87501, within 15 days.

Yours truly,

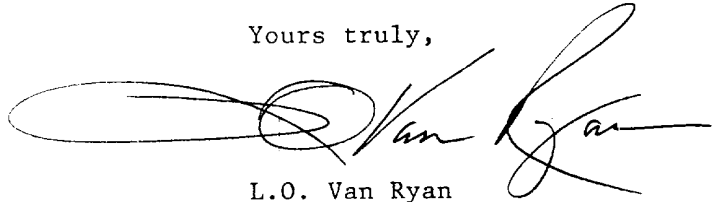
A handwritten signature in black ink, appearing to read "L.O. Van Ryan", is written over a horizontal line.

L.O. Van Ryan

FARMINGTON PUMPING SERVICE

OIL AND GAS PROPERTY MANAGEMENT • CONTRACT PUMPING • CONSULTING ENGINEERING

207 W. 38th St. Farmington, NM 87401 (505) 325-8900

June 26, 1991

Merrion Oil and Gas
P.O. Box 840
Farmington, NM 87499

Gentlemen:

Coleman Oil and Gas, Inc. is making application to drill a disposal well in the NW/4 of Section 2, T29N, R12W of San Juan County, New Mexico.

A copy of the application is attached for your information as a lease hold operator within one-half mile of the disposal well location.

Objections or requests for hearing must be filed with the Oil Conservation Divisor, P.O. Box 2088, Santa Fe, New Mexico 87501, within 15 days.

Yours truly,

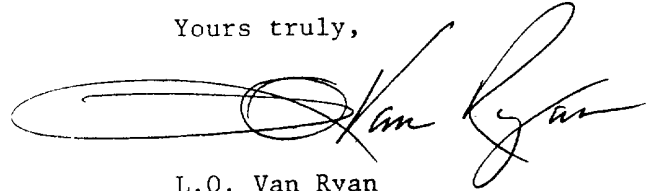
A handwritten signature in black ink, appearing to read "L.O. Van Ryan", with a large, stylized loop at the end.

L.O. Van Ryan

FARMINGTON PUMPING SERVICE

OIL AND GAS PROPERTY MANAGEMENT • CONTRACT PUMPING • CONSULTING ENGINEERING

207 W. 38th St. Farmington, NM 87401 (505) 325-8900

June 26, 1991

Southland Royalty Company
(Meridian Oil)
P.O. Box 4289
Farmington, NM 87499

Gentlemen:

Coleman Oil and Gas, Inc. is making application to drill a disposal well in the NW/4 of Section 2, T29N, R12W of San Juan County, New Mexico.

A copy of the application is attached for your information as a lease hold operator within one-half mile of the disposal well location.

Objections or requests for hearing must be filed with the Oil Conservation Division, P.O. Box 2088, Santa Fe, New Mexico 87501, within 15 days.

Yours truly,

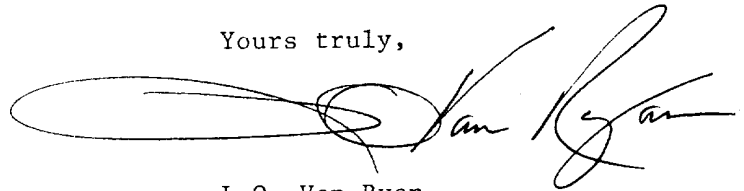
A handwritten signature in black ink, appearing to read "L.O. Van Ryan", with a large, stylized loop at the end.

L.O. Van Ryan

F-10 Se 12
MERIDIAN OIL

December 12, 1991

Oil Conservation Division
State of New Mexico
Attn: Mr. David R. Catanach
P.O. Box 2088
Santa Fe, NM 87501

RECEIVED
DEC 16 1991
OIL CON. DIV.
DIST. 3

RE: Case 10370
Coleman Oil and Gas Inc.
Salt Water Disposal
SW/4 NW/4 Sec. 2, T29N-R12W
San Juan County, New Mexico

Gentlemen:

Meridian Oil Inc. hereby withdraws its objection to Coleman Oil and Gas, Inc.'s application for a salt water disposal well to be located in the SW/4 NW/4 Section 2, T29N-R12W, San Juan County, New Mexico. Meridian and Coleman have come to an understanding in regards to the referenced project; therefore, it will not be necessary for a formal hearing. We wish to thank the Oil Conservation Division for its patience and assistance in this matter.

If I can be of further assistance, please let me know.

Very truly yours,

Van L. Goebel
Van L. Goebel
Senior Landman

VLG:11
ID#421+40
SRC 020254-T

cc: Alan Alexarder

Ernie Busch
Oil Conservation Division
Aztec, NM

OFFICE OF THE
ATTORNEY GENERAL
STATE OF TEXAS
AUGUST 19, 1964

Item VIII:

The injection zone is the Point Lookout Sandstone of the Mesa Verde Group. The Point Lookout is a light to medium gray, angular to subangular very fine grained, well-cemented sandstone with laminations of light to dark gray carbonaceous shale.

Recent well logs in the area indicate a maximum porosity of 13 to 14% with an average of 10%.

The average thickness of the injection interval is 100' and is at a depth of 4380' to 4480'.

Underground water sources are the Nacimiento which is exposed at the surface and the Ojo Alamo which occurs from 500' to 700'.

There are no known water sources immediately underlying the injection zone.